

NO. OF COPIES RECEIVED	6
DISTRIBUTION	
SANTA FE	1
FILE	1
U.S.G.S.	2
LAND OFFICE	
OPERATOR	2

NEW MEXICO OIL CONSERVATION COMMISSION

30-095-22684
Form C-101
Revised 1-1-65

5A. Indicate Type of Lease	
STATE <input type="checkbox"/>	FEE <input checked="" type="checkbox"/>
5. State Oil & Gas Lease No.	

APPLICATION FOR PERMIT TO DRILL, DEEPEN, OR PLUG BACK

1a. Type of Work		7. Unit Agreement Name	
b. Type of Well OIL WELL <input type="checkbox"/> GAS WELL <input checked="" type="checkbox"/> OTHER <input type="checkbox"/>		8. Farm or Lease Name Betty Hartman	
2. Name of Operator Manana Gas, Inc.		9. Well No. 1	
3. Address of Operator P.O. Box 80068, Albuquerque, New Mexico 87108		10. Field and Pool, or Wildcat Basin Dakota	
4. Location of Well UNIT LETTER P LOCATED 790 FEET FROM THE south LINE AND 1245 FEET FROM THE east LINE OF SEC. 14 TWP. 30N RGE. 12W NMPM		12. County San Juan	
21. Elevations (Show whether DF, RT, etc.) 5535 GR		19. Proposed Depth 6600'	19A. Formation Dakota
21A. Kind & Status Plug. Bond Blanket	21B. Drilling Contractor Four Corners Drlg.	20. Rotary or C.T. Rotary	
22. Approx. Date Work will start July 1, 1977			

PROPOSED CASING AND CEMENT PROGRAM

SIZE OF HOLE	SIZE OF CASING	WEIGHT PER FOOT	SETTING DEPTH	SACKS OF CEMENT	EST. TOP
12 1/4"	8 5/8"	24#	200'	150	Surface
7 7/8"	4 1/2"	10.5#	6600'	750	Surface

Mechanical logs will be run at TD and the Dakota formation will be selectively perforated and fraced. 10" 3000 psi BOP with blind and pipe rams will be operational at all times while drilling. 6" 3000 psi double gate manual BOP will be utilized for completion. DV tools will be set at the base of the Mesaverde and Pictured Cliffs for a 3-stage cement job on the long string.

HBP gas is dedicated to El Paso Natural Gas Co.

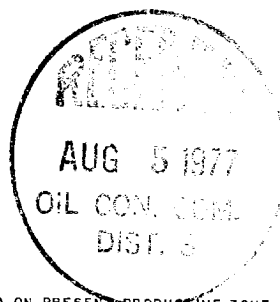

ABOVE SPACE DESCRIBE PROPOSED PROGRAM: IF PROPOSAL IS TO DEEPEN OR PLUG BACK, GIVE DATA ON PRESENT PRODUCTIVE ZONE AND PROPOSED NEW PRODUCTIVE ZONE. GIVE BLOWOUT PREVENTER PROGRAM, IF ANY.

I hereby certify that the information above is true and complete to the best of my knowledge and belief.

Signed Ed Hartman Title President Date 6-22-77
(This space for State Use)

APPROVED BY Al Hendrich TITLE SUPERVISOR DIST. #3 DATE AUG 1 1977
CONDITIONS OF APPROVAL IF ANY:

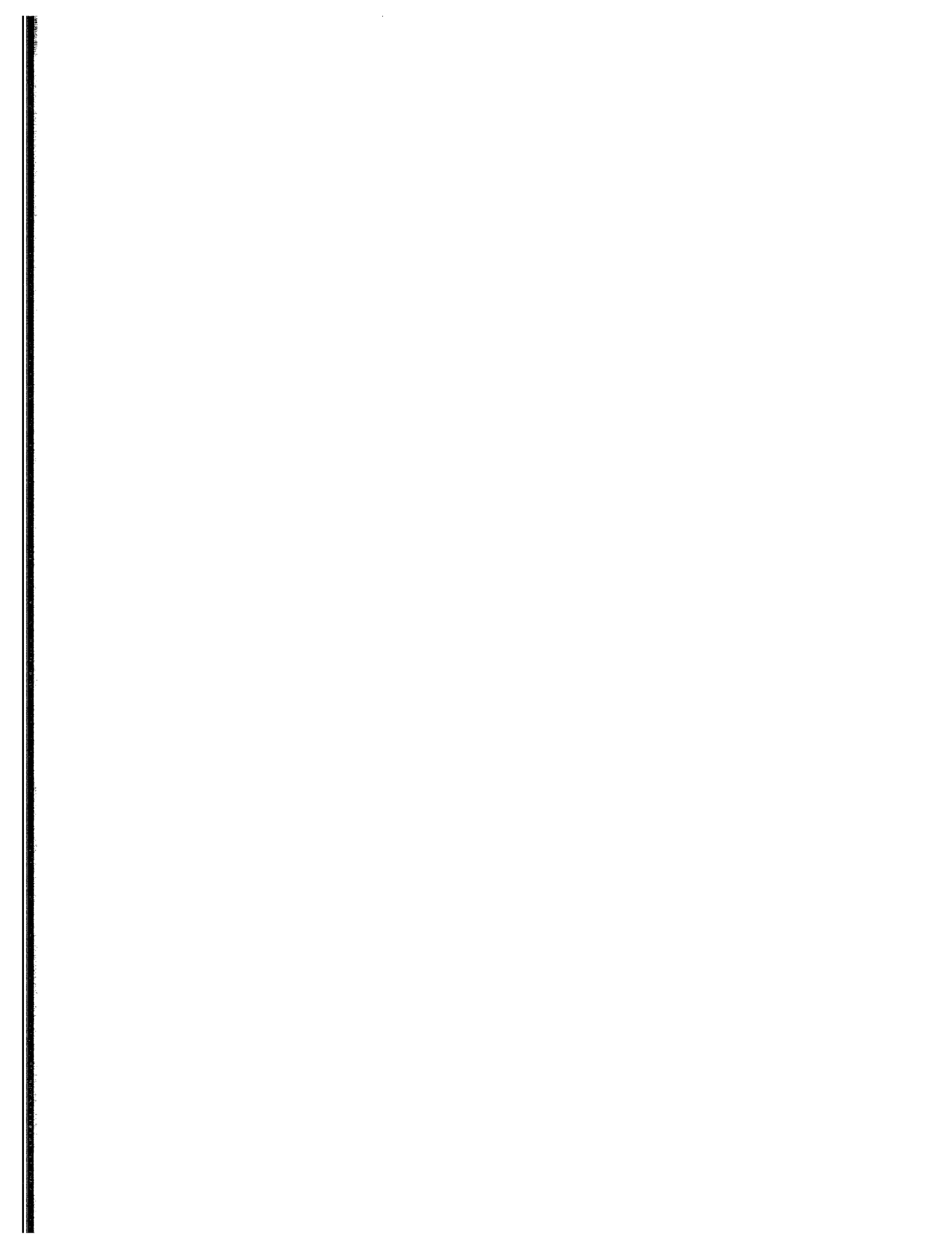

NEW MEXICO OIL CONSERVATION COMMISSION

WELL LOCATION AND ACERAGE DEDICATION PLAT

All distances must be from the outer boundaries of the Section

Operator MANANA GAS, INC.			Lease BETTY HARTMAN		Well No. 1
Unit Letter P	Section 14	Township 30 NORTH	Range 12 WEST	County SAN JUAN	
Actual Footage Location of Well: 790 feet from the SOUTH line and 1245 feet from the EAST line					
Ground Level Elev. 5535	Producing Formation Dakota	Pool Basin Dakota	Dedicated Acreage: 32.0 Acres		

1. Outline the acreage dedicated to the subject well by colored pencil or hachure marks on the plat below.
2. If more than one lease is dedicated to the well, outline each and identify the ownership thereof (both as to working interest and royalty), See enclosed.
3. If more than one lease of different ownership is dedicated to the well, have the interests of all owners been consolidated by communitization, unitization, force-pooling, etc?

(x) Yes () No If answer is "yes," type of consolidation Communitization

If answer is "no," list the owners and tract descriptions which have actually consolidated. (Use reverse side of this form if necessary.)

No allowable will be assigned to the well until all interests have been consolidated (by communitization, unitization, forced-pooling, or otherwise) or until a non standard unit, eliminating such interests, has been approved by the Commission.

CERTIFICATION

I hereby certify that the information contained herein is true and complete to the best of my knowledge and belief.

Ed Hartman

Name

Ed Hartman

Position

President

Company

Manana Gas, Inc.

Date

6-22-77

I hereby certify that the well location shown on this plat was plotted from field notes of actual surveys made by me or under my supervision, and that the same is true and correct to the best of my knowledge and belief.

13 May 1977

Date Surveyed

James P. Leese
Registered Professional Engineer
and/or Land Surveyor

James P. Leese

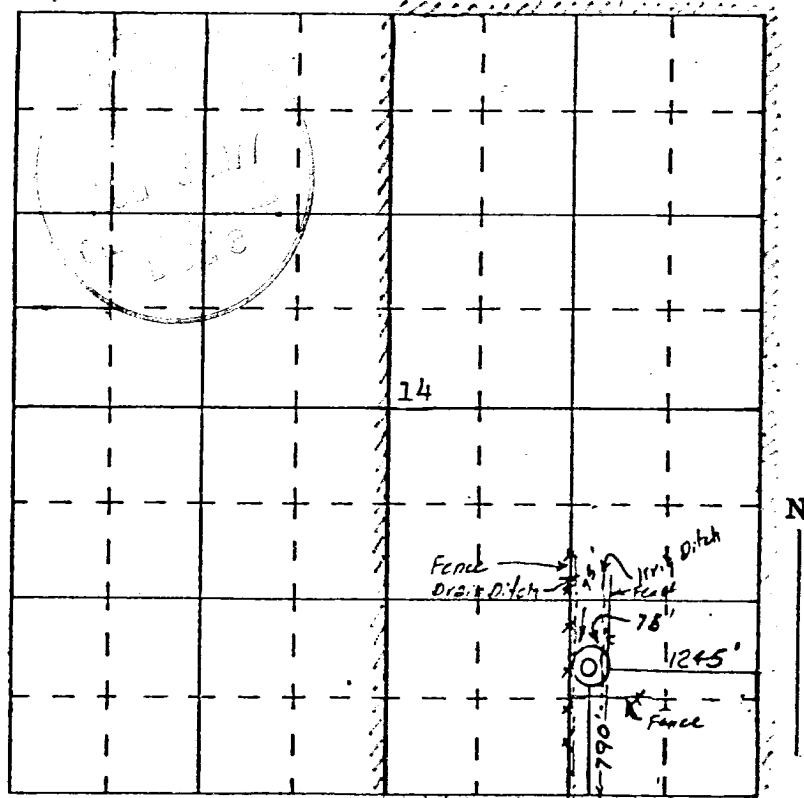

SCALE—4 INCHES EQUALS 1 MILE

