

Ernie Busch

To: Ben Stone
Subject: DUGAN PRODUCTION CORP MS. NONA #2 (DHC)
Importance: High

MS. NONA #2
A-15-30N-14W
RECOMMEND: APPROVAL

[illegible]



dugan production corp.

RECEIVED
NOV - 7 1996

OIL CON. DIV.
DIST. 3

November 6, 1996

Mr. William LeMay, Director
New Mexico Oil Conservation Division
2040 South Pacheco
Santa Fe, NM 87505

Re: Application for Administrative Approval to Downhole Commingle
Dugan Production Corp's Ms. Nona #2
Unit A, Section 15, T-30N, R-14W
Greek Gallup and Basin Dakota Pools
San Juan County, NM

Dear Mr. LeMay,

Attached please find our application for administrative approval to complete the Greek Gallup and downhole commingle it with the existing Basin Dakota production in our Ms. Nona #2 well. Since the Greek Gallup pool is limited, it is recommended the production allocation be made off anticipated production rates as produced from our Pole's Paradise #2 well located in Unit K, Sec. 9, T30N, R14W, San Juan County, New Mexico. The Pole's Paradise No. 2 Gallup production has stabilized at 3 BOPD and 6 MCFD. A production decline curve is attached.

Production decline curves and C-102s for each zone, Form C-107A and a map showing all offsetting operators are attached. Dugan Production Corp. operates all offsetting proration units.

Sincerely,

Gary Brink
Operations Manager

GWB/cg

encs.

cc: NMOCD, Aztec
BLM, Farmington

Oil
Gas
Water
Wells

Field: BASIN

Lease: MS NONA | Well #2

Operator: DUGAN PRODUCTION CORPORATION

Production Rate vs Time
For the Period 09/1978 to 04/1996 | API: 30045227640000

BBI/Mo or Mcf/Mo

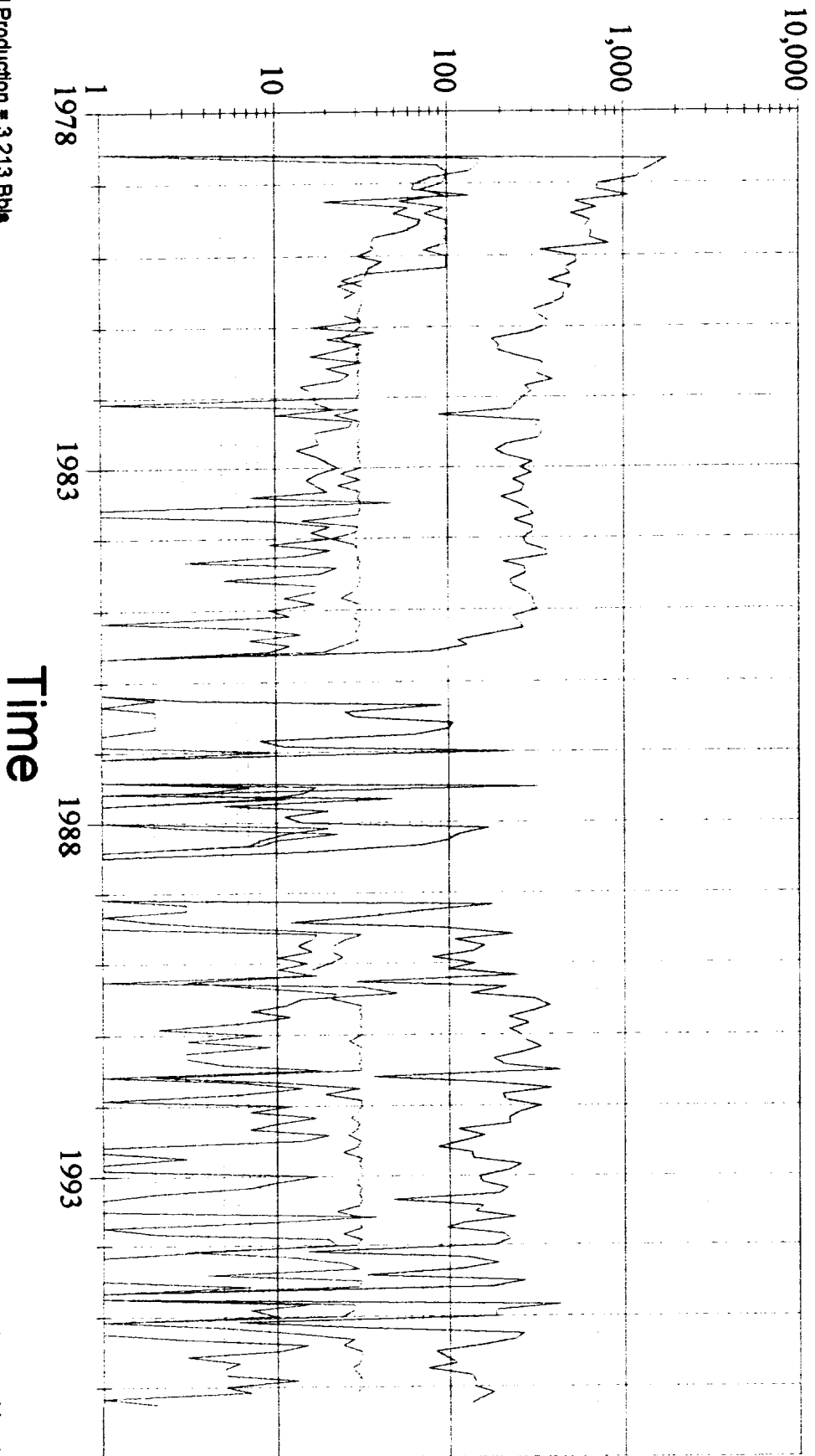

Reported Oil Production = 3,213 Bbl
Reported Gas Production = 49,248 Mcf
Reported Water Production = 5,586 Bbl

Oil
Gas
Water
Wells

Field: WILDCAT GL

Lease: POLE'S PARADISE | Well #2

Operator: DUGAN PRODUCTION CORPORATION

Production Rate vs Time
For the Period 04/1995 to 04/1996 | API: 30045254080000

BBI/Mo or Mcf/Mo

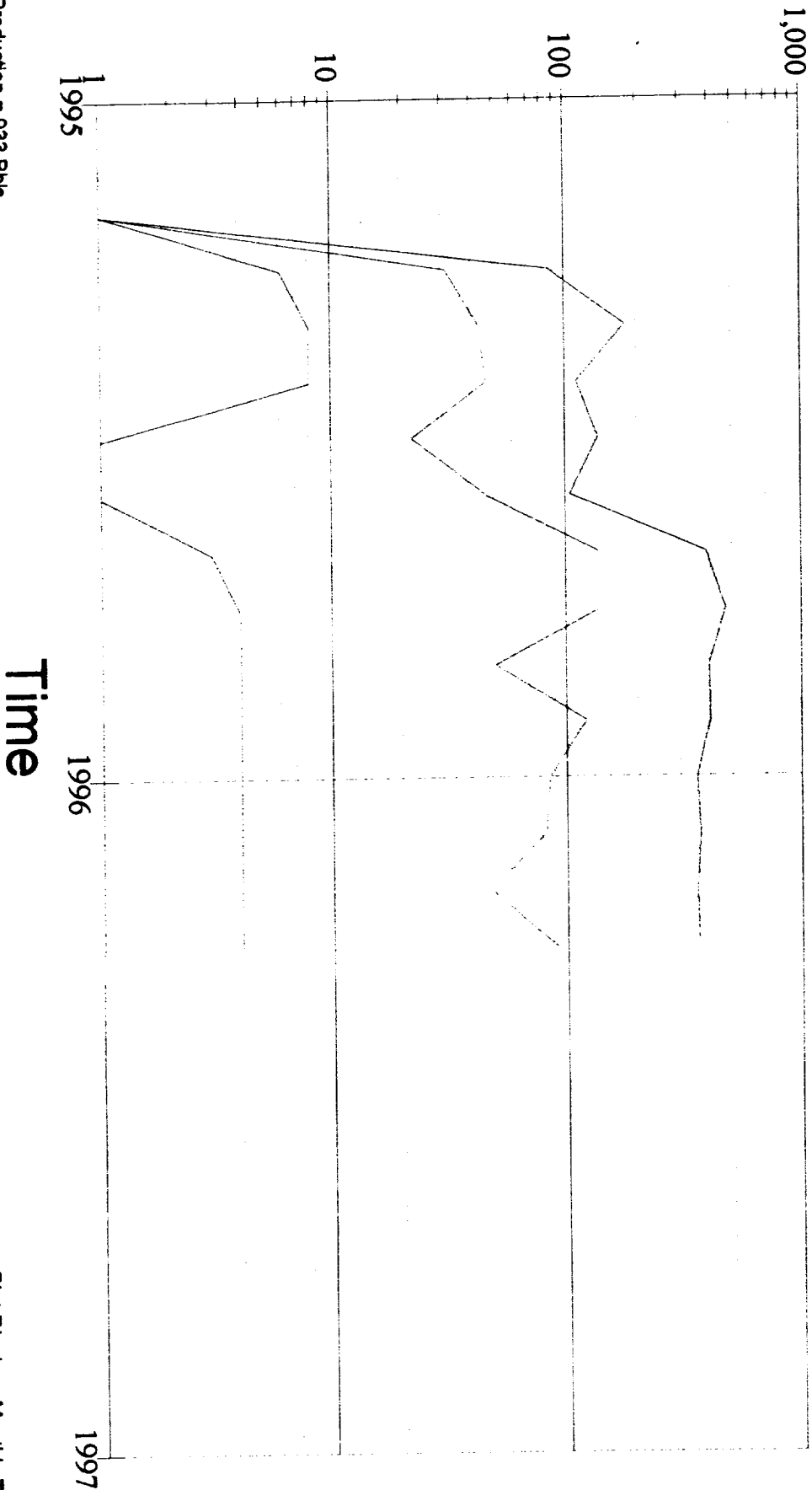

Reported Oil Production = 933 Bbls
Reported Gas Production = 3,661 Mcf
Reported Water Production = 55 Bbls

Time

Plot Displays Monthly Totals

Copyright (C) 1996 by Petroleum Information Corporation

NEW MEXICO OIL CONSERVATION COMMISSION
WELL LOCATION AND ACREAGE DEDICATION PLAT

Form C-102
Supersedes C-128
Effective 1-1-65

All distances must be from the outer boundaries of the Section

Operator Dugan Production Corporation			Lease Ms Nona			Well No. 2		
Unit Letter A	Section 15	Township 30 North	Range 14 West	County San Juan				
Actual Footage Location of Well: 920 feet from the North line and 970 feet from the East line								
Ground Level Elev. 6102	Producing Formation Dakota		Pool Basin			Dedicated Acreage: 320 Acres		

1. Outline the acreage dedicated to the subject well by colored pencil or hatchure marks on the plat below.
2. If more than one lease is dedicated to the well, outline each and identify the ownership thereof (both as to working interest and royalty).
3. If more than one lease of different ownership is dedicated to the well, have the interests of all owners been consolidated by communitization, unitization, force-pooling, etc?

☒ Yes ☐ No If answer is "yes," type of consolidation Communitization

If answer is "no," list the owners and tract descriptions which have actually been consolidated. (Use reverse side of this form if necessary.) _____

No allowable will be assigned to the well until all interests have been consolidated (by communitization, unitization, forced-pooling, or otherwise) or until a non-standard unit, eliminating such interests, has been approved by the Commission.

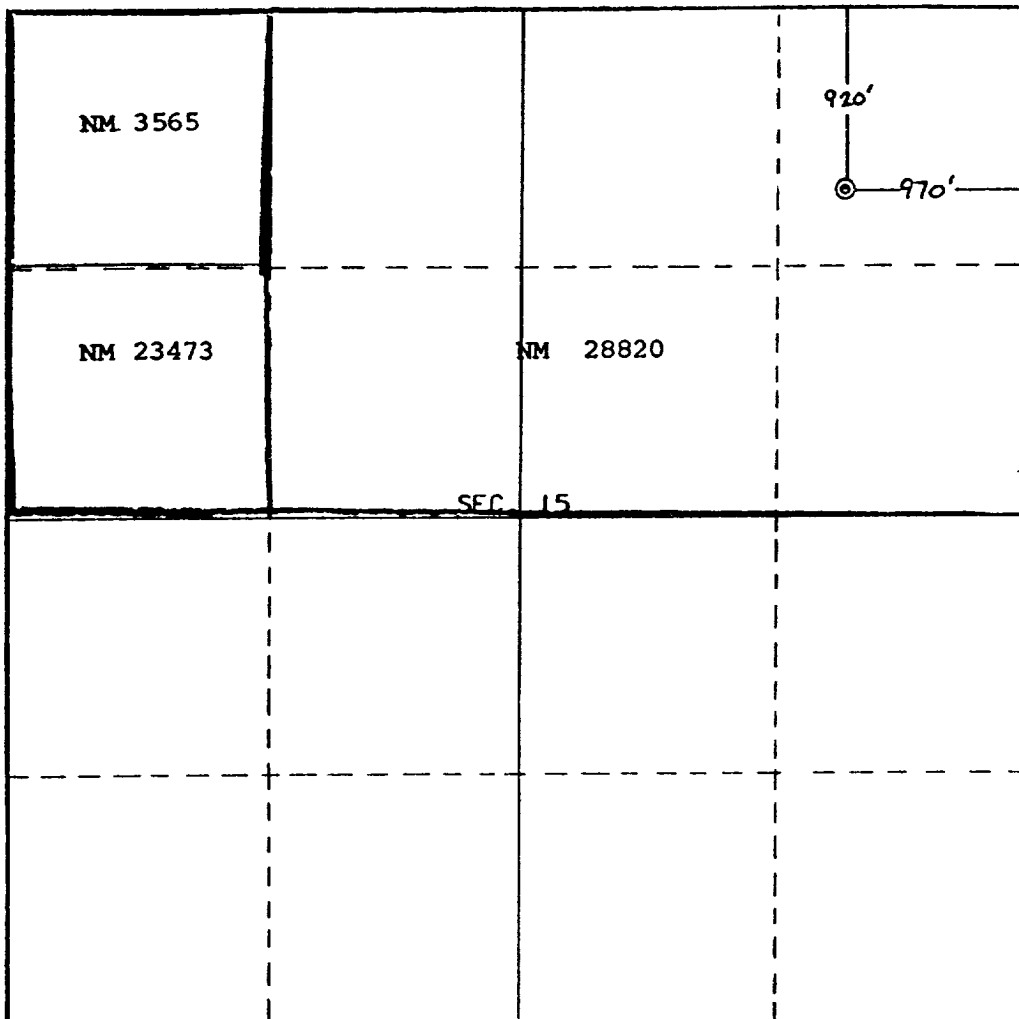

CERTIFICATION

I hereby certify that the information contained herein is true and complete to the best of my knowledge and belief.

Name
Thomas A. Dugan

Position
President

Company
Dugan Production Corp.

Date
10-5-77

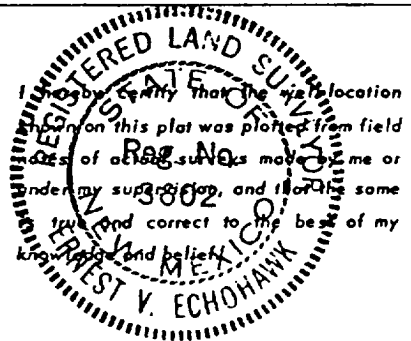

Date Surveyed
September 18, 1977

Registered Professional Engineer
and/or Land Surveyor

E.V. Echohawk

Certificate No. **3602**
E.V. Echohawk LS

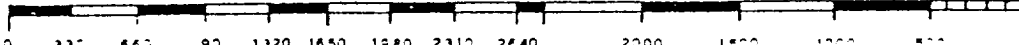

District I
PO Box 1988, Hobbs, NM 88241-1988
District II
PO Drawer DD, Artesia, NM 88211-8719
District III
1800 Rio Brazos Rd., Aztec, NM 87410
District IV
PO Box 2088, Santa Fe, NM 87504-2088

State of New Mexico
Energy, Minerals & Natural Resources Department

OIL CONSERVATION DIVISION
PO Box 2088
Santa Fe, NM 87504-2088

Form C-102
Revised February 21, 1994
Instructions on back
Submit to Appropriate District Office
State Lease - 4 Copies
Fee Lease - 3 Copies

☐ AMENDED REPORT

WELL LOCATION AND ACREAGE DEDICATION PLAT

1 APT Number 30 045 22764		2 Pool Code 96219		3 Pool Name W/C Greek Gallup	
4 Property Code 003775		5 Property Name Ms. Nona			6 Well Number 2
7 OGRID No. 006515		8 Operator Name Dugan Production Corp.			9 Elevation 6102' GL

10 Surface Location

UL or lot no. A	Section 15	Township 30N	Range 14W	Lot Ida	Feet from the 920	North/South line North	Feet from the 970	East/West line East	County San Juan
--------------------	---------------	-----------------	--------------	---------	----------------------	---------------------------	----------------------	------------------------	--------------------

11 Bottom Hole Location If Different From Surface

UL or lot no.	Section	Township	Range	Lot Ida	Feet from the	North/South line	Feet from the	East/West line	County

12 Dedicated Acres 40	13 Joint or Infill	14 Consolidation Code	15 Order No.
--------------------------	--------------------	-----------------------	--------------

NO ALLOWABLE WILL BE ASSIGNED TO THIS COMPLETION UNTIL ALL INTERESTS HAVE BEEN CONSOLIDATED
OR A NON-STANDARD UNIT HAS BEEN APPROVED BY THE DIVISION

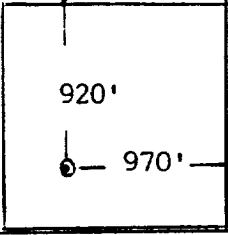
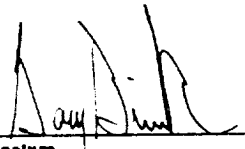
16					17 OPERATOR CERTIFICATION <i>I hereby certify that the information contained herein is true and complete to the best of my knowledge and belief</i>  Signature Gary Brink Printed Name Operations Manager Title 11/6/96 Date	
					18 SURVEYOR CERTIFICATION <i>I hereby certify that the well location shown on this plat was plotted from field notes of actual surveys made by me or under my supervision, and that the same is true and correct to the best of my belief.</i> September 18, 1977 Date of Survey Signature and Seal of Professional Surveyor: Original signed by E.V. Echohawk, L.S. 3602 Certificate Number	

DISTRICT I

P.O. Box 1990, Hobbs, NM 88241-1990

DISTRICT II

811 South First St., Artesia, NM 88210-2835

DISTRICT III

1000 Rio Brazos Rd, Aztec, NM 87410-1693

State of New Mexico
Energy, Minerals and Natural Resources Department**OIL CONSERVATION DIVISION**2040 S. Pacheco
Santa Fe, New Mexico 87505-6429Form C-107-A
New 3-12-96**APPROVAL PROCESS.**☐ Administrative ☐ Hearing**EXISTING WELLBORE**☐ YES ☐ NO**APPLICATION FOR DOWNHOLE COMMINGLING**Dugan Production Corp. P.O. Box 420, Farmington, NM 87499
Operator AddressMs. Nona 2 A 15-T30N-R14W San Juan
Lease Well No. Unit Ltr. - Sec - Twp - Rge CountySpacing Unit Lease Types: (check 1 or more)
OGRID NO. 006515 Property Code 003775 API NO. 30 045 22764 Federal ☒ , State ☐ , (and/or) Fee ☐

The following facts are submitted in support of downhole commingling:	Upper Zone	Intermediate Zone	Lower Zone
1. Pool Name and Pool Code	Greek Gallup 96219		Basin Dakota 71599
2. Top and Bottom of Pay Section (Perforations)	5527-5843		6398-6484
3. Type of production (Oil or Gas)	Oil		Gas
4. Method of Production (Flowing or Artificial Lift)	Pumping		Flowing
5. Bottomhole Pressure Oil Zones - Artificial Lift: Gas & Oil - Flowing: All Gas Zones: Estimated Current Measured Current Estimated Or Measured Original	a. (Current) b. (Original) 1900 est.	a. b.	a. 1230 calc. b. 2365 calc.
6. Oil Gravity ($^{\circ}$ API) or Gas BTU Content	41 $^{\circ}$ est.		1212
7. Producing or Shut-In?			Producing
Production Marginal? (yes or no)	Yes		Yes
* If Shut-In, give date and oil/gas/ water rates of last production Note: For new zones with no production history, applicant shall be required to attach production estimates and supporting data * If Producing, give date and oil/gas/ water rates of recent rates	Date: Rates: 3/6/0 est. from offset production	Date: Rates:	Date: Rates:

Application For Downhole Commingling
 Offsetting Operators
 Greek Gallup-Basin Dakota
 Dugan Production Corp
 Ms Nona #2
 Unit A, Sec 15, T 30 N, R 14 W
 San Juan Co, NM

10 Dugan	11 Dugan
Dugan Ms Nona #2 ●	Dugan
13 Dugan	14 Dugan