

UNITED STATES
DEPARTMENT OF THE INTERIOR
GEOLOGICAL SURVEY

APPLICATION FOR PERMIT TO DRILL, DEEPEN, OR PLUG BACK

1a. TYPE OF WORK DRILL <input checked="" type="checkbox"/> DEEPEN <input type="checkbox"/> PLUG BACK <input type="checkbox"/>			5. LEASE DESIGNATION AND SERIAL NO. SF 078438		
b. TYPE OF WELL OIL WELL <input type="checkbox"/> GAS WELL <input checked="" type="checkbox"/> OTHER <input type="checkbox"/> SINGLE ZONE <input checked="" type="checkbox"/> MULTIPLE ZONE <input type="checkbox"/>			6. IF INDIAN, ALLOTTEE OR TRIBE NAME		
2. NAME OF OPERATOR El Paso Natural Gas Company			7. UNIT AGREEMENT NAME San Juan 32-9 Unit		
3. ADDRESS OF OPERATOR PO Box 990, Farmington, NM 87401			8. FARM OR LEASE NAME San Juan 32-9 Unit		
4. LOCATION OF WELL (Report location clearly and in accordance with any State requirements.)* At surface F 1500'N, 1600'W At proposed prod. zone			9. WELL NO. 17A		
14. DISTANCE IN MILES AND DIRECTION FROM NEAREST TOWN OR POST OFFICE* 6 miles East of Cedar Hill, NM, "			10. FIELD AND POOL, OR WILDCAT Blanco Mesa Verde		
15. DISTANCE FROM PROPOSED* LOCATION TO NEAREST PROPERTY OR LEASE LINE, FT. (Also to nearest drlg. unit line, if any) 1500			11. SEC., T., R., M., OR BLK. AND SURVEY OR AREA Sec. 8, T-31-N, R-9-W NMPM		
16. NO. OF ACRES IN LEASE Unit			12. COUNTY OR PARISH San Juan		
17. NO. OF ACRES ASSIGNED TO THIS WELL W/ 309.37			13. STATE NM		
18. DISTANCE FROM PROPOSED LOCATION* TO NEAREST WELL, DRILLING, COMPLETED, OR APPLIED FOR, ON THIS LEASE, FT. 700			19. PROPOSED DEPTH 6235'		
20. ROTARY OR CABLE TOOLS Rotary			21. APPROX. DATE WORK WILL START*		
21. ELEVATIONS (Show whether DF, RT, GR, etc.) 6695' GL					

23. PROPOSED CASING AND CEMENTING PROGRAM				
SIZE OF HOLE	SIZE OF CASING	WEIGHT PER FOOT	SETTING DEPTH	QUANTITY OF CEMENT
13 3/4"	9 5/8"	32.3#	200'	224 cu.ft. to circulate
8 3/4"	7"	20.0#	3988'	466 cu.ft. to cover Ojo Alai
6 1/4"	4 1/2" liner	10.5#	3838-6235'	422 cu.ft. to fill to 3838'

Selectively perforate and sandwater fracture the Mesa Verde formation.

A 3000 psi WP and 6000 psi test double gate preventer equipped with blind and pipe rams will be used for blow out prevention on this well.

This gas is dedicated.

The W/2 of Section 8 is dedicated to this well.

IN ABOVE SPACE DESCRIBE PROPOSED PROGRAM: If proposal is to deepen or plug back, give data on present productive zone and proposed new productive zone. If proposal is to drill or deepen directionally, give pertinent data on subsurface locations and measured and true vertical depths. Give blowout preventer program, if any.

24. SIGNED N. G. Busco TITLE Drilling Clerk DATE January 16, 1978

(This space for Federal or State office use)

PERMIT NO. _____ APPROVAL DATE _____

APPROVED BY _____ TITLE _____ DATE _____
CONDITIONS OF APPROVAL, IF ANY:

*See Instructions On Reverse Side

NW - Unit agreement

**NEW MEXICO OIL CONSERVATION COMMISSION
WELL LOCATION AND ACREAGE DEDICATION PLAT**

Form C-102
Supersedes C-128
Effective 1-1-65

All distances must be from the outer boundaries of the Section.

Operator EL PASO NATURAL GAS COMPANY			Lease SAN JUAN 32-9 UNIT (SF-078438)		Well No. 17A
Unit Letter F	Section 8	Township 31-N	Range 9-W	County SAN JUAN	
Actual Footage Location of Well: <div style="display: flex; justify-content: space-between;"> 1500 feet from the NORTH line and 1600 feet from the WEST line </div>					
Ground Level Elev. 6695	Producing Formation MESA VERDE	Pool BLANCO MESA VERDE	Dedicated Acreage: 309.37 Acres		

1. Outline the acreage dedicated to the subject well by colored pencil or hachure marks on the plat below.
2. If more than one lease is dedicated to the well, outline each and identify the ownership thereof (both as to working interest and royalty).
3. If more than one lease of different ownership is dedicated to the well, have the interests of all owners been consolidated by communitization, unitization, force-pooling, etc?

☒ Yes ☐ No If answer is "yes," type of consolidation Unitization

If answer is "no," list the owners and tract descriptions which have actually been consolidated. (Use reverse side of this form if necessary.) _____

No allowable will be assigned to the well until all interests have been consolidated (by communitization, unitization, forced-pooling, or otherwise) or until a non-standard unit, eliminating such interests, has been approved by the Commission.

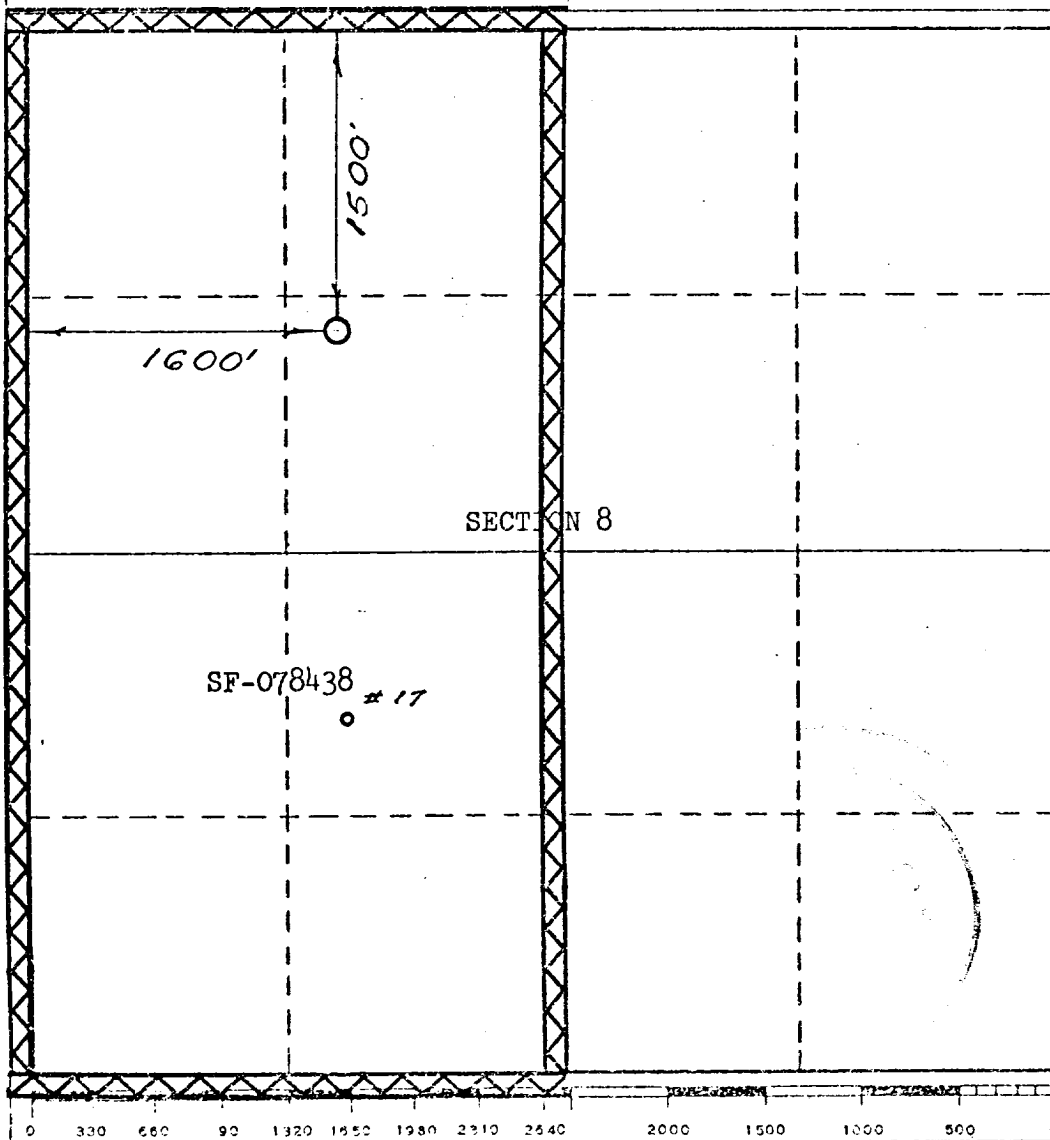

CERTIFICATION

I hereby certify that the information contained herein is true and complete to the best of my knowledge and belief.

Original Signed by
D. G. Brisco

Name
Drilling Clerk

Position
El Paso Natural Gas Co.

Company
January 16, 1978

Date

I hereby certify that the well location shown on this plat was plotted from field notes of actual surveys made by me or under my supervision, and that the same is true and correct to the best of my knowledge and belief.

Date Surveyed
SEPTEMBER 21, 1977

Registered Professional Engineer
and/or Land Surveyor

[Signature]
Certificate No. **1760**

Multi-Point Surface Use Plan

San Juan 32-9 Unit #17A

1. Existing Road - Please refer to Map No. 1 which shows the existing roads. New roads which will be required have been marked on this map. All existing and new roads will be properly maintained during the duration of this project.
2. Planned Access Roads - Please refer to Map No. 1. The grade of the access roads will be consistent with that of the local terrain. The road surface will not exceed twenty feet (20') in width. Upon completion of the project, the access road will be adequately drained to control soil erosion. Drainage facilities may include ditches, water bars, culverts or any other measure deemed necessary by trained Company personnel to insure proper drainage. Gates and/or cattleguards will be installed if necessary.
3. Location of Existing Wells - Please refer to Map No. 2
4. Location of Tank Batteries, Production Facilities, and Production Gathering and Service Lines - Please refer to Maps No. 1 and No. 2. Map No. 2 shows the existing gas gathering lines. Map No. 1 shows the existing roads and new proposed access roads. All known production facilities are shown on these two maps.
5. Location and Type of Water Supply - Water for the proposed project will be obtained from a water hole located at Hart Canyon Water Well.
6. Source of Construction Materials - No additional materials will be required to build either the access road or the proposed location.

7. Methods of Handling Waste Materials - All garbage and trash materials will be put into a burn pit shown on the attached Location Plat No. 1. When clean-up operations are begun on the proposed project, the burn pit with its refuse will be buried to a depth of at least three feet (3'). A latrine, the location of which is also shown on Plat No. 1 will be provided for human waste. If large amounts of liquids are left in the reserve pit after completion of the project, the pit will be fenced until the liquids have had adequate time to dry. The location clean-up will not take place until such time as the reserve pit can be properly covered over to prevent run-off from carrying any of these materials into the watershed. No earthen pit will be located on natural drainages; all earthen pits will be so constructed as to prevent leakage from occurring.
8. Ancillary Facilities - No camps or airstrips will be associated with this project.
9. Wellsite Layout - Please refer to the attached Plat No. 1.
10. Plans for Restoration of the Surface - After completion of the proposed project, the location will be cleaned and leveled. The location will be left in such a condition that will enable reseeding operations to be carried out. Seed Mixture #2 will be used. The reseeding operation will be performed during the time period set forth by the regulatory body. The location production equipment will be painted gray (Federal Standard #595-36357)
11. Other Information - The terrain is sandstone ledges and rolling hills covered with pinon and cedar trees. Cattle graze the proposed project site.

12. Operator's Representative - W. D. Dawson, Post Office Box 990,
Farmington, New Mexico 87401

13. Certification - I hereby certify that I, or persons under my direct supervision, have inspected the proposed drillsite and access route; that I am familiar with the conditions which presently exist; that the statements made in this plan are, to the best of my knowledge, true and correct; and, that the work associated with the operations proposed herein will be performed by El Paso Natural Gas Company and its contractors and sub-contractors in conformity with this plan and the terms and conditions under which it is approved.

January 13, 1978



D. R. Read
Division Drilling Engineer

DRR:pb

January 17, 1978

Operations Plan
San Juan 32-9 Unit #17A

I. Location: 1500'N, 1600'W, Section 8, T-31-N, R-9-W, San Juan County, NM

Field: Blanco Mesa Verde

Elevation: 6695'GL

II. Geology:

A. Formation Tops:	Surface	San Jose	Lewis	3788'
	Ojo Alamo	1933'	Mesa Verde	5403'
	Kirtland	2038'	Menefee	5493'
	Fruitland	3128'	Point Lookout	5785'
	Pic.Cliffs	3528'	Total Depth	6235'

B. Logging Program: GR-Ind. and GR-Density at Total Depth.

C. Coring Program: none

D. Natural Gauges: 5390', 5480', 5775' and at Total Depth.
Also gauge any noticeable increase in gas. Record all gauges in daily drilling report and on morning report.

III. Drilling:

A. Mud Program: mud from surface to 3988'. Gas from intermediate casing to Total Depth.

IV. Materials:

A. Casing Program:	<u>Hole Size</u>	<u>Depth</u>	<u>Casing Size</u>	<u>Wt.&Grade</u>
	13 3/4"	200'	9 5/8"	32.3# H-40
	8 3/4"	3988'	7"	20.0# K-55
	6 1/4"	3838-6235'	4 1/2"	10.5# K-55

B. Float Equipment: 9 5/8" surface casing - Larkin guide shoe (fig. 102)

7" intermediate casing - Dowell guide shoe (fig. 50101) and Dowell self-fill insert float valve (fig. 53003), 5 B&W stabilizers (Prod. No. 637085) every other joint above shoe. Run float two joints above shoe.

4 1/2" liner - 4 1/2" liner hanger with neoprene packoff. Larkin geyser shoe (fig. 222) and Larkin flapper type float collar (fig. 404 M&F).

C. Tubing: 6235' of 2 3/8", 4.7#, J-55 8rd EUE tubing with a common pump seating nipple above perforated pup joint with bull plugged full joint for mud anchor on bottom.

D. Wellhead Equipment: 10" 900 x 9 5/8" casing head. 10" 900 x 6" 900 xmas tree.

Operations Plan - San Juan 32-9 Unit #17A

V. Cementing:

9 5/8" surface casing - use 190 sks. of Class "B" cement with 1/4# gel-flake per sack and 3% calcium chloride (224 cu.ft. of slurry, 100% excess to circulate to surface). WOC 12 hours.. Test casing to 600#/30 minutes.

7" intermediate casing - use 215 sks. of 65/35 Class "B" Poz with 6% gel and 2% calcium chloride (8.3 gallons of water per sack) followed by 100 sks. of Class "B" with 2% calcium chloride (466 cu.ft. of slurry, 50% excess to cover Ojo Alamo). Run temperature survey at 8 hours. WOC 12 hours. Test casing to 1200#/30 minutes.

4 1/2" liner - precede cement with 20 barrels of gel water (2 sks. gel) Cement with 240 sks. of Class "B" cement with 4% gel, 1/4 cu.ft. of fine gilsonite per sack and 0.6% Halad-9 (422 cu.ft. of slurry, 70% excess to circulate liner). WOC 18 hours.

El Paso Natural Gas Company
 Typical location plot for these yards and related wells

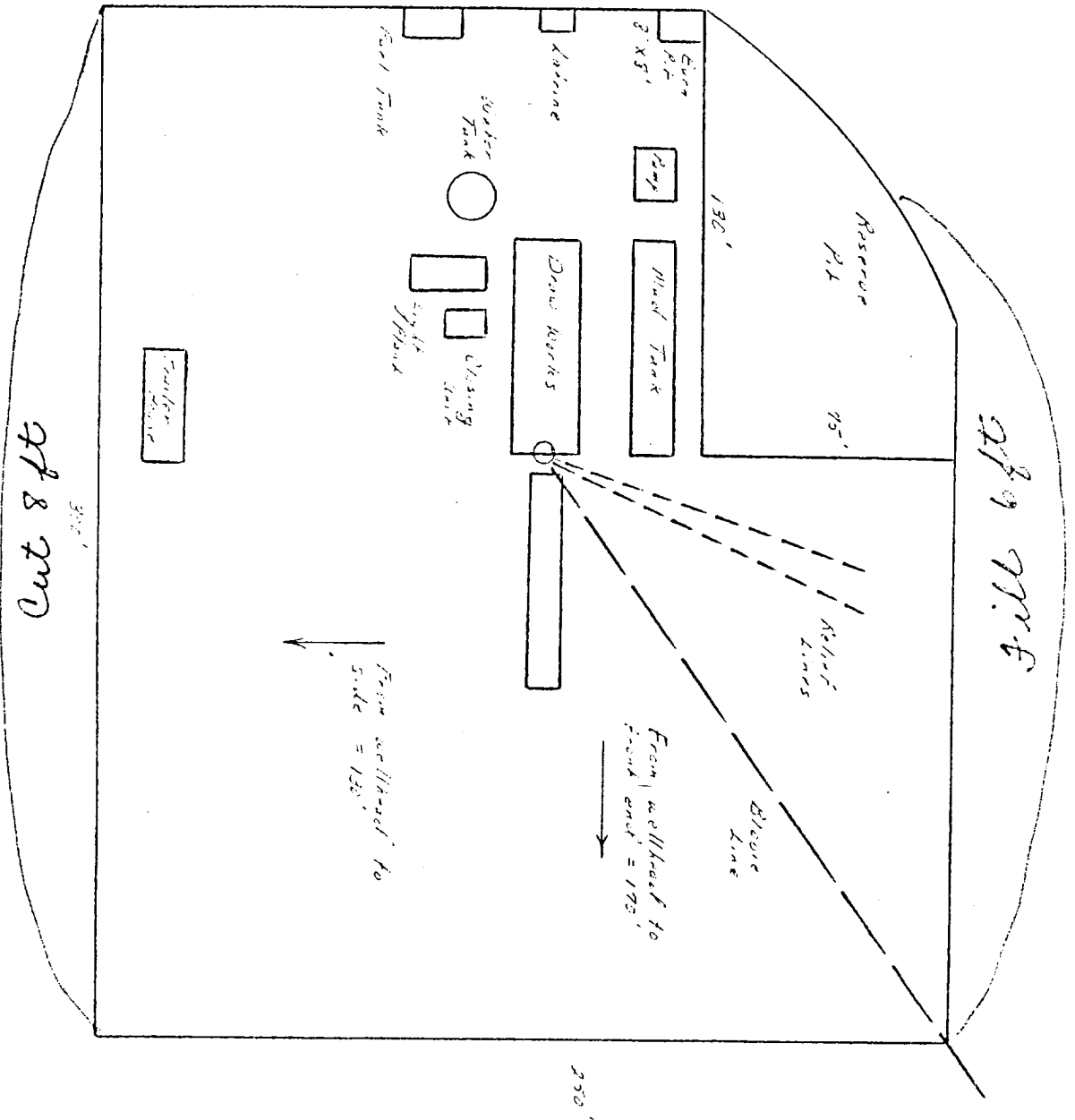

Typical R.O.P. Installation
for Mesa Verde Well

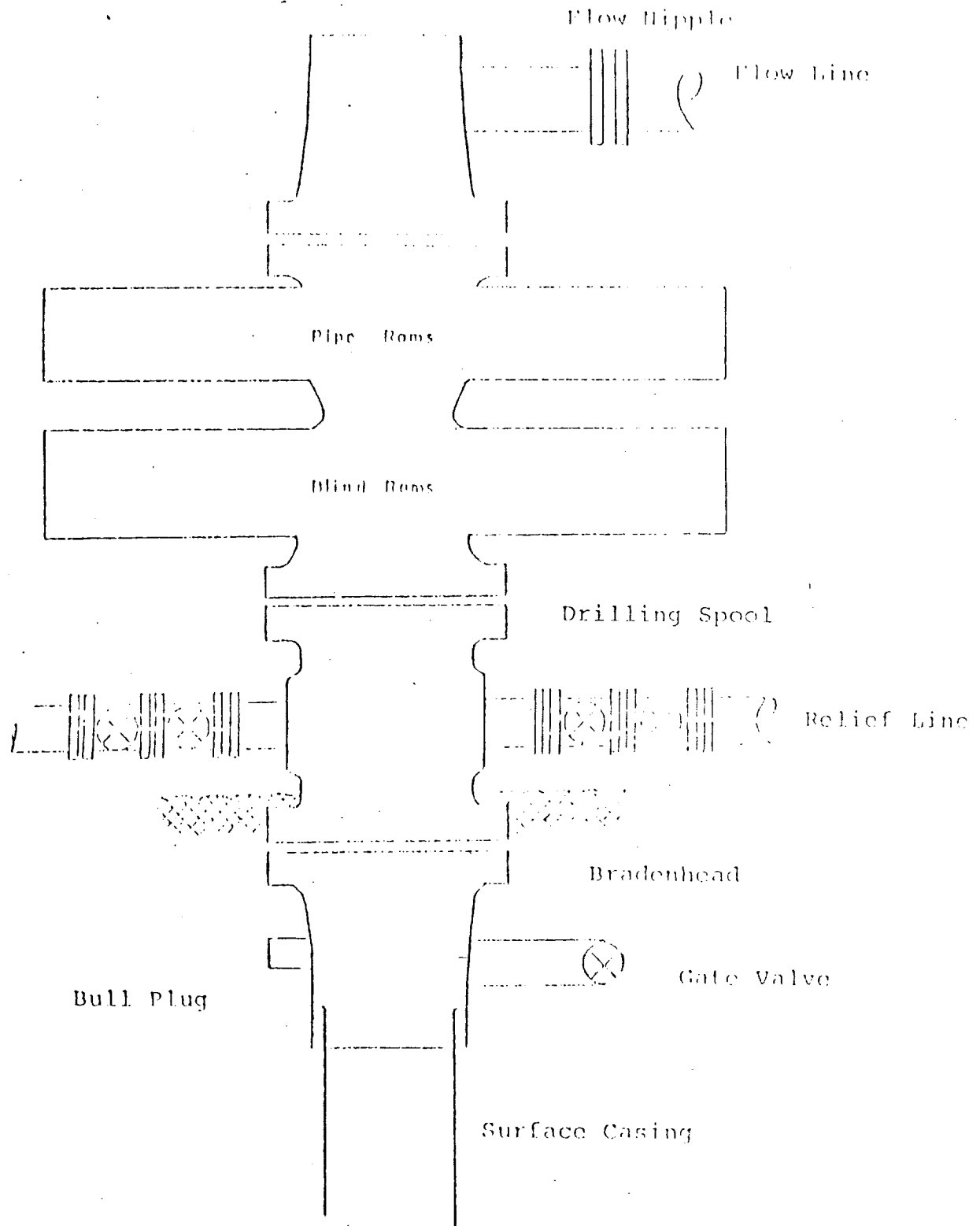

Series 900 Double Gate ROP, rated
at 3000 psi Working Pressure
When gas drilling operations begin a Shaffer type 50
or equivalent rotating head is installed on top of the
flow nipple and the flow line is converted into a blowie line

EL PASO NATURAL GAS COMPANY

San Juan 32-9 Unit #17A

SENW --31-9

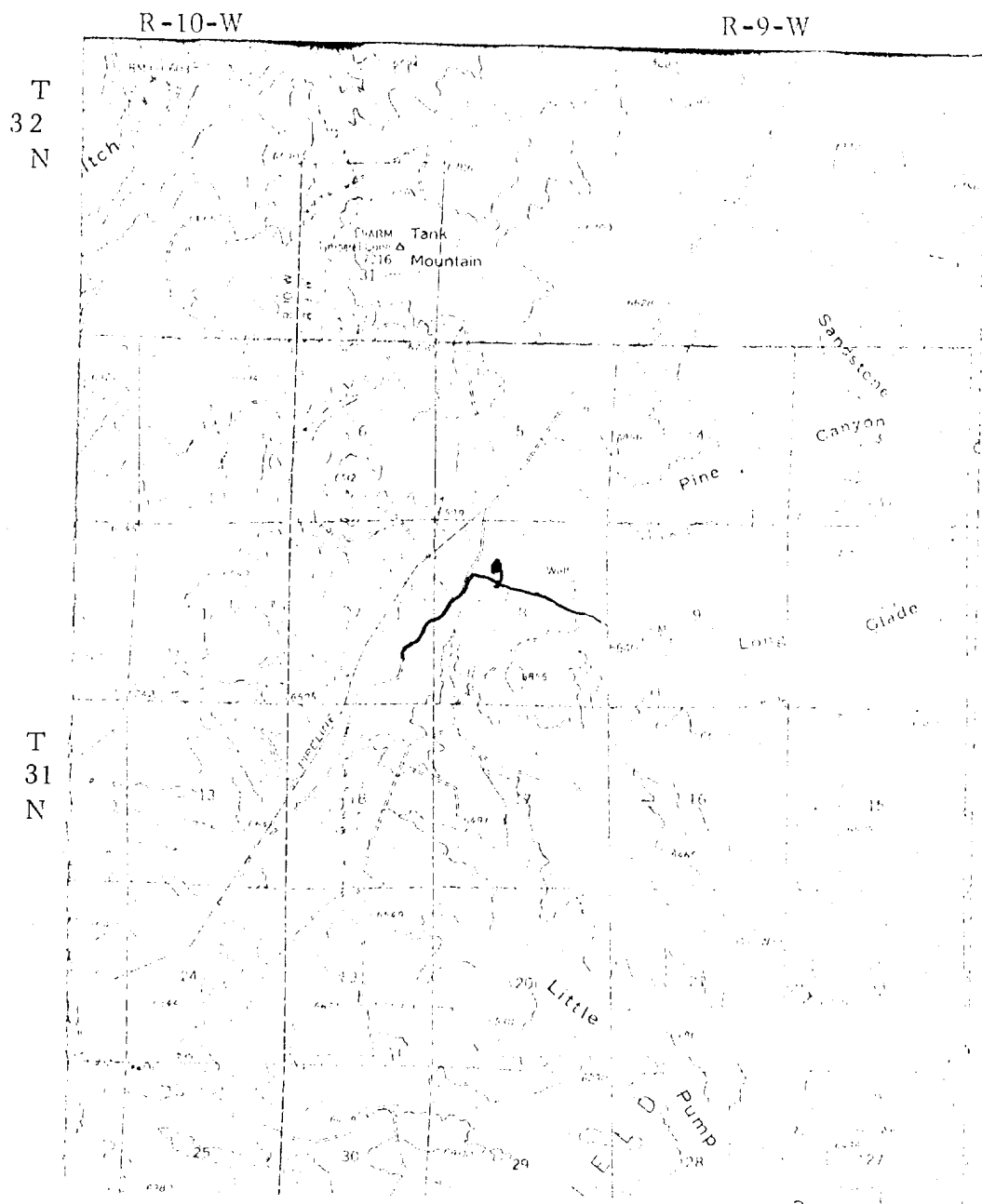

MAP #1

LEGEND OF MAP #1

EXISTING ROADS	—————
EXISTING PIPELINES	-+ -+ -+
EXISTING DITCHES	- - - - -
PROPOSED ROADS	—————
PROPOSED PIPELINES	+ + + + +
PROPOSED DITCHES	+ + + + +

EL PASO NATURAL GAS COMPANY

San Juan 32-9 Unit #17A

SENW -31-9

R 9 W

T
31
N

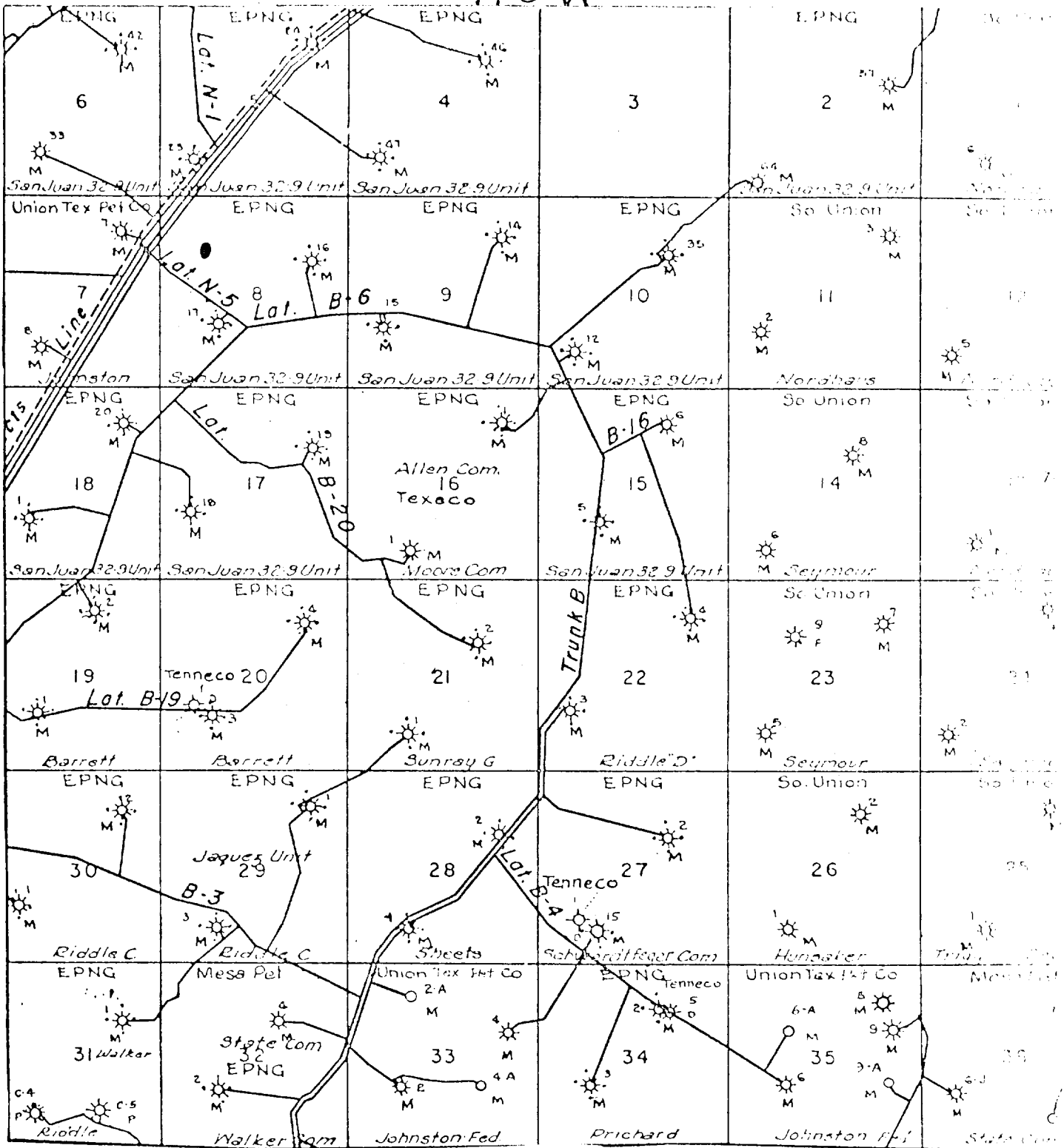

MAP #2

Proposed Location

UNITED STATES
DEPARTMENT OF THE INTERIOR
GEOLOGICAL SURVEY

SUNDRY NOTICES AND REPORTS ON WELLS

(Do not use this form for proposals to drill or to deepen or plug back to a different reservoir. Use Form 9-331-C for such proposals.)

1. oil well ☐ gas well ☒ other ☐
2. NAME OF OPERATOR
EL PASO NATURAL GAS COMPANY
3. ADDRESS OF OPERATOR
Box 990, Farmington, New Mexico 87401
4. LOCATION OF WELL (REPORT LOCATION CLEARLY. See space 17 below.)
1500'N, 1600'W
AT SURFACE:
AT TOP PROD. INTERVAL:
AT TOTAL DEPTH:

16. CHECK APPROPRIATE BOX TO INDICATE NATURE OF NOTICE, REPORT, OR OTHER DATA

REQUEST FOR APPROVAL TO:		SUBSEQUENT REPORT OF:
TEST WATER SHUT-OFF	<input type="checkbox"/>	<input checked="" type="checkbox"/>
FRACTURE TREAT	<input type="checkbox"/>	<input type="checkbox"/>
SHOOT OR ACIDIZE	<input type="checkbox"/>	<input type="checkbox"/>
REPAIR WELL	<input type="checkbox"/>	<input type="checkbox"/>
PULL OR ALTER CASING	<input type="checkbox"/>	<input type="checkbox"/>
MULTIPLE COMPLETE	<input type="checkbox"/>	<input type="checkbox"/>
CHANGE ZONES	<input type="checkbox"/>	<input type="checkbox"/>
ABANDON*	<input type="checkbox"/>	<input type="checkbox"/>
(other)		

17. DESCRIBE PROPOSED OR COMPLETED OPERATIONS (Clearly state all pertinent details, and give pertinent dates, including estimated date of starting any proposed work. If well is directionally drilled, give subsurface locations and measured and true vertical depths for all markers and zones pertinent to this work.)*

7-29-78 Spudded well. Drilled surface hole. Ran 5 joints 9 5/8", 36# K-55 surface casing, 211' set at 225'. Cemented with 224 cu. ft. cement. Circulated to surface. WOC 12 hours; held 600#/30 minutes.

Subsurface Safety Valve: Manu. and Type _____ Set @ _____ Ft.

18. I hereby certify that the foregoing is true and correct

SIGNED N. D. Buices TITLE Drilling Clerk DATE 8/1/78

(This space for Federal or State office use)

APPROVED BY _____ TITLE _____ DATE _____
CONDITIONS OF APPROVAL, IF ANY:

5. LEASE
SF 078438
6. IF INDIAN, ALLOTTEE OR TRIBE NAME
7. UNIT AGREEMENT NAME
San Juan 32-9 Unit
8. FARM OR LEASE NAME
San Juan 32-9 Unit
9. WELL NO.
17 A
10. FIELD OR WILDCAT NAME
Blanco M.V.
11. SEC., T., R., M., OR BLK. AND SURVEY OR AREA
Sec. 8, T-31-N, R-9-W
N.M.P.M.
12. COUNTY OR PARISH
San Juan
13. STATE
New Mexico
14. API NO.
15. ELEVATIONS (SHOW DF, KDB, AND WD)
6695' GL

(NOTE: Report results of multiple completion or zone change on Form 9-330.)

UNITED STATES
DEPARTMENT OF THE INTERIOR
GEOLOGICAL SURVEY

SUNDRY NOTICES AND REPORTS ON WELLS

(Do not use this form for proposals to drill or to deepen or plug back to a different reservoir. Use Form 9-331-C for such proposals.)

1. oil ☐ gas ☒ other ☐
well well

2. NAME OF OPERATOR
EL PASO NATURAL GAS CO.

3. ADDRESS OF OPERATOR
BOX 289, FARMINGTON, NEW MEXICO

4. LOCATION OF WELL (REPORT LOCATION CLEARLY. See space 17 below.)
AT SURFACE: 1500'N, 1600'W
AT TOP PROD. INTERVAL:
AT TOTAL DEPTH:

16. CHECK APPROPRIATE BOX TO INDICATE NATURE OF NOTICE, REPORT, OR OTHER DATA

REQUEST FOR APPROVAL TO: SUBSEQUENT REPORT OF:

TEST WATER SHUT-OFF	<input type="checkbox"/>	<input checked="" type="checkbox"/>
FRACTURE TREAT	<input type="checkbox"/>	<input checked="" type="checkbox"/>
SHOOT OR ACIDIZE	<input type="checkbox"/>	<input type="checkbox"/>
REPAIR WELL	<input type="checkbox"/>	<input type="checkbox"/>
PULL OR ALTER CASING	<input type="checkbox"/>	<input type="checkbox"/>
MULTIPLE COMPLETE	<input type="checkbox"/>	<input type="checkbox"/>
CHANGE ZONES	<input type="checkbox"/>	<input type="checkbox"/>
ABANDON*	<input type="checkbox"/>	<input type="checkbox"/>
(other)		

5. LEASE

SF 078438

6. IF INDIAN, ALLOTTEE OR TRIBE NAME

7. UNIT AGREEMENT NAME

San Juan 32-9 Unit

8. FARM OR LEASE NAME

San Juan 32-9 Unit

9. WELL NO.

17A

10. FIELD OR WILDCAT NAME

Blanco M.V.

11. SEC., T., R., M., OR BLK. AND SURVEY OR AREA Sec. 8, T-31-N, R-9-W

NMPM

12. COUNTY OR PARISH

San Juan

13. STATE

New Mexico

14. API NO.

15. ELEVATIONS (SHOW DF, KDB, AND WD)

6695' GL

(NOTE: Report results of multiple completion or zone change on Form 9-330.)

17. DESCRIBE PROPOSED OR COMPLETED OPERATIONS (Clearly state all pertinent details, and give pertinent dates, including estimated date of starting any proposed work. If well is directionally drilled, give subsurface locations and measured and true vertical depths for all markers and zones pertinent to this work.)*

8/6/78: T.D. 3980'. Ran 104 joints 7", 20# KS intermediate casing, 3968' set at 3980'. Cemented with 442 cu. ft. cement. WOC 12 hours; held 1200#/30 minutes. Top of cement at 2300'.

8/11/78: T.D. 6230'. Ran 56 joints 4 1/2", 10.5#, K-55 casing liner, 2415' set 3815-6230'. Float collar set at 6211'. Cemented with 417 cu. ft. cement. WOC 18 hours.

10/7/78: PBTD 6211'. Tested casing to 3500#, OK. Perfed C.H. and Men. 5128, 5341, 5431, 5439, 5445, 5466, 5474, 5484, 5489, 5500, 5507, 5512, 5561, 5568, 5592, with 1 SPZ. Fraced w/47,000# 20/40 sand and 53,870 gal. water. Flushed w/7610 gal. water. Perfed Mass. P.L. 5809, 5814, 5823, 5828, 5850, 5854 (OVER)

Subsurface Safety Valve: Manu. and Type _____ Set @ _____ Ft.

18. I hereby certify that the foregoing is true and correct

SIGNED A. G. Lucas TITLE Drilling Clerk DATE 10/17/78

(This space for Federal or State office use)

APPROVED BY _____ TITLE _____ DATE _____
CONDITIONS OF APPROVAL, IF ANY:

*See Instructions on Reverse Side

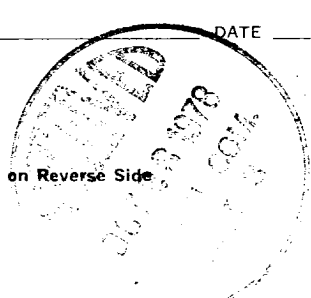

RECEIVED

OCT 20 1978

GEOLOGICAL SURVEY

Instructions

General: This form is designed for submitting proposals to perform certain well operations, and reports of such operations when completed, as indicated, on Federal and Indian lands pursuant to applicable Federal law and regulations, and, if approved or accepted by any State, on all lands in such State, pursuant to applicable State law and regulations. Any necessary special instructions concerning the use of this form and the number of copies to be submitted, particularly with regard to local, area, or regional procedures and practices, either are shown below or will be issued by, or may be obtained from, the local Federal and/or State office.

Item 4: If there are no applicable State requirements, locations on Federal or Indian land should be described in accordance with Federal requirements. Consult local State or Federal office for specific instructions.

Item 17: Proposals to abandon a well and subsequent reports of abandonment should include such special information as is required by local Federal and/or State offices. In addition, such proposals and reports should include reasons for the abandonment; data on any former or present productive zones, or other zones with present significant fluid contents not sealed off by cement or otherwise; depths (top and bottom) and method of placement of cement plugs; mud or other material placed below, between and above plugs; amount, size, method of parting of any casing, liner or tubing pulled and the depth to top of any left in the hole; method of closing top of well; and date well site conditioned for final inspection looking to approval of the abandonment.

5861, 5564, 5873, 5887, 5899, 5913, 5917, 5929,
5941, 5973 w/1 SPZ. Fraced w/45,000# 20/40 sand
and 50,790 gal. water. Flushed w/7940 gal.
water. Perfed Lower PL 6006, 6019, 6032, 6047, 6070,
6084, 6101, 6119, 6155, 6179 with 1 SPZ. Fraced
w/45,000# 20/40 sand and 58,120 gal. water.
Flushed w/7700 gal. water.