

NO. OF COPIES RECEIVED	7
DISTRIBUTION	
SANTA FE	1
FILE	1
U.S.G.S.	3
LAND OFFICE	1
OPERATOR	2

NEW MEXICO OIL CONSERVATION COMMISSION

30-045-23311
Form C-101
Revised 1-1-65

5A. Indicate Type of Lease	
STATE <input checked="" type="checkbox"/>	FEE <input type="checkbox"/>
5. State Oil & Gas Lease No.	

APPLICATION FOR PERMIT TO DRILL, DEEPEN, OR PLUG BACK

1a. Type of Work		7. Unit Agreement Name	
b. Type of Well DRILL <input checked="" type="checkbox"/> DEEPEN <input type="checkbox"/> PLUG BACK <input type="checkbox"/> OIL WELL <input type="checkbox"/> GAS WELL <input checked="" type="checkbox"/> OTHER <input type="checkbox"/> SINGLE ZONE <input checked="" type="checkbox"/> MULTIPLE ZONE <input type="checkbox"/>		8. Farm or Lease Name Zachry Com	
2. Name of Operator Southland Royalty Company		9. Well No. 1A	
3. Address of Operator P. O. Drawer 570, Farmington, New Mexico 87401		10. Field and Pool, or Wildcat Blanco Mesaverde	
4. Location of Well UNIT LETTER C LOCATED 990 FEET FROM THE North LINE AND 1630 FEET FROM THE West LINE OF SEC. 2 TWP. 30N RGE. 12W NMPM		12. County San Juan	
19. Proposed Depth 4927'		19A. Formation Mesaverde	20. Rotary or C.T. Rotary
21. Elevations (Show whether DF, RT, etc.) 5905' GR	21A. Kind & Status Plug. Bond	21B. Drilling Contractor	22. Approx. Date Work will start 1-15-79

23.

PROPOSED CASING AND CEMENT PROGRAM

SIZE OF HOLE	SIZE OF CASING	WEIGHT PER FOOT	SETTING DEPTH	SACKS OF CEMENT	EST. TOP
12-1/4"	9-5/8"	36#	200'	125 cu. ft	Circ. to surface
8-3/4"	7"	20#	2517'	291 cu. ft	Cover Ojo Alamo
6-1/4"	4-1/2"	10.5#	2367'-4927'	447 cu. ft	Liner top

Surface formation is Nacimiento.

Top of Ojo Alamo sand is at 1227'.

Top of Pictured Cliffs sand is at 2267'.

Fresh water mud will be used to drill from surface to intermediate casing point.

An air system will be used to drill from intermediate casing point to total depth.

It is anticipated that a GR-Induction and a GR-Density log will be run at total depth.

No abnormal pressures or poisonous gases are anticipated in this well.

It is expected that this well will be drilled before April 15, 1979. This depends on time required for approvals, rig availability and the weather.

Gas is dedicated.

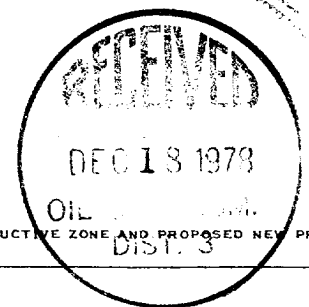

IN ABOVE SPACE DESCRIBE PROPOSED PROGRAM: IF PROPOSAL IS TO DEEPEN OR PLUG BACK, GIVE DATA ON PRESENT PRODUCTIVE ZONE AND PROPOSED NEW PRODUCTIVE ZONE. GIVE BLOWOUT PREVENTER PROGRAM, IF ANY.

I hereby certify that the information above is true and complete to the best of my knowledge and belief.

Signed Frank T. Chavez Title District Production Manager Date December 14, 1978

(This space for State Use)

Original Signed by FRANK T. CHAVEZ

DEPUTY OIL & GAS INSPECTOR, DIST. #3

APPROVED BY _____ TITLE _____ DATE DEC 18 1978

CONDITIONS OF APPROVAL, IF ANY:

NEW MEXICO OIL CONSERVATION COMMISSION
WELL LOCATION AND ACREAGE DEDICATION PLAT

Form C-102
Supersedes C-128
Effective 1-1-65

All distances must be from the outer boundaries of the Section.

Operator SOUTHLAND ROYALTY COMPANY			Lease ZACHRY Com.		Well No. 1A
Unit Letter C	Section 2	Township 30N	Range 12W	County San Juan	
Actual Footage Location of Well: 990 feet from the North line and 1630 feet from the West line					
Ground Level Elev. 5905 Gr	Producing Formation Mesa Verde		Pool Blanco		Dedicated Acreage: 318.60 Acres

1. Outline the acreage dedicated to the subject well by colored pencil or hachure marks on the plat below.
2. If more than one lease is dedicated to the well, outline each and identify the ownership thereof (both as to working interest and royalty).
3. If more than one lease of different ownership is dedicated to the well, have the interests of all owners been consolidated by communitization, unitization, force-pooling, etc?

☐ Yes ☐ No If answer is "yes," type of consolidation _____

If answer is "no," list the owners and tract descriptions which have actually been consolidated. (Use reverse side of this form if necessary.) _____

No allowable will be assigned to the well until all interests have been consolidated (by communitization, unitization, forced-pooling, or otherwise) or until a non-standard unit, eliminating such interests, has been approved by the Commission.

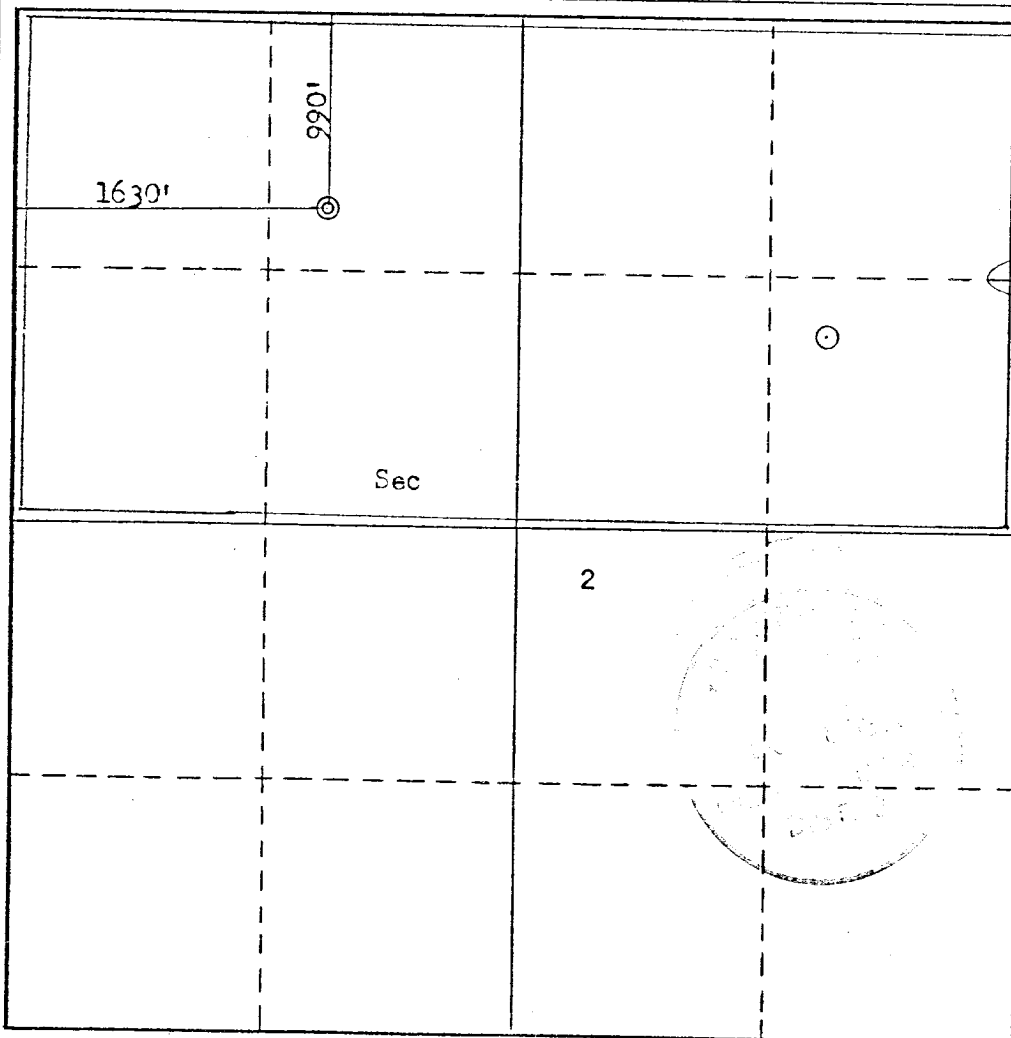

CERTIFICATION

I hereby certify that the information contained herein is true and complete to the best of my knowledge and belief.

Name _____
Position
Dist. Production Manager
Company
Southland Royalty Company

Date
December 15, 1978

I hereby certify that the well location shown on this plat was plotted from field notes of actual surveys made by me or under my supervision, and that the same is true and correct to the best of my knowledge and belief.

Date Surveyed
November 8, 1978

Registered Professional Engineer
and/or Land Surveyor

Fred B. Kerr Jr.

Certificate No. _____



Southland Royalty Company

December 15, 1978

Oil Conservation Division
1000 Rio Brazos Road
Aztec, New Mexico 87410

Attention: Mr. Al Kendrick

Dear Sir:

All drilling and completion rigs will be equipped with 6" or larger double gate hydraulic blowout preventers and a hydraulic operated closing unit with steel lines.

The preventer is 3000# working pressure and 6000# test.

All crews will be thoroughly trained in the operation of this preventer. The preventer will be tested frequently enough to insure safe operation.

Yours truly,

L. O. Van Ryan
District Production Manager

LOVR/dg