

District I
P.O. Box 100
Santa Fe, New Mexico 87505
District II
P.O. Box 100
Santa Fe, New Mexico 87505
District III
1000 Rio Brazos Rd. Aztec, NM 87410

Samuel E. Faust
DEPUTY OIL & GAS INSPECTOR

State of New Mexico
Energy, Minerals and Natural Resources Department

OIL CONSERVATION DIVISION

2040 South Pacheco Street
Santa Fe, New Mexico 87505

SUBMIT 1 COPY TO
APPROPRIATE
DISTRICT OFFICE
AND 1 COPY TO
SANTA FE OFFICE

FEB 28 1997

PIT REMEDIATION AND CLOSURE REPORT

RECEIVED
OCT 1 1996

OIL & GAS DIV
4-11-96

Operator: PNM Gas Services (Meridian) **Telephone:** 324-3764

Address: 603 W. Elm Street Farmington, NM 87401

Facility or Well Name: Hampton #5

Location: Unit: C Sec. 13 T. 30 N R. 11 W County San Juan

Pit Type: Separator Dehydrator ☒ Other

Land Type: BLM ☒ State Fee Other

Pit Location: Pit dimensions: length 20 width 20 depth 4

(Attach diagram) Reference: wellhead ☒ other

Footage from reference: 106'

Direction from reference: 45 Degrees ☒ East North

 West South ☒

Depth to Ground Water:

Less than 50 feet	(20 points)	
50 feet to 99 feet	(10 points)	
Greater than 100 feet	(0 points)	<u>0</u>

(Vertical distance from contaminants to seasonal high water elevation of ground water)

Wellhead Protection Area:

Yes	(20 points)	
No	(0 points)	<u>0</u>

(Less than 200 feet from a private domestic water source, or, less than 1,000 feet from all other water sources)

Distance to Surface Water:

Less than 200 feet	(20 points)	
200 feet to 1,000 feet	(10 points)	
Greater than 1,000 feet	(0 points)	<u>0</u>

(Horizontal distance to perennial lakes, ponds, rivers, streams, creeks, irrigation canals and ditches)

RANKING SCORE (TOTAL POINTS): 0

Date Remediation Started:

4/22/96

Date Completed:

4/22/96

Remediation Method:

Excavation

☒

Approx. Cubic Yard

341

(Check all appropriate sections)

Landfarmed

☒

Amount Landfarmed (cubic yds)

341

Other

Remediation Location:

Onsite

☒

Offsite

(i.e., landfarmed onsite, name and location of offsite facility)

Backfill Material Location:

General Description of Remedial Action:

Excavated contaminated soil and landfarmed onsite within a bermed area at a depth of 6" to 12". Soil was aerated by plowing/disking until soil meets regulatory levels.

Ground Water Encountered:

No

☒

Yes

Depth

Final Pit Closure Sampling:

Sample Location

5 pt. composite-4 side walls and center of pit bottom

(if multiple samples, attach sample result and diagram of sample locations and depths.)

Sample depth

14'

Sample date

4/22/96

Sample time

1:30:00 PM

Sample Results

Benzene (ppm)

0.0026

Total BTEX (ppm)

0.0224

Field headspace (ppm)

TPH

< 5.00

Method

8015A

Vertical Extent (ft)

Risk Assessment form attached

Yes

No

☒

Ground Water Sample:

Yes

No

☒

(If yes, attach sample results)

I HEREBY CERTIFY THAT THE INFORMATION ABOVE IS TRUE AND COMPLETE TO THE BEST OF MY KNOWLEDGE AND MY BELIEF

DATE

October 25, 1996

PRINTED NAME

Maureen Gannon

SIGNATURE

Maureen Gannon

AND TITLE

Environmental Engineer

Hampton #5

4-22-96

Meridian Oil

Sec. 13, T30N, R11W, Unit "C"

Run # 10-42

45° East of South

excavated 341 yds.

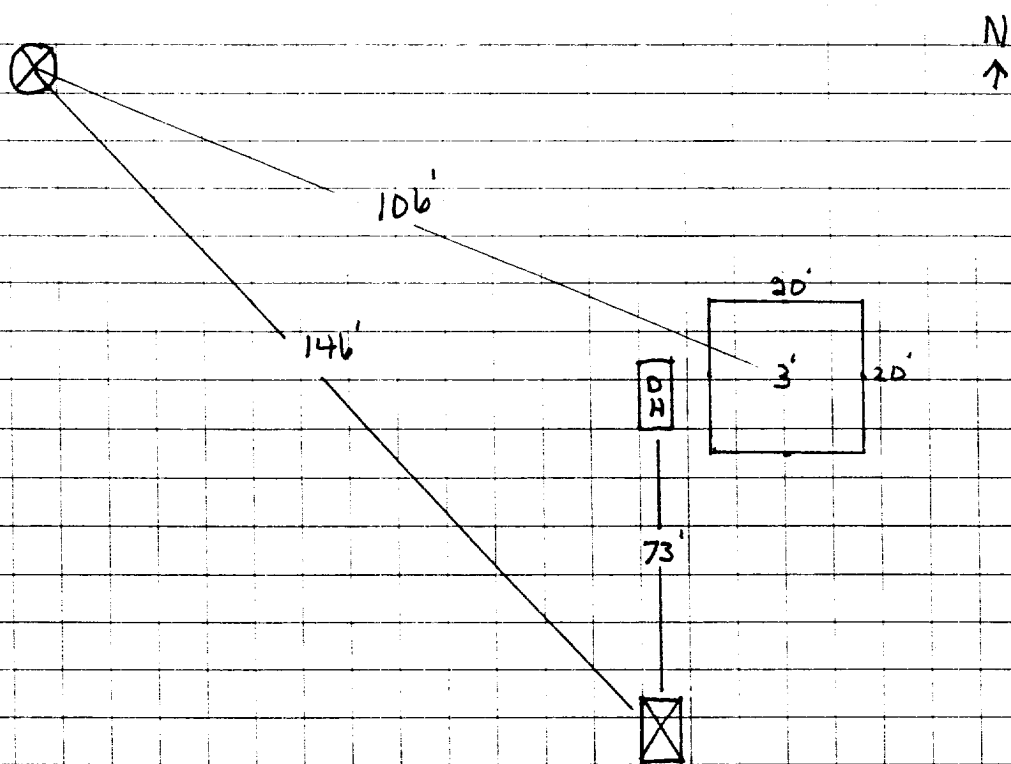

OFF: (505) 325-8786



LAB: (505) 325-5667

Diesel Range Organics EPA 8015-Modified

Attn: *Denver Bearden*
Company: *PNM Gas Services*
Address: *603 W. Elm*
City, State: *Farmington, NM 87401*

Date: *25-Apr-96*
COC No.: *4611*
Sample No. *10705*
Job No. *2-1000*

Project Name: ***PNM Gas Services - Hampton #5***
Project Location: ***9604221330; 5pt. Composite, 4 Walls & Bottom, 14'***
Sampled by: GC Date: *22-Apr-96* Time: *13:30*
Analyzed by: DC Date: *24-Apr-96*
Sample Matrix: *Soil*

Laboratory Analysis

<i>Analyte</i>	<i>Result</i>	<i>Unit of Measure</i>	<i>Detection Limit</i>	<i>Unit of Measure</i>
<i>Diesel Range Organics (C10 - C28)</i>	<i><5.0</i>	<i>mg/kg</i>	<i>5.0</i>	<i>mg/kg</i>

Quality Assurance Report

DRO QC No.: *0446-STD*

Calibration Check

<i>Analyte</i>	<i>Method Blank</i>	<i>Unit of Measure</i>	<i>True Value</i>	<i>Analyzed Value</i>	<i>% Diff</i>	<i>Limit</i>
<i>Diesel Range (C10 - C28)</i>	<i><5</i>	<i>ppm</i>	<i>2,000</i>	<i>2,038</i>	<i>1.9</i>	<i>15%</i>

Matrix Spike

<i>Analyte</i>	<i>1 - Percent Recovered</i>	<i>2 - Percent Recovered</i>	<i>Limit</i>	<i>%RSD</i>	<i>Limit</i>
<i>Diesel Range (C10-C28)</i>	<i>101</i>	<i>101</i>	<i>(70-130)</i>	<i>0</i>	<i>20%</i>

Method - SW-846 EPA Method 8015A mod. - Nonhalogenated Volatile Hydrocarbons by Gas Chromatography

Approved by: 
Date: *4/25/96*

P. O. BOX 2606 • FARMINGTON, NM 87499

- TECHNOLOGY BLENDING INDUSTRY WITH THE ENVIRONMENT -

OFF: (505) 325-8786



LAB: (505) 325-5667

AROMATIC VOLATILE ORGANICS

Attn: *Denver Bearden*
Company: *PNM Gas Services*
Address: *603 W. Elm*
City, State: *Farmington, NM 87401*

Date: *25-Apr-96*
COC No.: *4611*
Sample No.: *10705*
Job No.: *2-1000*

Project Name: *PNM Gas Services - Hampton #5*
Project Location: *9604221330; 5pt. Composite, 4 Walls & Bottom, 14'*
Sampled by: *GC* Date: *22-Apr-96* Time: *13:30*
Analyzed by: *DC* Date: *24-Apr-96*
Type of Sample: *Soil*

Aromatic Volatile Organics

Component	Result	Units of Measure	Detection Limit	Units of Measure
<i>Benzene</i>	<i>2.6</i>	<i>ug/kg</i>	<i>0.2</i>	<i>ug/kg</i>
<i>Toluene</i>	<i>7.7</i>	<i>ug/kg</i>	<i>0.2</i>	<i>ug/kg</i>
<i>Ethylbenzene</i>	<i>1.2</i>	<i>ug/kg</i>	<i>0.2</i>	<i>ug/kg</i>
<i>m,p-Xylene</i>	<i>8.8</i>	<i>ug/kg</i>	<i>0.2</i>	<i>ug/kg</i>
<i>o-Xylene</i>	<i>2.2</i>	<i>ug/kg</i>	<i>0.2</i>	<i>ug/kg</i>
	<i>TOTAL</i>	<i>22.4</i>		<i>ug/kg</i>

Method - SW-846 EPA Method 8020 Aromatic Volatile Organics by Gas Chromatography

Approved by: *[Signature]*
Date: *4/25/96*

P. O. BOX 2606 • FARMINGTON, NM 87499

— TECHNOLOGY BLENDING INDUSTRY WITH THE ENVIRONMENT —

Hampton #5 Landfarm

7-2-96

Composite Sample # 9602021355

Soil Vapor Reading 9.4

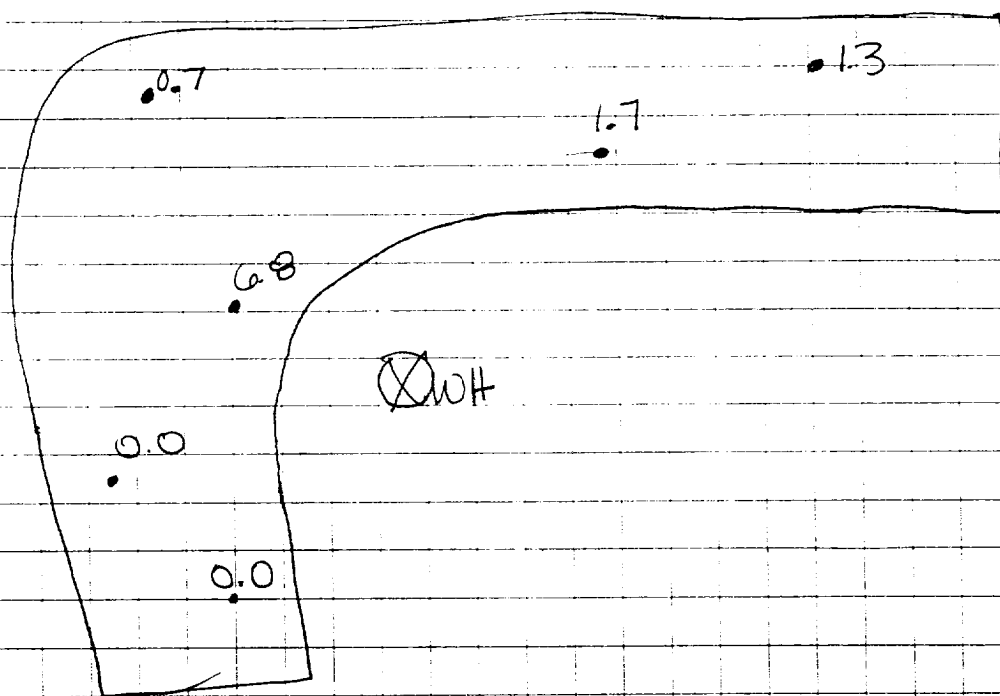

Sampling Depth - 2" - 12" deep

OFF: (505) 325-5667



LAB: (505) 325-1556

Diesel Range Organics

Attn: *Denver Bearden*
Company: *PNM Gas Services*
Address: *603 W. Elm*
City, State: *Farmington, NM 87401*

Date: *10-Jul-96*
COC No.: *4897*
Sample No. *11393*
Job No. *2-1000*

Project Name: *PNM Gas Services - Hampton #5 Landfarm*
Project Location: *9607021355; 6pt. Composite, 2"-12" deep*
Sampled by: *GC* Date: *2-Jul-96* Time: *13:55*
Analyzed by: *DC* Date: *9-Jul-96*
Sample Matrix: *Soil*

Laboratory Analysis

<i>Parameter</i>	<i>Result</i>	<i>Unit of Measure</i>	<i>Detection Limit</i>	<i>Unit of Measure</i>
<i>Diesel Range Organics (C10 - C28)</i>	<i><5.0</i>	<i>mg/kg</i>	<i>5.0</i>	<i>mg/kg</i>

Quality Assurance Report

DRO QC No.: 0475-QC

Calibration Check

<i>Parameter</i>	<i>Method Blank</i>	<i>Unit of Measure</i>	<i>True Value</i>	<i>Analyzed Value</i>	<i>% Diff</i>	<i>Limit</i>
<i>Diesel Range (C10 - C28)</i>	<i><5.0</i>	<i>ppm</i>	<i>2,000</i>	<i>1,960</i>	<i>2.0</i>	<i>15%</i>

Matrix Spike

<i>Parameter</i>	<i>1- Percent Recovered</i>	<i>2- Percent Recovered</i>	<i>Limit</i>	<i>%RSD</i>	<i>Limit</i>
<i>Diesel Range (C10-C28)</i>	<i>117</i>	<i>112</i>	<i>(70-130)</i>	<i>3</i>	<i>20%</i>

Method - SW-846 EPA Method 8015A mod. - Nonhalogenated Volatile Hydrocarbons by Gas Chromatography

Approved by: *[Signature]*
Date: *7/10/96*

P.O. BOX 2606 • FARMINGTON, NM 87499

- TECHNOLOGY BLENDING INDUSTRY WITH THE ENVIRONMENT -