

OIL CONSERVATION COMMISSION
Albuquerque DISTRICT

OIL CONSERVATION COMMISSION
BOX 2088
SANTA FE, NEW MEXICO

DATE April 28, 1980

RE: Proposed MC _____
Proposed DHC _____
Proposed NSL a _____
Proposed SWD _____
Proposed WFX _____
Proposed PMX _____

Gentlemen:

I have examined the application dated April 28, 1980
for the Manana Gas Inc. Mary Ankeroyd #1 5-18-340-11W
Operator Lease and Well No. Unit, S-T-R

and my recommendations are as follows:

Approve

Yours very truly,

Frank S. Chavez

Manana Gas, Inc.

P. O. BOX 145

FARMINGTON, NEW MEXICO 87401

ED HARTMAN, PRES.

TEL. (505) 325-3066

April 25, 1980

Mr. Joe D. Ramey
Oil Conservation Division
P.O. Box 2088
Santa Fe, New Mexico 87501

RE: Application for Non-Standard Location
Manana Gas, Inc. Mary Ackroyd #1
1810' FSL, 1330' FEL, Section 18, T30N, R11W,
San Juan County, New Mexico
Aztec-Farmington Pool

Dear Mr. Ramey:

We hereby request an administrative order approving the non-standard location of the subject well in the Farmington Formation due to topographical conditions.

Administrative Order NSL-1016 granted approval of this location for a Pictured Cliffs well on March 27, 1979.

This well did not penetrate the Pictured Cliffs Formation due to mechanical problems. It has now been completed as a Farmington Gas well.

Enclosed are copies of the original application for your convenience.

Copies of this application are being mailed to all offset operators shown on the Pictured Cliffs ownership plat by Certified Mail this date. There are no offset Farmington wells.

Very truly yours,

Manana Gas, Inc.

By Ed Kendrick
Vice President

Encls:



CURTIS J. LITTLE
PETROLEUM GEOLOGIST
TELEPHONE (505) 327-6176
POST OFFICE BOX 2487
PETROLEUM PLAZA SUITE 150
FARMINGTON, NEW MEXICO 87401

March 5, 1979

Joe D. Ramey, Director
Oil Conservation Division
State of New Mexico
P. O. Box 2088
Santa Fe, New Mexico 87501

APPLICATION FOR ADMINISTRATIVE APPROVAL - UNORTHODOX LOCATION
Aztec Pictured Cliffs Gas Field 1810'FSL/1330'FEL
Section 18-T30N-R11W, San Juan County, New Mexico

Gentlemen:

Enclosed are triplicate plats showing ownership of all lessees and Pictured Cliffs wells offsetting our proration unit and a survey plat of the proposed location.

Approval for this unorthodox location is requested because: (1) After many months of negotiation with Mr. Joe B. Gillentine, owner of the E/2 SE/4 surface rights, a legal location in the NESE has been abandoned with our belief as to the impossibility of ever gaining access to the drillsite, and (2) Mr. Sherman Emery's land upon which the proposed drillsite is located is all irrigated and cultivated, Mr. Emery desires to to have the wellhead NOT more than 10 feet into his field from his fenceline road; therefore, the necessity of drilling 1330' FEL rather than the legal 1450'FEL.

By copy of this letter we request all offsetting owners notify you of their approval or disapproval of this request.

Very truly yours,

MANANA GAS, INC.

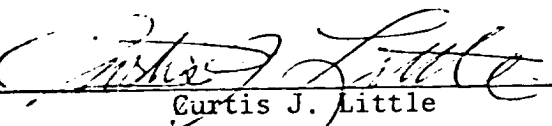
By 
Curtis J. Little

cc W/encls:
OCC Office, Aztec
Brad Keyes, Aztec
W. P. Carr, Dallas, Texas
EPNG, Farmington
Koch Exploration, Wichita, Kansas



WELL LOCATION AND ACREAGE DEDICATION PLAT

Effective 1-1-55

5

All distances must be from the outer boundaries of the Section.

MANANA GAS, INC.		Lease Mary Ackroyd		Well No. 1
Well Letter J	Section 18	Township 30 NORTH	Range 11 WEST	County SAN JUAN

Actual Footage Location of Well:

1810	feet from the	SOUTH	line and	1330	feet from the	EAST	line
Ground Level Elev. 5669	Producing Formation Pictured Cliffs		Pool Aztec Pictured Cliffs		Dedicated Acreage: 160 Acres		

1. Outline the acreage dedicated to the subject well by colored pencil or hachure marks on the plat below.
2. If more than one lease is dedicated to the well, outline each and identify the ownership thereof (both as to working interest and royalty).
3. If more than one lease of different ownership is dedicated to the well, have the interests of all owners been consolidated by communitization, unitization, force-pooling, etc?

☒ Yes ☐ No If answer is "yes," type of consolidation Communitization

If answer is "no," list the owners and tract descriptions which have actually been consolidated. (Use reverse side of this form if necessary.)

No allowable will be assigned to the well until all interests have been consolidated (by communitization, unitization, forced-pooling, or otherwise) or until a non-standard unit, eliminating such interests, has been approved by the Commission.

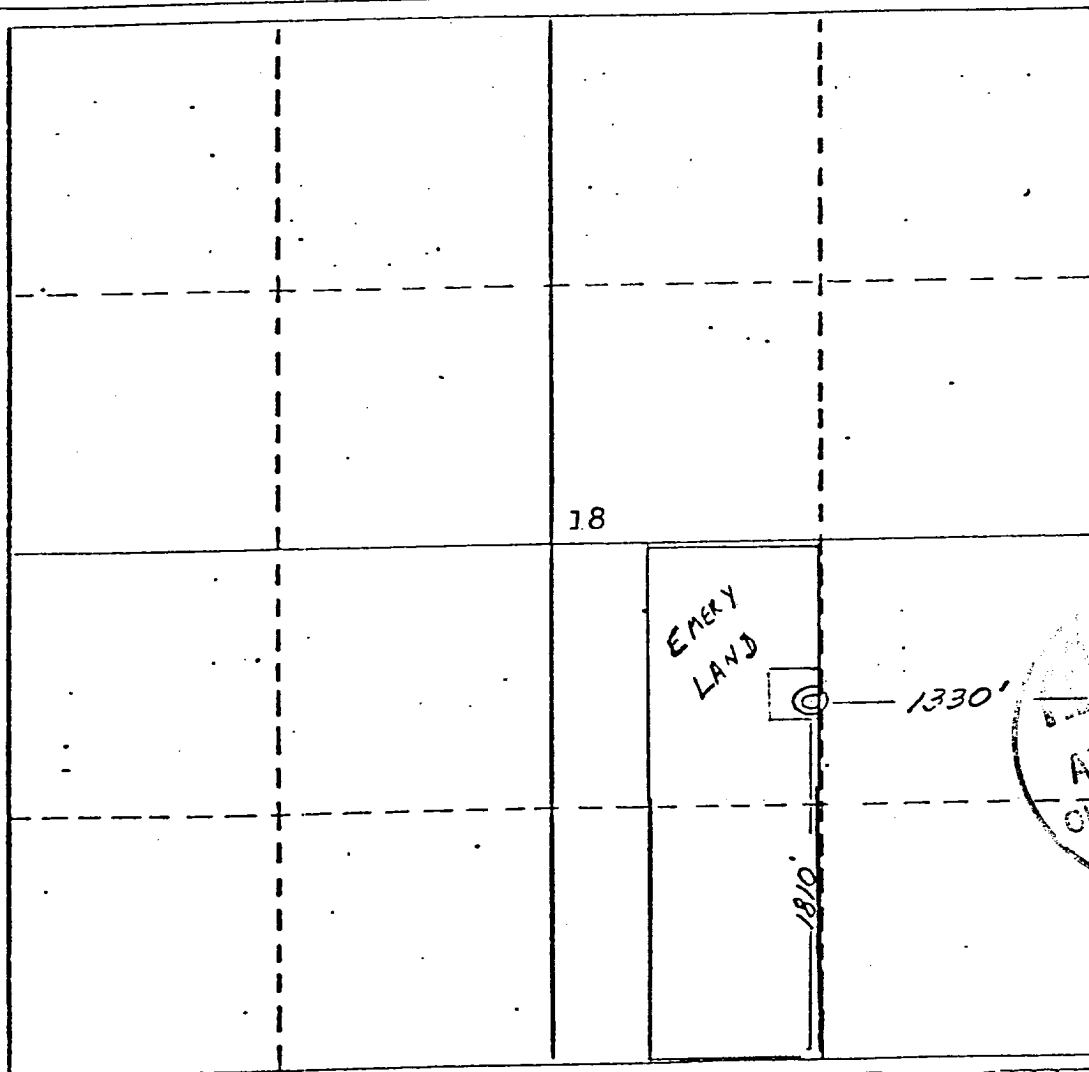

CERTIFICATION

I hereby certify that the information contained herein is true and complete to the best of my knowledge and belief.

Name

Position

Company

MANANA GAS, INC.

Date

March 5, 1979

I hereby certify that the location shown on the plat is correct and that the notes on the plat are true and correct to the best of my knowledge and belief.

Date Surveyed

10 February 1979

Registered Professional Engineer and Land Surveyor

James P. Leese

Certificate No.

1463

T. 30 NORTH

R. 11 WEST

