

State of New Mexico  
Energy, Minerals and Natural Resources Department

OIL CONSERVATION DIVISION

P.O. Box 2088  
Santa Fe, New Mexico 87504-2088

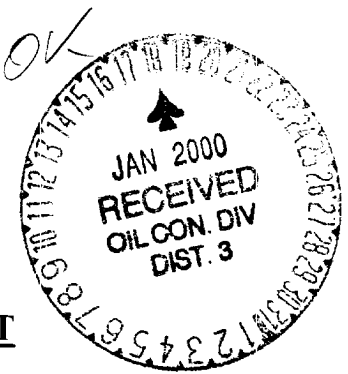

**PIT REMEDIATION AND CLOSURE REPORT**

Operator: Devon Energy (Williams Field Services) Telephone: (801) 584-6361  
Address: P.O. Box 58900, Salt Lake City, Utah 84158-0900  
WellName: NE Blanco #201 ( 85214 )  
Location: Unit or Qtr/Qtr Sec <sup>M</sup> Sec 9 T 31N R 7W County San Juan  
PitType Dehydrator  
LandType: Fee

Pit Location: Pit dimensions: length ft., width ft., depth ft.  
(Attach diagram)

Reference: Wellhead

Footage from reference: 70 ft.

Direction from reference: 20 Degrees East of North

Depth To Ground Water: Less than 50 feet (20 points)  
(Vertical distance from 50 feet to 99 feet (10 points)  
contaminants to seasonal Greater than 100 feet (0 points) 0  
high water elevation of  
ground water)

Wellhead Protection Area: Yes (20 points)  
(Less than 200 feet from a private No (0 points) 0  
domestic water source, or; less than  
1000 feet from all other water sources)

Distance To Surface Water: Less than 200 feet (20 points)  
(Horizontal distance to perennial 200 feet to 1,000 feet (10 points)  
lakes, ponds, rivers, streams, creeks, Greater than 1,000 feet (0 points) 0  
irrigation canals and ditches)

Ranking Score (TOTAL POINTS): 0

Date Remediation Started: 9/20/99

Date Completed: 9/20/99

Remediation Method: Excavation ☐  
(check all appropriate  
sections)

Approx. Cubic Yard

Landfarmed ☐

Insitu Bioremediation

Other ☐ AssessedRemediation Location: Onsite ☐ Offsite(ie. landfarmed onsite,  
name and location of  
offsite facility)

General Description Of Remedial Action:

Assessed pit by excavating test pit to 6 feet below pit bottom and collecting composite sample from floor.

Ground Water Encountered: No

Final Pit:

Sample location NE BLANCO 201-A-TPFL-01

Closure Sampling:

Assessed

(if multiple samples, attach  
sample results and diagram  
of sample locations and  
depths)

Sample depth 6 feet

Sample date 9/20/99

Sample time 14:48

Sample Result

Benzene (ppm) &lt;0.05

Total BTEX (ppm) &lt;0.05

Field Headspace (ppm)

TPH (ppm) &lt;2.0

Ground Water Sample: 0

I HEREBY CERTIFY THAT THE INFORMATION ABOVE IS TRUE AND COMPLETE TO  
THE BEST OF MY KNOWLEDGE AND BELIEF

DATE 12-20-99

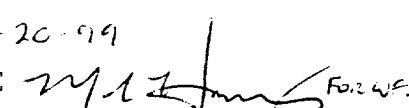
SIGNATURE  For WFSPRINTED NAME Mark Harvey for Williams Field Services  
AND TITLE

# PIT RETIREMENT FORM

85214

Date: 9-20-99

Weather Partly Cloudy Warm

Well Name NE BLANCO #201 Operator DEVON

Sec 9 T 31N R 7W UL

and Type: BLM STATE FEE INDIAN

County SAN JUAN

One Call Made (505-765-1234)? Y N

Line Marking Evident? Y N

## Pit Location:

Reference Wellhead X Other

Distance from: 70'

Direction: 20 Degrees X E N X

of

W S

Starting Pit Dimensions 16 x 16 x 2

Final Pit Dimensions  x  x

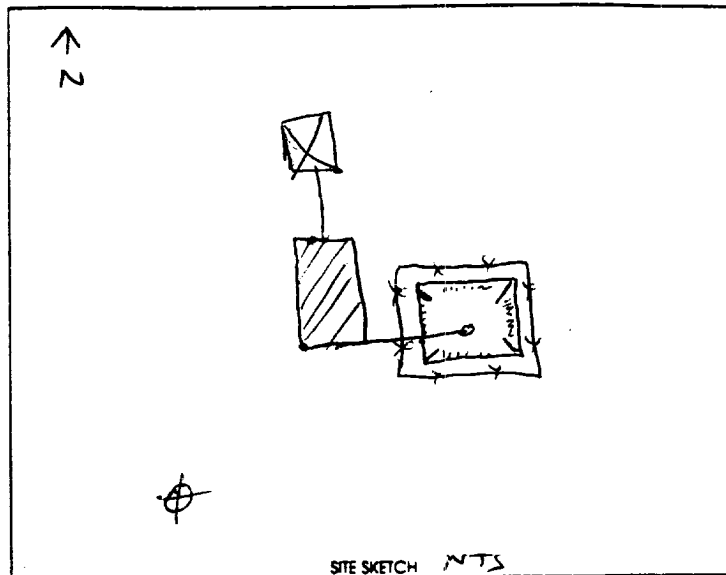

## Organic Vapor Readings:

Start N/A

## Soil Description:

@ 2'   
@ 4'   
@ 6'   
@ 8'   
@   
@

0-6' + BRN CLAYEY SILT - SILTY CLAY.  
MDA - WELL PLASTIC, SOFT

Well Proximity To: Residence, Domestic Water Well, Stock Well NONE

Arroyo, Wash, Lake, Stream >1000'

Estimated or Known Distance to Ground Water >100'

Source of Backfill (If other than processed material)

Samples collected: Type

Progress: Verification:

ID NE BLANCO #201 - A-TPFL-01 Assess Soil / water

Progress: Verification:

ID  Soil / water

Progress: Verification:

ID  Soil / water

Sample sent to Lab Via: Courier

Hand Carried

Other

Preservative: ICE Other

N/A

Comments: EARTHEN PIT. SITE IS JUST SOUTH OF +  
ON SAME PAD AS NE BLANCO #67. NO DOOR  
OR DISCOLORATION. EXCAVATED TEST PIT TO  
6' DEEP AND COLLECTED ASSESSMENT SAMPLE FROM  
FLOOR. NO IMPACT TO SIDEWALLS.

Soil Shipped to: N/A

Prepared by: JS

(pit sketch show sample pits.)

## QWAL LABORATORIES, INC.

2911 ROTARY TERRACE, P.O. BOX 562/PITTSBURG, KS 66762/(316)232-1970

## LABORATORY REPORT:

REFERENCE #: 9909783

SENT WILLIAMS FIELD SERVICE  
TO: 295 CHIPETA WAY  
SALT LAKE CITY, UTAH 84158  
MARK HARVEY

DATE REPORTED: 09/29/99  
DATE COLLECTED: 09/20/99  
DATE RECEIVED: 09/23/99

PROJECT: WFS/IGN-NM PITS

Reference Fraction: 9909783-18A  
Sample ID: NE BLANCO 201-A-TPFL-01  
Sample Date Collected: 09/20/99 14:48:00

Sample Matrix: SOIL

TEST	METHOD	RESULT	UNITS	PQL	ANALYZED	BY
TPH-DRO	SW846-8015D	ND	MG/KG	2	09/25/99	BEM
BTEX	OA1/8021B			3.0		
BENZENE		ND	MG/KG	0.050	09/28/99	KKL
TOLUENE		ND	MG/KG	0.050	09/28/99	KKL
ETHYLBENZENE		ND	MG/KG	0.050	09/28/99	KKL
TOTAL XYLENES		ND	MG/KG	0.050	09/28/99	KKL
BFB (SURROGATE)		81	125	75		
QA/QC PACKAGE LEVEL	NONE		SU			

ND=NONE DETECTED  
PQL=PRACTICAL QUANTITATION LIMIT  
SU=STANDARD UNITS  
B=DETECTED IN METHOD BLANK

APPROVED BY:

TERRY KOESTER  
LABORATORY DIRECTOR