

✓

OIL CONSERVATION COMMISSION  
Cytle DISTRICT

OIL CONSERVATION COMMISSION  
BOX 2088  
SANTA FE, NEW MEXICO

DATE February 29, 1980

RE: Proposed MC \_\_\_\_\_  
Proposed DHC \_\_\_\_\_  
Proposed NSL \_\_\_\_\_  
Proposed SWD \_\_\_\_\_  
Proposed WFX \_\_\_\_\_  
Proposed PMX \_\_\_\_\_

NSP ✓

Gentlemen:

I have examined the application dated February 29, 1980  
for the Union Texas Petroleum Johnston School #114, N-7-31N-9W  
Operator Lease and Well No. Unit, S-T-R

and my recommendations are as follows:

Approve after verification of Frutland waivers  
Polach is shown as an applicant but there is no waiver from him  
or notice of mailing

Yours very truly,

Frank S. Cury



Union Texas Petroleum Division  
Suite 1010 Lincoln Tower  
1860 Lincoln Street  
Denver, Colorado 80203

February 22, 1980

New Mexico Oil Conservation  
Commission  
P. O. Box 2088  
Santa Fe, New Mexico 87501

Re: Johnston Federal #11Y  
SE SW Sec.7-T31N-R9W  
Blanco Pictured Cliffs and  
Blanco Fruitland Fields  
San Juan County, New Mexico

Gentlemen:

Attached please find the following documents on the captioned well:

1. Well Completion Report (Form 9-330)
2. Affidavit of Deviation Surveys
3. Packer Leakage Test
4. Request for Allowable (Form C104)
5. Application for Approval of a Non-Standard Proration Unit
6. Application for Multiple Completion (Form C-107)
7. Application for Approval to Down Hole Commingle Production

In support of our various applications the following information is offered:

APPLICATION FOR NON STANDARD PRORATION UNIT *for Fruitland*

Due to variations of legal subdivisions of public land surveys, the quarter sections along the western boundary of Township 31 North, Range 9 West are irregular in size. Because of this irregularity we are unable to form a standard 160 acre proration unit, and are asking the Commission to approve the non-standard proration unit consisting of the west half of Section 7 containing 209.5 acres.

The subject well was drilled as a replacement well for Johnston Federal #11 which has been plugged and abandoned. By virtue of Case No. 6227 (May 17, 1978) and Order No. R-5737 (June 12, 1978), which approved the same non-standard proration unit for Johnston Federal #11; we request administrative approval of the non-standard proration unit for our replacement well. Attachment I includes waivers from offset operators and a survey plat of the well and proposed proration unit.

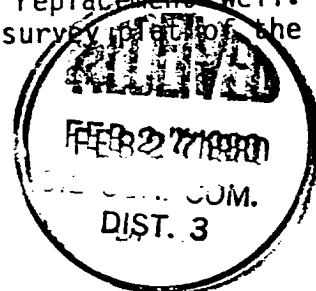

APPLICATION FOR MULTIPLE COMPLETION ✓

The Johnston Federal #11Y was drilled for Pictured Cliffs production. While drilling the well gas kicks were also observed in the Fruitland section, and both zones have been perforated. Attachment II includes Form C-107, a well bore diagram, land plats, waivers from offset operators, and a log of the well.

APPLICATION TO DOWN HOLE COMMINGLE ✓

Completion operations on the Johnston Federal #11Y were in progress from October 12, 1979 to December 14, 1979. Over \$110,000 has been spent on the completion attempt, for a total well cost to date of approximately \$210,000. Among some of our problems, we had to cement squeeze the upper Fruitland perforations to repair a channel that extended to the surface. After squeezing and additional stimulation, productivity is not as good as before, indicating unrepaired damage to the zone has occurred. While attempting to stimulate the Fruitland after the squeeze job, communication outside the pipe to the Pictured Cliffs was apparently initiated. The enclosed Packer Leakage Test verifies that the Fruitland and Pictured Cliffs zones are in communication. We have pulled our production tubing on two occasions but have found no leaks, thus indicating that the communication between zones is behind pipe. It is our contention that further cement squeezings would present an undue hardship not only because of the expense involved, but also because it undoubtedly would further damage the productivity of both zones and would result in ultimate loss of reserves. We therefore request approval to down hole commingle the Fruitland and Pictured Cliffs zones in this well. Waivers from the offset operators and a well bore diagram were included in Attachment II. Attachment III is a resubmittal of the Sundry Notice of Completion on the well which somewhat details our completion operations on the well.

Should any of our applications not qualify for administrative approval, please place the matter on the docket for hearing.

Yours very truly,

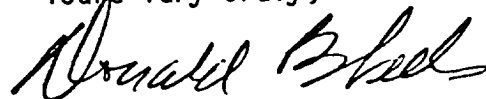

DONALD B. WELLS  
District Production Manager

DBW/jcn  
Attach.

cc: New Mexico Oil Conservation Commission  
1000 Rio Brazos Road  
Aztec, New Mexico 87410

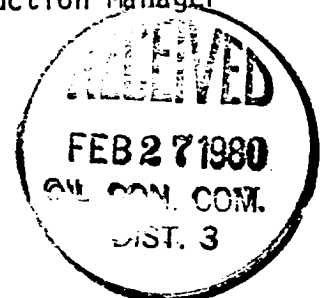





Union Texas Petroleum Division  
Suite 1010 Lincoln Tower  
1860 Lincoln Street  
Denver, Colorado 80295

Attachment I

January 14, 1980

New Mexico Oil Conservation  
Commission  
P. O. Box 2088  
Santa Fe, New Mexico 87501

RE: Union Texas Petroleum  
Johnston Federal #11Y  
SE SW Sec.7-T31N-R9W  
San Juan County, N. Mexico

Gentlemen:

Please be advised that KOCH INDUSTRIES, INC. has no objections to Union Texas Petroleum's request for a non standard proration unit for the captioned well.

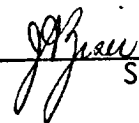
  
SIGNED

  
TITLE

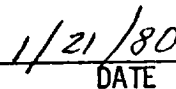
  
DATE

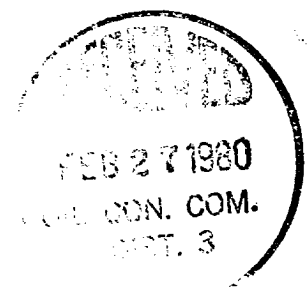



Union Texas Petroleum Division  
Suite 1010 Lincoln Tower  
1860 Lincoln Street  
Denver, Colorado 80295

January 14, 1980

New Mexico Oil Conservation  
Commission  
P. O. Box 2088  
Santa Fe, New Mexico 87501

RE: Union Texas Petroleum  
Johnston Federal #11Y  
SE SW Sec.7-T31N-R9W  
San Juan County, N. Mexico

Gentlemen:

Please be advised that EL PASO NATURAL GAS CO. has no objections to Union Texas Petroleum's request for a non standard proration unit for the captioned well.

*Carl E. Matthews*  
SIGNED

*Regional Production Mgr.*  
TITLE

*1/28/80*  
DATE

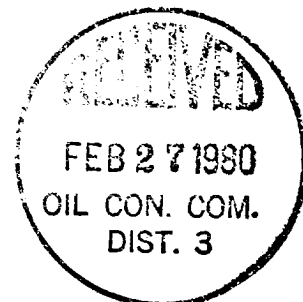

All distances must be from the outer boundaries of the Section.

Operator <b>UNION TEXAS PETROLEUM</b>		Lease <b>JOHNSTON FEDERAL</b>		Well No. <b>11 Y</b>	
Unit Letter <b>N</b>	Section <b>7</b>	Township <b>31 NORTH</b>	Range <b>9 WEST</b>	County <b>SAN JUAN</b>	
Actual Footage Location of Well: <b>990</b> feet from the <b>SOUTH</b> line and <b>790</b> feet from the <b>WEST</b> line					
Ground Level Elev. <b>6612</b>	Producing Formation <b>PICTURE CLIFFS</b>		Pool <b>BLANCO PICTURED CLIFFS</b>		Dedicated Acreage: <b>209.5</b> Acres

1. Outline the acreage dedicated to the subject well by colored pencil or hatchure marks on the plat below.

2. If more than one lease is dedicated to the well, outline each and identify the ownership thereof (both as to working interest and royalty).

3. If more than one lease of different ownership is dedicated to the well, have the interests of all owners been consolidated by communitization, unitization, force-pooling, etc?

☐ Yes ☐ No If answer is "yes," type of consolidation \_\_\_\_\_

If answer is "no," list the owners and tract descriptions which have actually been consolidated. (Use reverse side of this form if necessary.) \_\_\_\_\_

No allowable will be assigned to the well until all interests have been consolidated (by communitization, unitization, forced-pooling, or otherwise) or until a non-standard unit, eliminating such interests, has been approved by the Commission.

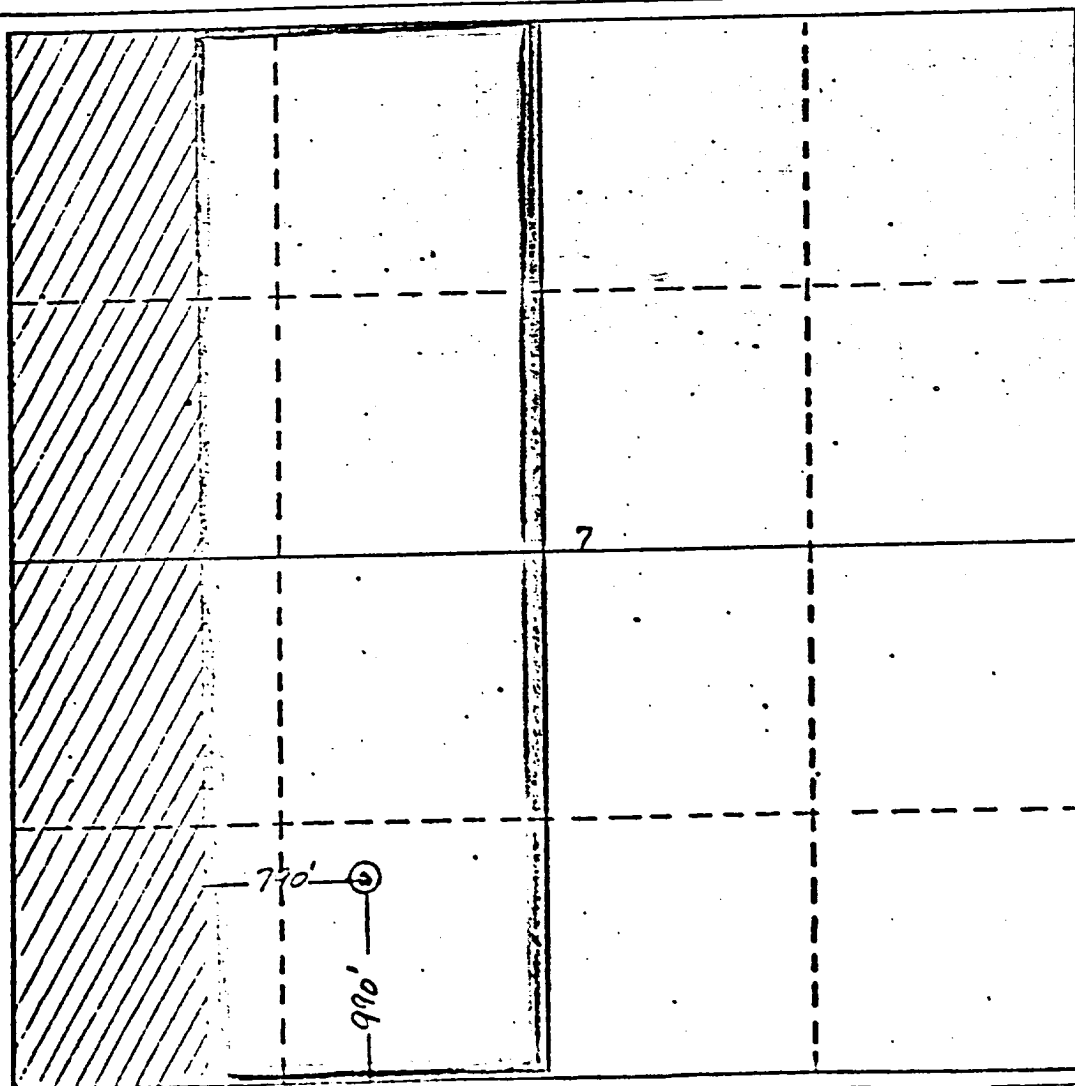

#### CERTIFICATION

I hereby certify that the information contained herein is true and complete to the best of my knowledge and belief.

Name

Position

**DISTRICT PRODUCTION MGR**

Company

**UNION TEXAS PETROLEUM**

Date

**5-3-79**

I hereby certify that the well location shown on this plat was plotted from field notes of actual survey made by me or under my supervision and that the same is true and correct to the best of my knowledge and belief.

Date Surveyed

**24 January 1979**

Registered Professional Engineer  
and/or Land Surveyor

**Michael D. Ray**

Certificate No.

**5992**