

NO. OF COPIES RECEIVED	6
DISTRIBUTION	
SANTA FE	1
FILE	1
U.S.G.S.	2
LAND OFFICE	
OPERATOR	1

# NEW MEXICO OIL CONSERVATION COMMISSION

30-095-23511  
Form C-101  
Revised 1-1-65

5A. Indicate Type of Lease	
STATE <input type="checkbox"/>	FEE <input checked="" type="checkbox"/>
5. State Oil & Gas Lease No.	
7. Unit Agreement Name	
8. Farm or Lease Name Atlantic B	
9. Well No. 22	
10. Field and Pool, or Wildcat Blanco Pic.Cliffs	
12. County San Juan	
19. Proposed Depth 3150'	19A. Formation Pic.Cliffs
20. Rotary or C.T. Rotary	
21. Elevations (Show whether DF, RT, etc.) 6276' GR	21A. Kind & Status Plug. Bond statewide
22. Approx. Date Work will start	

## APPLICATION FOR PERMIT TO DRILL, DEEPEN, OR PLUG BACK

1a. Type of Work	
b. Type of Well DRILL <input checked="" type="checkbox"/> DEEPEN <input type="checkbox"/> PLUG BACK <input type="checkbox"/> OIL WELL <input type="checkbox"/> GAS WELL <input checked="" type="checkbox"/> OTHER <input type="checkbox"/> SINGLE ZONE <input checked="" type="checkbox"/> MULTIPLE ZONE <input type="checkbox"/>	
2. Name of Operator El Paso Natural Gas Company	
3. Address of Operator PO Box 289, Farmington, NM 87401	
4. Location of Well UNIT LETTER C LOCATED 810 FEET FROM THE North LINE AND 1730 FEET FROM THE West LINE OF SEC. 3 TWP. 30N RGE. 10W NMPM	
21. Elevations (Show whether DF, RT, etc.) 6276' GR	
21A. Kind & Status Plug. Bond statewide	
21B. Drilling Contractor	
22. Approx. Date Work will start	

## PROPOSED CASING AND CEMENT PROGRAM

SIZE OF HOLE	SIZE OF CASING	WEIGHT PER FOOT	SETTING DEPTH	SACKS OF CEMENT	EST. TOP
12 1/4"	8 5/8"	24.0#	120'	106 cu.ft.	surface
6 3/4"	2 7/8"	6.4#	3150'	482 cu.ft.	1570'

Selectively perforate and sandwater fracture the Pictured Cliffs formation.

A 3000 psi WP and 6000 psi test double gate preventer equipped with blind and pipe rams will be used for blow out prevention on this well.

This gas is dedicated.

The NW/4 of Section 3 is dedicated to this well.

APPROVAL VALID  
FOR 90 DAYS  
EXPIRES 8-23-79



IN ABOVE SPACE DESCRIBE PROPOSED PROGRAM: IF PROPOSAL IS TO DEEPEN OR PLUG BACK, GIVE DATA ON PRESENT PRODUCTIVE ZONE AND PROPOSED NEW PRODUCTIVE ZONE. GIVE BLOWOUT PREVENTER PROGRAM, IF ANY.

I hereby certify that the information above is true and complete to the best of my knowledge and belief.

Signed D. G. Buico Title Drilling Clerk Date 5-9-79

(This space for State Use)

APPROVED BY Frank S. Lang TITLE DEPUTY OIL & GAS INSPECTOR, DIST. #3

DATE MAY 25 1979

CONDITIONS OF APPROVAL, IF ANY:

*write in*

NEW MEXICO OIL CONSERVATION COMMISSION  
WELL LOCATION AND ACREAGE DEDICATION PLAT

Form C-102  
Supersedes C-128  
Effective 1-1-65

All distances must be from the outer boundaries of the Section.

Operator <b>EL PASO NATURAL GAS COMPANY</b>			Lease <b>ATLANTIC "B"</b>		(FEE)	Well No. <b>22</b>
Unit Letter <b>C</b>	Section <b>3</b>	Township <b>30N</b>	Range <b>10W</b>	County <b>San Juan</b>		
Actual Footage Location of Well: <b>810</b> feet from the <b>North</b> line and <b>1730</b> feet from the <b>West</b> line						
Ground Level Elev. <b>6276</b>	Producing Formation <b>Pictured Cliffs</b>		Pool <b>Blanco Pictured Cliffs</b>		Dedicated Acreage: <b>162.03</b> Acres	

1. Outline the acreage dedicated to the subject well by colored pencil or hachure marks on the plat below.
2. If more than one lease is dedicated to the well, outline each and identify the ownership thereof (both as to working interest and royalty).
3. If more than one lease of different ownership is dedicated to the well, have the interests of all owners been consolidated by communitization, unitization, force-pooling, etc?  
☐ Yes ☐ No If answer is "yes," type of consolidation Communitization

If answer is "no," list the owners and tract descriptions which have actually been consolidated. (Use reverse side of this form if necessary.)

No allowable will be assigned to the well until all interests have been consolidated (by communitization, unitization, forced-pooling, or otherwise) or until a non-standard unit, eliminating such interests, has been approved by the Commission.

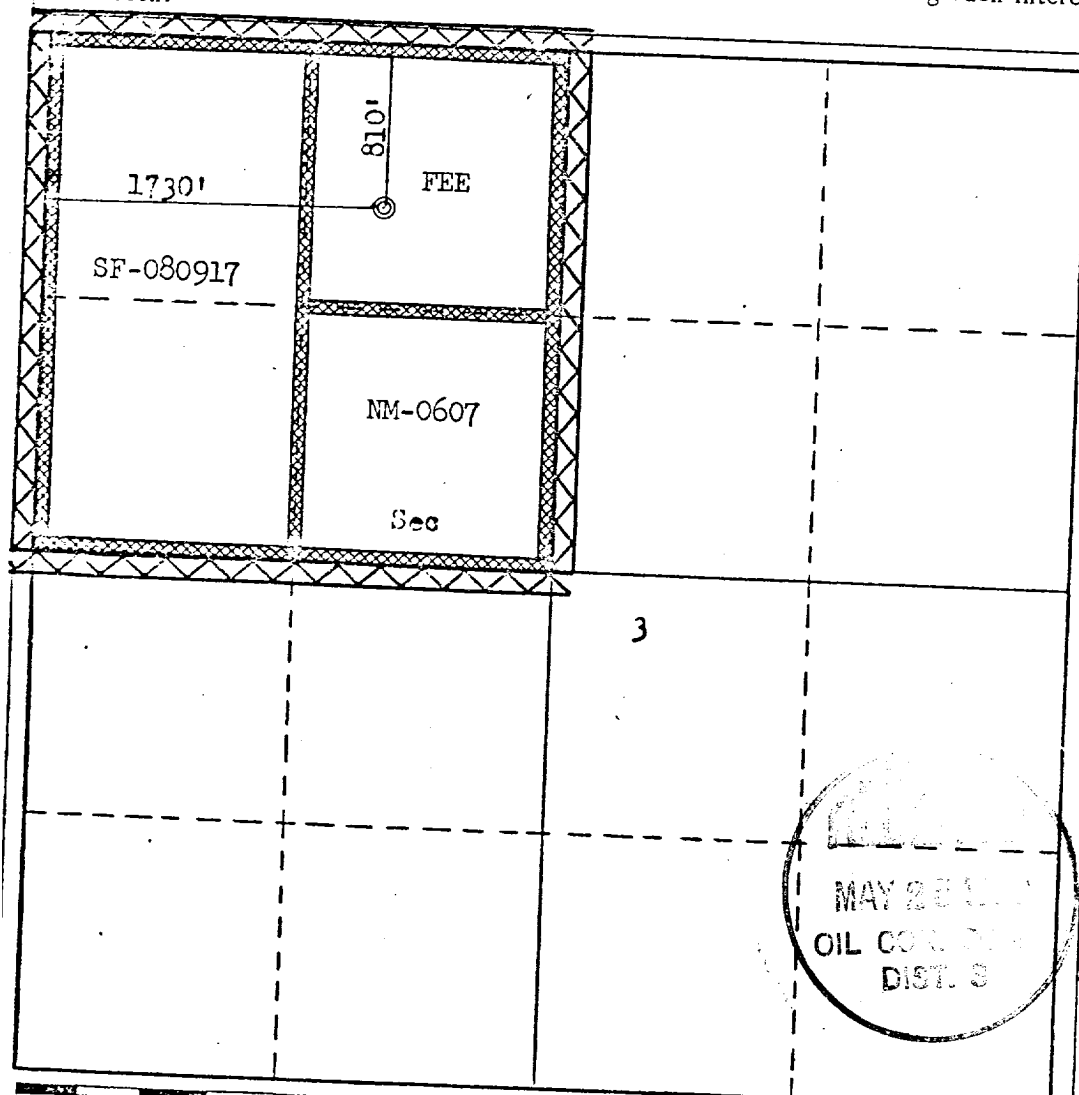

CERTIFICATION

I hereby certify that the information contained herein is true and complete to the best of my knowledge and belief.

*D. G. Lucas*  
Name  
Drilling Clerk  
Position  
El Paso Natural Gas Co.  
Company  
5-10-79  
Date

I hereby certify that the well location shown on this plat was plotted from field notes of actual surveys made by me or under my supervision, and that the same is true and correct to the best of my knowledge and belief.

Date Surveyed  
**October 1, 1978**  
Registered Professional Engineer  
and/or Land Surveyor  
*Fred E. Cobb, Jr.*  
Certificate No.

MAY 28 1978  
OIL CONSERVATION COMMISSION  
DIST. 8

0 330 660 990 1320 1650 1980 2310 2640 2970 3300 3630 3960 4290 4620 4950 5280 5610 5940 6270 6600 6930 7260 7590 7920 8250 8580 8910 9240 9570 9900