

UNITED STATES  
DEPARTMENT OF THE INTERIOR  
GEOLOGICAL SURVEY

30-095-23609

5. LEASE DESIGNATION AND SERIAL NO.  
NM-024158

6. IF INDIAN, ALLOTTEE OR TRIBAL NAME

7. UNIT AGREEMENT NAME

8. FARM OR LEASE NAME  
McKenzie

9. WELL NO.  
1 E

10. FIELD AND POOL, OR WILDCAT  
Basin Dakota

11. SEC., T., R., M., OR BLE. AND SURVEY OR AREA  
Sec 20 T30N R12W

12. COUNTY OR PARISH  
San Juan

13. STATE  
NM

APPLICATION FOR PERMIT TO DRILL, DEEPEN, OR PLUG BACK

1a. TYPE OF WORK  
DRILL ☒ DEEPEN ☐ PLUG BACK ☐

b. TYPE OF WELL  
OIL WELL ☐ GAS WELL ☒ OTHER ☐ SINGLE ZONE ☐ MULTIPLE ZONE ☐

2. NAME OF OPERATOR  
Dugan Production Corp.

3. ADDRESS OF OPERATOR  
Box 234, Farmington, NM 87401

4. LOCATION OF WELL (Report location clearly and in accordance with any State requirements)  
At surface  
800' FNL - 960' FWL  
At proposed prod. zone

14. DISTANCE IN MILES AND DIRECTION FROM NEAREST TOWN OR POST OFFICE\*  
8 miles NE of Farmington post office

15. DISTANCE FROM PROPOSED\* LOCATION TO NEAREST PROPERTY OR LEASE LINE, FT. (Also to nearest drlg. unit line, if any)  
800'

18. DISTANCE FROM PROPOSED LOCATION\* TO NEAREST WELL, DRILLING, COMPLETED, OR APPLIED FOR, ON THIS LEASE, FT.  
2320'

21. ELEVATIONS (Show whether DF, RT, GR, etc.)  
5792'

16. NO. OF ACRES IN LEASE  
320

19. PROPOSED DEPTH  
6600'

17. NO. OF ACRES ASSIGNED TO THIS WELL  
N/320

20. ROTARY OR CABLE TOOLS  
Rotary

22. APPROX. DATE WORK WILL START\*  
July 10, 1979

23. PROPOSED CASING AND CEMENTING PROGRAM

SIZE OF HOLE	SIZE OF CASING	WEIGHT PER FOOT	SETTING DEPTH	QUANTITY OF CEMENT
12-1/2"	8-5/8"	24#	180'	150 sx
7-7/8"	4-1/2"	10.5#	6600'	800 sx in two stages

Plan to drill with mud to test producing formation. If productive, will set 4-1/2" casing, selectively perforate, frac, clean out after frac, run 1-1/4" tubing, and complete well.

Plan to use BOP furnished by rig while drilling (10" 3000 psi hydraulic)

Plan to use BOP rental while completing (6" 3000 psi double gate manual)

NMERB: The Redacted A El Paso.

IN ABOVE SPACE DESCRIBE PROPOSED PROGRAM: If proposal is to deepen or plug back, give data on present productive zone and proposed new productive zone. If proposal is to drill or deepen directionally, give pertinent data on subsurface locations and measured and true vertical depths. Give blowout preventer program, if any.

24. SIGNED Thomas A. Dugan TITLE Petroleum Engineer DATE 6-14-79  
(This space for Federal or State office use)

PERMIT NO. \_\_\_\_\_ APPROVAL DATE \_\_\_\_\_

APPROVED BY \_\_\_\_\_ TITLE \_\_\_\_\_ DATE \_\_\_\_\_  
CONDITIONS OF APPROVAL, IF ANY:

ak Brink

NMOC



# WELL LOCATION AND ACREAGE DEDICATION PLAT

Supersedes C-128  
Effective 1-1-65

All distances must be from the outer boundaries of the Section.

Operator <b>Dugan Production Corporation</b>		Lessee <b>McKenzie</b>		Well No. <b>#1E</b>
Unit Letter <b>D</b>	Section <b>20</b>	Township <b>30 North</b>	Range <b>12 West</b>	County <b>San Juan</b>
Actual Footage Location of Well: <div style="display: flex; justify-content: space-between;"> <span>800 feet from the North line and</span> <span>960 feet from the West line</span> </div>				
Ground Level Elev. <b>5792</b>	Producing Formation <b>Dakota</b>	Pool <b>Basin Dakota</b>	Dedicated Acreage: <b>320 Acres</b>	

1. Outline the acreage dedicated to the subject well by colored pencil or hachure marks on the plat below.
2. If more than one lease is dedicated to the well, outline each and identify the ownership thereof (both as to working interest and royalty).
3. If more than one lease of different ownership is dedicated to the well, have the interests of all owners been consolidated by communitization, unitization, force-pooling, etc?

☐ Yes ☐ No If answer is "yes," type of consolidation \_\_\_\_\_

If answer is "no," list the owners and tract descriptions which have actually been consolidated (use reverse side of this form if necessary.) \_\_\_\_\_

No allowable will be assigned to the well until all interests have been consolidated (by communitization, unitization, forced-pooling, or otherwise) or until a non-standard unit, eliminating such interests, has been approved by the Commission.

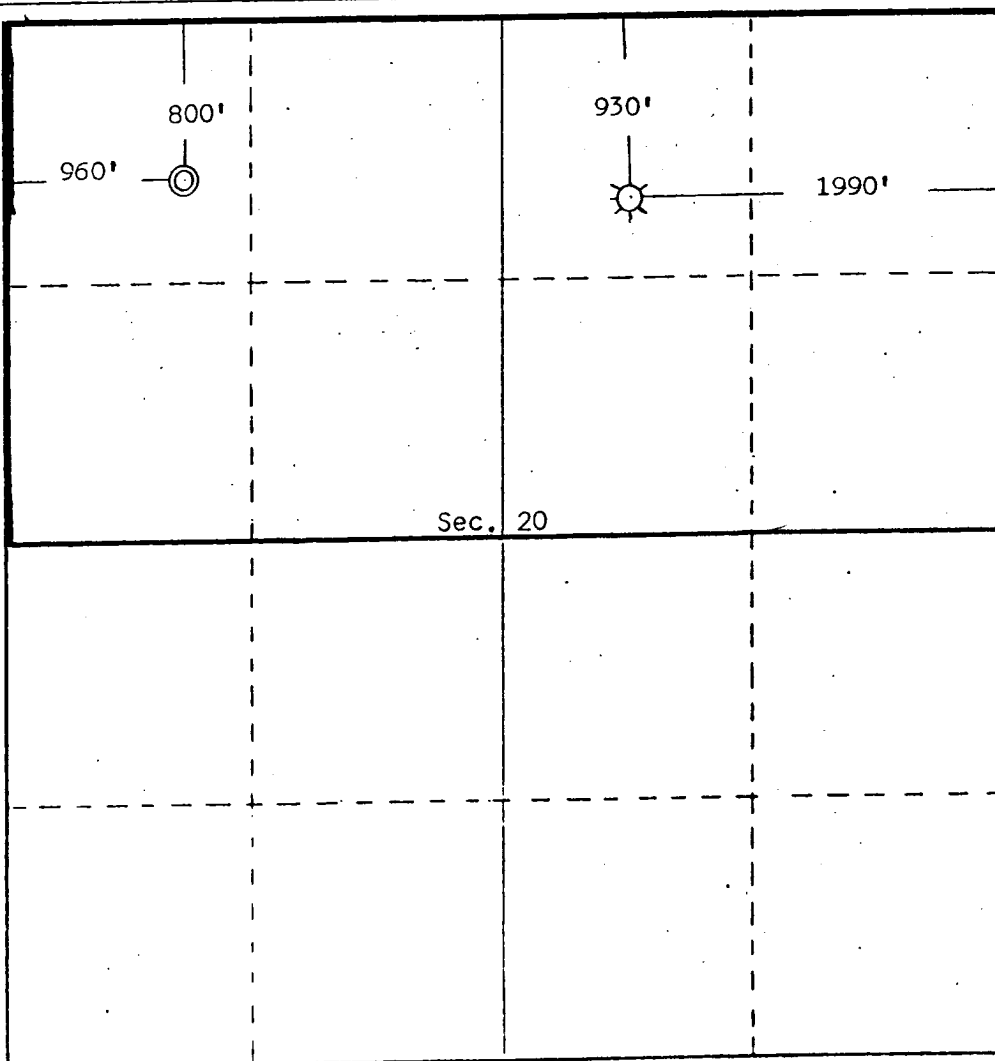
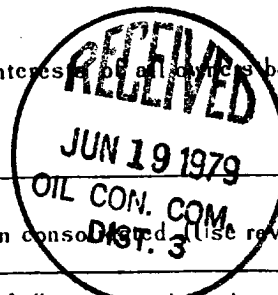

## CERTIFICATION

I hereby certify that the information contained herein is true and complete to the best of my knowledge and belief.

*Thomas A. Dugan*  
Name

Thomas A. Dugan  
Position  
Petroleum Engineer

Company  
Dugan Production Corp.

Date  
6-14-79

I hereby certify that the well location shown on this plat was plotted from field notes of actual surveys made by me or under my supervision and that the same is true and correct to the best of my knowledge and belief.

Date Surveyed  
June 8, 1979

Registered Professional Engineer  
and/or Land Surveyor

*Edgar L. Risenhoover*  
Certificate No. 5979  
Edgar L. Risenhoover

0 330 660 990 1320 1650 1980 2310 2640 2970 3300 3630 3960

