

NO. OF COPIES RECEIVED	5
DISTRIBUTION	
SANTA FE	1
FILE	1
U.S.G.S.	2
LAND OFFICE	
OPERATOR	1

NEW MEXICO OIL CONSERVATION COMMISSION

30-045-23642
Form C-101
Revised 1-1-65

5A. Indicate Type of Lease	
STATE <input type="checkbox"/>	FEE <input checked="" type="checkbox"/>
5. State Oil & Gas Lease No.	

APPLICATION FOR PERMIT TO DRILL, DEEPEN, OR PLUG BACK

1a. Type of Work		7. Unit Agreement Name	
b. Type of Well DRILL <input checked="" type="checkbox"/> DEEPEN <input type="checkbox"/> PLUG BACK <input type="checkbox"/> OIL WELL <input type="checkbox"/> GAS WELL <input checked="" type="checkbox"/> OTHER <input type="checkbox"/> SINGLE ZONE <input checked="" type="checkbox"/> MULTIPLE ZONE <input type="checkbox"/>		8. Farm or Lease Name Jacquez	
2. Name of Operator El Paso Natural Gas Company		9. Well No. 3	
3. Address of Operator PO Box 289, Farmington, NM 87401		10. Field and Pool, or Wildcat Blanco PC Ext.	
4. Location of Well UNIT LETTER C LOCATED 1090 FEET FROM THE North LINE AND 1180 FEET FROM THE West LINE OF SEC. 30 TWP. 30N RGE. 8W NMPM		12. County San Juan	
19. Proposed Depth 2490		19A. Formation Pic. Cliffs	20. Rotary or C.T. Rotary
21. Elevations (Show whether DF, RT, etc.) 5649' GL	21A. Kind & Status Plug. Bond statewide	21B. Drilling Contractor	22. Approx. Date Work will start

23.

PROPOSED CASING AND CEMENT PROGRAM

SIZE OF HOLE	SIZE OF CASING	WEIGHT PER FOOT	SETTING DEPTH	SACKS OF CEMENT	EST. TOP
12 1/4"	8 5/8"	24.0#	120'	100 cu.ft.	surface
6 3/4"	2 7/8"	6.4#	2490'	371 cu.ft.	cover Ojo Alamo

Selectively perforate and sandwater fracture the Pictured Cliffs formation.

A 3000 psi WP and 6000 psi test double gate preventer equipped with blind and pipe rams will be used for blow out prevention on this well.

This gas is dedicated.

Lot 9, SE/4 SW/4 of Section 19 and Lots 2, 3 and E/2 of NW/4 of Section 30 are dedicated to this well.

EXPIRES 9-27-79

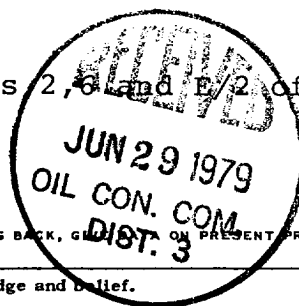

IN ABOVE SPACE DESCRIBE PROPOSED PROGRAM: IF PROPOSAL IS TO DEEPEN OR PLUG BACK, GIVE DATA ON PRESENT PRODUCTIVE ZONE AND PROPOSED NEW PRODUCTIVE ZONE. GIVE BLOWOUT PREVENTER PROGRAM, IF ANY.

I hereby certify that the information above is true and complete to the best of my knowledge and belief.

Signed W. G. Busco Title Drilling Clerk Date June 27, 1979

(This space for State Use)

APPROVED BY Frank S. Clary TITLE DEPUTY OIL & GAS INSPECTOR, DIST. #3 DATE JUN 29 1979

CONDITIONS OF APPROVAL, IF ANY:

NW 2-3669

WELL LOCATION AND ACREAGE DEDICATION PLAT

Supersedes C-128
Effective 1-1-65

All distances must be from the outer boundaries of the Section.

Operator EL PASO NATURAL GAS COMPANY			Lease JACQUEZ (FEE)		Well No. 3
Unit Letter C	Section 30	Township 30-N	Range 8-W	County SAN JUAN	
Actual Footage Location of Well: 1090 feet from the NORTH line and 1180 feet from the WEST line					
Ground Level Elev. 5649	Producing Formation PICTURED CLIFFS		Pool BLANCO PICTURED CLIFFS EXT.	Dedicated Acreage: 172.90 Acres	

1. Outline the acreage dedicated to the subject well by colored pencil or hachure marks on the plat below.
2. If more than one lease is dedicated to the well, outline each and identify the ownership thereof (both as to working interest and royalty).
3. If more than one lease of different ownership is dedicated to the well, have the interests of all owners been consolidated by communitization, unitization, force-pooling, etc?

☒ Yes ☐ No If answer is "yes," type of consolidation Communitization

If answer is "no," list the owners and tract descriptions which have actually been consolidated. (Use reverse side of this form if necessary.)

No allowable will be assigned to the well until all interests have been consolidated (by communitization, unitization, forced-pooling, or otherwise) or until a non-standard unit, eliminating such interests, has been approved by the Commission. NOTE: THIS PLAT IS REISSUED TO SHOW CORRECTED DEDICATION. 6-14-79

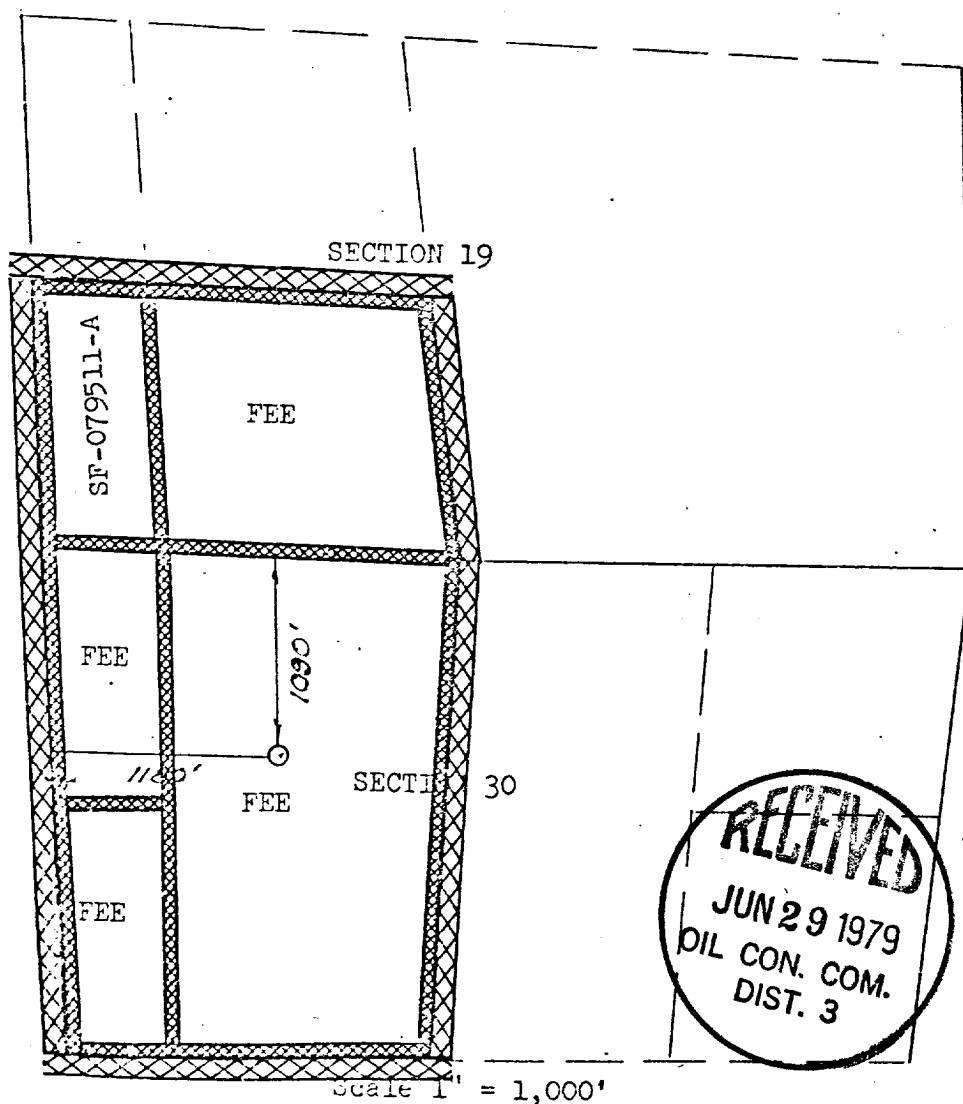

CERTIFICATION

I hereby certify that the information contained herein is true and complete to the best of my knowledge and belief.

F. B. Kerr Jr.

Name
Drilling Clerk

Position
El Paso Natural Gas Co.

Company
June 27, 1979

Date

I hereby certify that the well location shown on this plat was plotted from field notes of actual surveys made by me or under my supervision, and that the same is true and correct to the best of my knowledge and belief.

Date Surveyed
JUNE 1, 1979

Registered Professional Engineer and/or Land Surveyor
**ORIGINAL SIGNED BY:
FRED B. KERR JR.**

Certificate No. **3950**