

UNITED STATES
DEPARTMENT OF THE INTERIOR
GEOLOGICAL SURVEY

SUNDRY NOTICES AND REPORTS ON WELLS

(Do not use this form for proposals to drill or to deepen or plug back to a different reservoir. Use Form 9-331-C for such proposals.)

1. oil ☐ gas ☒ other ☐
well well

2. NAME OF OPERATOR

AMOCO PRODUCTION COMPANY

3. ADDRESS OF OPERATOR

501 Airport Drive, Farmington, NM 87401

4. LOCATION OF WELL (REPORT LOCATION CLEARLY. See space 17 below.)

AT SURFACE: **1020' FNL and 1450' FEL, Sec. 10**
AT TOP PROD. INTERVAL: **T30N, R12W**
AT TOTAL DEPTH: **Same**

16. CHECK APPROPRIATE BOX TO INDICATE NATURE OF NOTICE, REPORT, OR OTHER DATA

REQUEST FOR APPROVAL TO:

TEST WATER SHUT-OFF ☐

FRACTURE TREAT ☐

SHOOT OR ACIDIZE ☐

REPAIR WELL ☐

PULL OR ALTER CASING ☐

MULTIPLE COMPLETE ☐

CHANGE ZONES ☐

ABANDON* ☐

(other) **Restaking**

SUBSEQUENT REPORT OF:

☐

☐

☐

☐

☐

☐

☐

☐

5. LEASE

SP-081239

6. IF INDIAN, ALLOTTEE OR TRIBE NAME

7. UNIT AGREEMENT NAME

8. FARM OR LEASE NAME

Kelly Gas Com "B"

9. WELL NO.

1

10. FIELD OR WILDCAT NAME

Flora Vista Fruitland

11. SEC., T., R., M., OR BLK. AND SURVEY OR AREA

NW/4 NE/4, Section 10, T30N, R12W

12. COUNTY OR PARISH

San Juan

13. STATE

New Mexico

14. API NO.

30-045-23778

15. ELEVATIONS (SHOW DF, KDB, AND WD)

5740'

(NOTE: Report results of multiple completion or zone change on Form 9-330.)

17. DESCRIBE PROPOSED OR COMPLETED OPERATIONS (Clearly state all pertinent details, and give pertinent dates, including estimated date of starting any proposed work. If well is directionally drilled, give subsurface locations and measured and true vertical depths for all markers and zones pertinent to this work.)*

The subject well has been restaked from 910' FNL and 1520' FEL, Section 10, T30N, R12W, back to the original location of 1020' FNL and 1450' FEL, Section 10, T30N, R12W, San Juan County New Mexico. Attached is a plat showing the new location.

Subsurface Safety Valve: Manu. and Type _____

18. I hereby certify that the foregoing is true and correct

SIGNED

B. E. Jackel

TITLE

District Engineer

DATE

November 8, 1979

(This space for Federal or State office use)

APPROVED BY _____

CONDITIONS OF APPROVAL, IF ANY:

TITLE _____

DATE _____

NMOCC

*See Instructions on Reverse Side

Instructions

General: This form is designed for submitting proposals to perform certain well operations, and reports of such operations when completed, as indicated, on Federal and Indian lands pursuant to applicable Federal law and regulations, and, if approved or accepted by any State, on all lands in such State, pursuant to applicable State law and procedures and practices, either as shown below or will be issued by, or may be obtained from, the local Federal and/or State office.

Item 4: If there are no applicable State requirements, locations on Federal or Indian land should be described in accordance with Federal requirements. Consult local State or Federal office for specific instructions.

Item 17: Proposals to abandon a well and subsequent reports of abandonment should include such special information as is required by local Federal and/or State offices. In addition, such proposals and reports should include reasons for the abandonment; data on any former or present productive zones, or other zones with present significant above plugs; amount, size, method of parting of any casing, liner or tubing pulled and the depth to top of any left in the hole; method of closing top of well; and date well site conditioned for final inspection looking to approval of the abandonment.

OIL CONSERVATION DIVISION

P. O. BOX 2088

Form C-107
Revised 10-1-78

STATE OF NEW MEXICO

SANTA FE, NEW MEXICO 87501

ENERGY AND MINERALS DEPARTMENT

All distances must be from the outer boundaries of the Section.

Operator AMOCO PRODUCTION COMPANY		Lease KELLY GAS COM "B"		Well No. 1
Unit Letter B	Section 10	Township 30N	Range 12W	County San Juan

Actual Footage Location of Well: 1020 feet from the North line and 1450 feet from the East line				
Ground Level Elev. 5740	Producing Formation Fruitland	Pool Flora Vista Fruitland	Dedicated Acreage: 160 Acres	

1. Outline the acreage dedicated to the subject well by colored pencil or hachure marks on the plat below.
2. If more than one lease is dedicated to the well, outline each and identify the ownership thereof (both as to working interest and royalty).
3. If more than one lease of different ownership is dedicated to the well, have the interests of all owners been consolidated by communitization, unitization, force-pooling, etc?

☒ Yes ☐ No If answer is "yes," type of consolidation Communitization

If answer is "no," list the owners and tract descriptions which have actually been consolidated. (Use reverse side of this form if necessary.)

No allowable will be assigned to the well until all interests have been consolidated (by communitization, unitization, forced-pooling, or otherwise) or until a non-standard unit, eliminating such interests, has been approved by the Commission.

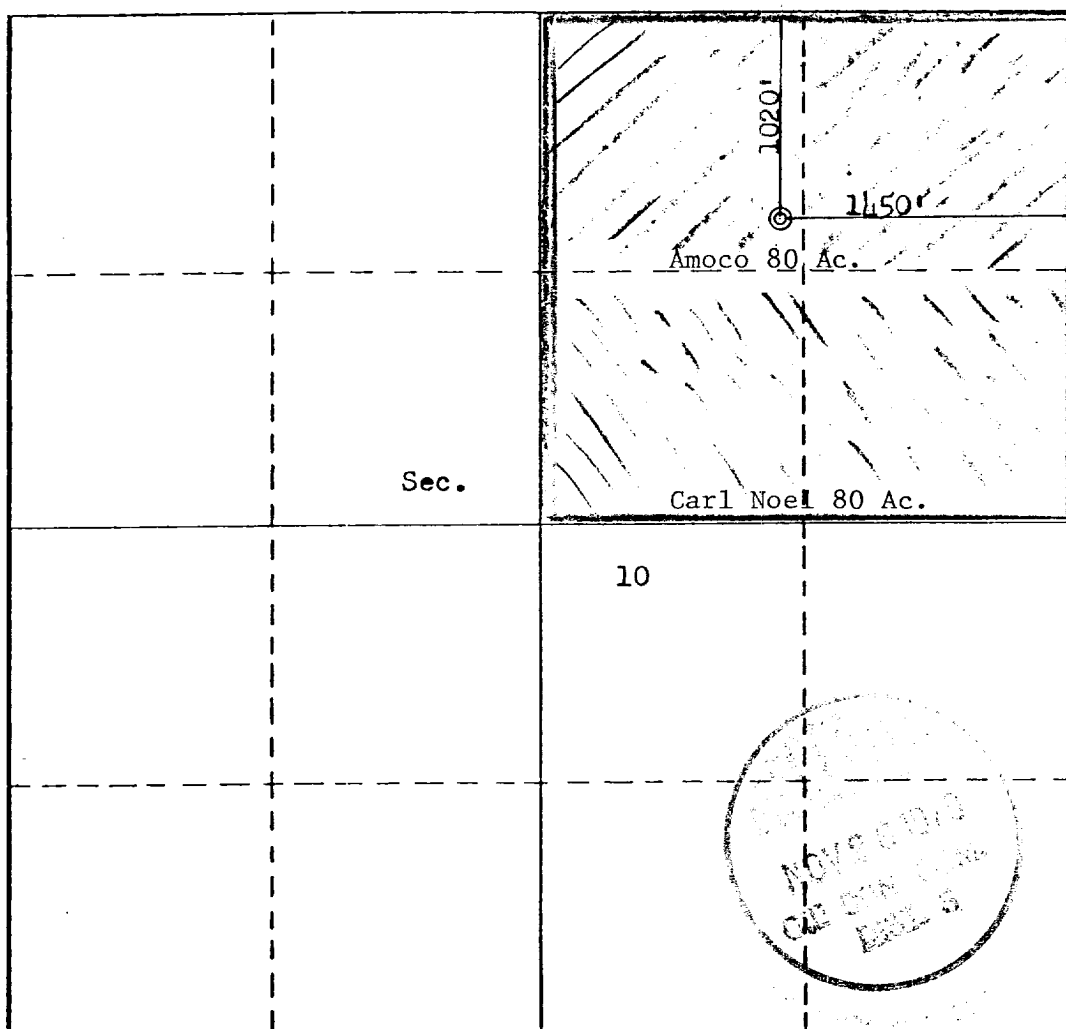

CERTIFICATION

I hereby certify that the information contained herein is true and complete to the best of my knowledge and belief.

B.E. Fackrell

Name

B. E. FACKRELL

Position

DISTRICT ENGINEER

Company

AMOCO PRODUCTION COMPANY

Date

NOVEMBER 8, 1979

I hereby certify that the well location shown on this plat was plotted from field notes of actual surveys made by me or under my supervision, and that the same is true and correct to the best of my knowledge and belief.

Restaked to original loc.

Date Surveyed

November 1, 1979

Registered Professional Engineer
and/or Land Surveyor

Fred B. Kerr Jr.

Certificate No.

3950

NEW MEXICO

F. B. KERR, JR.