

UNITED STATES
DEPARTMENT OF THE INTERIOR
GEOLOGICAL SURVEY

APPLICATION FOR PERMIT TO DRILL, DEEPEN, OR PLUG BACK

1a. TYPE OF WORK

DRILL ☒DEEPEN ☐PLUG BACK ☐

b. TYPE OF WELL

OIL
WELL ☐GAS
WELL ☒

OTHER

SINGLE
ZONE ☐MULTIPLE
ZONE ☐

2. NAME OF OPERATOR

Ladd Petroleum Corp.

3. ADDRESS OF OPERATOR

Box 208, Farmington, NM 87401

4. LOCATION OF WELL (Report location clearly and in accordance with any State requirements.)*

At surface

1450'

1120'

FSL - 1540' FWL

At proposed prod. zone

14. DISTANCE IN MILES AND DIRECTION FROM NEAREST TOWN OR POST OFFICE*

3 miles west of Farmington

15. DISTANCE FROM PROPOSED*

LOCATION TO NEAREST
PROPERTY OR LEASE LINE, FT.

1450'

(Also to nearest drlg. unit lloc. if any)

18. DISTANCE FROM PROPOSED LOCATION*

TO NEAREST WELL, DRILLING, COMPLETED,
OR APPLIED FOR, ON THIS LEASE, FT.

1/2 mi.

16. NO. OF ACRES IN LEASE

19. PROPOSED DEPTH

1300'

17. NO. OF ACRES ASSIGNED
TO THIS WELL

160

20. ROTARY OR CABLE TOOLS

Rotary

21. ELEVATIONS (Show whether DF, RT, GR, etc.)

5501' GR

22. APPROX. DATE WORK WILL START*

Aug. 20, 1979

23.

PROPOSED CASING AND CEMENTING PROGRAM

| SIZE OF HOLE | SIZE OF CASING | WEIGHT PER FOOT | SETTING DEPTH | QUANTITY OF CEMENT |
|--------------|----------------|-----------------|---------------|--------------------|
| 8-3/4" | 7" used | 20# | 40' | 10 sx class "B" |
| 4-3/4" | 2-7/8" new | 6.4# | 1300' | 100 sx ** |

Plan to drill well using mud as circulating medium to test Pictured Cliffs formation. If productive, plan to set 2-7/8" tbg for csg, selectively perforate, frac, clean out after frac, run 1-1/4" tbg and complete well. Plan to run IES log.

~~Do not plan to use a blowout preventer while drilling. Will use muder valve and stripper head while completing well.~~

NMERB: Gas not dedicated.

**75 sx 2% Lodense w/1/4# cello flake per sx followed by 25 sx class "B" w/1/4# cello flake per sx

IN ABOVE SPACE DESCRIBE PROPOSED PROGRAM: If proposal is to deepen or plug back, give data on present productive zone and proposed new productive zone. If proposal is to drill or deepen directionally, give pertinent data on subsurface locations and measured and true vertical depths. Give blowout preventer program, if any.

24.

SIGNED

W. A. Ruggan

TITLE

Agent

DATE

8-7-79

(This space for Federal or State office use)

PERMIT NO.

APPROVAL DATE

APPROVED BY

TITLE

DATE

CONDITIONS OF APPROVAL, IF ANY:

YIMOC

30-045-23868

5. LEASE DESIGNATION AND SERIAL NO.

NM 0206995

6. IF INDIAN, ALLOTTEE OR TRIBE NAME

7. UNIT AGREEMENT NAME

8. FARM OR LEASE NAME

Aztec 34

9. WELL NO.

2-34

10. FIELD AND POOL, OR WILDCAT

Harper Hill Fruitland P

11. SEC., T., R., M., OR BLK.
AND SURVEY OR AREA

Sec 34 T30N R14W

12. COUNTY OR PARISH

San Juan

13. STATE

NM

NEW MEXICO OIL CONSERVATION COMMISSION
WELL LOCATION AND ACREAGE DEDICATION PLAT

Form C-102
Supersedes C-128
Effective 1-1-65

All distances must be from the outer boundaries of the Section.

| | | | | |
|--|---|-----------------------------|--|-------------------------------------|
| Operator Ladd Petroleum | | Lease Aztec 34 | | Well No. 2-111 |
| Unit Letter N | Section 34 | Township 30 North | Range 14 West | County San Juan |
| Actual Footage Location of Well: 1120 feet from the South line and 1540 feet from the West line | | | | |
| Ground Level Elev. 5506 | Producing Formation Fruitland | Pool Harper Hill | Dedicated Acreage: 160 Acres | |

1. Outline the acreage dedicated to the subject well by colored pencil or hachure marks on the plat below.
2. If more than one lease is dedicated to the well, outline each and identify the ownership thereof (both as to working interest and royalty).
3. If more than one lease of different ownership is dedicated to the well, have the interests of all owners been consolidated by communitization, unitization, force-pooling, etc?

☐ Yes ☐ No If answer is "yes," type of consolidation _____

If answer is "no," list the owners and tract descriptions which have actually been consolidated. (Use reverse side of this form if necessary.) _____

No allowable will be assigned to the well until all interests have been consolidated (by communitization, unitization, forced-pooling, or otherwise) or until a non-standard unit, eliminating such interests, has been approved by the Commission.

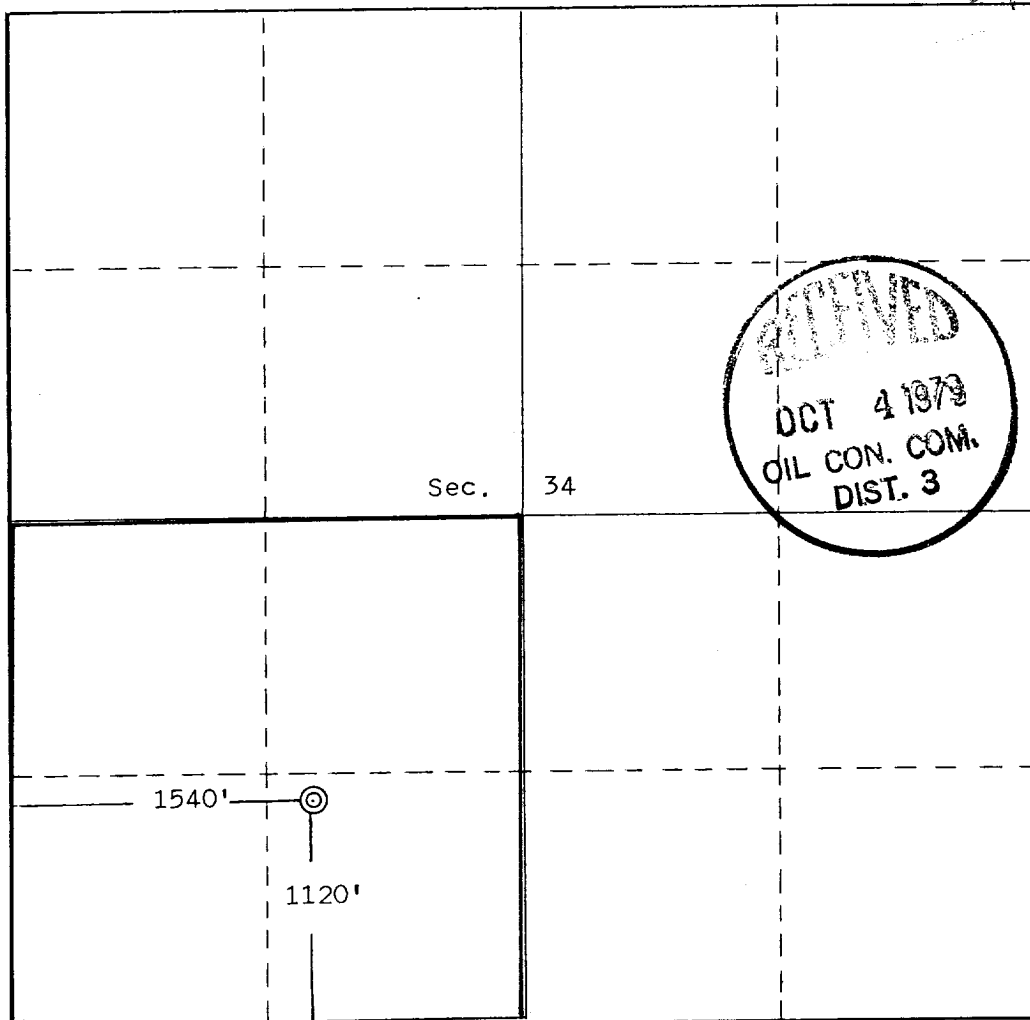

CERTIFICATION

I hereby certify that the information contained herein is true and complete to the best of my knowledge and belief.

Name

Thomas A. Dugan

Position

Agent

Company

Ladd Petroleum Corp.

Date

8-29-79

I hereby certify that the well location shown on this plat was reported and field notes of actual surveys made by me or under my supervision and that the same is true and correct to the best of my knowledge and belief.

Date Surveyed

August 28, 1979

Registered Professional Engineer and/or Land Surveyor

Edgar L. Risenhoover

Certificate No. **5979**

Edgar L. Risenhoover, L.S.

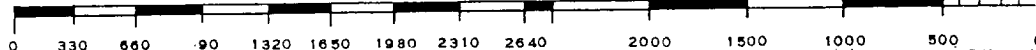

SCHEMATIC DIAGRAM

TESTING PROCEDURES

Install BOP after setting surface pipe and pressure test to 1000 psi after drilling out from under surface pipe.

REGAN BLOWOUT PREVENTERS

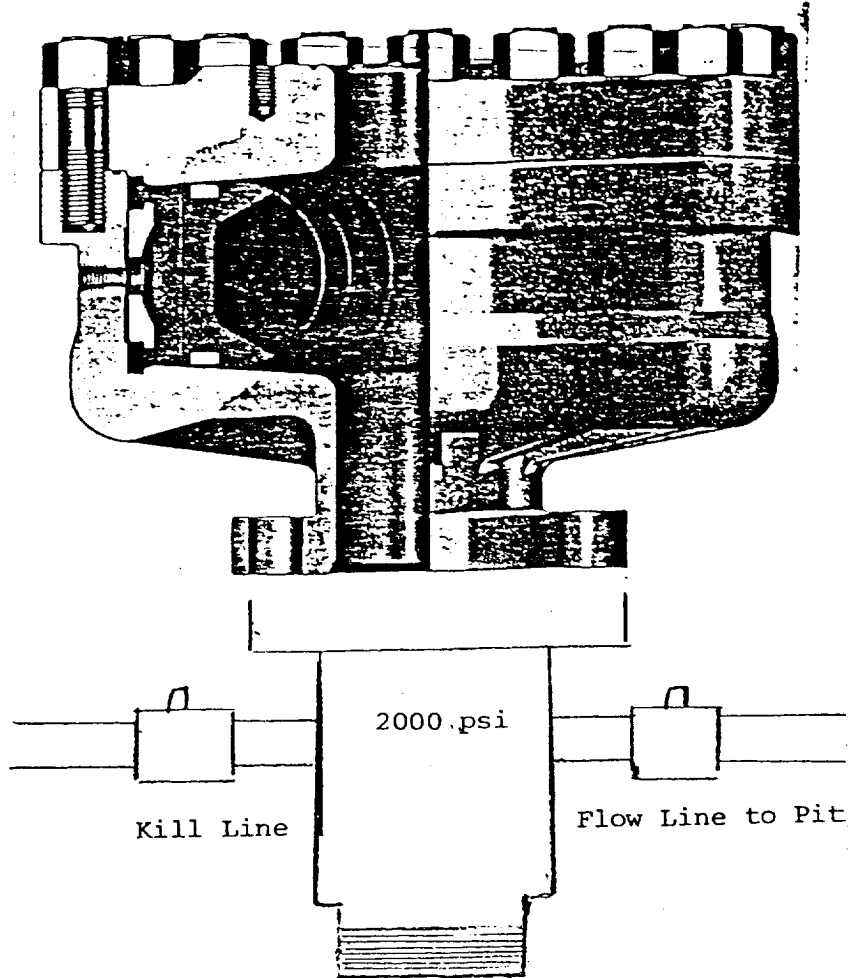

The Regan Torus Blowout Preventer is used primarily on production and workover rigs for well control up to 3000 PSI working pressure

DESIGN FEATURES

- The Torus Preventer is designed for minimum height to facilitate its use with production and workover rigs.
- The rubber packer will conform to any object in the well bore. Sealing ability is not affected by minor damage to the inner bore.
- The packer will seal on open hole at full working pressure.
- The dual packer design increases the reliability of the preventer since the outer rubber is never exposed to the well bore. Under ordinary service, the outer packer is rarely replaced.

TORUS BLOWOUT PREVENTER
PATENTED

SPECIFICATIONS

| Nominal Size | Test Pressure (psi) | DIMENSIONS (In.) | | | Weight (lb.) | End Flanges (I) | R/RX Ring Grooves | Side Outlet |
|--------------|---------------------|------------------|-----------|----------------|--------------|-----------------|-------------------|-------------|
| | | Outside Diameter | Thru Bore | Overall Height | | | | |
| 6 | 3000 | 27 | 7 1/4 | 19 1/4 | 1360 | Nom. 6 | 45 | None |
| | 6000 | 28 3/4 | 7 1/4 | 21 1/4 | 1950 | Nom. 6 | 45 | 2" L.P. |

UNITED STATES
DEPARTMENT OF THE INTERIOR
GEOLOGICAL SURVEY

SUNDRY NOTICES AND REPORTS ON WELLS

(Do not use this form for proposals to drill or to deepen or plug back to a different reservoir. Use Form 9-331-C for such proposals.)

1. oil well ☐ gas well ☐ other ☐
2. NAME OF OPERATOR
Ladd Petroleum Corp.
3. ADDRESS OF OPERATOR
Box 208, Farmington, NM 87401
4. LOCATION OF WELL (REPORT LOCATION CLEARLY. See space 17 below.)
AT SURFACE: 1120' FSL - 1540' FWL
AT TOP PROD. INTERVAL:
AT TOTAL DEPTH:

16. CHECK APPROPRIATE BOX TO INDICATE NATURE OF NOTICE, REPORT, OR OTHER DATA

REQUEST FOR APPROVAL TO:

- TEST WATER SHUT-OFF ☐
- FRACTURE TREAT ☐
- SHOOT OR ACIDIZE ☐
- REPAIR WELL ☐
- PULL OR ALTER CASING ☐
- MULTIPLE COMPLETE ☐
- CHANGE ZONES ☐
- ABANDON* ☐
- (other) Change Plans

SUBSEQUENT REPORT OF:

- ☐
- ☐
- ☐
- ☐
- ☐
- ☐
- ☐
- ☐

5. LEASE

NM 0206995

6. IF INDIAN, ALLOTTEE OR TRIBE NAME

7. UNIT AGREEMENT NAME

8. FARM OR LEASE NAME

Aztec 34

9. WELL NO.

2

10. FIELD OR WILDCAT NAME

Harper Hill Fruitland

11. SEC., T., R., M., OR BLK. AND SURVEY OR AREA

Sec 34 T30N R14W

12. COUNTY OR PARISH

San Juan

13. STATE

NM

14. API NO.

15. ELEVATIONS (SHOW DF, KDB, AND WD)

5506' GR

(NOTE: Report results of multiple completion or zone change on Form 9-330.)

17. DESCRIBE PROPOSED OR COMPLETED OPERATIONS (Clearly state all pertinent details, and give pertinent dates, including estimated date of starting any proposed work. If well is directionally drilled, give subsurface locations and measured and true vertical depths for all markers and zones pertinent to this work.)*

Plan to change plans from APD filed 8-7-79 as follows:

1. Change location of well per C-102
2. Plan to set 90' of 7" surface pipe and cement to surface w/20 sx
3. Plan to use BOP as required by USGS. (6" 600 series.)

Subsurface Safety Valve: Manu. and Type

18. I hereby certify that the foregoing is true and correct.

SIGNED

Thomas A. Dugan

TITLE

Agent

DATE

8-29-79

(This space for Federal or State office use)

APPROVED BY

TITLE

DATE

CONDITIONS OF APPROVAL, IF ANY:

