

UNITED STATES
DEPARTMENT OF THE INTERIOR
GEOLOGICAL SURVEY

30-045-03870

5. LEASE DESIGNATION AND SERIAL NO.

NM 0206995

6. IF INDIAN ALLOTTEE OR TRIBE NAME

7. UNIT AGREEMENT NAME

8. FARM OR LEASE NAME

Aztec 35

9. WELL NO.

5-5

10. FIELD AND FOUL, OR WILDCAT

Harper Hill Fruitland

11. SEC., T., R., M., OR BLK.
AND SURVEY OR AREA

Section 35 T30N R14W

12. COUNTY OR PARISH

San Juan

13. STATE

NM

APPLICATION FOR PERMIT TO DRILL, DEEPEN, OR PLUG BACK

1a. TYPE OF WORK

DRILL ☒DEEPEN ☐PLUG BACK ☐

b. TYPE OF WELL

OIL
WELL ☐GAS
WELL ☒

OTHER

SINGLE
ZONE ☐MULTIPLE
ZONE ☐

2. NAME OF OPERATOR

Ladd Petroleum Corp.

3. ADDRESS OF OPERATOR

Box 208, Farmington, NM 87401

4. LOCATION OF WELL (Report location clearly and in accordance with any State requirements.)*

At surface

1470' FSL - 1640' FEL

At proposed prod. zone

1120'

14. DISTANCE IN MILES AND DIRECTION FROM NEAREST TOWN OR POST OFFICE*

3 miles west of Farmington, NM

15. DISTANCE FROM PROPOSED*

LOCATION TO NEAREST
PROPERTY OR LEASE LINE, FT.
(Also to nearest drlg. unit line, if any)

1170'

16. NO. OF ACRES IN LEASE

17. NO. OF ACRES ASSIGNED
TO THIS WELL

160

18. DISTANCE FROM PROPOSED LOCATION*
TO NEAREST WELL, DRILLING, COMPLETED,
OR APPLIED FOR, ON THIS LEASE, FT.

1/2 mile

19. PROPOSED DEPTH

1300'

20. ROTARY OR CABLE TOOLS

Rotary

21. ELEVATIONS (Show whether DF, RT, GR, etc.)

5495'

22. APPROX. DATE WORK WILL START*

Aug. 20, 1979

23. PROPOSED CASING AND CEMENTING PROGRAM

SIZE OF HOLE	SIZE OF CASING	WEIGHT PER FOOT	SETTING DEPTH	QUANTITY OF CEMENT
8-3/4"	7" used	20#	40'	10 SX class "B"
4-3/4"	2-7/8" new	6.4#	1300'	100 SX **

Plan to drill well using mud as circulating medium to test Pictured Cliffs formation. If productive, plan to set 2-7/8" tbg for csg, selectively perforate, frac, clean out after frac, run 1-1/4" tbg and complete well. Plan to run IES log.

Do not plan to use a blowout preventer while drilling master valve and stripper head while completing well.

NMRB: Gas not dedicated.

**75 sx 2% Lodense w/1/4# cello flake per sx followed by 25 sx class "B" w/1/4# cello flake per sx

IN ABOVE SPACE DESCRIBE PROPOSED PROGRAM: If proposal is to deepen or plug back, give data on present productive zone and proposed new productive zone. If proposal is to drill or deepen directionally, give pertinent data on subsurface locations and measured and true vertical depths. Give blowout preventer program, if any.

24.

SIGNED

2. A. Dugan

TITLE

Agent

DATE

8-7-79

(This space for Federal or State office use)

PERMIT NO.

APPROVAL DATE

APPROVED BY

TITLE

DATE

CONDITIONS OF APPROVAL, IF ANY:

NMMCC

**NEW MEXICO OIL CONSERVATION COMMISSION
WELL LOCATION AND ACREAGE DEDICATION PLAT**

Form C-102
Supersedes C-128
Effective 1-1-65

All distances must be from the outer boundaries of the Section.

Operator Ladd Petroleum			Lease Aztec 35		Well No. 5-44
Unit Letter 0	Section 35	Township 30 North	Range 14 West	County San Juan	
Actual Footage Location of Well: <div style="display: flex; justify-content: space-between;"> 1120 feet from the South line and 1640 feet from the East line </div>					
Ground Level Elev. 5493	Producing Formation Fruitland	Pool Harper Hill	Dedicated Acreage: 160 Acres		

1. Outline the acreage dedicated to the subject well by colored pencil or hachure marks on the plat below.
2. If more than one lease is dedicated to the well, outline each and identify the ownership thereof (both as to working interest and royalty).
3. If more than one lease of different ownership is dedicated to the well, have the interests of all owners been consolidated by communitization, unitization, force-pooling, etc?

☐ Yes ☐ No If answer is "yes," type of consolidation _____

If answer is "no," list the owners and tract descriptions which have actually been consolidated. (Use reverse side of this form if necessary.) _____

No allowable will be assigned to the well until all interests have been consolidated (by communitization, unitization, forced-pooling, or otherwise) or until a non-standard unit, eliminating such interests, has been approved by the Commission.

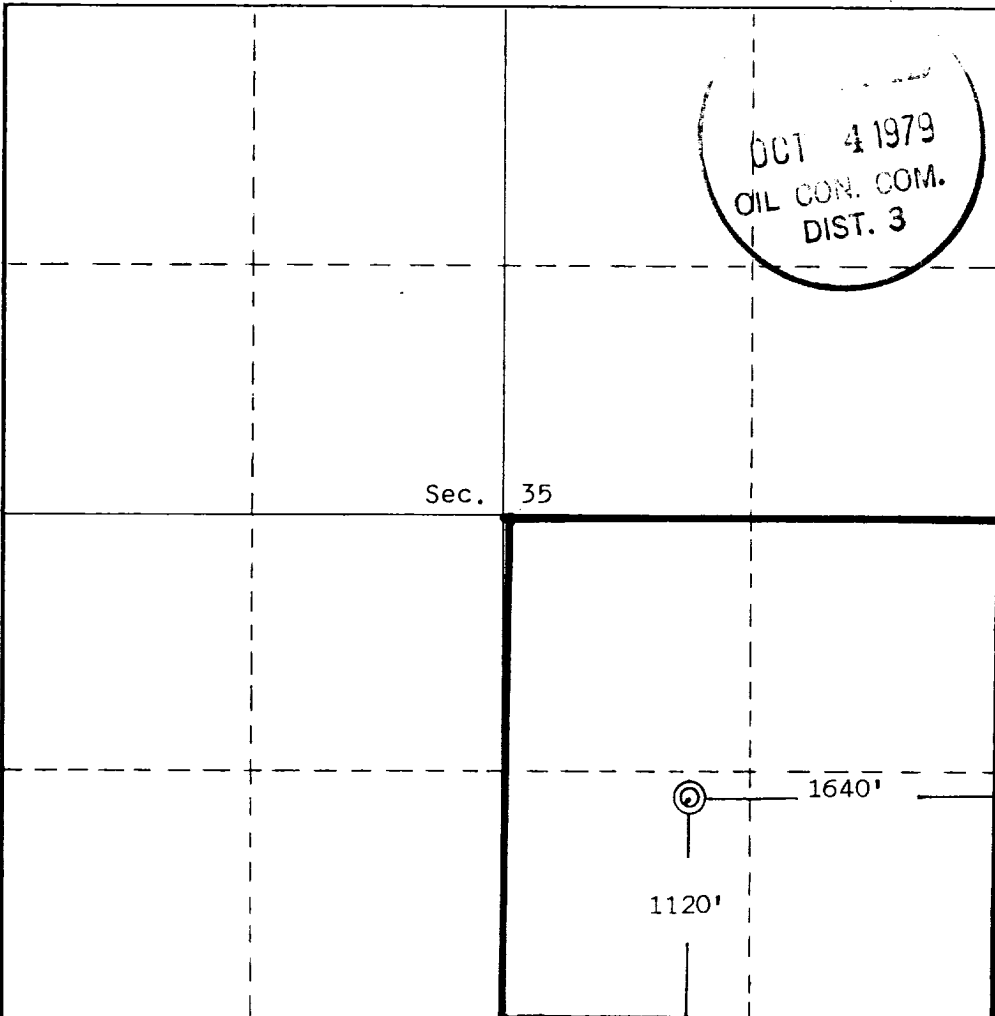

CERTIFICATION

I hereby certify that the information contained herein is true and complete to the best of my knowledge and belief.

Thomas A. Dugan
 Name **Thomas A. Dugan**
 Position **Agent**
 Company **Ladd Petroleum Corp.**
 Date **8-29-79**

I hereby certify that the location shown on this plat was located in the field notes of a duly surveyed road, or under my supervision, and that the same is correct to the best of my knowledge and belief.

Edgar L. Risenhoover
 Date Surveyed **August 28, 1979**
 Registered Professional Engineer and/or Land Surveyor
 Certificate No. **5979**
Edgar L. Risenhoover, L.S.

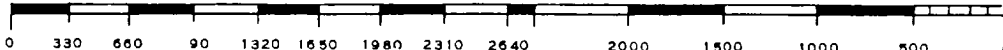

SCHEMATIC DIAGRAM

TESTING PROCEDURES

Install BOP after setting surface pipe and pressure test to 1000 psi after drilling out from under surface pipe.

REGAN BLOWOUT PREVENTERS

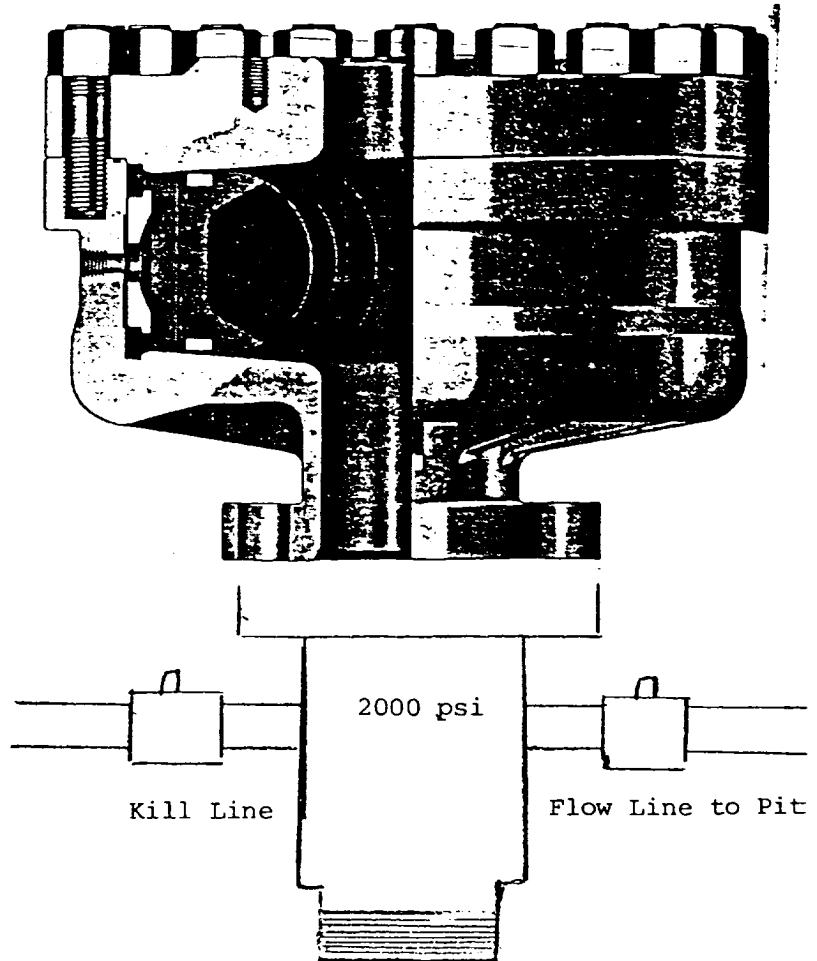

The Regan Torus Blowout Preventer is used primarily on production and workover rigs for well control up to 3000 PSI working pressure

DESIGN FEATURES

- The Torus Preventer is designed for minimum height to facilitate its use with production and workover rigs.
- The rubber packer will conform to any object in the well bore. Sealing ability is not affected by minor damage to the inner bore.
- The packer will seal on open hole at full working pressure.
- The dual packer design increases the reliability of the preventer since the outer rubber is never exposed to the well bore. Under ordinary service, the outer packer is rarely replaced.

TORUS BLOWOUT PREVENTER PATENTED

SPECIFICATIONS

Nominal Size	Test Pressure (psi)	DIMENSIONS (In.)			Weight (lb.)	End Flanges (I)	R/RX Ring Grooves	Side Outlet
		Outside Diameter	Thru Bore	Overall Height				
6	3000 6000	27 28½	7¼ 7½	19½ 21½	1360 1950	Nom. 6 Nom. 6	45 45	None 2" L.P.

**UNITED STATES
DEPARTMENT OF THE INTERIOR
GEOLOGICAL SURVEY**

SUNDRY NOTICES AND REPORTS ON WELLS

(Do not use this form for proposals to drill or to deepen or plug back to a different reservoir. Use Form 9-331-C for such proposals.)

1. oil ☐ gas ☐ other ☐

2. NAME OF OPERATOR
Ladd Petroleum Corp.

3. ADDRESS OF OPERATOR
Box 208, Farmington, NM 87401

4. LOCATION OF WELL (REPORT LOCATION CLEARLY. See space 17 below.) 1120' FSL - 1640' FEL

AT SURFACE:
AT TOP PROD. INTERVAL:
AT TOTAL DEPTH:

16. CHECK APPROPRIATE BOX TO INDICATE NATURE OF NOTICE, REPORT, OR OTHER DATA

REQUEST FOR APPROVAL TO:

TEST WATER SHUT-OFF ☐
FRACTURE TREAT ☐
SHOOT OR ACIDIZE ☐
REPAIR WELL ☐
PULL OR ALTER CASING ☐
MULTIPLE COMPLETE ☐
CHANGE ZONES ☐
ABANDON* ☐

SUBSEQUENT REPORT OF:

(other) Change Plans

5. LEASE NM 0206995	
6. IF INDIAN, ALLOTTEE OR TRIBE NAME	
7. UNIT AGREEMENT NAME	
8. FARM OR LEASE NAME Aztec	
9. WELL NO. 5	
10. FIELD OR WILDCAT NAME Harper Hill Fruitland	
11. SEC., T., R., M., OR BLK. AND SURVEY OR AREA Sec 35 T30N R14W	
12. COUNTY OR PARISH San Juan	13. STATE NM
14. API NO.	
15. ELEVATIONS (SHOW DF, KDB, AND WD) 5493' GR	

(NOTE: Report results of multiple completion or zone change on Form 9-330.)

17. DESCRIBE PROPOSED OR COMPLETED OPERATIONS (Clearly state all pertinent details, and give pertinent dates, including estimated date of starting any proposed work. If well is directionally drilled, give subsurface locations and measured and true vertical depths for all markers and zones pertinent to this work.)*

Plan to change plans from APD filed 8-7-79 as follows:

1. Change location of well per C-102
2. Plan to set 90' of 7" surface pipe and cement to surface w/20 sx
3. Plan to use BOP as required by USGS. (6" 600 series.)

Subsurface Safety Valve: Manu. and Type _____

18. I hereby certify that the foregoing is true and correct

SIGNED

Thomas A. Dugan

TITLE

Agent
President

DATE

8-29-79

(This space for Federal or State office use)

APPROVED BY

TITLE

DATE

CONDITIONS OF APPROVAL, IF ANY:

7114000

