

30-045-24220

NO. OF COPIES RECEIVED		
DISTRIBUTION		
SANTA FE	1	
FILE	1	✓
U.S.G.S.	2	
LAND OFFICE	1	
OPERATOR	1	

## NEW MEXICO OIL CONSERVATION COMMISSION

Form C-101  
Revised 1-1-65

5A. Indicate Type of Lease	
STATE <input checked="" type="checkbox"/>	FEE <input type="checkbox"/>
5. State Oil & Gas Lease No.	
E-292-9	

## APPLICATION FOR PERMIT TO DRILL, DEEPEN, OR PLUG BACK

[illegible]

### PROPOSED CASING AND CEMENT PROGRAM

SIZE OF HOLE	SIZE OF CASING	WEIGHT PER FOOT	SETTING DEPTH	SACKS OF CEMENT	EST. TOP
13 3/4"	9 5/8"	36.00#	250'	250	Circulate
8 3/4"	7"	23.00#	3580'	300	1800'
6 1/4"	4 1/2"	10.50#	5925'	300	Top of liner

We propose to perforate the Mesaverde Zone and sand-water fracture with 200,000 gallons water and 200,000 lbs sand in two stages. Estimated tops: Fruitland 3005', Lewis 3475', Cliffhouse 5165', Point Lookout 5475', Mancos 5705'. A 3000 PSI WP; Series 10" - 900 adapted to Series 10" - 600 and 6" - 600 hydraulic blowout preventer equipped with blind and necessary pipe rams will be used with adequate kill and bleed off lines. A mud of sufficient weight to control the Fruitland will be used, well to be drilled with gas below 7" casing.

Compensated Density Gamma-Neutron logs will be run in open hole

Blow out preventers will be tested every trip.

gas is dehydrated

APPROVAL VALID  
FOR 90 DAYS UNLESS  
DRILLING COMMENCED.

**EXPIRES** 6-2-80



IN ABOVE SPACE DESCRIBE PROPOSED PROGRAM; IF PROPOSAL IS TO DEEPEN OR PLUG BACK, GIVE DATA ON PRESENT PRODUCTIVE ZONE AND PROPOSED NEW PRODUCTIVE ZONE. GIVE BLOWOUT PREVENTER PROGRAM, IF ANY.

I hereby certify that the information above is true and complete to the best of my knowledge and belief.

Signed DeLasso Loos Title District Manager Date 02-29-80

(This space for State Use)

APPROVED BY Frank J. Chene TITLE \_\_\_\_\_ SUPERVISOR DISTRICT # 3 DATE MAR 4 1980

CONDITIONS OF APPROVAL, IF ANY:

NEW MEXICO OIL CONSERVATION COMMISSION  
WELL LOCATION AND ACREAGE DEDICATION PLAT

Form C-102  
Supersedes C-128  
Effective 1-1-65

All distances must be from the outer boundaries of the Section.

Operator <b>BLACKWOOD &amp; NICHOLS</b>			Lease <b>NORTHEAST BLANCO UNIT</b>		Well No. <b>47-A</b>
Unit Letter <b>F</b>	Section <b>32</b>	Township <b>31 N.</b>	Range <b>7W.N.M.P.M.</b>	County <b>SAN JUAN</b>	
Actual Footage Location of Well: <b>1850</b> feet from the <b>north</b> line and <b>1850</b> feet from the <b>west</b> line					
Ground Level Elev. <b>6353 U.G.</b>	Producing Formation <b>Mesaverde</b>	Pool <b>Blanco-Mesaverde</b>		Dedicated Acreage: <b>320</b> Acres	

1. Outline the acreage dedicated to the subject well by colored pencil or hachure marks on the plat below.
2. If more than one lease is dedicated to the well, outline each and identify the ownership thereof (both as to working interest and royalty).
3. If more than one lease of different ownership is dedicated to the well, have the interests of all owners been consolidated by communitization, unitization, force-pooling, etc?

☒ Yes ☐ No If answer is "yes," type of consolidation Unitization

If answer is "no," list the owners and tract descriptions which have actually been consolidated. (Use reverse side of this form if necessary.)

No allowable will be assigned to the well until all interests have been consolidated (by communitization, unitization, forced-pooling, or otherwise) or until a non-standard unit, eliminating such interests, has been approved by the Commission.

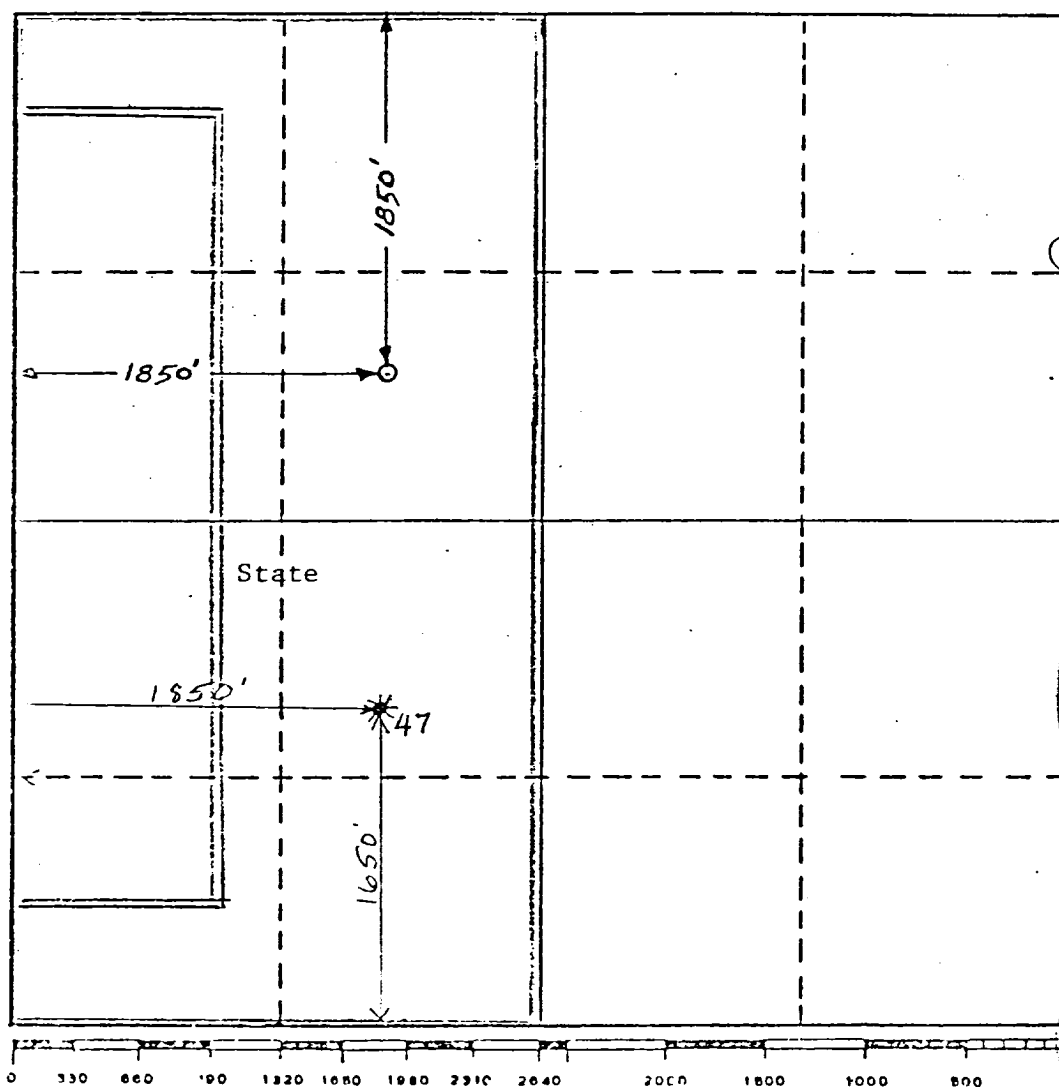

CERTIFICATION

I hereby certify that the information contained herein is true and complete to the best of my knowledge and belief.

DeLasse Loos

Name DeLasse Loos

Position District Manager

Company Blackwood & Nichols Co., Ltd.

Date January 21, 1980

I hereby certify that the well location shown on this plat was plotted from field notes and surveys made by me or under my supervision, and that the same are true and correct to the best of my knowledge and belief.

**RECEIVED**  
**MAR 4 1980**  
**OIL CON. COM.**  
**DIST. 3**

Date Surveyed Dec. 6, 1979

Registered Professional Engineer and/or Land Surveyor:  
John A. Kroeger, R.L.S.

Certificate No. 1941