

<b>Operator:</b> <u>PNM Gas Services (Floyd Oil Company)</u>		<b>Telephone:</b> <u>324-3764</u>	
<b>Address:</b> <u>603 W. Elm Street Farmington, NM 87401</u>			
<b>Facility or Well Name:</b> <u>New Mexico Federal N #1E</u>			
<b>Location:</b>	Unit <u>P</u>	Sec <u>17</u>	T <u>30 N</u> R <u>12 W</u> County <u>San Juan</u>
<b>Pit Type:</b>	Separator <input type="checkbox"/>	Dehydrator <input checked="" type="checkbox"/>	Other _____
<b>Land Type:</b>	BLM <input checked="" type="checkbox"/>	State <input type="checkbox"/>	Fee <input type="checkbox"/> Other _____
<b>Pit Location:</b>	Pit dimensions: length <u>18</u> ' width <u>18</u> ' depth <u>3</u> '		
(Attach diagram)	Reference:	wellhead <input checked="" type="checkbox"/>	other _____
	Footage from reference: <u>94</u> ' _____		
	Direction from reference:	<u>65</u> Degrees	<input type="checkbox"/> East North <input type="checkbox"/>
		<input checked="" type="checkbox"/> West	of South <input checked="" type="checkbox"/>
<b>Depth to Ground Water:</b>	Less than 50 feet (20 points) 50 feet to 99 feet (10 points) Greater than 100 feet (0 points)		
(Vertical distance from contaminants to seasonal high water elevation of ground water)	<div style="border: 1px solid black; padding: 5px; transform: rotate(-10deg); display: inline-block;"> <b>RECEIVED</b>  <b>JAN 31 2001</b>  <b>OIL CON. DIV.</b>  <b>DIST. 3</b> </div>		
<b>Wellhead Protection Area:</b>	Yes (20 points) No (0 points)		
(Less than 200 feet from a private domestic water source, or, less than 1,000 feet from all other water sources)			
<b>Distance to Surface Water:</b>	Less than 200 feet (20 points) 200 feet to 1,000 feet (10 points) Greater than 1,000 feet (0 points)		
(Horizontal distance to perennial lakes, ponds, rivers, streams, creeks, irrigation canals and ditches)			
<b>RANKING SCORE (TOTAL POINTS):</b>			<b>0</b>



|

New Mexico Federal N #1E

Date Remediation Started: 06/10/1999

Date Completed: 06/10/1999

Remediation Method:

Excavation

X

Approx. Cubic Yard

76

(Check all appropriate sections)

Landfarmed

X

Amount Landfarmed (cubic yds)

76

Other

Remediation Location:

Onsite

X

Offsite

(i.e., landfarmed onsite, name and location of offsite facility)

Backfill Material Location:

General Description of Remedial Action:

Excavated contaminated soil to a pit size of 17' X 20' X 6' and landfarmed soil onsite within a bermed area at a depth of 6" to 12". Soil was aerated by disking/plowing until soil met regulatory levels.

Ground Water Encountered:

No

☒

Yes

☐

Depth

Final Pit Closure Sampling:

Sample Location

5 pt. composite - bottom.

(if multiple samples, attach sample result and diagram of sample locations and depths.)

Sample depth

6'

Sample date

06/10/1999

Sample time

2:15:00 PM

Sample Results

Benzene (ppm) < 0.5

Total BTEX (ppm) 45.7

Field headspace (ppm)

TPH (ppm) 280.00

Method

8015B

Vertical Extent (ft)

Risk Analysis form attached

Yes

☐

No

☒

Ground Water Sample:

Yes

☐

No

☒

(If yes, see attached Groundwater Site Summary Report)

I HEREBY CERTIFY THAT THE INFORMATION ABOVE IS TRUE AND COMPLETE TO THE BEST OF MY KNOWLEDGE AND MY BELIEF

DATE January 24, 2000

SIGNATURE

*Maureen Gannon*

PRINTED NAME Maureen Gannon  
AND TITLE Project Manager



|

New Mexico Federal N#1E  
 (P) 17-30N-12W  
 Floyd Oil Company  
 6-10-99 @ 1153  
 65° W of S

↑  
N

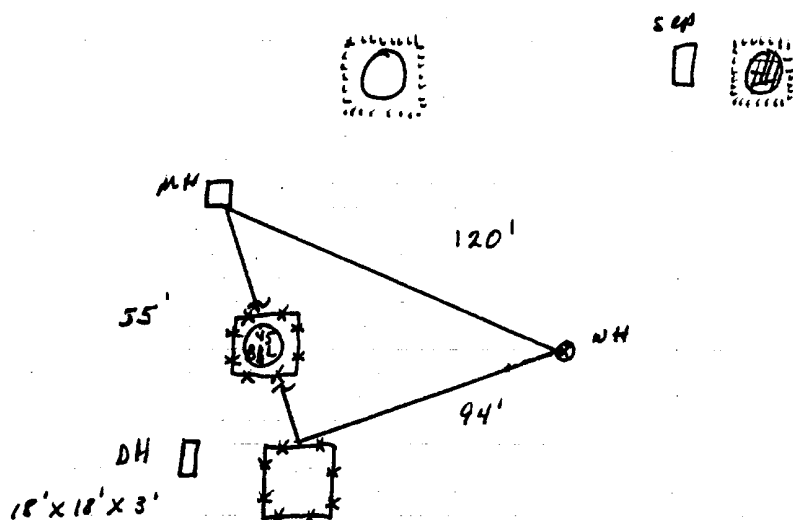

Excavation Sampling

17'(N+S) x 20'(E+W) x 6'(D)

PEO Readings  
 4' - 1776 ppm  
 6' - 1444 ppm

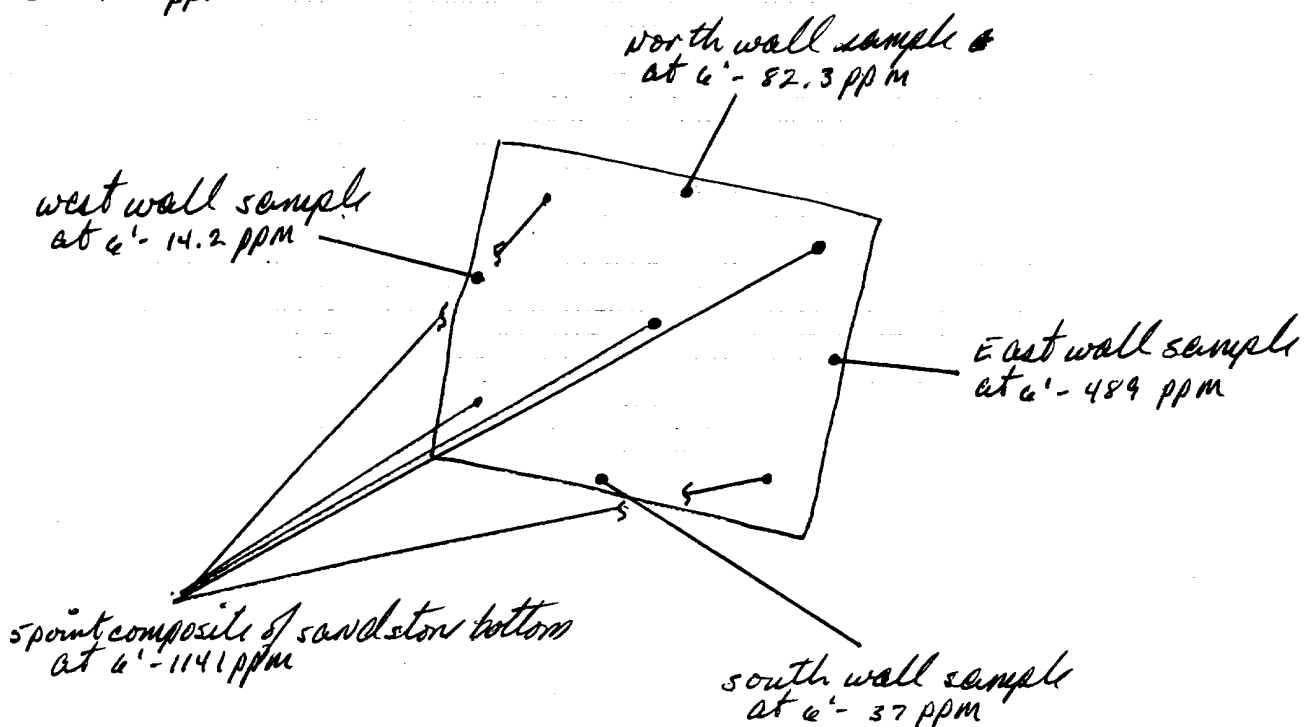

with C-1.



|

OFF: (505) 325-5667



LAB: (505) 325-1556

**On Site Technologies, LTD.**

**Date:** 28-Jun-99

---

**CLIENT:** PNM - Public Service Company of NM  
**Project:** PNM Pit Remediation  
**Lab Order:** 9906045

---

## **CASE NARRATIVE**

Samples were analyzed using the methods outlined in the following references:

Test Methods for Evaluating Solid Waste, Physical/Chemical Methods, SW846, 3rd Edition

All method blanks, laboratory spikes, and/or matrix spikes met quality assurance objectives.



|



OFF: (505) 325-5667



RH

LAB: (505) 325-1556

## ANALYTICAL REPORT

Date: 28-Jun-99

<b>Client:</b>	PNM - Public Service Company of NM	<b>Client Sample Info:</b>	NM Federal N#1E
<b>Work Order:</b>	9906045	<b>Client Sample ID:</b>	9906101415; 5pt. Bottom Comp
<b>Lab ID:</b>	9906045-03A	<b>Matrix:</b>	SOIL
<b>Project:</b>	PNM Pit Remediation	<b>Collection Date:</b>	6/10/99 2:15:00 PM
		<b>COC Record:</b>	7637

Parameter	Result	PQL	Qual	Units	DF	Date Analyzed
<b>DIESEL RANGE ORGANICS</b>		<b>SW8015B</b>				Analyst: DC
T/R Hydrocarbons: C10-C28	280	25		mg/Kg	1	6/24/99
<b>AROMATIC VOLATILES BY GC/PID</b>		<b>SW8021B</b>				Analyst: DC
Benzene	ND	500		µg/Kg	500	6/14/99
Toluene	4900	1000		µg/Kg	500	6/14/99
Ethylbenzene	2500	500		µg/Kg	500	6/14/99
m,p-Xylene	30000	1000		µg/Kg	500	6/14/99
o-Xylene	8300	500		µg/Kg	500	6/14/99

45700  
45.7 ppm

<b>Qualifiers:</b>	PQL - Practical Quantitation Limit	S - Spike Recovery outside accepted recovery limits
	ND - Not Detected at Practical Quantitation Limit	R - RPD outside accepted recovery limits
	J - Analyte detected below Practical Quantitation Limit	E - Value above quantitation range
	B - Analyte detected in the associated Method Blank	Surr: - Surrogate

P.O. BOX 2606 • FARMINGTON, NM 87499

1 of 1



|

OFF: (505) 325-5667



LAB: (505) 325-1556

## ANALYTICAL REPORT

Date: 28-Jun-99

<b>Client:</b>	PNM - Public Service Company of NM	<b>Client Sample Info:</b>	NM Federal N#1E
<b>Work Order:</b>	9906045	<b>Client Sample ID:</b>	9906101420; 4pt. Wall Comp
<b>Lab ID:</b>	9906045-04A	<b>Matrix:</b>	SOIL
<b>Project:</b>	PNM Pit Remediation	<b>Collection Date:</b>	6/10/99 2:20:00 PM
		<b>COC Record:</b>	7637

Parameter	Result	PQL	Qual	Units	DF	Date Analyzed
<b>DIESEL RANGE ORGANICS</b>		<b>SW8015B</b>				Analyst: DC
T/R Hydrocarbons: C10-C28	76	25		mg/Kg	1	6/24/99
<b>AROMATIC VOLATILES BY GC/PID</b>		<b>SW8021B</b>				Analyst: DC
Benzene	ND	50		µg/Kg	50	6/14/99
Toluene	110	100		µg/Kg	50	6/14/99
Ethylbenzene	69	50		µg/Kg	50	6/14/99
m,p-Xylene	520	100		µg/Kg	50	6/14/99
o-Xylene	120	50		µg/Kg	50	6/14/99

819  
819 ppm

**Qualifiers:**

PQL - Practical Quantitation Limit

ND - Not Detected at Practical Quantitation Limit

J - Analyte detected below Practical Quantitation Limit

B - Analyte detected in the associated Method Blank

S - Spike Recovery outside accepted recovery limits

R - RPD outside accepted recovery limits

E - Value above quantitation range

Surr: - Surrogate

P.O. BOX 2606 • FARMINGTON, NM 87499

1 of 1



|

NEW MEXICO FEDERAL ...  
Sec. 17 T. 30N R. 12W Unit P  
Floyd Oil Company

Landfarm Drawing

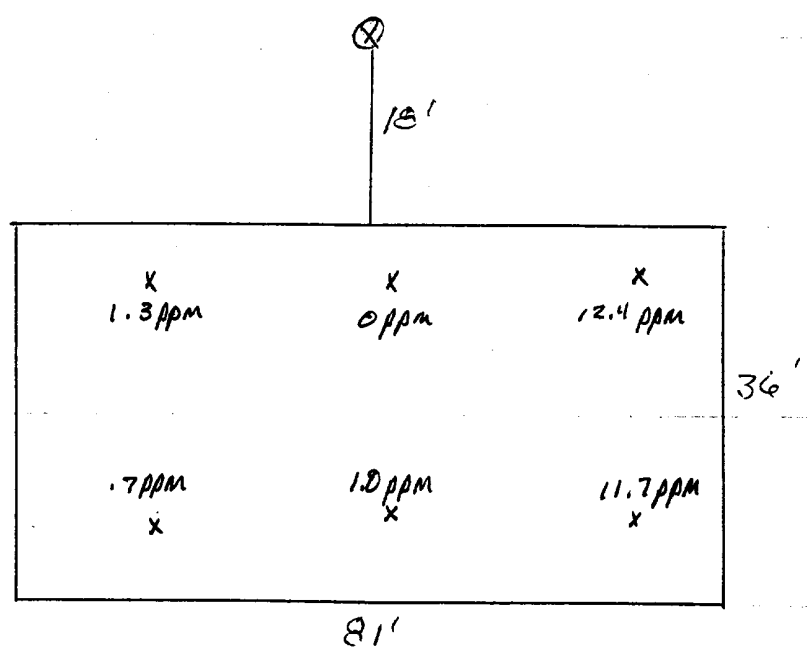

Not to Scale

2" to 12"

Head Space - 10.1 ppm  
Sample # - 9908101325

not to scale



|

OFF: (505) 325-5667



LAB: (505) 325-1556

**On Site Technologies, LTD.**

**Date:** 16-Aug-99

---

**CLIENT:** PNM - Public Service Company of NM  
**Project:** PNM Pit Remediation Landfarms  
**Lab Order:** 9908025

---

**CASE NARRATIVE**

Samples were analyzed using the methods outlined in the following references:

Test Methods for Evaluating Solid Waste, Physical/Chemical Methods, SW846, 3rd Edition

All method blanks, laboratory spikes, and/or matrix spikes met quality assurance objectives.





OFF: (505) 325-5667



LAB: (505) 325-1556

## ANALYTICAL REPORT

Date: 16-Aug-99

<b>Client:</b>	PNM - Public Service Company of NM	<b>Client Sample Info:</b>	NM Federal N #1E LF
<b>Work Order:</b>	9908025	<b>Client Sample ID:</b>	9908101325; 6pt. Composite
<b>Lab ID:</b>	9908025-02A	<b>Matrix:</b>	SOIL
<b>Project:</b>	PNM Pit Remediation Landfarms	<b>Collection Date:</b>	08/10/1999 1:25:00 PM
		<b>COC Record:</b>	7681

Parameter	Result	PQL	Qual	Units	DF	Date Analyzed
<b>DIESEL RANGE ORGANICS</b>		<b>SW8015B</b>				
T/R Hydrocarbons: C10-C28	ND	25		mg/Kg	1	Analyst: DC 08/11/1999

<b>Qualifiers:</b>	PQL - Practical Quantitation Limit	S - Spike Recovery outside accepted recovery limits
	ND - Not Detected at Practical Quantitation Limit	R - RPD outside accepted recovery limits
	J - Analyte detected below Practical Quantitation Limit	E - Value above quantitation range
	B - Analyte detected in the associated Method Blank	Surr: - Surrogate

1 of 1

P.O. BOX 2606 • FARMINGTON, NM 87499

- TECHNOLOGY BLENDING INDUSTRY WITH THE ENVIRONMENT -

