

UNITED STATES
DEPARTMENT OF THE INTERIOR
GEOLOGICAL SURVEY

APPLICATION FOR PERMIT TO DRILL, DEEPEN, OR PLUG BACK

1a. TYPE OF WORK

DRILL ☒DEEPEN ☐PLUG BACK ☐

b. TYPE OF WELL

OIL
WELL ☐GAS
WELL ☒

OTHER

SINGLE
ZONE ☐MULTIPLE
ZONE ☒

2. NAME OF OPERATOR

Supron Energy Corporation

3. ADDRESS OF OPERATOR

P.O. Box 808, Farmington, New Mexico 87401

4. LOCATION OF WELL (Report location clearly and in accordance with any State requirements.)*

At surface

1600 ft. from the South line and 945 ft. from the East line

At proposed prod. zone

Same as above

14. DISTANCE IN MILES AND DIRECTION FROM NEAREST TOWN OR POST OFFICE*

8 miles northeast of Blanco, New Mexico

15. DISTANCE FROM PROPOSED*

LOCATION TO NEAREST

PROPERTY OR LEASE LINE, FT.

(Also to nearest drlg. unit line, if any)

945 ft.

945 ft.

18. DISTANCE FROM PROPOSED*

TO NEAREST WELL, DRILLING, COMPLETED,

OR APPLIED FOR, ON THIS LEASE, FT.

1800 ft.

16. NO. OF ACRES IN LEASE

2197.12

19. PROPOSED DEPTH

8080

17. NO. OF ACRES ASSIGNED
TO THIS WELLE₂ 320.00

20. ROTARY OR CABLE TOOLS

Rotary

21. ELEVATIONS (Show whether DF, RT, GR, etc.)

6471 Gr.

22. APPROX. DATE WORK WILL START*

June 1, 1980

23.

PROPOSED CASING AND CEMENTING PROGRAM

SIZE OF HOLE	SIZE OF CASING	WEIGHT PER FOOT	SETTING DEPTH	QUANTITY OF CEMENT
12-1/4"	10-3/4"	32.75	250	175 sx
9-7/8"	7-5/8"	26.40	3650	325 sx
6-3/4"	5-1/2"	15.50	3500' to 8080'	500 sx

Surface hole will be drilled to T.D. of +250 ft. Csg. will be run and cement circulated to the surface. The intermediate hole will be drilled to T.D. of +3650' using mud as the circulating medium. Pipe will be run and cemented w/325 sx of cement with the estimated top of the cement at 1950 ft. The remainder of the hole will be drilled, using gas as the circulating medium to +8080 ft. A liner will be run to T.D. and hung off with a liner hanger at +3500 ft. The liner will be cemented with 500 sx of cement. The Dakota zone will be perforated and sand water fraced to stimulate production. A bridge plug set above the Dakota zone. The Mesaverde zone perforated and sand water fraced to stimulate production. The Mesaverde zone cleaned up. The bridge plug will be drilled out and the Dakota zone cleaned up. Tubing will be run with a production pkr. and set above the Dakota zone. A second string of tubing will be run and landed in the Mesaverde zone. The well head will be nipples down and a packer leakage test conducted to insure isolation of the two zones.

IN ABOVE SPACE DESCRIBE PROPOSED PROGRAM: If proposal is to deepen or plug back, give data on present productive zone and proposed new productive zone. If proposal is to drill or deepen directionally, give pertinent data on subsurface locations and measured and true vertical depths. Give blowout preventer program, if any.

24.

SIGNED

Rudy D. Motto
Rudy D. Motto

TITLE Area Superintendent

DATE May 2, 1980

(This space for Federal or State office use)

PERMIT NO.

APPROVAL DATE

APPROVED BY

CONDITIONS OF APPROVAL, IF ANY:

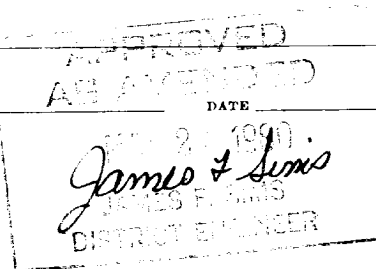
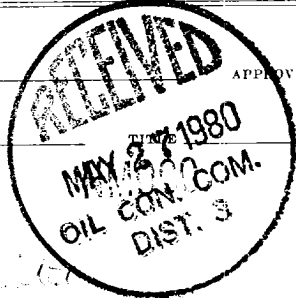

All distances must be from the outer boundaries of the section.

Operator SUPRON ENERGY CORPORATION			Lease QUINN		Well No. 4A
Unit Letter I	Section 19	Township 31 NORTH	Range 8 WEST, N.M.P.M.,	County SAN JUAN	
Actual Footage Location of Well: 1600 feet from the SOUTH line and 945 feet from the EAST line					
Ground Level Elev. 6471	Producing Formation Dakota Mesaverde		Pool Basin Blanco	Dedicated Acreage: Ex 320.00 Acres	

1. Outline the acreage dedicated to the subject well by colored pencil or hatchure marks on the plat below.
2. If more than one lease is dedicated to the well, outline each and identify the ownership thereof (both as to working interest and royalty).
3. If more than one lease of different ownership is dedicated to the well, have the interests of all owners been consolidated by communitization, unitization, force-pooling, etc?

☐ Yes ☐ No If answer is "yes," type of consolidation _____

If answer is "no," list the owners and tract descriptions which have actually been consolidated. (Use reverse side of this form if necessary.) _____

No allowable will be assigned to the well until all interests have been consolidated (by communitization, unitization, forced-pooling, or otherwise) or until a non-standard unit, eliminating such interests, has been approved by the Division.

CERTIFICATION

I hereby certify that the information contained herein is true and complete to the best of my knowledge and belief.

Linda A. Math
Name

Area Superintendent

Position

SUPRON ENERGY CORPORATION

Company

March 19, 1980

Date

I hereby certify that the well location shown on this plat is plotted from field notes, actual survey made by me or under my supervision, and that same is true and correct to the best of my knowledge.

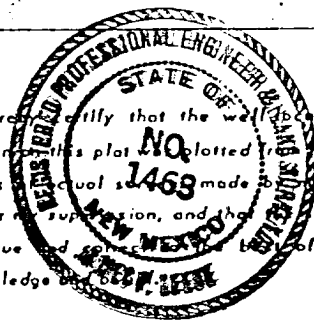

Date Surveyed

MARCH 4, 1980

Registered Professional Engineer and/or Land Surveyor

James P. Leese
James P. Leese

Certificate No.

1463

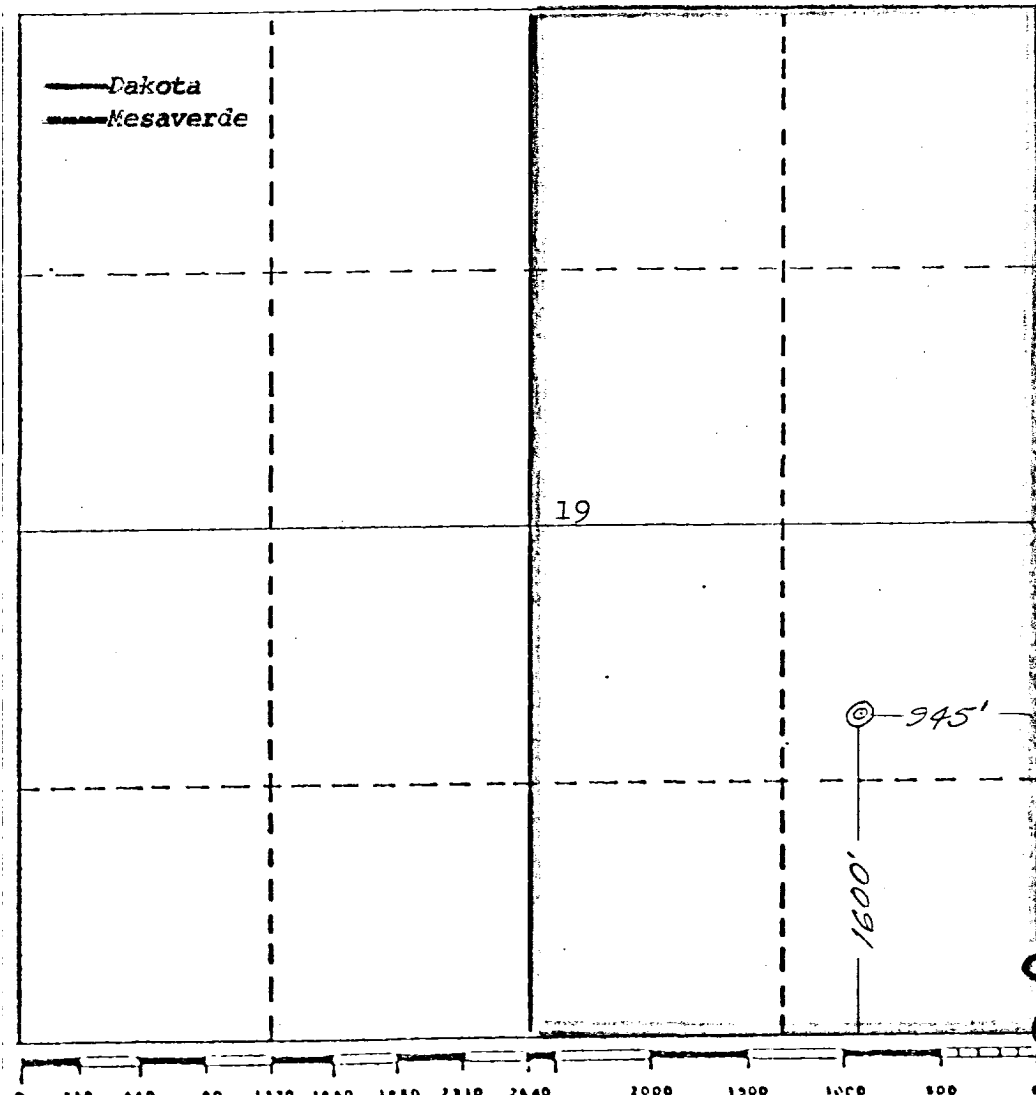

SUPRON ENERGY CORPORATION

Quinn No. 4-A

SE $\frac{1}{4}$ Sec. 19, T-31N, R-8W, N.M.P.M.

San Juan County, New Mexico

The following attachments are included with this application:

1. Topographical map showing the proposed location and access road.
2. Planned access road is 600 ft. long and 20 ft. wide. The road will follow natural contours of the land and will have drainage facilities installed to meet requirements of N.T.L. 6. No extra surfacing materials will be used.
3. Map showing existing producing facilities and access roads.
4. Location of surface equipment if required.
5. Drilling and completion water will be obtained from the San Juan River.
6. All pits will be fenced and constructed in such a way as to prevent litter on the location.
7. We will dispose of all waste by placing it in the reserve pit and burying it when the well is completed.
8. There will be no camp at or near the well site.
9. There will be no air strip.
10. A plat is attached showing the location of the rig, mud tanks, reserve pit, burn pit and etc.
11. A letter of certification is attached. The operator representative for compliance purposes is Rudy D. Mott, Area Superintendent, P.O. Box 808, Farmington, New Mexico 87401. Phone (505) 325-3587.
12. The soil is sandy clay, the principal vegetation is juniper, pinon, bitterbrush, mountain mahogany, sagebrush and snakeweed.



SUPRON ENERGY CORPORATION
QUINN # 4-A
SE $\frac{1}{4}$ Sec. 19, T31N, R8W.
San Juan County, New Mexico

Archuleta
Navajo Dam PO

LANDING STRIP

LOCATION AND EQUIPMENT LAYOUT
SUPRON ENERGY CORPORATION

Quinn No. 4-A

1600 feet from the South line and 945 feet from the East line of Section 19, Township 31 North, Range 8 West, N.M.P.M., San Juan County, New Mexico.

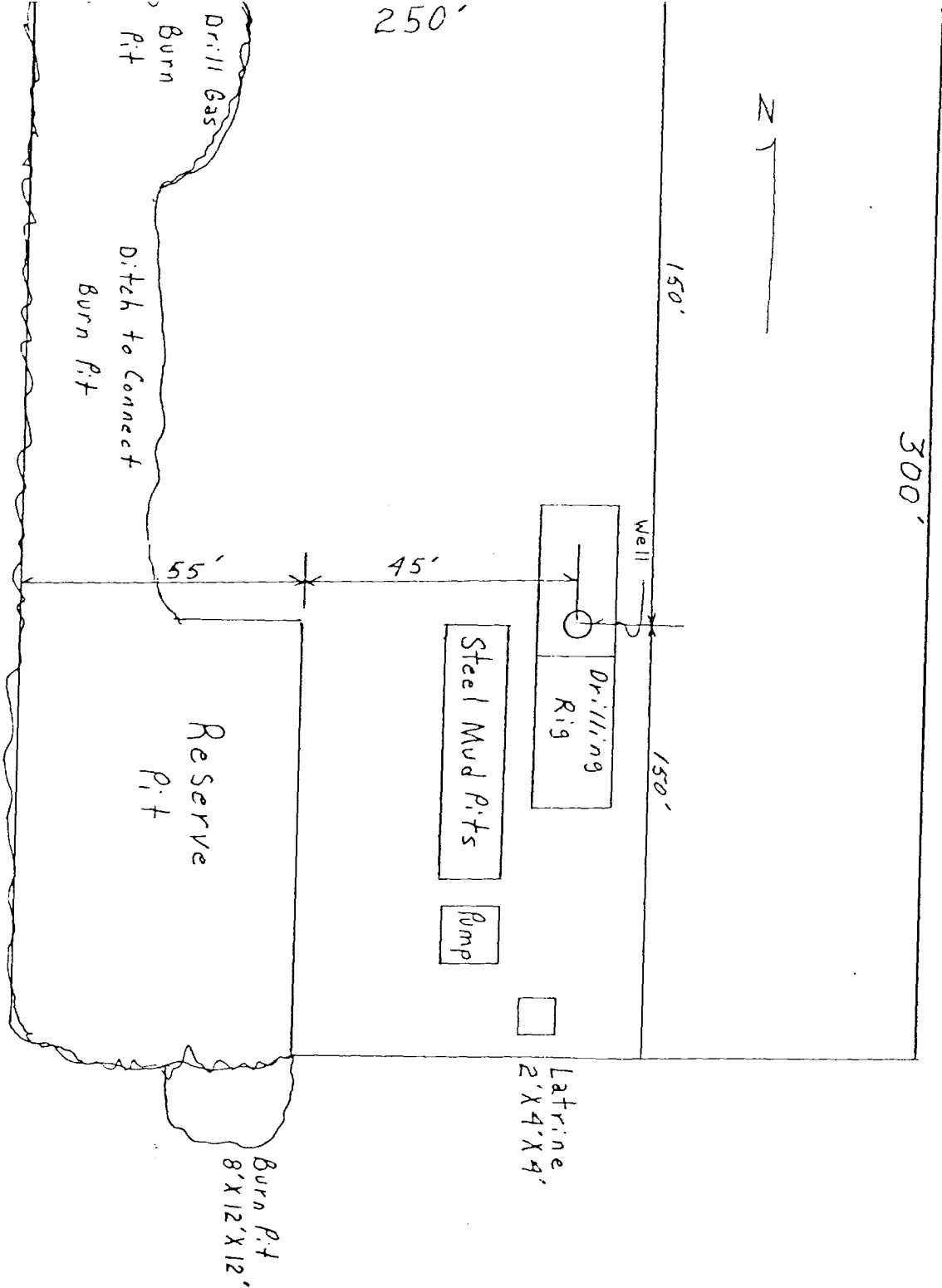

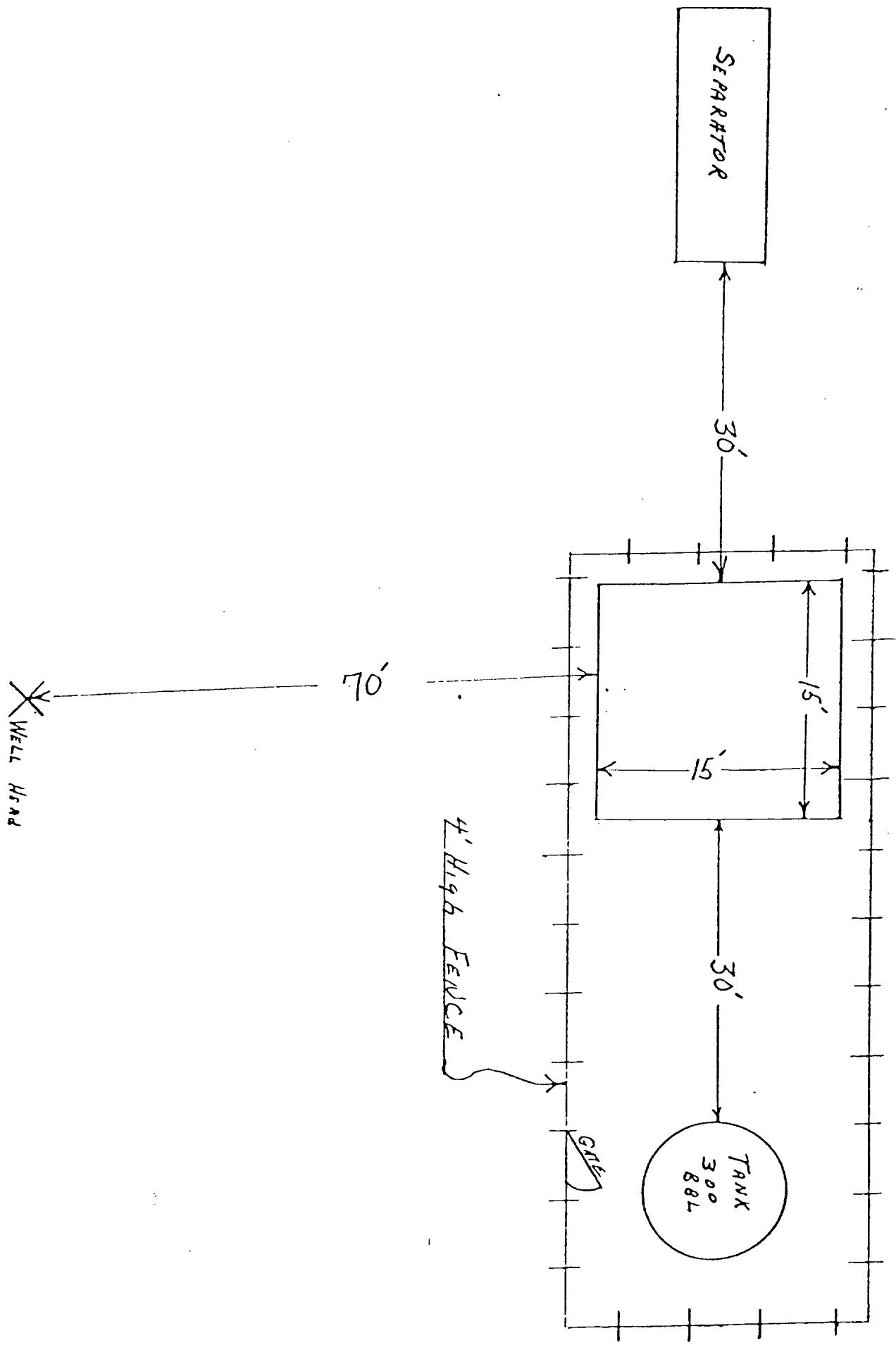

Blowout Preventer will be tested daily and prior to drilling out with the results to be logged on the drillers report.

The B.O.P. and all valve and fittings are rated at 3000 psi working pressure, and hydraulically operated

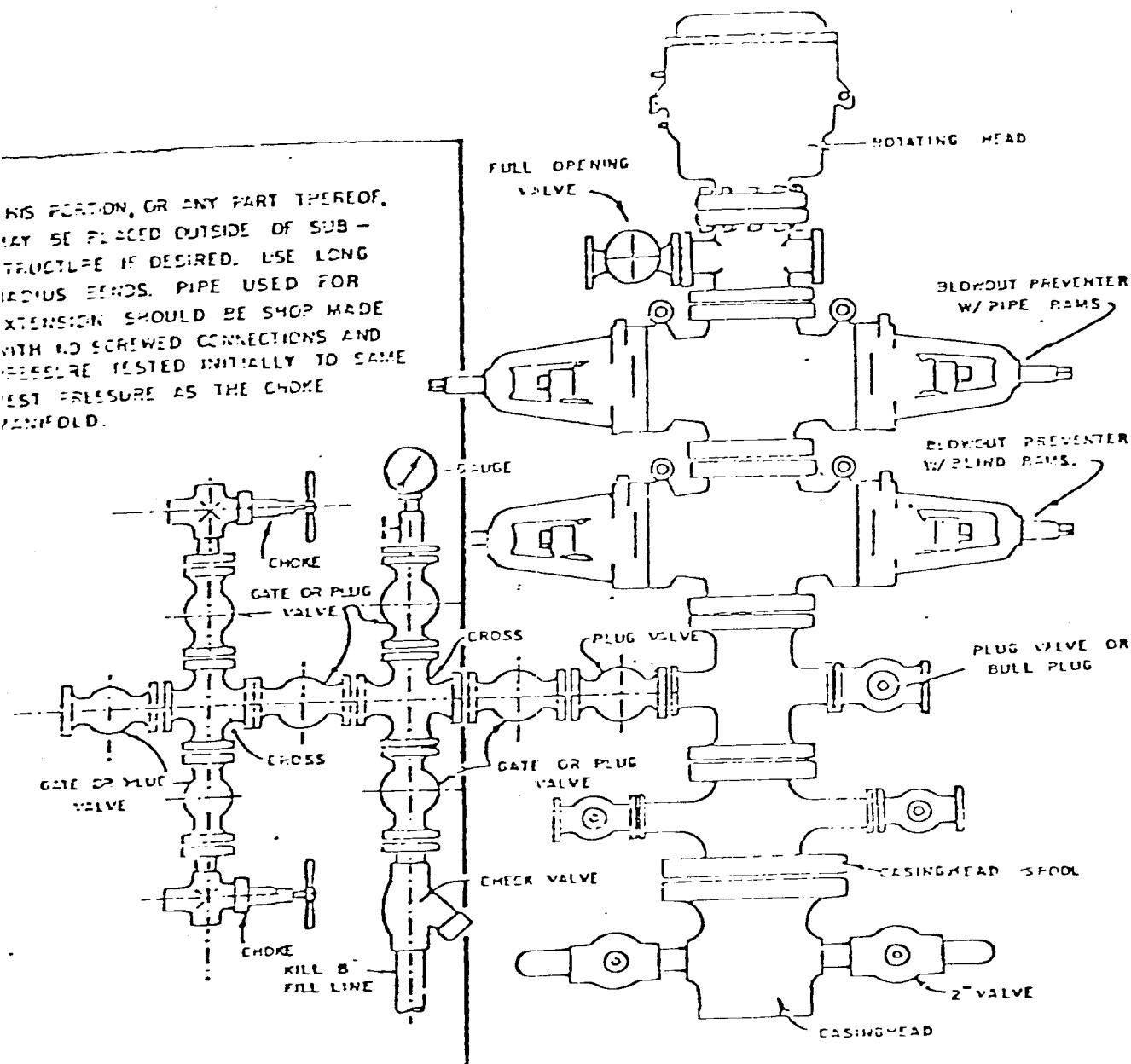

BLOWOUT PREVENTER HOOKUP

SUPRON ENERGY CORPORATION
Post Office Box 808
FARMINGTON, New Mexico 87401

I hereby certify that I, or persons under my direct supervision, have inspected the proposed drillsite and access route; that I am familiar with the conditions which presently exist; that the statements made in this plan are, to the best of my knowledge, true and correct; and, that the work associated with the operations proposed herein will be performed by SUPRON ENERGY CORPORATION and its contractors subcontractors in conformity with this plan and the terms and conditions under which it is approved.

SUPRON ENERGY CORPORATION

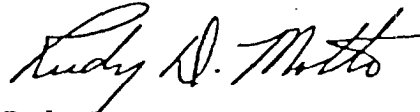
A handwritten signature in cursive script, reading "Rudy D. Motto".

Rudy D. Motto
Area Superintendent
Phone: 325-3587

Quinn No. 4-A
SE ¼ Sec. 19, T-31N, R-8W, N.M.P.M.
San Juan County, New Mexico

1. the geologic name of the surface formation is, "Wasatch".
2. The estimated tops of important geologic markers are:

A. Base of the Ojo Alamo	2230'
B. Kirtland	2230'
C. Fruitland	3010'
D. Pictured Cliffs	3350'
E. Chacra	4260'
F. Cliff House	5213'
G. Point Lookout	5614'
H. Gallup	7015'
I. Greenhorn	7640'
J. Dakota	8080'
3. The estimated depths at which anticipated water, oil or other mineral bearing formations are expected to be encountered are:

A. Ojo Alamo	2230'	Water
B. Kirtland	2230'	Water
C. Fruitland	3010'	Water
D. Pictured Cliffs	3350'	Water
E. Chacra	4260'	Water
F. Cliff House	5213'	Gas
G. Point Lookout	5614'	Gas
H. Gallup	7015'	Dry
I. Greenhorn	7640'	Shale
J. Dakota	8080'	Gas
4. The casing program is shown on form 9-331C and all casing is new.
5. The lessee's pressure control equipment schematics are attached, along with minimum specifications, testing procedures, and frequencies.
6. The type, estimated volumes, and characteristics of the circulating medium are as follows:

A. 0 to 250 ft.	Natural Mud
B. 250 to 3650 ft.	Permaloid non dispersed mud containing approx. 90 sx gel, 35 sx of permaloid and 10 sx of C.M.C.
C. 3500 to 8080 ft.	Natural Gas
7. The auxiliary equipment to be used will be floats at the bit and a sub on the floor with a full opening valve to be stabbed into the drill pipe when the kelly is not in the string.
8. The well is in an area which is partially developed, therefore we will not have a testing and coring program. The logging program is as follows:

A. E.S. Induction
B. Gamma Ray Density
C. Gamma Ray Correlation
D. Cement Bond Log
9. We do not expect to find any abnormal pressures, temperatures or hydrogen sulfide problems in this partially developed area.
10. The anticipated starting date for this well is June 1, 1980.