

NO. OF COPIES RECEIVED	
DISTRIBUTION	
SANTA FE	
FILE	
U.S.G.S.	
LAND OFFICE	
OPERATOR	

NEW MEXICO OIL CONSERVATION COMMISSION

30-045-245-42

Form C-101
Revised 1-1-65

5A. Indicate Type of Lease	
STATE <input checked="" type="checkbox"/>	FEE <input type="checkbox"/>
5. State Oil & Gas Lease No.	
E 956-1	

APPLICATION FOR PERMIT TO DRILL, DEEPEN, OR PLUG BACK

1a. Type of Work		7. Unit Agreement Name	
b. Type of Well OIL WELL <input type="checkbox"/> GAS WELL <input checked="" type="checkbox"/> OTHER <input type="checkbox"/>		8. Farm or Lease Name Atlantic D Com P	
2. Name of Operator El Paso Natural Gas Company		9. Well No. 17	
3. Address of Operator PO Box 289, Farmington, NM 87401		10. Field and Pool, or Wildcat Blanco PC ext	
4. Location of Well UNIT LETTER G LOCATED 1670 FEET FROM THE North LINE AND 1610 FEET FROM THE East LINE OF SEC. 36 TWP. 31 RGE. 10 NMPM		12. County San Juan	
21. Elevations (Show whether DF, RT, etc.) 6640'		19. Proposed Depth 3620'	
21A. Kind & Status Plug. Bond statewide		19A. Formation Pic.Cliffs	
21B. Drilling Contractor		20. Rotary or C.T. Rotary	
22. Approx. Date Work will start			

PROPOSED CASING AND CEMENT PROGRAM

SIZE OF HOLE	SIZE OF CASING	WEIGHT PER FOOT	SETTING DEPTH	SACKS OF CEMENT	EST. TOP
12 1/4"	8 5/8"	24.0#	200'	140	surface
7 7/8"	4 1/2"	10.5#	3620'	348	Ojo Alamo 2050'
					Ojo Alamo 2050'

Selectively perforate and sandwater fracture the Pictured Cliffs formation.

A 3000 psi WP and 6000 psi test double gate preventer equipped with blind and pipe rams will be used for blow out prevention on this well.

This gas is dedicated.

The NE/4 of Section 36 is dedicated to this well.

APPROVAL VALID
FOR 90 DAYS UNLESS
DRILLING COMMENCED.

EXPIRES 12-2-80



IN ABOVE SPACE DESCRIBE PROPOSED PROGRAM. IF PROPOSAL IS TO DEEPEN OR PLUG BACK, GIVE DATA ON PRESENT PRODUCTIVE ZONE AND PROPOSED NEW PRODUCTIVE ZONE. GIVE BLOWOUT PREVENTER PROGRAM, IF ANY.

I hereby certify that the information above is true and complete to the best of my knowledge and belief.

Signed Regan Bradford Title Drilling Clerk Date 9-2-80

(This space for State Use)

APPROVED BY Frank S. Day TITLE SUPERVISOR DISTRICT #3 DATE SEP 3 1980

CONDITIONS OF APPROVAL, IF ANY:

SEP 3 1980

All distances must be from the outer boundaries of the Section.

Operator EL PASO NATURAL GAS COMPANY			Lease ATLANTIC D COM P (NM-E-956-1)		Well No. 17
Well Letter G	Section 36	Township 31N	Range 10W	County San Juan	
Actual Footage Location of Well:					
1670 feet from the North line and		1610 feet from the East line			
Ground Level Elev. 6640	Producing Formation PICTURED CLIFFS		Pool BLANCO PICTURED CLIFFS ext	Dedicated Acreage: 160.00 Acres	

1. Outline the acreage dedicated to the subject well by colored pencil or hachure marks on the plat below.
2. If more than one lease is dedicated to the well, outline each and identify the ownership thereof (both as to working interest and royalty).
3. If more than one lease of different ownership is dedicated to the well, have the interests of all owners been consolidated by communitization, unitization, force-pooling, etc?

☐ Yes ☐ No If answer is "yes," type of consolidation _____

If answer is "no," list the owners and tract descriptions which have actually been consolidated. (Use reverse side of this form if necessary.) _____

No allowable will be assigned to the well until all interests have been consolidated (by communitization, unitization, forced-pooling, or otherwise) or until a non-standard unit, eliminating such interests, has been approved by the Commission.

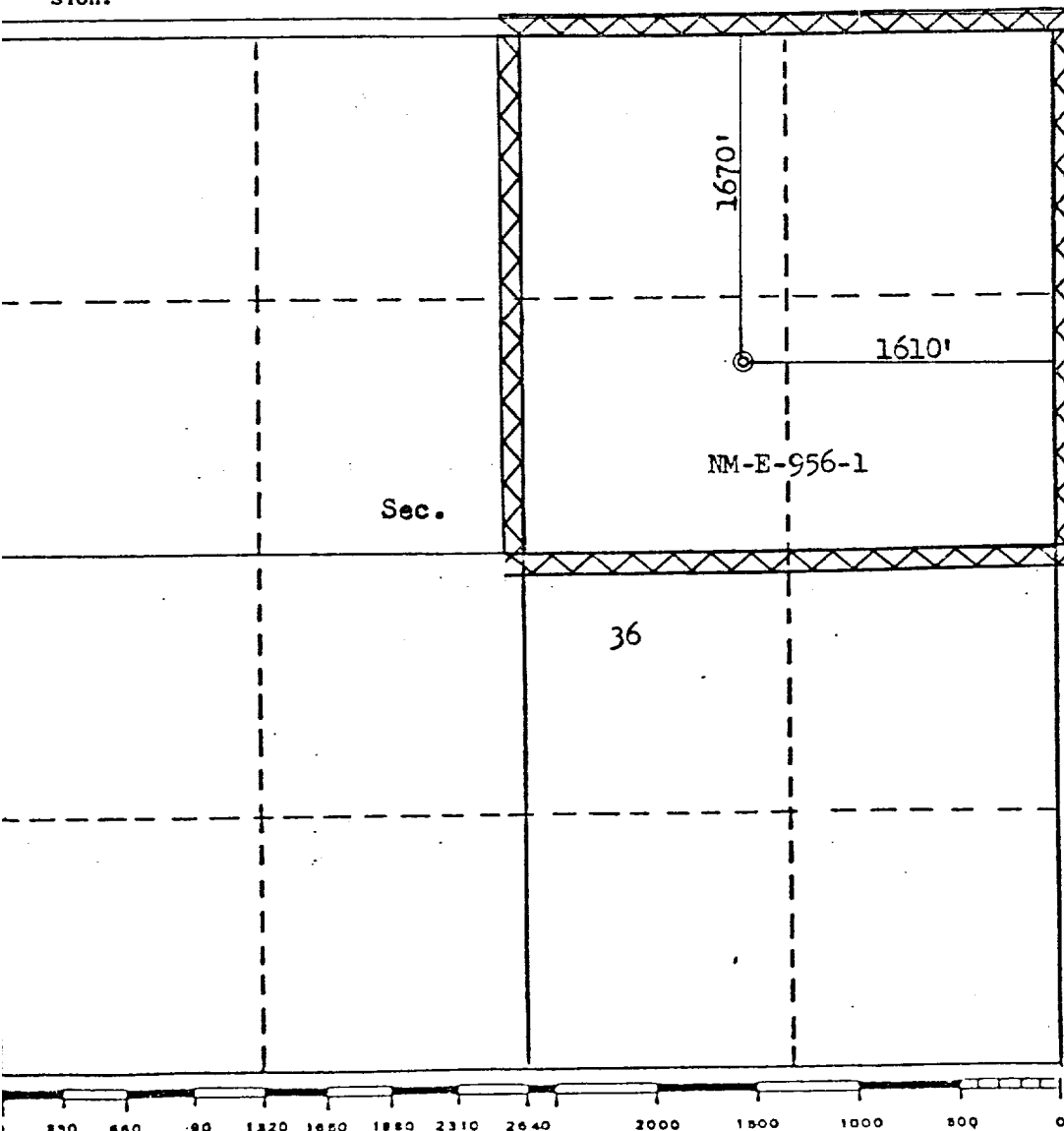

CERTIFICATION

I hereby certify that the information contained herein is true and complete to the best of my knowledge and belief.

Reggie Deadfield
Name

Drilling Clerk

Position
El Paso Natural Gas

Company
September 2, 1980

Date

I hereby certify that the well location shown on this plat was plotted from field notes of actual surveys made by me or under my supervision, and that the same is true and correct to the best of my knowledge and belief.

Date Surveyed
August 2, 1980

Registered Professional Engineer
and/or Land Surveyor

Fred B. Kerr Jr.
Fred B. Kerr Jr.

Certificate No.
3950