

NO. OF COPIES RECEIVED	
DISTRIBUTION	
SANTA FE	
FILE	
U.S.G.S.	
LAND OFFICE	
OPERATOR	

**ABANDONED LOCATION**

NEW MEXICO OIL CONSERVATION COMMISSION

30-045-245-43

Form C-101  
Revised 1-1-65

5A. Indicate Type of Lease STATE <input checked="" type="checkbox"/> FEE <input type="checkbox"/>
5. State Oil & Gas Lease No. B-10400-1
7. Unit Agreement Name
8. Farm or Lease Name Atlantic D Com I
9. Well No. 10
10. Field and Pool, or Wildcat Blanco PC
12. County San Juan
19. Proposed Depth 3610'
19A. Formation PC
20. Rotary or C.T. Rotary
21. Elevations (Show whether DF, RT, etc.) 6663' GL
21A. Kind & Status Plug. Bond statewide
21B. Drilling Contractor
22. Approx. Date Work will start

APPLICATION FOR PERMIT TO DRILL, DEEPEN, OR PLUG BACK

1a. Type of Work b. Type of Well OIL WELL <input type="checkbox"/> GAS WELL <input checked="" type="checkbox"/> OTHER <input type="checkbox"/> DRILL <input checked="" type="checkbox"/> DEEPEN <input type="checkbox"/> PLUG BACK <input type="checkbox"/> SINGLE ZONE <input checked="" type="checkbox"/> MULTIPLE ZONE <input type="checkbox"/>	2. Name of Operator El Paso Natural Gas Company	3. Address of Operator PO Box 289, Farmington, NM 87401	4. Location of Well UNIT LETTER M LOCATED 1020 FEET FROM THE South LINE AND 847 FEET FROM THE West LINE OF SEC. 36 TWP. 31 N RGE. 10 W NMPM
23. PROPOSED CASING AND CEMENT PROGRAM			

SIZE OF HOLE	SIZE OF CASING	WEIGHT PER FOOT	SETTING DEPTH	SACKS OF CEMENT	EST. TOP
12 1/4"	8 5/8"	24.0#	200'	140	surface
7 7/8"	4 1/2"	10.5#	3610'	351	Ojo Alamo 2025'

Selectively perforate and sandwater fracture the Pictured Cliffs formation.

A 3000 psi WP and 6000 psi test double gate preventer equipped with blind and pipe rams will be used for blow out prevention on this well.

This gas is dedicated.

The SW/4 of Section 36 is dedicated to this well.

APPROVAL VALID  
FOR 90 DAYS UNLESS  
DRILLING COMMENCED,

EXPIRES 12-2-80

IN ABOVE SPACE DESCRIBE PROPOSED PROGRAM: IF PROPOSAL IS TO DEEPEN OR PLUG BACK, GIVE DATA ON PRESENT PRODUCTIVE ZONE AND PROPOSED NEW PRODUCTIVE ZONE. GIVE BLOWOUT PREVENTER PROGRAM, IF ANY.

I hereby certify that the information above is true and complete to the best of my knowledge and belief.

Signed Pepper Bradford Title Drilling Clerk Date 9-2-80

(This space for State Use)

APPROVED BY Frank J. Long TITLE SUPERVISOR DISTRICT #3 DATE SEP 3 1980

CONDITIONS OF APPROVAL, IF ANY:

**NEW MEXICO OIL CONSERVATION COMMISSION  
WELL LOCATION AND ACREAGE DEDICATION PLAT**

Form C-102  
Supersedes C-128  
Effective 1-1-65

All distances must be from the outer boundaries of the Section.

Operator <b>EL PASO NATURAL GAS COMPANY</b>		Lease <b>ATLANTIC D COM. I (B-10400-1)</b>		Well No. <b>10</b>
Unit Letter <b>M</b>	Section <b>36</b>	Township <b>31-N</b>	Range <b>10-W</b>	County <b>SAN JUAN</b>
Actual Footage Location of Well: <b>1020</b> feet from the <b>SOUTH</b> line and <b>847</b> feet from the <b>WEST</b> line				
Ground Level Elev. <b>6663</b>	Producing Formation <b>PICTURED CLIFFS</b>	Pool <b>BLANCO PICTURED CLIFFS</b>	Dedicated Acreage: <b>160.00</b> Acres	

1. Outline the acreage dedicated to the subject well by colored pencil or hachure marks on the plat below.
2. If more than one lease is dedicated to the well, outline each and identify the ownership thereof (both as to working interest and royalty).
3. If more than one lease of different ownership is dedicated to the well, have the interests of all owners been consolidated by communitization, unitization, force-pooling, etc?

☐ Yes ☐ No If answer is "yes," type of consolidation \_\_\_\_\_

If answer is "no," list the owners and tract descriptions which have actually been consolidated. (Use reverse side of this form if necessary.) \_\_\_\_\_

No allowable will be assigned to the well until all interests have been consolidated (by communitization, unitization, forced-pooling, or otherwise) or until a non-standard unit, eliminating such interests, has been approved by the Commission.

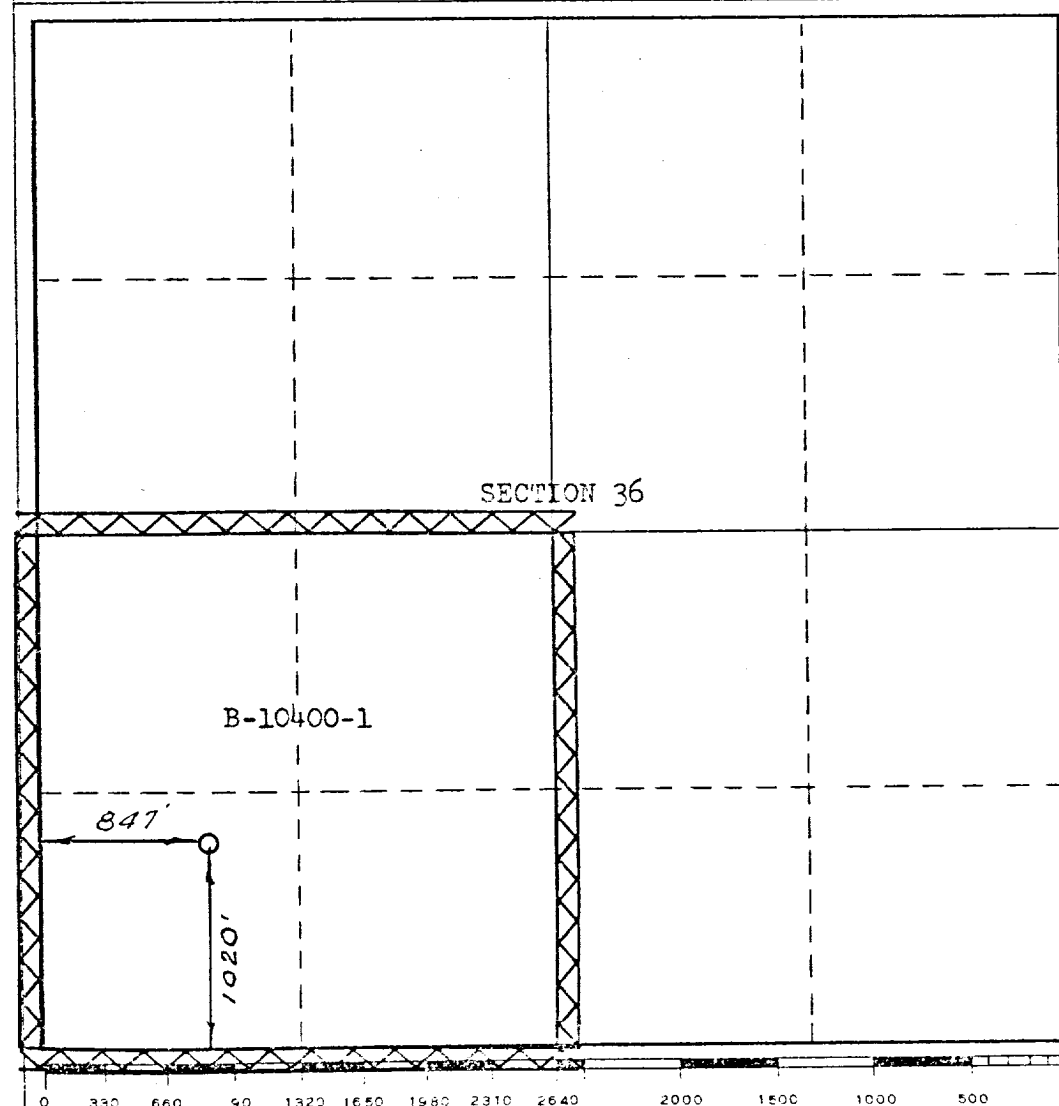

**CERTIFICATION**

*I hereby certify that the information contained herein is true and complete to the best of my knowledge and belief.*

Name  
*Samuel Bradford*  
 Position  
**Drilling Clerk**  
 Company  
**El Paso Natural Gas**  
 Date  
**September 2, 1980**

*I hereby certify that the well location shown on this plat was plotted from field notes of actual surveys made by me or under my supervision, and that the same is true and correct to the best of my knowledge and belief.*

Date Surveyed  
**DECEMBER 22, 1971**  
 Registered Professional Engineer and/or Land Surveyor  
*David P. [Signature]*  
 Certificate No. **1760**



STATE OF NEW MEXICO  
ENERGY AND MINERALS DEPARTMENT  
OIL CONSERVATION DIVISION  
AZTEC DISTRICT OFFICE

December 1, 1980

BRUCE KING  
GOVERNOR

LARRY KEHOE  
SECRETARY

1000 RIO BRAZOS ROAD  
AZTEC, NEW MEXICO 87410  
(505) 334-6178

El Paso Natural Gas Co.

Box 990

Farmington, N.M. 87401

Re: Atlantic D Com 1 #10

H-36-31N-10W

Gentlemen:

Ninety days have elapsed since approval of Division Form C-101, Notice of Intention to Drill, for the subject well and to date no progress reports, Forms C-103, have been received. Therefore, Division approval of Form C-101 has now expired and no drilling operations are to be initiated or continued without further notice to and approval by the Division. Pending such approval this will be considered an abandoned location.

Yours truly,

Frank T. Chavez  
District Supervisor

xc: Oil Conservation Division, Santa Fe

FTC:no

**ABANDONED LOCATION**

S

30-045-24543

9-3-80

F. Loc. 1020/S;847/W Elev. 6663 GL Spd. \_\_\_\_\_ Comp. \_\_\_\_\_ TD \_\_\_\_\_ PB \_\_\_\_\_Casing S. \_\_\_\_\_ @ \_\_\_\_\_ W \_\_\_\_\_ Sx. Int. \_\_\_\_\_ @ \_\_\_\_\_ W \_\_\_\_\_ Sx. Pr. \_\_\_\_\_ @ \_\_\_\_\_ W \_\_\_\_\_ Sx. T. \_\_\_\_\_ @ \_\_\_\_\_  
Csg. Perf. \_\_\_\_\_ Prod. Strim. \_\_\_\_\_T  
R  
A  
N  
S

I.P. \_\_\_\_\_ BO/D \_\_\_\_\_ MCF/D After \_\_\_\_\_ Hrs. \_\_\_\_\_ SICP \_\_\_\_\_ PSI After \_\_\_\_\_ Days GOR \_\_\_\_\_ Grav. \_\_\_\_\_ 1st Del. \_\_\_\_\_ s \_\_\_\_\_

TOPS		NITD <b>X</b>	Well Log	TEST DATA						
Kirtland		C-103	Plat <b>X</b>	Schd.	PC	Q	PW	PD	D	Ref. No.
Fruitland		C-104	Electric Log							
Pictured Cliffs			C-122							
Cliff House		Ditr	Dfa							
Menefee		Datr	Dac							
Point Lookout		160								
Mancos										
Gallup										
Sanostee										
Greenhorn										
Dakota										
Morrison										
Entrada										

P  
O  
I.

Blanco PCCo. SJ S 36 T 31N 10W U M Oper El Paso Natural Gas Co. Lse. Atlantic D Com I No. 10

Atlantic D Com I #10

M-36-31N-10W

El Paso Natural Gas Co.