

All distances must be from the outer boundaries of the Section.

Operator C & E OPERATORS, INC.		Lease AZTEC		Well No. 8
Oil Letter M	Section 8	Township 30 NORTH	Range 11 WEST	County SAN JUAN
Original Footage Location of Well 1000 feet from the SOUTH line and 890 feet from the WEST line MV				
Ground Level Elev. 5598	Producing Formation Mesaverde Pictured Cliffs	Pool Blanco MV Aztec PC	Dedicated Acres 159.48 <small>317.08 Acres</small>	

1. Outline the acreage dedicated to the subject well by colored pencil or hatchure marks on the plat below.
2. If more than one lease is dedicated to the well, outline each and identify the ownership thereof (both as to working interest and royalty).
3. If more than one lease of different ownership is dedicated to the well, have the interests of all owners been consolidated by communitization, unitization, force-pooling, etc? **N/A**

☐ Yes ☐ No If answer is "yes," type of consolidation _____

If answer is "no," list the owners and tract descriptions which have actually been consolidated. (Use reverse side of this form if necessary.) _____

No allowable will be assigned to the well until all interests have been consolidated (by communitization, unitization, forced-pooling, or otherwise) or until a non-standard unit, eliminating such interests, has been approved by the Division.

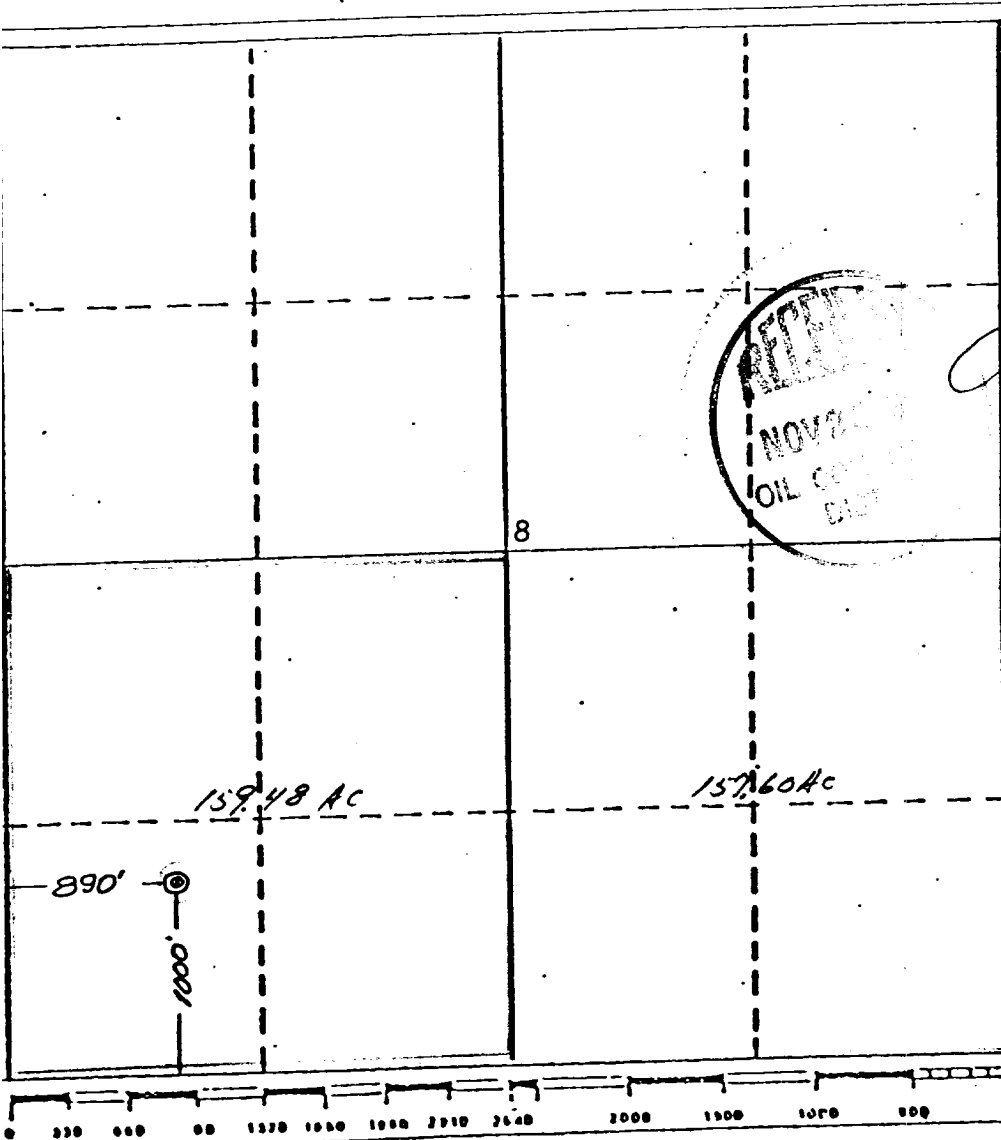

CERTIFICATION

I hereby certify that the information contained herein is true and complete to the best of my knowledge and belief.

Name

John M. Heller

Position

Consultant

Company

C & E Operators

Date

Nov. 24, 1980

I hereby certify that the location shown on this plat is the location of the well shown on the field notes and that the same is correct to the best of my knowledge and belief.

Date Surveyed

June 13, 1980

Registered Professional Engineer and/or Land Surveyor

James P. Leese
James P. Leese

Certificate No.

1463