

STATE OF NEW MEXICO
ENERGY AND MINERALS DEPARTMENT

OIL CONSERVATION DIVISION

P. O. BOX 2088

SANTA FE, NEW MEXICO 87501

30-045-24697
Form C-101
Revised 10-1-78

NO. OF COPIES RECEIVED	
DISTRIBUTION	
SANTA FE	
FILE	
U.S.G.S.	
LAND OFFICE	
OPERATOR	

5A. Indicate Type of Lease
STATE ☐ FEE ☒
5. State Oil & Gas Lease No.

APPLICATION FOR PERMIT TO DRILL, DEEPEN, OR PLUG BACK

1a. Type of Work b. Type of Well OIL WELL <input type="checkbox"/> GAS WELL <input checked="" type="checkbox"/> OTHER <input type="checkbox"/> DRILL <input checked="" type="checkbox"/> DEEPEN <input type="checkbox"/> PLUG BACK <input type="checkbox"/> SINGLE ZONE <input type="checkbox"/> MULTIPLE ZONE <input checked="" type="checkbox"/>		7. Unit Agreement Name
2. Name of Operator C & E Operators		8. Farm or Lease Name Fee
3. Address of Operator One Energy Square, Suite 170, Dallas, Texas 75206		9. Well No. 9-A
4. Location of Well UNIT LETTER B LOCATED 970 FEET FROM THE North LINE AND 1820 FEET FROM THE East LINE OF SEC. 9 TWP. 30N RGE. 11 W NMPM		10. Field and Pool, or Wildcat Aztec PC - Blanco
11. Elevations (Show whether DF, RL, etc.) 5604' Gr.		12. County San Juan
21A. Kind & Status Plug. Bond Blanket	21B. Drilling Contractor Y-W Drilling Co.	22. Approx. Date Work will start On Approval

PROPOSED CASING AND CEMENT PROGRAM

SIZE OF HOLE	SIZE OF CASING	WEIGHT PER FOOT	SETTING DEPTH	SACKS OF CEMENT	EST. TOP
12-1/4"	8-5/8"	24	250+	175 3% CaCl	Surface
7-7/8"	5-1/2"	15.5	4800	300	3000
Stage collar @ approx. 2180' & cement w/375 sx.					Surface

Propose to set 8-5/8" casing w/spud mud. Cement to surface. WOC - 8 hrs. Install BOP's and bleed off manifold. Press. test to 600 psi. - 30 min. Drill 7-7/8" hole with light gel-chemical mud to TD. Run IES & GRD/N Logs. Run 5-1/2" casing and stage cement. Perf. & stimulate Mesaverde; set BP; Perf. & stimulate Pictured Cliffs zone. Clean out PC zone, mill out plug and clean out Mesaverde zone. Run Baker Mod "D" prod. packer. Ran 1-1/2" EUE tubing and seals on Mesaverde. Run 1-1/4" IL tubing on Pictured Cliffs. Install dual well head; clean up and test.

(Location inside City limits of Aztec)

APPROVAL VALID
FOR 90 DAYS UNLESS
DRILLING COMMENCED,

EXPIRES 2-23-81



IN ABOVE SPACE DESCRIBE PROPOSED PROGRAM; IF PROPOSAL IS TO DEEPEN OR PLUG BACK, GIVE DATA ON PRESENT PRODUCTIVE ZONE AND PROPOSED NEW PRODUCTIVE ZONE. GIVE BLOWOUT PREVENTER PROGRAM, IF ANY.

I hereby certify that the information above is true and complete to the best of my knowledge and belief.

Signed John M. Heller Title NM Reg. Eng. No. 4361, Box 1507, Durango, CO Consultant Date 11-24-80

(This space for State Use)

Original Signed by CHARLES GHOLSON

APPROVED BY _____ TITLE DEPUTY OIL & GAS INSPECTOR, DIST. #3

DATE NOV 25 1980

CONDITIONS OF APPROVAL, IF ANY:

Hold 11-24-80

**NEW MEXICO OIL CONSERVATION COMMISSION
WELL LOCATION AND ACREAGE DEDICATION PLAT**

Form C-102
Supersedes C-128
Effective 1-1-65

All distances must be from the outer boundaries of the Section.

Operator C & E OPERATORS, INC.			Lease FEE		Well No. 9 A
Unit Letter B	Section 9	Township 30 NORTH	Range 11 WEST	County SAN JUAN	
Actual Footage Location of Wells					
970 feet from the NORTH line and		1820 feet from the EAST line	MV ---		
Ground Level Elev. 5604	Producing Formation Mesaverde Pictured Cliffs	Pool Blanco MV 47 Aztec PC	Dedicated Acreage 317.90 158.63 Acres		

1. Outline the acreage dedicated to the subject well by colored pencil or hatchure marks on the plat below.
2. If more than one lease is dedicated to the well, outline each and identify the ownership thereof (both as to working interest and royalty).
3. If more than one lease of different ownership is dedicated to the well, have the interests of all owners been consolidated by communitization, unitization, force-pooling, etc?

☐ Yes ☒ No If answer is "yes," type of consolidation Propose to Force Pool by Hearing
Dec. 10, 1980 docket

If answer is "no," list the owners and tract descriptions which have actually been consolidated. (Use reverse side of this form if necessary.) _____

No allowable will be assigned to the well until all interests have been consolidated (by communitization, unitization, forced-pooling, or otherwise) or until a non-standard unit, eliminating such interests, has been approved by the Commission.

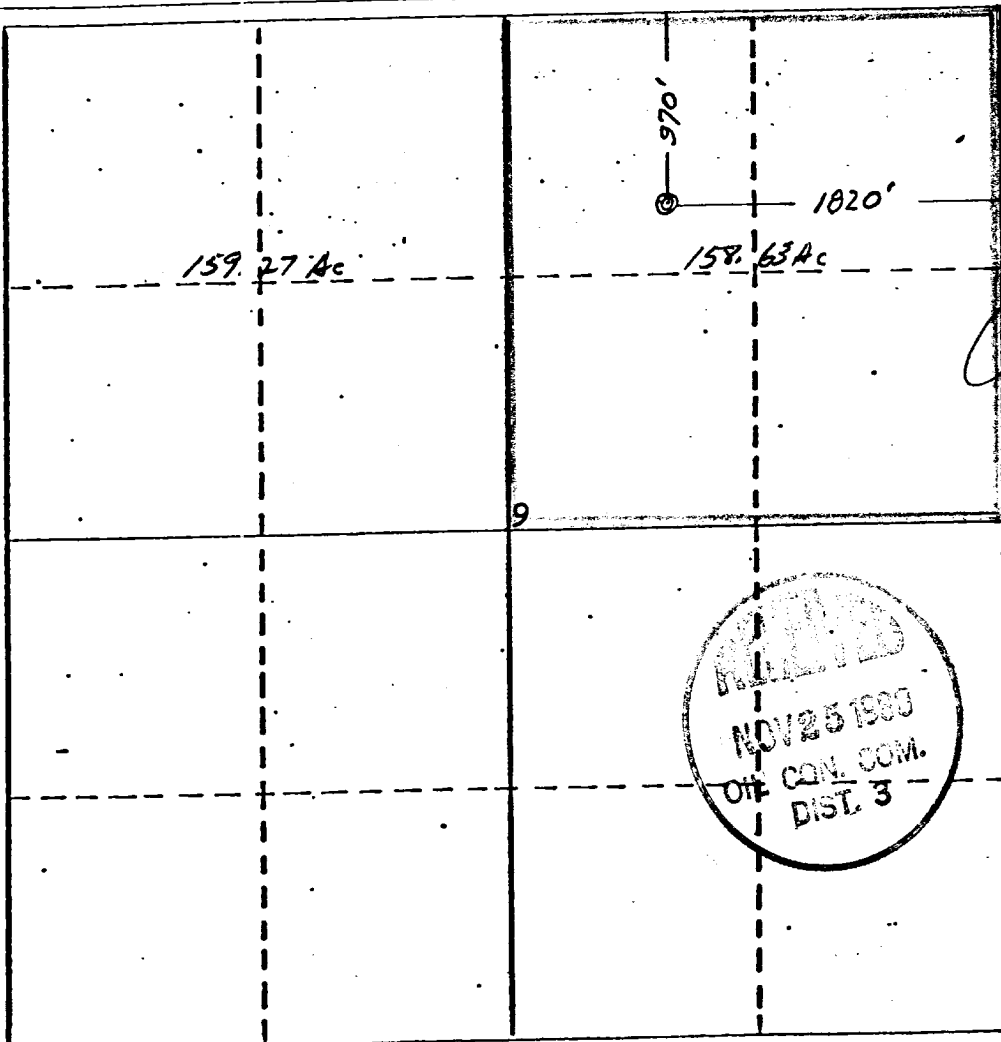

CERTIFICATION

I hereby certify that the information contained herein is true and complete to the best of my knowledge and belief.

Name John M. Heller
Position Consultant
Company C & E Operators
Date Nov. 24, 1980

I hereby certify that the well location shown on this plat was plotted from field notes, actual surveys made by me or under my supervision, and that the same is true and correct to the best of my knowledge and belief.

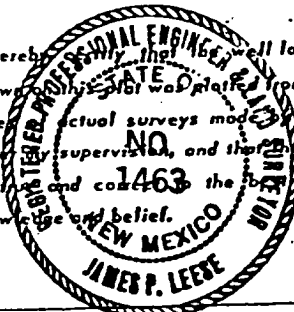

Date Surveyed
October 17, 1980
Registered Professional Engineer
and/or Land Surveyor
James P. Leese

Certificate No.
1463

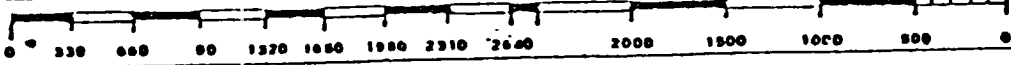

C & E OPERATORS FORCED POOLING APPLICATION
N/2 SECTION 9 - T30N-R11W, SAN JUAN COUNTY, NEW MEXICO CONTAINING 317.90 ACRES
NOTICES TO:

	AC.	TRACT
Rosie Cordova 803 McCoy Avenue Aztec, New Mexico 87401	.26	Lot 12, McCoy Tract 1
Floyd E. Hazen c/o Nciah E. Tindle 300 N. Light Plant Road	.26	Lot 9, McCoy Tract 1
Leslie Webb c/o Genevieve Lopez 719 McCoy Avenue Aztec, New Mexico 87401	.26	Lot 10, McCoy Tract 1
Twauna C. Scogin 713 McCoy Avenue Aztec, New Mexico 87401	.51	Lots 7 & 8, McCoy Tract 1
Mrs. Rosa J. Archuleta 711 McCoy Avenue Aztec, New Mexico 87401	.26	Lot 6, McCoy Tract 1
Angelica & Joe E. Martinez 1404 Hermosa S. E. Albuquerque, New Mexico 87108	.26	Lot 5, McCoy Tract 1
Bernado Sanchez 707 McCoy Avenue Aztec, New Mexico 87401	.26	Lot 4, McCoy Tract 1
Ann Tonia Bennett 5209 Berget Drive Amarillo, Texas 79106	.67	Fr. SE/NE Sec. 9-T30N-R11W
Lillian C. Lopez 608 White Avenue Aztec, New Mexico 87401	.11	Fr. SE/NE Sec. 9-T30N-R11W
Beta Development Company P. O. Box 1659 Midland, Texas 79701	27.18	Various Oil & Gas Leases

C & E OPERATORS FORCED POOLING APPLICATION
N/2 SECTION 9 - T30N-R11W, SAN JUAN COUNTY, NEW MEXICO CONTAINING 317.90 ACRES
NOTICES TO:

AC. TRACT

Church of Latter Day Saints Real Estate Division 50 E. North Temple Salt Lake City, Utah 84150	.66	Lots 32, 33, 34, 35 & Fr. Lots 7,8, 9, 10 McCoy Tract 2
---	-----	---

Church of Latter Day Saints Mr. Brent Christensen Box 2488 Farmington, New Mexico 87401		(same land)
--	--	-------------

Ralph A. Ransom 411 Aztec Blvd. NE Aztec, New Mexico 87410	.40	Fr. Lots 1, 2, 3, 4, 5, 36 37, McCoy Tract 2
--	-----	---

Shamrock Oil & Gas Co. Attn: Emerald Corp. P. O. Box 631 Amarillo, Texas 79105	.30	Fr. Lots 1, 39, 40, 41, 42, 43, 44 McCoy Tract 2
---	-----	--

Loyd Armstrong 428 N. Church Street Aztec, New Mexico 87400	.36	Fr. SE/NE Sec. 9 T30N-R11W
---	-----	-------------------------------

Claudio Chavez 665 Pioneer Avenue Aztec, New Mexico 87400	.59	Fr. SE/NE Sec. 9 T30N-R11W
---	-----	-------------------------------

Terry Moss c/o Hooper c/o Gregory Plesko 616 Pioneer Avenue Aztec, New Mexico 87400	.16	Fr. SE/NE Sec. 9 T30N-R11W
---	-----	-------------------------------

Albert Marcuez 618 Pioneer Street Aztec, New Mexico 87400	.23	Fr. SE/NE Sec. 9 T30N-R11W
---	-----	-------------------------------

Joe B. Montoya 722 Pioneer Avenue Aztec, New Mexico 87400	.24	Lot 35, McCoy Tract 1
---	-----	--------------------------

William Wayne Sumner 818 Pioneer Avenue Aztec, New Mexico 87400	.28	Lot 23, Fr. lot 22, McCoy Tract 1
---	-----	--------------------------------------

C & E Operators

Typical Blowout Preventer
Installation for Mesaverde and
Pictured Cliffs Wells.
10" Series 340 3000 psi.

Pressure test to 600 psi. on
surface casing.

Pressure test to 300 psi. on
intermediate casing strings.

Operate each trip and or at least
once each 24 hour period.

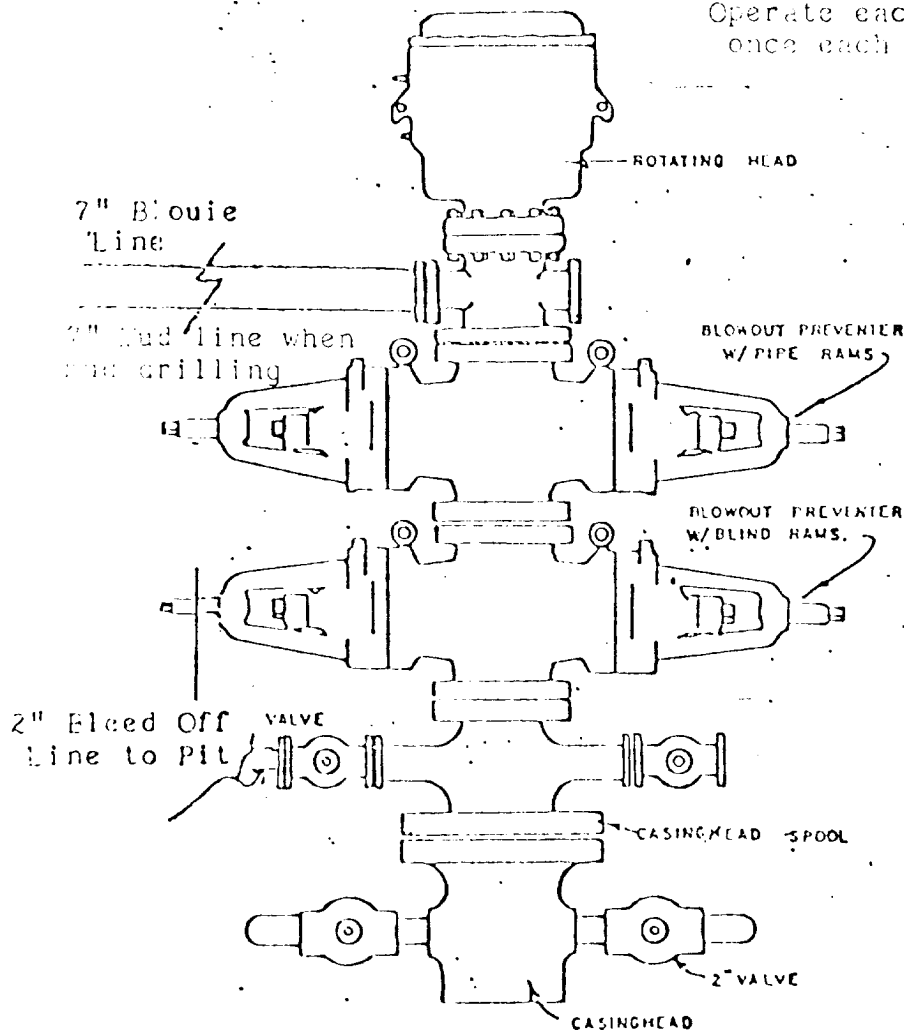

BLOWOUT PREVENTER HOOKUP