

NO. OF COPIES RECEIVED		
DISTRIBUTION		
SANTA FE		
FILE		
U.S.G.S.		
LAND OFFICE		
OPERATOR		

NEW MEXICO OIL CONSERVATION COMMISSION

30-045-24845

Form C-101  
Revised 1-1-65

5A. Indicate Type of Lease  
STATE  FEE

5. State Oil & Gas Lease No.

APPLICATION FOR PERMIT TO DRILL, DEEPEN, OR PLUG BACK

1a. Type of Work  
DRILL  DEEPEN  PLUG BACK

b. Type of Well  
OIL WELL  GAS WELL  OTHER  SINGLE ZONE  MULTIPLE ZONE

2. Name of Operator  
Blackwood & Nichols Co., Ltd.

3. Address of Operator  
P. O. Box 1237, Durango, Colorado 81301

4. Location of Well  
UNIT LETTER 0 LOCATED 1150' FEET FROM THE South LINE  
AND 1520' FEET FROM THE East LINE OF SEC. 9 TWP. 31N RGE. 7W NMPM

7. Unit Agreement Name  
Northeast Blanco Unit  
Agrmt. #1, Sec. 929

8. Farm or Lease Name  
Northeast Blanco Unit

9. Well No.  
207

10. Field and Pool, or Wildcat  
South Los Pinos  
Fruitland - PC

12. County  
San Juan

19. Proposed Depth  
3750'

19A. Formation  
Fruitland - PC

20. Rotary or C.T.  
Rotary

21. Elevations (Show whether DF, RT, etc.)  
6579' GL

21A. Kind & Status Plug. Bond

21B. Drilling Contractor  
Unknown

22. Approx. Date Work will start  
February 15, 1981

PROPOSED CASING AND CEMENT PROGRAM

SIZE OF HOLE	SIZE OF CASING	WEIGHT PER FOOT	SETTING DEPTH	SACKS OF CEMENT	EST. TOP
12 1/4"	9 5/8"	36.00#	300'	250 Sacks	Circulate
7 7/8"	4 1/2"	10.50#	3750'	400 Sacks	1000'

We propose to perforate the Pictured Cliffs and Fruitland Zones and sand-water fracture with 50,000 gals water and 50,000 lbs. sand in two stages. Estimated tops: Fruitland 3190', Pictured Cliffs 3485', Lewis 3625'.

A 3000 PSI WP; Series 10" - 900 adapted to Series 10" - 600 and 6" - 600 hydraulic blowout preventer equipped with blind and necessary pipe rams will be used with adequate kill and bleed off lines. A mud of sufficient weight to control the Fruitland Formation will be used.

Compensated Density Gamma Ray - Neutron logs will be run in open hole.

Blow out preventer will be tested every trip. Gas is dedicated to Northwest Pipeline Corp.

FOR 65000  
DRILLING CONTRACTOR  
EXPIRES 7-26-81

IN ABOVE SPACE DESCRIBE PROPOSED PROGRAM; IF PROPOSAL IS TO DEEPEN OR PLUG BACK, GIVE DATA ON PRESENT PRODUCTIVE ZONE AND PROPOSED NEW PRODUCTIVE ZONE. GIVE BLOWOUT PREVENTER PROGRAM, IF ANY.

I hereby certify that the information above is true and complete to the best of my knowledge and belief.

Signed DeLasso Loos Title District Manager Date January 26, 1981

(This space for State Use)

APPROVED BY Frank S. Carey TITLE DISTRICT MGR DATE JAN 27 1981

CONDITIONS OF APPROVAL, IF ANY:

NEW MEXICO OIL CONSERVATION COMMISSION  
WELL LOCATION AND ACREAGE DEDICATION PLAT

Form C-102  
Supersedes C-128  
Effective 1-1-65

All distances must be from the outer boundaries of the Section.

Operator <b>BLACKWOOD &amp; NICHOLS</b>		Lease <b>NORTHEAST BLANCO UNIT</b>		Well No. <b>207</b>
Unit Letter <b>0</b>	Section <b>9</b>	Township <b>31 N.</b>	Range <b>7W., N.M.P.M.</b>	County <b>SAN JUAN</b>
Actual Footage Location of Well <b>1150</b> feet from the <b>south</b> line and <b>1520</b> feet from the <b>east</b> line				
Ground Level Elev: <b>6579 U.G.</b>	Producing Formation <b>Fruitland Pictured Cliffs</b>	Pool <b>South Los Pinos Pictured Cliffs</b>	Dedicated Acreage: <b>160</b> Acres	

- Outline the acreage dedicated to the subject well by colored pencil or hachure marks on the plat below.
- If more than one lease is dedicated to the well, outline each and identify the ownership thereof (both as to working interest and royalty).
- If more than one lease of different ownership is dedicated to the well, have the interests of all owners been consolidated by communitization, unitization, force-pooling, etc?

Yes    No   If answer is "yes," type of consolidation Unitization

If answer is "no," list the owners and tract descriptions which have actually been consolidated. (Use reverse side of this form if necessary.) \_\_\_\_\_

No allowable will be assigned to the well until all interests have been consolidated (by communitization, unitization, forced-pooling, or otherwise) or until a non-standard unit, eliminating such interests, has been approved by the Commission.

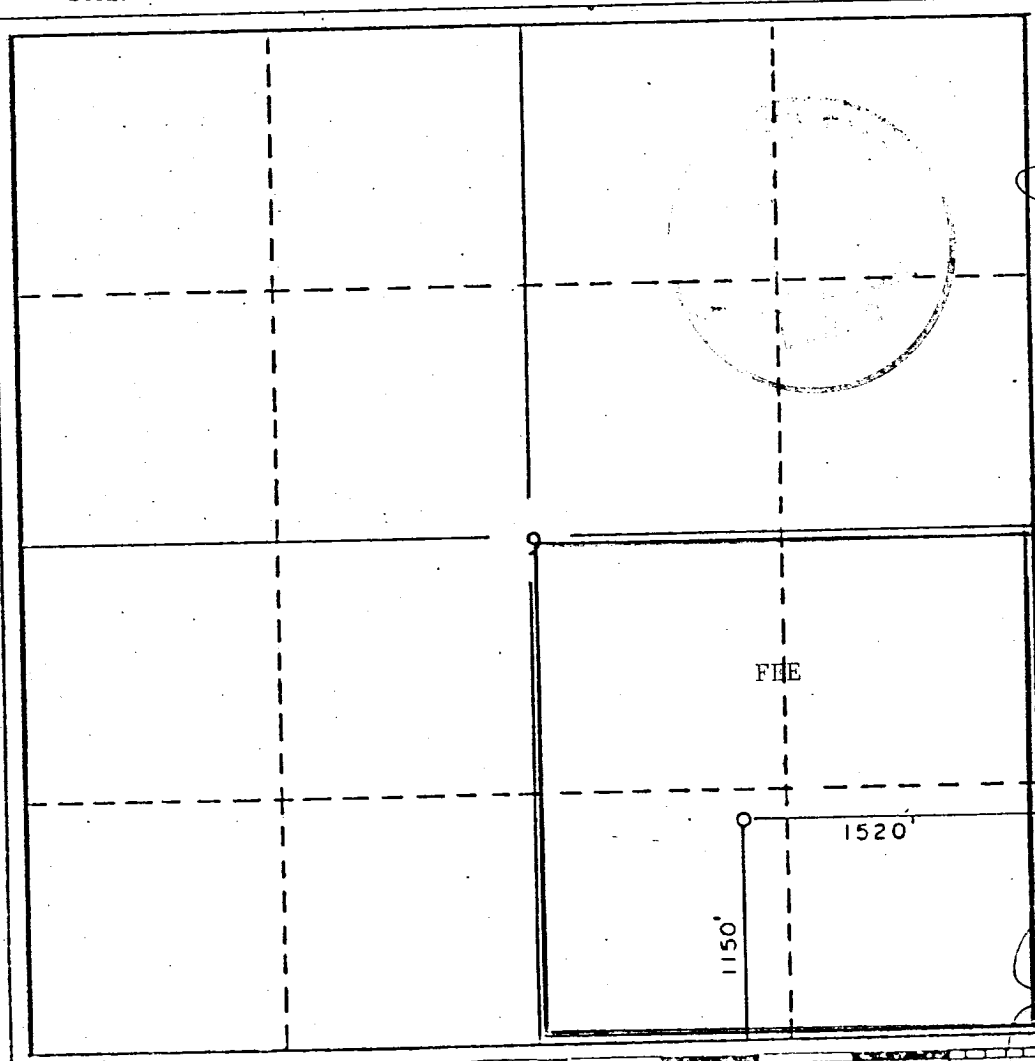

CERTIFICATION

I hereby certify that the information contained herein is true and complete to the best of my knowledge and belief.

*DeLasso Loos*  
Name

DeLasso Loos

Position

District Manager

Company

Blackwood & Nichols Co., Ltd.

Date

October 22, 1980

I hereby certify that the well location shown on this plat was plotted from field notes of actual surveys made by me or under my supervision, and that the same is true and correct to the best of my knowledge and belief.

Date Surveyed

October 14, 1980

Registered Professional Engineer and/or Land Surveyor

*John A. Kroeger*  
John A. Kroeger, LS

Certificate No.

1941