



Submit to Appropriate  
District Office  
State Lease - 4 copies  
Fee Lease - 3 copies

State of New Mexico  
Energy, Minerals and Natural Resources Department

*Pool change  
1/12/91*

Form C-102  
Revised 1-1-89

**OIL CONSERVATION DIVISION**  
P.O. Box 2088  
Santa Fe, New Mexico 87504-2088

**DISTRICT I**  
P.O. Box 1980, Hobbs, NM 88240

**DISTRICT II**  
P.O. Drawer 00, Artesia, NM 88210

**DISTRICT III**  
1000 Rio Brancs Rd., Aztec, NM 87410

**WELL LOCATION AND ACREAGE DEDICATION PLAT**  
All Distances must be from the outer boundaries of the section

Operator Meridian Oil Inc.		Lease Reid "A"		Well No. 2E
Unit Letter D	Section 1	Township 30 NORTH	Range 13 WEST	County San Juan
Actual Footage Location of Well: 905 feet from the North line and 1020 feet from the West line				
Ground level elev. 5986	Producing Formation Dakota/Fruitland Coal		Pool Basin/Basin	Dedicated Acreage: 319.1 Acres

- Outline the acreage dedicated to the subject well by colored pencil or ballpoint marker on the plat below.
- If more than one lease is dedicated to the well, outline each and identify the ownership thereof (both as to working interest and royalty).
- If more than one lease of different ownership is dedicated to the well, have the interest of all owners been consolidated by communitization, unitization, force-pooling, etc.?  
 Yes     No    If answer is "yes" type of consolidation \_\_\_\_\_  
 If answer is "no" list the owners and tract descriptions which have actually been consolidated. (Use reverse side of this form if necessary).  
 No allowable will be assigned to the well until all interests have been consolidated (by communitization, unitization, force-pooling, or otherwise) or until a non-standard unit, eliminating such interest, has been approved by the Division.

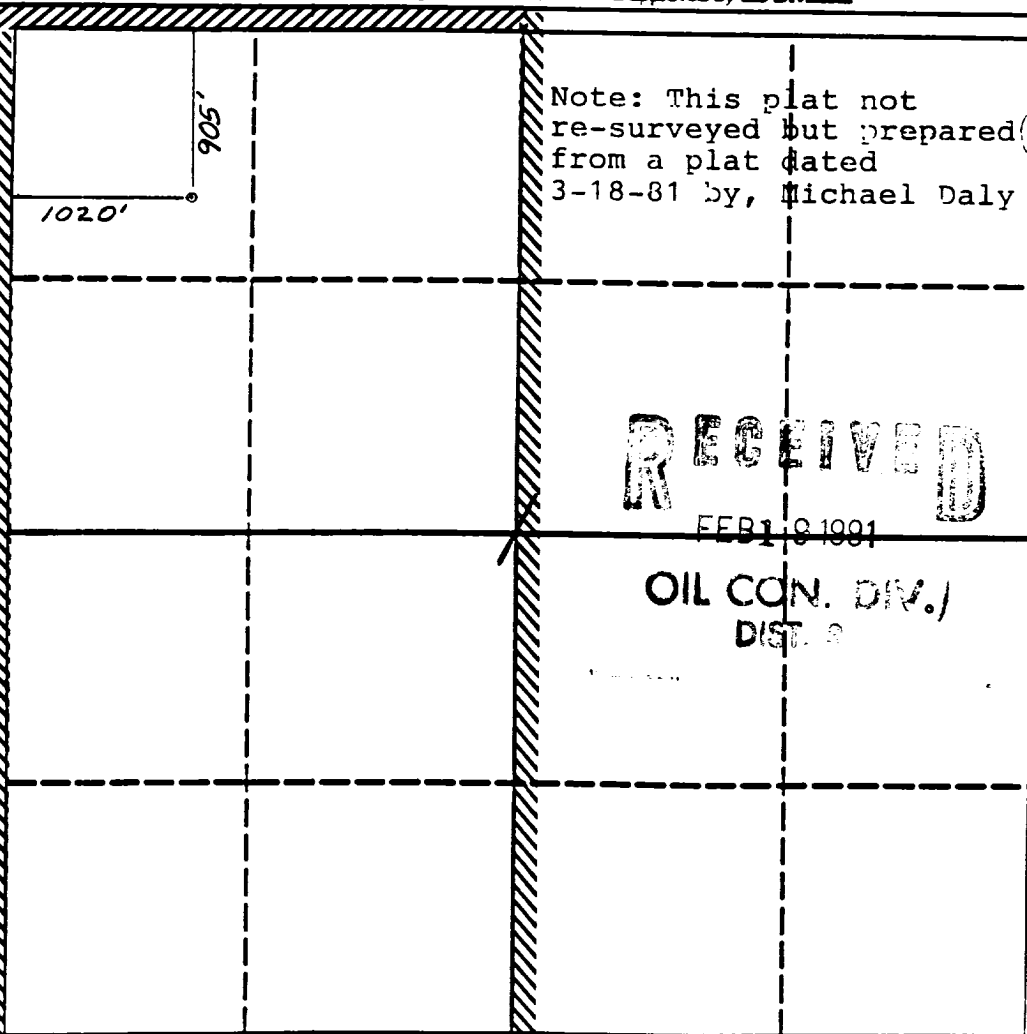

**OPERATOR CERTIFICATION**

I hereby certify that the information contained herein is true and complete to the best of my knowledge and belief.

*Peggy Bradford*  
Signature

Peggy Bradford  
Printed Name

Regulatory Affairs  
Position

Meridian Oil Inc.  
Company

12-20-90  
Date

**SURVEYOR CERTIFICATION**

I hereby certify that the well location shown on this plat was plotted from field notes of actual surveys made by me or under my supervision, and that the same is true and correct to the best of my knowledge and belief.

12-18-90  
Date Surveyed

*Neale C. Edwards*  
Signature

Professional Surveyor  
Title

NEW MEXICO  
6857  
6857  
REGISTERED LAND SURVEYOR

Neale C. Edwards  
Name

0 330 660 990 1320 1650 1980 2310 2640 2000 1500 1000 500 0