

## NEW MEXICO OIL CONSERVATION COMMISSION

Form 1103  
 Approved 11/84  
 1-11/84 and 1-11/88  
 1-11/88 and 1-11/88

[X] (Indicate Type of Notice)

Type ☐Type ☒

b. State Oil &amp; Gas Lease No.

## SUNDY NOTICES AND REPORTS ON WELLS

DO NOT USE THIS FORM FOR PROPOSALS TO DRILL UP TO DEEPER OR PLUG BACK TO A DIFFERENT RESERVOIR.  
 USE "APPLICATION FOR PERMIT TO DRILL" (FORM C-101) FOR SUCH PROPOSALS.

1. <input checked="" type="checkbox"/> WELL <input type="checkbox"/> OIL WELL <input type="checkbox"/> OTHER	7. Unit Agreement Name
2. Name of Operator AZTEC ENERGY CORP.	8. Farm or Lease Name Stock
3. Address of Operator 1206 E. 20th Farmington, NM 87401	9. Well No. 1
4. Location of Well UNIT LETTER <u>K</u> <u>2150</u> FEET FROM THE <u>South</u> LINE AND <u>2110</u> FEET FROM THE <u>East</u> LINE, SECTION <u>36</u> TOWNSHIP <u>30N</u> RANGE <u>16W</u> N.M.P.M.	10. Field and Pool, or Wildcat Undesignated Gallup
15. Elevation (Show whether DF, RT, CR, etc.) 5100' G.L.	12. County San Juan

16.

Check Appropriate Box To Indicate Nature of Notice, Report or Other Data

NOTICE OF INTENTION TO:

SUBSEQUENT REPORT OF:

PERFORM REMEDIAL WORK ☐PLUG AND ABANDON ☐REMEDIAL WORK ☐ALTERING CASING ☐TEMPORARILY ABANDON ☐COMMENCE DRILLING OPNS. ☐PLUG AND ABANDONMENT ☐PULL OR ALTER CASING ☐CHANGE PLANS ☐CASING TEST AND CEMENT JOBS ☐OTHER ☐OTHER move location ☐

17. Describe Proposed or Completed Operations (Clearly state all pertinent details, and give pertinent dates, including estimated date of starting any proposed work) SEE RULE 1103.

Operator request permission to move location to that above. Well site was originally:  
 2150'/S & 2310'/E 36-30-16



I, I hereby certify that the information above is true and complete to the best of my knowledge and belief.

SIGNED John Alexander TITLE Agent DATE 9/22/81

Original Signed by FRANK T. CHAVEZ

TITLE SUPERVISOR DISTRICT # 3DATE SEP 28 1981

CONDITIONS OF APPROVAL, IF ANY:

All distances must be from the outer boundaries of the Section

Operator <b>AZTEC ENERGY CORPORATION</b>			Lease <b>STOCK</b>		Well No. <b>1</b>
Unit Letter <b>K</b>	Section <b>36</b>	Township <b>30 NORTH</b>	Range <b>16 WEST</b>	County <b>SAN JUAN</b>	
Actual Footage Location of Well:					
<b>2150</b> feet from the <b>SOUTH</b>		line and <b>2110</b> feet from the <b>EAST</b>		line	
Ground Level Elev. <b>5100</b>	Producing Formation <b>Gallup</b>	Pool <b>Undesignated Gallup</b>		Dedicated Acreage: <b>40</b>	Acre

1. Outline the acreage dedicated to the subject well by colored pencil or hatchure marks on the plat below.
2. If more than one lease is dedicated to the well, outline each and identify the ownership thereof (both as to working interest and royalty).
3. If more than one lease of different ownership is dedicated to the well, have the interests of all owners been consolidated by communitization, unitization, force-pooling, etc?

☐ Yes ☐ No If answer is "yes," type of consolidation \_\_\_\_\_

If answer is "no," list the owners and tract descriptions which have actually been consolidated. (Use reverse side of this form if necessary.) \_\_\_\_\_

No allowable will be assigned to the well until all interests have been consolidated (by communitization, unitization, forced-pooling, or otherwise) or until a non-standard unit, eliminating such interests, has been approved by the Division.

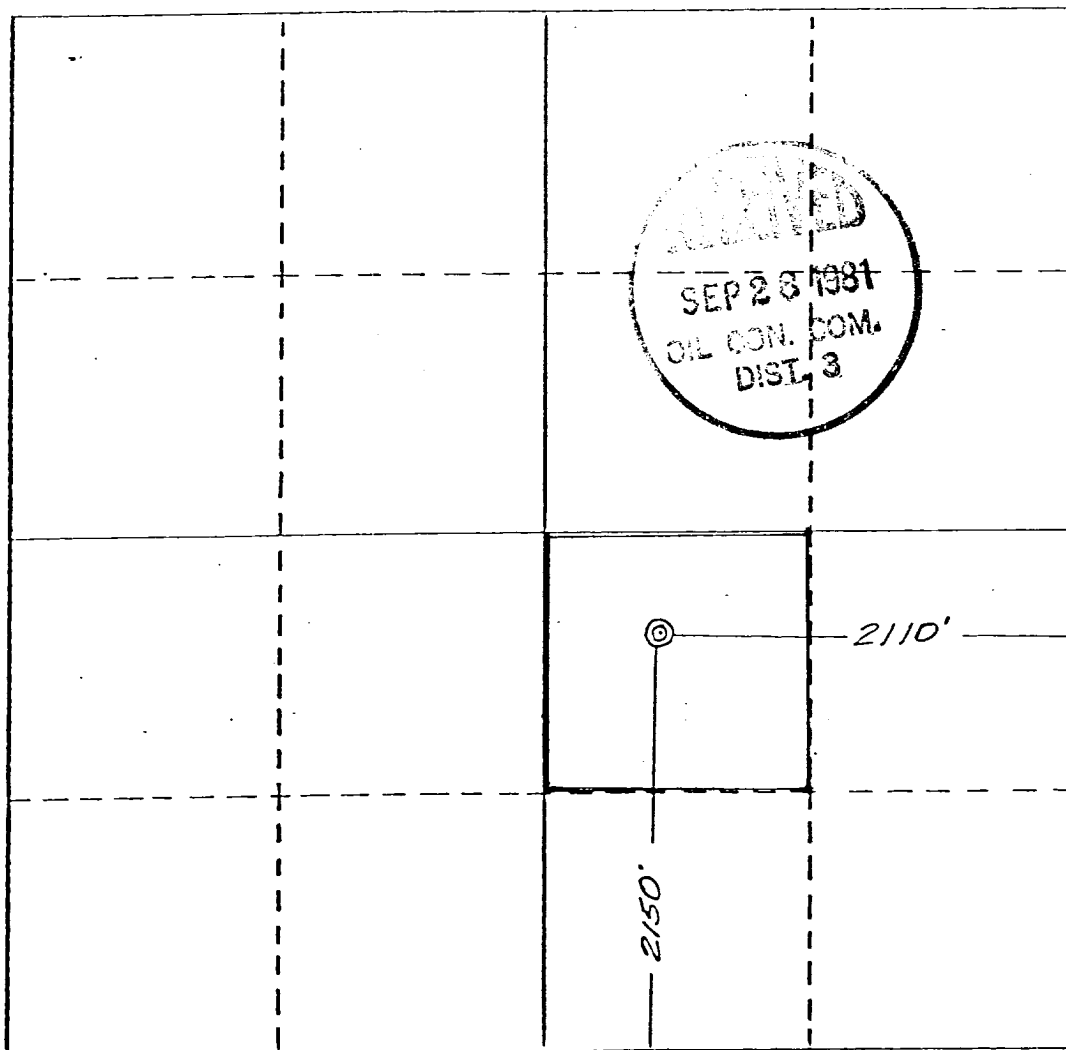

CERTIFICATION

I hereby certify that the information contained herein is true and complete to the best of my knowledge and belief.

*John Alexander*  
Name

John Alexander

Position

Agent

Company

AZTEC ENERGY CORP.

Date

9-22-81

I hereby certify that the well location shown on this plat was plotted from field notes of actual surveys made by me or under my supervision and that same is true and correct to the best of my knowledge and belief.

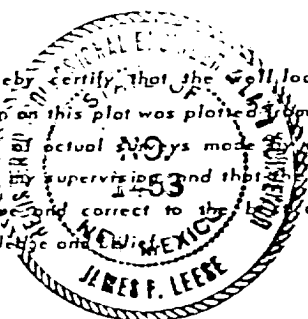

Date Surveyed

15 September 1981

Registered Professional Engineer and/or Land Surveyor

*James P. Lease*  
James P. Lease

Certificate No.

1463

0 330 660 990 1320 1650 1980 2310 2640 2970 3300 3630 3960 4290 4620 4950 5280 5610 5940 6270 6600 6930 7260 7590 7920 8250 8580 8910 9240 9570 9900 0