

EL PASO FIELD SERVICES PRODUCTION PIT CLOSURE

Risk
BTEX

Chrisman Gas Com #1E
Meter/Line ID – 94211

SITE DETAILS

Legals - Twn: 30N	Rng: 12W	Sec: 11	Unit: D
NMOCD Hazard Ranking: 10		Land Type: BLM	
Operator: Cross Timbers		Pit Closure Date: 05/11/94	

RATIONALE FOR RISK-BASED CLOSURE

The pit noted above was assessed and ranked according to the criteria in the New Mexico Oil Conservation Division's (NMOCD) Unlined Surface Impoundment Closure Guidelines.

A test pit was excavated to ten feet and a soil sample was collected for field headspace analysis and laboratory analysis for TPH. Groundwater was not encountered in the test pit. The pit was backfilled and graded in a manner to direct surface runoff away from the pit area. Headspace analysis indicated an organic vapor content of 149 ppm; laboratory analysis indicated a TPH concentration of 116 mg/kg. This site was re-assessed on April 20, 1998, because the initial assessment incorrectly included washes as a surface water body.

El Paso Field Services Company (EPFS) requests closure of the above mentioned production pit location for the following reasons:

- The primary source, discharge to the pit, has been removed for six years.
- The test pit was backfilled and the former pit area graded to direct surface runoff away from the former pit.
- Groundwater was not encountered in the test excavation. In addition, the estimated depth to groundwater is greater than 50 feet; therefore, impact to groundwater is unlikely.
- There are no water supply wells or other sources of fresh water extraction within 1,000 feet of the site.
- Residual hydrocarbons in the soil will degrade naturally with minimal risk to the environment.
- Based on the Hazard Ranking Score, TPH concentrations were below required remediation levels.

ATTACHMENT

Revised Field Pit Assessment Form
Field Pit Remediation/Closure Form

Field Pit Assessment Form
Laboratory Analytical Results

REVISED
FIELD PIT SITE ASSESSMENT FORM

GENERAL	<p>Meter: <u>94211</u> Location: <u>CHRISMAN GAS COM #1E</u></p> <p>Operator #: _____ Operator Name: <u>CROSS TIMBERS</u> P/L District: <u>AZTEC</u></p> <p>Coordinates: Letter: <u>D</u> Section <u>11</u> Township: <u>30</u> Range: <u>12</u></p> <p>Or Latitude _____ Longitude _____</p> <p>Pit Type: Dehydrator _____ Location Drip: <u>X</u> Line Drip: _____ Other: _____</p> <p>Site Assessment Date: <u>4-20-98</u> Area: <u>02</u> Run: <u>63</u></p>
SITE ASSESSMENT	<p>NMOCD Zone: (From NMOCD Maps) Inside Outside</p> <p>Land Type: <input type="checkbox"/> (1) <input checked="" type="checkbox"/> (2)</p> <p>BLM <input checked="" type="checkbox"/> (1) State <input type="checkbox"/> (2) Fee <input type="checkbox"/> (3) Indian _____</p> <p>Depth to Groundwater</p> <p>Less Than 50 Feet (20 points) <input type="checkbox"/> (1)</p> <p>50 Ft to 99 Ft (10 points) <input checked="" type="checkbox"/> (2)</p> <p>Greater Than 100 Ft (0 points) <input type="checkbox"/> (3)</p> <p>Wellhead Protection Area</p> <p>Is it less than 1000 ft from wells, springs or other sources of fresh water extraction?, or; Is it less than 200 ft from a private domestic water source?</p> <p style="text-align: center;"><input type="checkbox"/> (1) YES (20 points) <input checked="" type="checkbox"/> (2) NO (0 points)</p> <p>Horizontal Distance to Surface Water Body</p> <p>Less Than 200 Ft (20 points) <input type="checkbox"/> (1)</p> <p>200 Ft to 1000 Ft (10 points) <input type="checkbox"/> (2)</p> <p>Greater Than 1000 Ft (0 points) <input checked="" type="checkbox"/> (3)</p> <p>Name of Surface Water Body _____</p> <p>(Surface Water Body: Perennial Rivers, Streams, Creeks, Irrigation Canals, Ditches, Lakes, Ponds)</p> <p>Distance to Nearest Ephemeral Stream <input type="checkbox"/> (1) < 100' (Navajo Pits Only)</p> <p style="margin-left: 300px;"><input type="checkbox"/> (2) > 100'</p> <p>TOTAL HAZARD RANKING SCORE: <u>10</u> POINTS</p>
REMARKS	<p>Remarks : <u>Site has been re-assessed, due to initial assessment including washes as a Surface Water Body. THERE ARE SEVERAL HOMES IN AREA OF THIS LOCATION BUT NONE SEEM TO BE ANY CLOSER THAN 1,000 TO 1,500 FEET.</u></p>

FIELD PIT SITE ASSESSMENT FORM

GENERAL	<p>Meter: <u>94212</u> <u>94211</u> Location: <u>CHRISMAN GAS COM #1E GL/DK</u></p> <p>Operator #: <u>0203</u> Operator Name: <u>AMOCO</u> P/L District: <u>KUTZ</u></p> <p>Coordinates: Letter: <u>D</u> Section <u>11</u> Township: <u>30</u> Range: <u>12</u></p> <p>Or Latitude _____ Longitude _____</p> <p>Pit Type: Dehydrator _____ Location Drip: <u>X</u> Line Drip: _____ Other: _____</p> <p>Site Visit Date: <u>4.1.94</u> Run: <u>02</u> <u>63</u></p>
	SITE ASSESSMENT
REMARKS	

ORIGINAL PIT LOCATION

ORIGINAL PIT LOCATION

Original Pit : a) Degrees from North 108° Footage to Wellhead 128'
b) Degrees from North _____ Footage to Dogleg _____
Dogleg Name _____
c) Length : 19' Width : 12' Depth : 3'

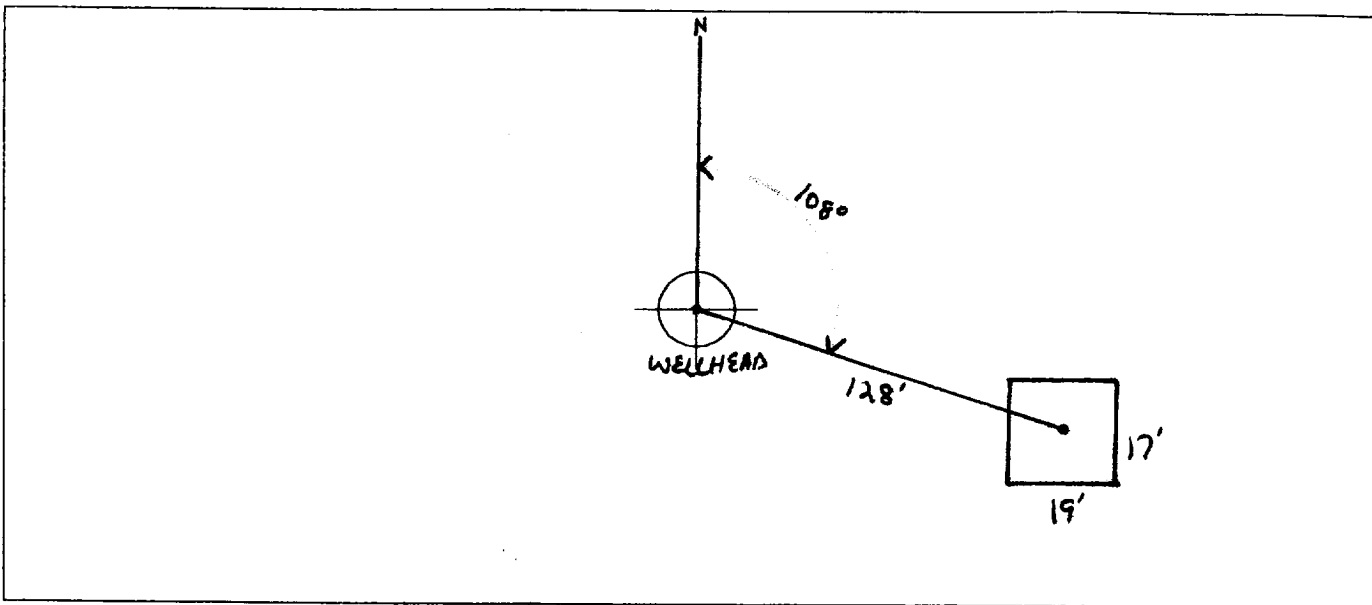

REMARKS

Remarks :

STARTED TAKING PICTURES AT 10:46 A.M.END DUMP

Completed By:

Robert Thompson

Signature

4.1.94

Date

ORIGINAL PIT LOCATION

Original Pit : a) Degrees from North 108° Footage to Wellhead 128'
 b) Degrees from North _____ Footage to Dogleg _____
 Dogleg Name _____
 c) Length : 19' Width : 12' Depth : 3'

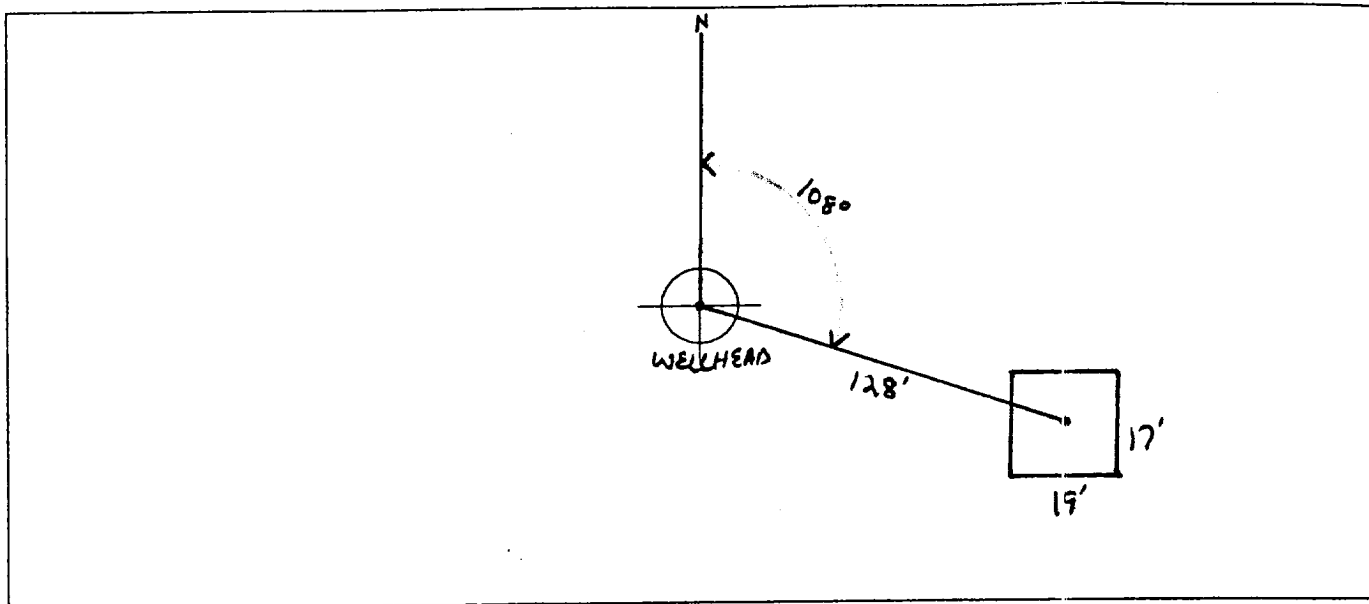

REMARKS :

STARTED TAKING PICTURES AT 10:46 A.M.
END DUMP

Completed By:

Robert Thompson
 Signature

4.1.94

Date

4-24-94
RT

FIELD PIT SITE ASSESSMENT FORM

GENERAL	<p>Meter: <u>94212</u> Location: <u>CHRISMAN GAS COM #1E GL/DK</u> Operator #: _____ Operator Name: _____ P/L District: _____ Coordinates: Letter: _____ Section: _____ Township: _____ Range: _____ Or Latitude _____ Longitude _____ Pit Type: Dehydrator _____ Location Drip: _____ Line Drip: _____ Other: _____ Site Assessment Date: _____ Area: <u>02</u> Run: <u>63</u></p>																												
SITE ASSESSMENT	<p>NMOCD Zone: (From NMOCD Maps) Land Type:</p> <table><tbody><tr><td>Inside</td><td><input type="checkbox"/> (1)</td><td>BLM</td><td><input type="checkbox"/> (1)</td></tr><tr><td>Outside</td><td><input checked="" type="checkbox"/> (2)</td><td>State</td><td><input type="checkbox"/> (2)</td></tr><tr><td></td><td></td><td>Fee</td><td><input type="checkbox"/> (3)</td></tr><tr><td></td><td></td><td>Indian</td><td>_____</td></tr></tbody></table> <p>Depth to Groundwater</p> <table><tbody><tr><td>Less Than 50 Feet (20 points)</td><td><input checked="" type="checkbox"/> (1)</td></tr><tr><td>50 Ft to 99 Ft (10 points)</td><td><input type="checkbox"/> (2)</td></tr><tr><td>Greater Than 100 Ft (0 points)</td><td><input type="checkbox"/> (3)</td></tr></tbody></table> <p>Wellhead Protection Area : Is it less than 1000 ft from wells, springs, or other sources of fresh water extraction? , or ; Is it less than 200 ft from a private domestic water source? <input type="checkbox"/> (1) YES (20 points) <input type="checkbox"/> (2) NO (0 points)</p> <p>Horizontal Distance to Surface Water Body</p> <table><tbody><tr><td>Less Than 200 Ft (20 points)</td><td><input type="checkbox"/> (1)</td></tr><tr><td>200 Ft to 1000 Ft (10 points)</td><td><input checked="" type="checkbox"/> (2)</td></tr><tr><td>Greater Than 1000 Ft (0 points)</td><td><input type="checkbox"/> (3)</td></tr></tbody></table> <p>Name of Surface Water Body <u>JOHNSON ARROYO</u> (Surface Water Body : Perennial Rivers, Major Wash, Streams, Creeks, Irrigation Canals, Ditches, Lakes, Ponds) Distance to Nearest Ephemeral Stream <input type="checkbox"/> (1) < 100' (Navajo Pits Only) <input type="checkbox"/> (2) > 100'</p> <p>TOTAL HAZARD RANKING SCORE: <u>30</u> POINTS</p>	Inside	<input type="checkbox"/> (1)	BLM	<input type="checkbox"/> (1)	Outside	<input checked="" type="checkbox"/> (2)	State	<input type="checkbox"/> (2)			Fee	<input type="checkbox"/> (3)			Indian	_____	Less Than 50 Feet (20 points)	<input checked="" type="checkbox"/> (1)	50 Ft to 99 Ft (10 points)	<input type="checkbox"/> (2)	Greater Than 100 Ft (0 points)	<input type="checkbox"/> (3)	Less Than 200 Ft (20 points)	<input type="checkbox"/> (1)	200 Ft to 1000 Ft (10 points)	<input checked="" type="checkbox"/> (2)	Greater Than 1000 Ft (0 points)	<input type="checkbox"/> (3)
Inside	<input type="checkbox"/> (1)	BLM	<input type="checkbox"/> (1)																										
Outside	<input checked="" type="checkbox"/> (2)	State	<input type="checkbox"/> (2)																										
		Fee	<input type="checkbox"/> (3)																										
		Indian	_____																										
Less Than 50 Feet (20 points)	<input checked="" type="checkbox"/> (1)																												
50 Ft to 99 Ft (10 points)	<input type="checkbox"/> (2)																												
Greater Than 100 Ft (0 points)	<input type="checkbox"/> (3)																												
Less Than 200 Ft (20 points)	<input type="checkbox"/> (1)																												
200 Ft to 1000 Ft (10 points)	<input checked="" type="checkbox"/> (2)																												
Greater Than 1000 Ft (0 points)	<input type="checkbox"/> (3)																												
MARKS	<p>Remarks : _____ _____ _____</p>																												

FIEI IT REMEDIATION/CLOSURE FORM

GENERAL

Meter: 94212
94211 Location: Chrisman Gas Com #1E GL/DK
Coordinates: Letter: D Section 11 Township: 30 Range: 12
Or Latitude _____ Longitude _____
Date Started : 5-11-94 Area: 02 Run: 63

FIELD OBSERVATIONS

Sample Number(s): VW57
Sample Depth: 10' Feet
Final PID Reading 149 PID Reading Depth 10' Feet
Yes No
Groundwater Encountered ☐ (1) ☒ (2) Approximate Depth _____ Feet

CLOSURE

Remediation Method :
Excavation ☐ (1) Approx. Cubic Yards 0
Onsite Bioremediation ☐ (2)
Backfill Pit Without Excavation ☒ (3)
Soil Disposition:
Envirotech ☐ (1) ☐ (3) Tierra
Other Facility ☐ (2) Name: _____
Pit Closure Date: 5-11-94 Pit Closed By: BEI

REMARKS

Remarks : NO line markers. Hit Bentonite at 4' Kept digging till 10'
+ couldn't Dig any further.

Signature of Specialist: Vale Wilson



FIELD SERVICES LABORATORY

ANALYTICAL REPORT

PIT CLOSURE PROJECT - Soil

original from
changed to
outside to
wvz
meter # 94212

SAMPLE IDENTIFICATION

	Field ID	Lab ID
SAMPLE NUMBER:	V W 57	945132
MTR CODE SITE NAME:	94212 / 94211	N/A
SAMPLE DATE TIME (Hrs):	5-11-94	1415
SAMPLED BY:	N/A	
DATE OF TPH EXT. ANAL.:	5-12-94	5-12-94
DATE OF BTEX EXT. ANAL.:	N/A	N/A
TYPE DESCRIPTION:	VG	Light Brown Sand/Clay

REMARKS:

RESULTS

PARAMETER	RESULT	UNITS	QUALIFIERS			
			DF	Q	M(g)	V(ml)
BENZENE		MG/KG				
TOLUENE		MG/KG				
ETHYL BENZENE		MG/KG				
TOTAL XYLENES		MG/KG				
TOTAL BTEX		MG/KG				
TPH (418.1)	20116	MG/KG			2.01	28
HEADSPACE PID	149	PPM				
PERCENT SOLIDS	85.7	%				

- TPH is by EPA Method 418.1 and BTEX is by EPA Method 8020 -

The Surrogate Recovery was at N/A % for this sample All QA/QC was acceptable.
Error:

DF = Dilution Factor Used

Approved By: John P. Smith

Date: 6/15/94

Page 1 of 1505-599-2144