

UNITED STATES
DEPARTMENT OF THE INTERIOR
GEOLOGICAL SURVEY

APPLICATION FOR PERMIT TO DRILL, DEEPEN, OR PLUG BACK

1a. TYPE OF WORK

DRILL ☒DEEPEN ☐PLUG BACK ☐

b. TYPE OF WELL

OIL
WELL ☐GAS
WELL ☒

OTHER

SINGLE
ZONE ☐MULTIPLE
ZONE ☒

2. NAME OF OPERATOR

Northwest Pipeline Corporation

3. ADDRESS OF OPERATOR

P.O. Box 90, Farmington, N.M. 87401

4. LOCATION OF WELL (Report location clearly and in accordance with any State requirements.)

At surface 1670' FSL & 1100' FEL Sec 21, T31N, R8W

At proposed prod. zone

Same as above

14. DISTANCE IN MILES AND DIRECTION FROM NEAREST TOWN OR POST OFFICE*

7 Miles North of Navajo Dam Post Office

15. DISTANCE FROM PROPOSED*

LOCATION TO NEAREST
PROPERTY OR LEASE LINE, FT.
(Also to deepest drlg. unit lide, if any)

1100'

18. DISTANCE FROM PROPOSED LOCATION*

TO NEAREST WELL, DRILLING, COMPLETED,
OR APPLIED FOR, ON THIS LEASE, FT.

2200'

16. NO. OF ACRES IN LEASE

N/A

19. PROPOSED DEPTH

8000'

17. NO. OF ACRES ASSIGNED
TO THIS WELL

E 320 MV / 320 DK

20. ROTARY OR CABLE TOOLS

Rotary

21. ELEVATIONS (Show whether DF, RT, GR, etc.)

6580' GR

DRILLING OPERATIONS AUTHORIZED ARE
SUBJECT TO COMPLIANCE WITH ATTACHED

22. APPROX. DATE WORK WILL START*

August 1981

23.

PROPOSED CASING AND CEMENTING PROGRAM

SIZE OF HOLE	SIZE OF CASING	WEIGHT PER FOOT	SETTING DEPTH	QUANTITY OF CEMENT
12-1/4"	9-5/8"	36#	350'	185 cu.ft
8-3/4"	7"	20#	3770'	400 cu.ft
6-1/4"	4-1/2"	10.5# & 11.6#	8000'	670 cu.ft

This action is subject to administrative
appeal pursuant to 30 CFR 290.

Selectively perforate and stimulate the Mesa Verde and Dakota Formation. Completion plans will be determined at Total Depth.

A BOP will be installed after the surface casing is set and cemented. All subsequent work will be conducted through the BOP's.

The East half of Section 21 is dedicated to both the Dakota & Mesa Verde Formation.

Gas is dedicated.

IN ABOVE SPACE DESCRIBE PROPOSED PROGRAM: If proposal is to deepen or plug back, give data on present productive zone and proposed new productive zone. If proposal is to drill or deepen directionally, give pertinent data on subsurface locations and measured and true depths. Give blowout preventer program, if any.

24.

SIGNED

Paul C. Thompson

TITLE

Drilling Engineer

DATE

5-8-81

(This space for Federal or State office use)

PERMIT NO.

APPROVAL DATE

APPROVED BY

CONDITIONS OF APPROVAL, IF ANY:

TITLE

Atty Dist. Supr.

DATE

OCT 16 1981

NMOCC

*See Instructions On Reverse Side

PCT/dib

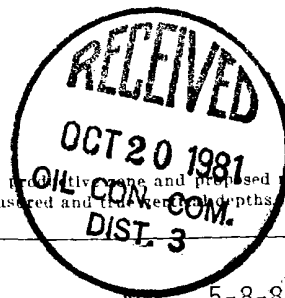

OIL CONSERVATION DIVISION

P. O. BOX 2088

SANTA FE, NEW MEXICO 87501

Form C-107
Revised 10-1-72STATE OF NEW MEXICO
ENERGY AND MINERALS DEPARTMENT

All distances must be from the outer boundaries of the Section.

Operator NORTHWEST PIPELINE CORPORATION			Lease SAN JUAN 32-8 UNIT		Well No. 11A
Unit Letter I	Section 21	Township 31N	Range 8W	County San Juan	
Actual Footage Location of Well: 1670 feet from the South line and 1100 feet from the East line					
Ground Level Elev: 6580	Producing Formation Mesa Verde / Dakota		Pool Blanco MV/Basin Dakota		Dedicated Acreage: 320 MV & DK Acres

1. Outline the acreage dedicated to the subject well by colored pencil or hachure marks on the plat below.

2. If more than one lease is dedicated to the well, outline each and identify the ownership thereof (both as to working interest and royalty).
NORTHWEST PIPELINE CORPORATION3. If more than one lease of different ownership is dedicated to the well, have the interests of all owners been consolidated by communitization, unitization, force-pooling, etc?
FEB 18 1981☒ Yes ☐ No If answer is "yes," type of consolidation Unitization

If answer is "no," list the owners and tract descriptions which have actually been consolidated. (Use reverse side of this form if necessary.)

No allowable will be assigned to the well until all interests have been consolidated (by communitization, unitization, forced-pooling, or otherwise) or until a non-standard unit, eliminating such interests, has been approved by the Commission.

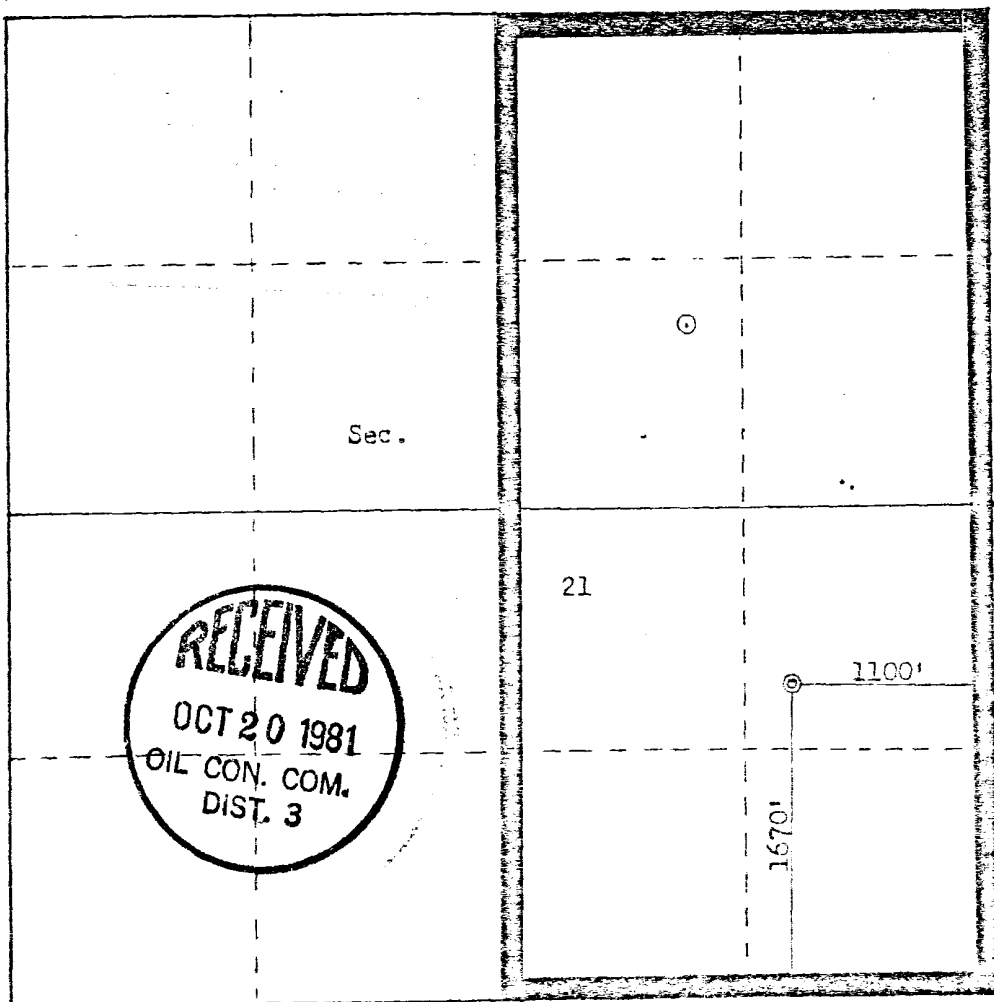

Scale: 1"=1000'

CERTIFICATION

I hereby certify that the information contained herein is true and complete to the best of my knowledge and belief.

Paul C. Thompson

Name

Paul C. Thompson

Position

Drilling Engineer

Company

Northwest Pipeline Corp

Date

2-19-81

I hereby certify that the well location shown on this plat was plotted from field notes of actual surveys made by me or under my supervision, and that the same is true and correct to the best of my knowledge and belief.

Date Surveyed

February 15, 1981

Registered Professional Engineer
and/or Land Surveyor*Fred B. Kerr Jr.*
Fred B. Kerr Jr.

Certificate No.

3550

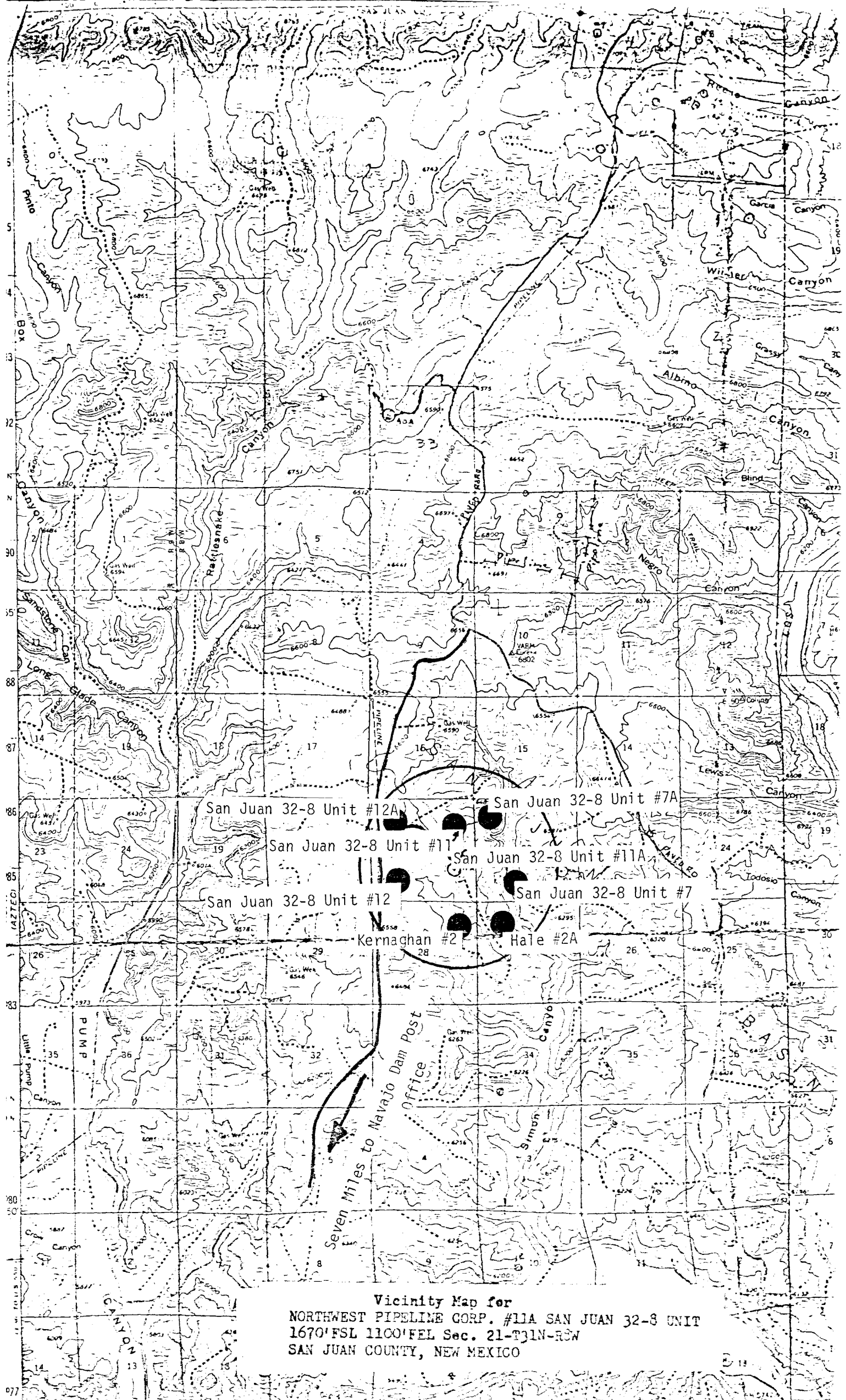

Vicinity Map for
NORTHWEST PIPELINE CORP. #11A SAN JUAN 32-8 UNIT
1670'FSL 1100'FEL Sec. 21-T31N-R3W
SAN JUAN COUNTY, NEW MEXICO

Give to Dean E.
attach to Intent to Drill

Form 9-331
Dec. 1973

UNITED STATES
DEPARTMENT OF THE INTERIOR
GEOLOGICAL SURVEY

RECEIVED

AUG 31 1981

U. S. GEOLOGICAL SURVEY
FARMINGTON, N.M.

Form Approved.
Budget Bureau No. 42-R1424

SUNDRY NOTICES AND REPORTS ON WELLS

(Do not use this form for proposals to drill or to deepen or plug back to a different reservoir. Use Form 9-331-C for such proposals.)

1. oil well ☐ gas well ☒ other

2. NAME OF OPERATOR

Northwest Pipeline Corporation

3. ADDRESS OF OPERATOR

P.O. Box 90, Farmington, N.M. 87401

4. LOCATION OF WELL (REPORT LOCATION CLEARLY. See space 17 below.)

AT SURFACE: 1670' FSL & 1100' FEL
AT TOP PROD. INTERVAL: Same as above
AT TOTAL DEPTH: Same as above

16. CHECK APPROPRIATE BOX TO INDICATE NATURE OF NOTICE, REPORT, OR OTHER DATA

REQUEST FOR APPROVAL TO:

TEST WATER SHUT-OFF ☐

FRACTURE TREAT ☐

SHOOT OR ACIDIZE ☐

REPAIR WELL ☐

PULL OR ALTER CASING ☐

MULTIPLE COMPLETE ☐

CHANGE ZONES ☐

ABANDON* ☐

(other)

SUBSEQUENT REPORT OF:

RECEIVED

JUL 23 1981

U. S. GEOLOGICAL SURVEY
FARMINGTON, N.M.

(NOTE: Report results of multiple completion or zone change on Form 9-330.)

17. DESCRIBE PROPOSED OR COMPLETED OPERATIONS (Clearly state all pertinent details, and give pertinent dates, including estimated date of starting any proposed work. If well is directionally drilled, give subsurface locations and measured and true vertical depths for all markers and zones pertinent to this work.)*

We would like to change the casing, hole size and the weight on this location from

12-1/4", 9-5/8", 36# to 13-3/4", 10-3/4", 40.5#

8-3/4", 7", 20# to 9-7/8", 7-5/8", 26.4#

6-1/4", 4-1/2", 10.5# & 11.6# to 6-3/4", 5-1/2", 17.0#.

RECEIVED

JUL 31 1981

OIL CON. COM.
DIST. 3

Subsurface Safety Valve: Manu. and Type _____ Set @ _____ Ft.

18. I hereby certify that the foregoing is true and correct

SIGNED Donna J. Brace TITLE Production Clerk DATE 7-27-81

Donna J. Brace

(This space for Federal or State office use)

APPROVED BY [Signature] TITLE _____ DATE _____
CONDITIONS OF APPROVAL, IF ANY:

APPROVED

JUL 30 1981

Dean Elliott
DISTRICT ENGINEER

NMOCC

*See Instructions on Reverse Side