

OIL CONSERVATION DIVISION

P.O. Box 2088
Santa Fe, New Mexico 87504-2088

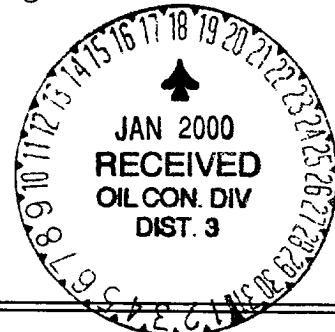

PIT REMEDIATION AND CLOSURE REPORT

Operator: Devon Energy (Williams Field Services) Telephone: (801) 584-6361
Address: P.O. Box 58900, Salt Lake City, Utah 84158-0900
WellName: NE BLANCO #77 (85683)
Location: Unit or Qtr/Qtr Sec *M* Sec 15 T 31N R 7W County San Juan
PitType Dehydrator
LandType: Fee

Pit Location: Pit dimensions: length 14 ft., width 14 ft., depth 7 ft.
(Attach diagram)

Reference: Wellhead

Footage from reference: 85 ft.

Direction from reference: 80 Degrees West of North

Depth To Ground Water:	Less than 50 feet	(20 points)	
(Vertical distance from	50 feet to 99 feet	(10 points)	
contaminants to seasonal	Greater than 100 feet	(0 points)	<u>0</u>
high water elevation of			
ground water)			

Wellhead Protection Area:	Yes	(20 points)	
(Less than 200 feet from a private	No	(0 points)	<u>0</u>
domestic water source, or; less than			
1000 feet from all other water sources)			

Distance To Surface Water:	Less than 200 feet	(20 points)	
(Horizontal distance to perennial	200 feet to 1,000 feet	(10 points)	
lakes, ponds, rivers, streams, creeks,	Greater than 1,000 feet	(0 points)	<u>0</u>
irrigation canals and ditches)			

Ranking Score (TOTAL POINTS): 0

Date Remediation Started: 9/22/99

Date Completed: 9/27/99

Remediation Method: Excavation ☒

Approx. Cubic Yard 51

(check all appropriate sections)

Landfarmed ☒

Insitu Bioremediation

Other Landfarmed soil after mechanical aeration. LF Headspace 0 ppm.

Remediation Location: Onsite ☒ Offsite

(ie. landfarmed onsite, name and location of offsite facility)

General Description Of Remedial Action:

The pit was excavated to remove gross petroleum contamination. The excavated material was mechanically aerated and placed into an onsite landfarm.

Ground Water Encountered: No

Final Pit:

Sample location NE BLANCO 77-V-EXFL-01

Closure Sampling:

(if multiple samples, attach sample results and diagram of sample locations and depths)

Two samples were collected, one sample from the excavation bottom and the second sample was made up of 4 points from each excavation wall.

Sample depth 7 feet

Sample date 9/22/99

Sample time 12:13

Sample Result

Benzene (ppm) <0.05

Total BTEX (ppm) <0.05

Field Headspace (ppm)

TPH (ppm) <2.0

Ground Water Sample: No

I HEREBY CERTIFY THAT THE INFORMATION ABOVE IS TRUE AND COMPLETE TO THE BEST OF MY KNOWLEDGE AND BELIEF

DATE 12-20-99

SIGNATURE *Mark Harvey* For WFSPRINTED NAME Mark Harvey for Williams Field Services
AND TITLE

PIT RETIREMENT FORM

85683

Date: 9-22-99

Weather dry CLOUDY MILD 70°F

Well Name NE BLANCO #77 Operator LEVIN

Sec 15 T 31N R 7W UL

and Type: BLM STATE FEE INDIAN

County SAN JUAN

One Call Made (505-765-1234)?

Y N

Line Marking Evident? 1800 321 2337

Y N

Pit Location:

Reference Wellhead X Other

Distance from: 85'

Direction: 80 Degrees E N X

X of W S

Starting Pit Dimensions 14 x 14 x 2

Final Pit Dimensions 14 x 14 x 7

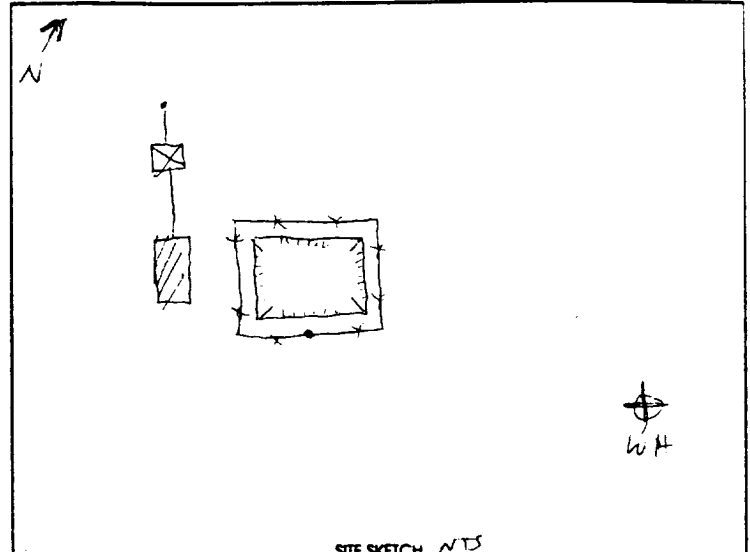

Organic Vapor Readings:

Start N/A
 @ 2' /
 @ 4' /
 @ 6' /
 @ 8' /
 @ /
 @ /

Soil Description:

0-5' BWN CLAYEY SILT, MOD PLASTIC
5'-7'+ GRN/GRAY CLAYSTONE / CLAYEY SILT
/
/
/
/

Well Proximity To: Residence, Domestic Water Well, Stock Well NONE

Arroyo, Wash, Lake, Stream >100'

Estimated or Known Distance to Ground Water >100'

Source of Backfill (if other than processed material)

Samples collected:

Type Progress: Verification
 Progress: Verification
 Progress: Verification

ID NE BLANCO #77-V-EXWA-01 soil / water
 ID NE BLANCO #77-V-EXPL-02 soil / water
 ID / soil / water

Sample sent to Lab Via: Courier Hand Carried / Other / Preservative: ICE Other /

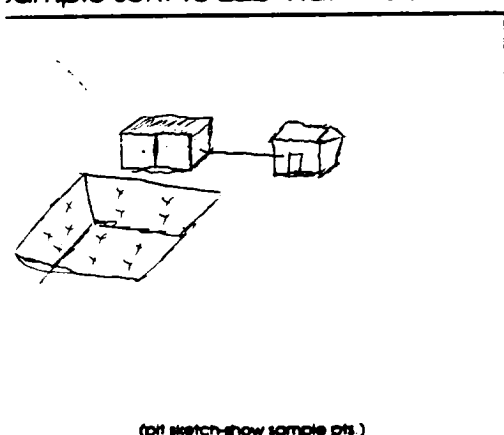

Comments: GLYCOL DEHY DISCHARGES INTO EARTHEN PIT
ON 9/21/99 CIP INSTALLED A TEMPORARY TANK TO
ALLOW WELL TO REMAIN ON DURING PIT CLOSURE
SOIL HAS GLYCOL ODR. EXCAVATED IMPACTED SOIL
+ SHREDDED MATERIAL LAYED OUT PROCESSED
MATERIAL IN ON-SITE LANDFARM

Soil Shipped to: ON-SITE UP
 Prepared by: PS

Q W A L L A B O R A T O R I E S, I N C.

2911 ROTARY TERRACE, P.O. BOX 562/PITTSBURG, KS 66762/(316)232-1970

LABORATORY REPORT:

REFERENCE #: 9909783

SENT WILLIAMS FIELD SERVICE
 TO: 295 CHIPETA WAY
 SALT LAKE CITY, UTAH 84158
 MARK HARVEY
 PROJECT: WFS/IGN-NM PITS

DATE REPORTED: 09/29/99
 DATE COLLECTED: 09/22/99
 DATE RECEIVED: 09/23/99

Reference Fraction: 9909783-01A 25683
 Sample ID: NE BLANCO 77-V-EWXA-01
 Sample Date Collected: 09/22/99 12:07:00

Sample Matrix: SOIL

TEST	METHOD	RESULT	UNITS	PQL	ANALYZED	BY
TPH-DRO	SW846-8015D	48	MG/KG	2	09/25/99	BEM
BTEX	OA1/8021B			3.0		
BENZENE		ND	MG/KG	0.050	09/28/99	KKL
TOLUENE		ND	MG/KG	0.050	09/28/99	KKL
ETHYLBENZENE		ND	MG/KG	0.050	09/28/99	KKL
TOTAL XYLENES		ND	MG/KG	0.050	09/28/99	KKL
BFB (SURROGATE)		100	125	75		
QA/QC PACKAGE LEVEL	NONE		SU			

ND=NONE DETECTED
 PQL=PRACTICAL QUANTITAION LIMIT
 SU=STANDARD UNITS
 B=DETECTED IN METHOD BLANK

APPROVED BY:

 TERRY KOESTER
 LABORATORY DIRECTOR

Q W A L L A B O R A T O R I E S , I N C .

2911 ROTARY TERRACE, P.O. BOX 562/PITTSBURG, KS 66762/(316)232-1970

LABORATORY REPORT:

REFERENCE #: 9909783

SENT WILLIAMS FIELD SERVICE
TO: 295 CHIPETA WAY
SALT LAKE CITY, UTAH 84158
MARK HARVEY
PROJECT: WFS/IGN-NM PITS

DATE REPORTED: 09/29/99
DATE COLLECTED: 09/22/99
DATE RECEIVED: 09/23/99

Reference Fraction: 9909783-02A 35683
Sample ID: NE BLANCO 77-V-EWFL-01
Sample Date Collected: 09/22/99 12:13:00

Sample Matrix: SOIL

TEST	METHOD	RESULT	UNITS	PQL	ANALYZED	BY
TPH-DRO	SW846-8015D	ND	MG/KG	2	09/25/99	BEM
BTEX	OA1/8021B			3.0		
BENZENE		ND	MG/KG	0.050	09/28/99	KKL
TOLUENE		ND	MG/KG	0.050	09/28/99	KKL
ETHYLBENZENE		ND	MG/KG	0.050	09/28/99	KKL
TOTAL XYLENES		ND	MG/KG	0.050	09/28/99	KKL
BFB (SURROGATE)		101	125	75		
QA/QC PACKAGE LEVEL	NONE		SU			

ND=NONE DETECTED

PQL=PRACTICAL QUANTITATION LIMIT

SU=STANDARD UNITS

B=DETECTED IN METHOD BLANK

APPROVED BY:

TERRY KOESTER
LABORATORY DIRECTOR

Q W A L L A B O R A T O R I E S, I N C.

2911 ROTARY TERRACE, P.O. BOX 562/PITTSBURG, KS 66762/(316)232-1970

LABORATORY REPORT:

REFERENCE #: 9909913

SENT WILLIAMS FIELD SERVICE
TO: 295 CHIPETA WAY
SALT LAKE CITY, UTAH 84158
MARK HARVEY

DATE REPORTED: 09/29/99
DATE COLLECTED: 09/27/99
DATE RECEIVED: 09/28/99

PROJECT: WFS/IGW/NM PITS

Reference Fraction: 9909913-01A

Sample ID: NEBU77-V-LF-01

Sample Matrix: SOIL

Sample Date Collected: 09/27/99 15:05:00

TEST	METHOD	RESULT	UNITS	PQL	ANALYZED	BY
QA/QC PACKAGE LEVEL	NONE	DONE	SU			
TOTAL PETROLEUM HYDR	EPA 418.1	ND	MG/KG	10.0	09/29/99	BEM

ND=NONE DETECTED

PQL=PRACTICAL QUANTITATION LIMIT

SU=STANDARD UNITS

B=DETECTED IN METHOD BLANK

APPROVED BY:

TERRY KOESTER
LABORATORY DIRECTOR