

UNITED STATES
DEPARTMENT OF THE INTERIOR
GEOLOGICAL SURVEY(Other instructions on
reverse side)30-045-25408
5. LEASE DESIGNATION AND SERIAL NO.

NM 16057

6. IF INDIAN, ALLOTTEE OR TRIBE NAME

7. UNIT AGREEMENT NAME

8. FARM OR LEASE NAME

Pole's Paradise

9. WELL NO.

2

10. FIELD AND POOL, OR WILDCAT

Basin Dakota

11. SEC., T., R., M., OR BLK.
AND SURVEY OR AREA

K

Sec 9 T30N R14W

12. COUNTY OR PARISH 13. STATE

San Juan

NM

APPLICATION FOR PERMIT TO DRILL, DEEPEN, OR PLUG BACK

1a. TYPE OF WORK

DRILL ☒DEEPEN ☐PLUG BACK ☐

b. TYPE OF WELL

OIL
WELL ☐GAS
WELL ☒

OTHER

SINGLE
ZONE ☒MULTIPLE
ZONE ☐

2. NAME OF OPERATOR

DUGAN PRODUCTION CORP.

3. ADDRESS OF OPERATOR

P O Box 208, Farmington, NM 87401

4. LOCATION OF WELL (Report location clearly and in accordance with any State requirements.)*
At surface

1850' FSL - 1850' FHL

At proposed prod. zone

14. DISTANCE IN MILES AND DIRECTION FROM NEAREST TOWN OR POST OFFICE*

6 miles NE of Kirtland, NM

15. DISTANCE FROM PROPOSED*

LOCATION TO NEAREST
PROPERTY OR LEASE LINE, FT.
(Also to nearest drlg. unit line, if any)

790'

16. NO. OF ACRES IN LEASE

800

17. NO. OF ACRES ASSIGNED

TO THIS WELL

W 320

18. DISTANCE FROM PROPOSED LOCATION*
TO NEAREST WELL, DRILLING, COMPLETED,
OR APPLIED FOR, ON THIS LEASE, FT.

1 1/2 mi to E

19. PROPOSED DEPTH

6025'

20. ROTARY OR CABLE TOOLS

Rotary

21. ELEVATIONS (Show whether DF, RT, GR, etc.)

5575' GL

5587' RKB

22. APPROX. DATE WORK WILL START*

6-25-82

23.

PROPOSED CASING AND CEMENTING PROGRAM

SIZE OF HOLE	SIZE OF CASING	WEIGHT PER FOOT	SETTING DEPTH	QUANTITY OF CEMENT
12-1/4"	8-5/8"	24#	200'	135 sx to surface
7-7/8"	4-1/2"	11.5 & 10.6#	6000'	1700 cu.ft. in 2 stages to surf.

Plan to drill with spud mud to set surface casing. Will then drill with water-mud-gel mixture to test the Dakota Formation in this wild area. We plan to run induction and density logs and, if the Dakota appears productive, will set 4 1/2" casing, selectively perforate, frac, clean out after frac, and complete well using 1 1/2" tubing.

GAS NOT DEDICATED.



IN ABOVE SPACE DESCRIBE PROPOSED PROGRAM: If proposal is to deepen or plug back, give data on present productive zone and proposed new productive zone. If proposal is to drill or deepen directionally, give pertinent data on subsurface locations and measured and true vertical depths. Give blowout preventer program, if any.

24.

SIGNED

Jerry McHugh

TITLE

Landman

DATE 6-7-82

(This space for Federal or State office use)

PERMIT NO.

APPROVAL DATE

APPROVED BY

TITLE

CONDITIONS OF APPROVAL, IF ANY:

APPROVED
AS AMENDED
JUN 24 1982
FOR JAMES F. SIMS
DISTRICT ENGINEER

OIL CONSERVATION DIVISION

STATE OF NEW MEXICO
ENERGY AND MINERALS DEPARTMENTP. O. BOX 2088
SANTA FE, NEW MEXICO 87501Form C-102
Revised 10-1-78

All distances must be from the outer boundaries of the Section.

Operator Dugan Production Corporation			Lease Pole's Paradise		Well No. 2
Unit Letter K	Section 9	Township 30 North	Range 14 West	County San Juan	
Actual Footage Location of Well: 1850 feet from the South line and 1850 feet from the West line					
Ground Level Elev. 5575	Producing Formation Dakota	Pool Basin Dakota		Dedicated Acreage: W320	Acres

1. Outline the acreage dedicated to the subject well by colored pencil or hachure marks on the plat below.
2. If more than one lease is dedicated to the well, outline each and identify the ownership thereof (both as to working interest and royalty).
3. If more than one lease of different ownership is dedicated to the well, have the interests of all owners been consolidated by communitization, unitization, force-pooling, etc?

☐ Yes ☐ No If answer is "yes," type of consolidation _____

If answer is "no," list the owners and tract descriptions which have actually been consolidated. (Use reverse side of this form if necessary.) _____

No allowable will be assigned to the well until all interests have been consolidated (by communitization, unitization, forced-pooling, or otherwise) or until a non-standard unit, eliminating such interests, has been approved by the Division.

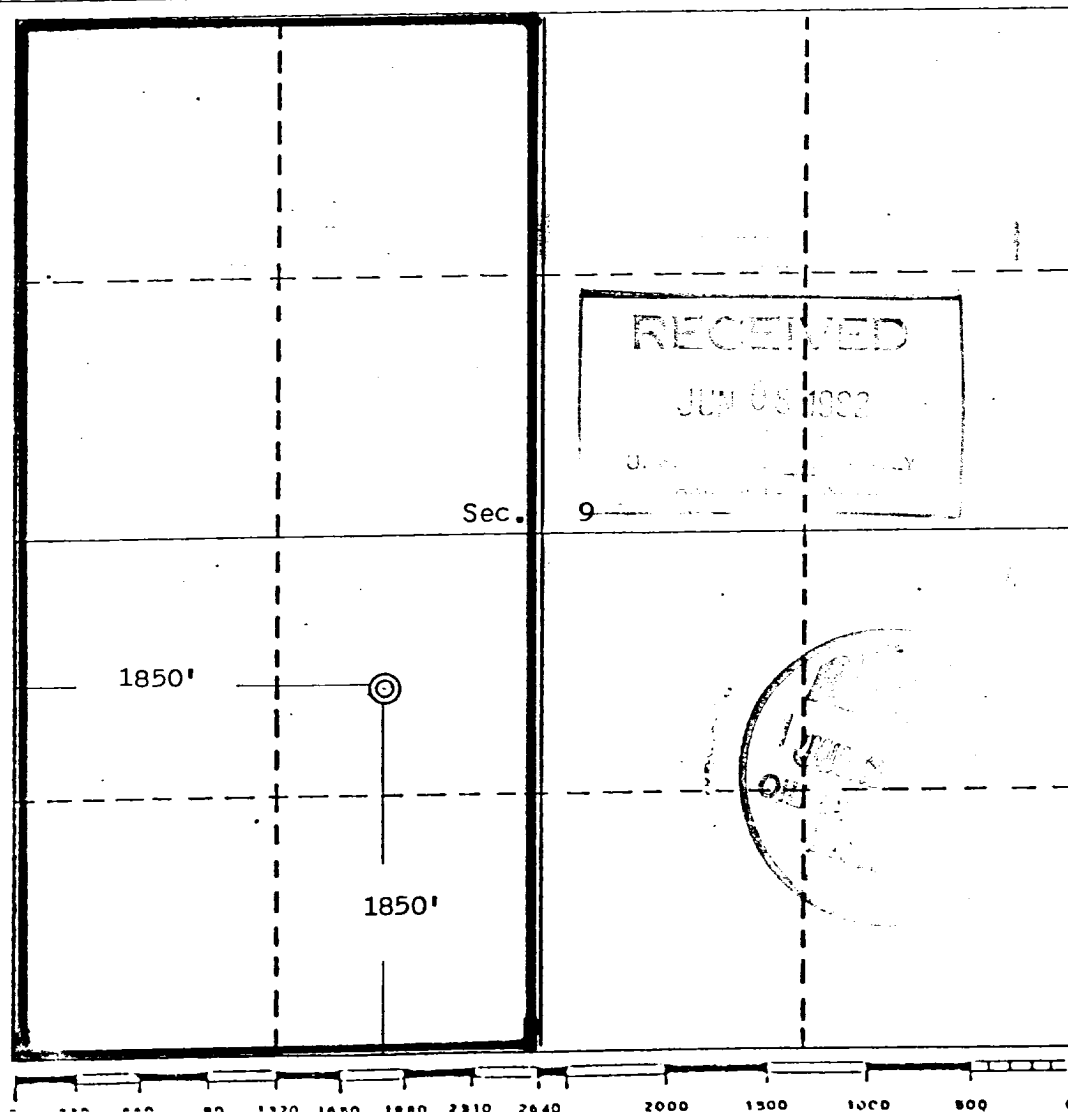

CERTIFICATION

I hereby certify that the information contained herein is true and complete to the best of my knowledge and belief.

Jerry McHugh
Name

Jerry McHugh
Position

Landman

Company

Dugan Production Corp.

Date

6-7-82

I hereby certify that the well location shown on this plat was plotted from field notes or actual measurements made by me or under my supervision, and that the same is true and correct to the best of my knowledge and belief.

EDGAR L. RISENHOVER
REGISTERED LAND SURVEYOR
NEW MEXICO
5979

Date Surveyed May 31, 1982

Edgar L. Risenhoover
Registered Professional Engineer
and/or Land Surveyor

Edgar L. Risenhoover

Certificate No.

5979

