

STATE OF NEW MEXICO
ENERGY AND MINERALS DEPARTMENT

OIL CONSERVATION DIVISION
P. O. BOX 2088
SANTA FE, NEW MEXICO 87501

Form C-101
Revised 10-1-78

| | |
|------------------------|--|
| NO. OF COPIES RECEIVED | |
| DISTRIBUTION | |
| SANTA FE | |
| FILE | |
| U.S.G.S. | |
| LAND OFFICE | |
| OPERATOR | |

5A. Indicate Type of Lease
STATE ☐ FEE ☒

5. State Oil & Gas Lease No.

APPLICATION FOR PERMIT TO DRILL, DEEPEN, OR PLUG BACK

1a. Type of Work

DRILL ☒

DEEPEN ☐

PLUG BACK ☐

b. Type of Well

OIL WELL ☐

GAS WELL ☒

OTHER

SINGLE ZONE ☒

MULTIPLE ZONE ☐

2. Name of Operator

C. & E. Operators, Inc.

3. Address of Operator Suite 1100 Two Energy Square

4849 Greenville Avenue, Dallas, Texas 75206

4. Location of Well

UNIT LETTER L

LOCATED 1850

FEET FROM THE South

LINE

AND 955

FEET FROM THE West

LINE OF SEC. 4

TWP. 30 North RGE. 11 West

7. Unit Agreement Name

8. Farm or Lease Name

FEE

9. Well No.

4 # A

10. Field and Pool, or Wildcat

Blanco Mesaverde

12. County

San Juan

1. Elevations (Show whether DF, RT, etc.)

5758' Ungraded ground

21A. Kind & Status Plug. Bond

Blanket

19. Proposed Depth

4930'

19A. Formation

Mesaverde

20. Rotary or C.T.

Rotary

21B. Drilling Contractor

Young Drilling Co.

22. Approx. Date Work will start

March, 1983

3.

PROPOSED CASING AND CEMENT PROGRAM

| SIZE OF HOLE | SIZE OF CASING | WEIGHT PER FOOT | SETTING DEPTH | SACKS OF CEMENT | EST. TOP |
|--------------|----------------|-----------------|-----------------|---------------------|----------|
| 12 1/4" | 9-5/8" New J | 36 | 275 | 150 sx. 2% CaCl. | Surface |
| 8-3/4" | 7" New K | 23 | 4930 | *300 sx. 1st. stage | 2850' |
| | * Stage collar | in Lewis below | Pictured Cliffs | 350 sx. 2nd. stage | Surface |

Propose to set 9-5/8" casing with spud mud. Cement back to surface. WOC 16 hrs. Nipple up Blow Out Preventers and bleed-off manifold and pressure test to 600 psi. for 30 min. Drill 8-3/4" hole with light gel-chemical mud to TD. Run IES & GRD/N logs. Run 7" casing and cement in two stages. Move off rotary tools and move in completion rig. Perforate & stimulate indicated productive intervals of Mesaverde. Blow down and clean up with N₂. Run 2-3/8" EUE or 1 1/2" EUE tubing to complete. Clean up and test well.

Note: On approval of this application, to drill a hole for cathodic protection anodes and check for boulders. If they are prevalent, to drive and set 13-3/8" conductor through boulders and leave in place. Surface hole would be drilled through the conductor pipe.

Attached is Blow Out Preventer Schematic

ABOVE SPACE DESCRIBE PROPOSED PROGRAM: IF PROPOSAL IS TO DEEPEN OR PLUG BACK, GIVE DATA ON PRESENT PRODUCTIVE ZONE AND PROPOSED NEW PRODUCTION ZONE. GIVE BLOWOUT PREVENTER PROGRAM, IF ANY.

I hereby certify that the information above is true and complete to the best of my knowledge and belief.

Witnessed by John M. Heller N. M. Reg. Eng. #4361 Title Consultant

Date Dec. 28, 1982

(This space for State Use)

PROVED BY

TITLE

APPROVAL EXPIRES

DATE

CONDITIONS OF APPROVAL, IF ANY:

UNLESS DRILLING IS COMMENCED

SPUD DATE MUST BE SUBMITTED

TO THE DIVISION

NEW MEXICO OIL CONSERVATION COMMISSION
WELL LOCATION AND ACREAGE DEDICATION PLAT

Form C-102
Supersedes C-128
Effective 1-1-65

All distances must be from the outer boundaries of the Section.

| | | | | | |
|---|---|-----------------------------|-------------------------|--|------------------------|
| Operator C & E OPERATORS, INC. | | | Lease FEE | | Well No. 4#A |
| Unit Letter L | Section 4 | Township 30 NORTH | Range 11 WEST | County SAN JUAN | |
| Actual Footage Location of Well: 1850 feet from the SOUTH line and 955 feet from the WEST line | | | | | |
| Ground Level Elev. 5758 | Producing Formation Mesaverde | Pool Blanco | | Dedicated Acreage: 320 Acres | |

1. Outline the acreage dedicated to the subject well by colored pencil or hatchure marks on the plat below.
2. If more than one lease is dedicated to the well, outline each and identify the ownership thereof (both as to working interest and royalty).
3. If more than one lease of different ownership is dedicated to the well, have the interests of all owners been consolidated by communitization, unitization, force-pooling, etc?

☒ Yes ☐ No If answer is "yes," type of consolidation Communitized SCR-45 12/15/79

If answer is "no," list the owners and tract descriptions which have actually been consolidated. (Use reverse side of this form if necessary.)

No allowable will be assigned to the well until all interests have been consolidated (by communitization, unitization, forced-pooling, or otherwise) or until a non-standard unit, eliminating such interests, has been approved by the Commission.

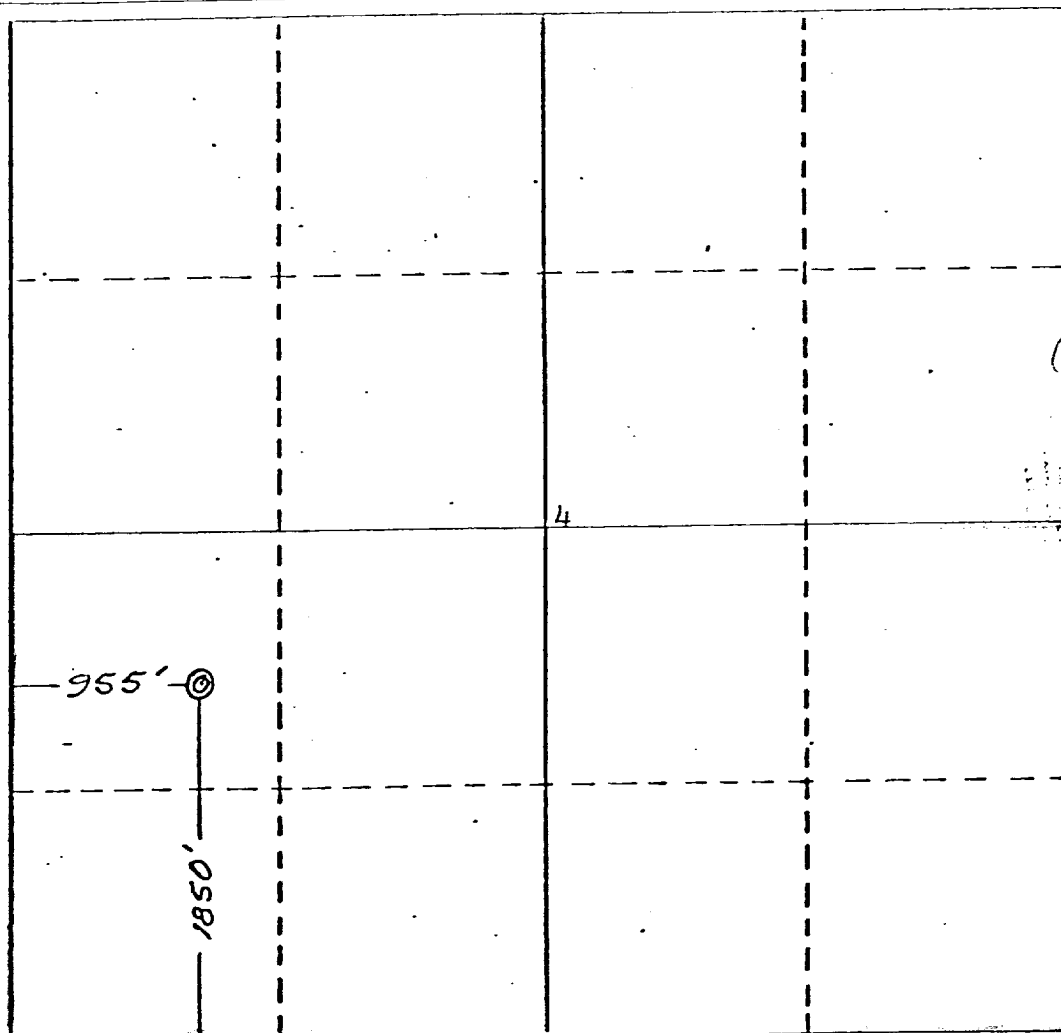

CERTIFICATION

I hereby certify that the information contained herein is true and complete to the best of my knowledge and belief.

Name
James P. Leese
Position
Consultant
Company
C. & E. Operators, Inc.
Date
Dec. 28, 1982

I hereby certify that the well location shown on this plat was plotted from field notes of actual survey made by me or under my supervision, and that the same is true and correct to the best of my knowledge and belief.

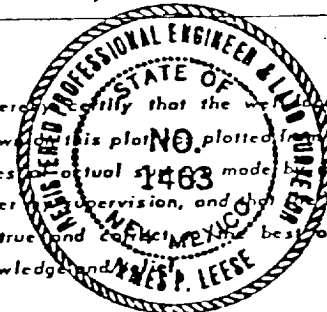

Date Surveyed
20 July 1982
Registered Professional Engineer and/or Land Surveyor
James P. Leese
James P. Leese

Certificate No.
1463

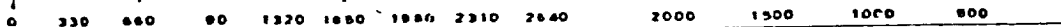

C. & E. OPERATORS, INC.

Typical Blowout Preventer
Installation for Mesaverde
and Pictured Cliffs Wells
10" Series 900 3000 psi. WP

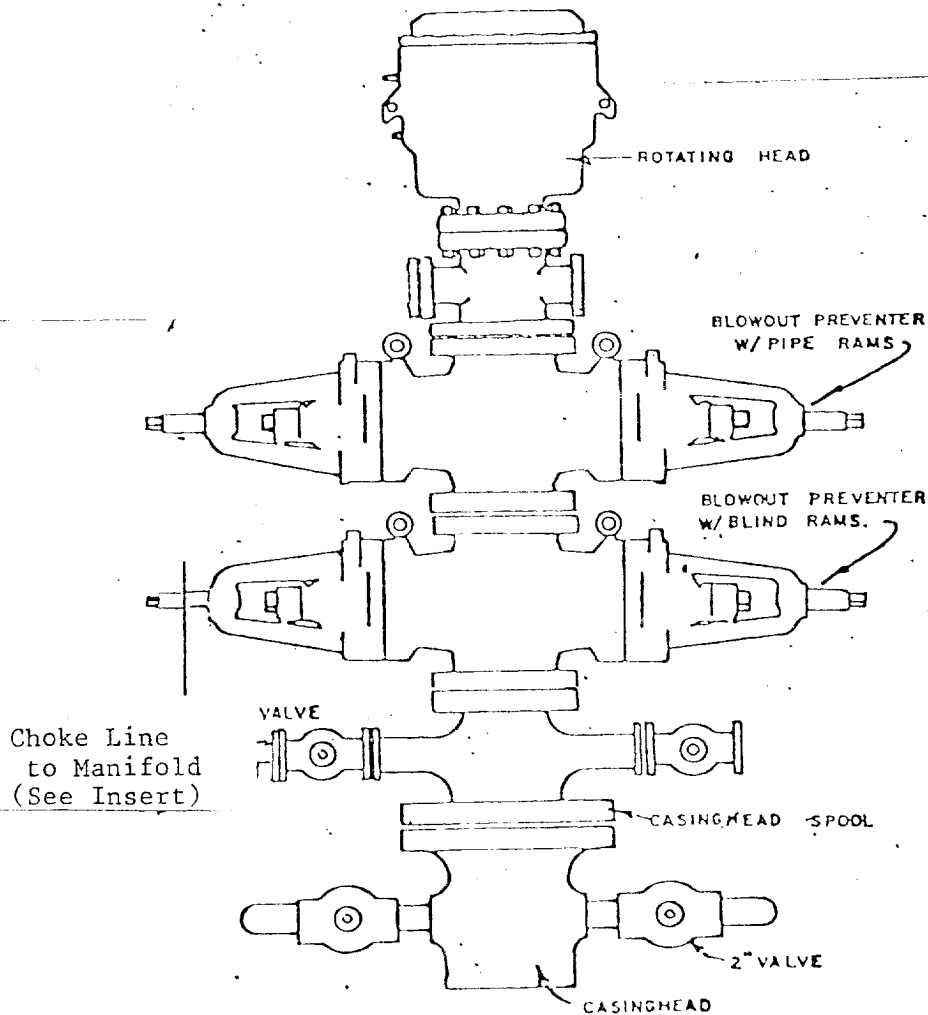

BLOWOUT PREVENTER HOOKUP

2" or 2½" 3000 psi.
Manifold

(IF TURNS ARE NECESSARY, THEY
WILL BE TEES W/BULL PLUG OR 45° ELLS)

