

3 11000

EL PASO (EL PASO)

Surrenders Old  
C-102 and C-103  
Effective 1-1-85

COPIES RECEIVED		
DISTRIBUTION		
SANITARY		
FILE		
U.S.G.S.		
LAND OFFICE		
OPERATOR		

## NEW MEXICO OIL CONSERVATION COMMISSION

## SUNDY NOTICES AND REPORTS ON WELLS

(DO NOT USE THIS FORM FOR PROPOSALS TO DRILL OR TO DEEPEN OR PLUG BACK TO A DIFFERENT RESERVOIR.  
USE "APPLICATION FOR PERMIT" (FORM C-101) FOR SUCH PROPOSALS.)

1. ☐ OIL WELL ☒ GAS WELL ☐ OTHER

2. Name of Operator  
Dugan Production Corp.

3. Address of Operator  
P.O. Box 208, Farmington, NM 87499

4. Location of Well  
UNIT LETTER I 1850 FEET FROM THE South LINE AND 790 FEET FROM  
THE East LINE, SECTION 2 TOWNSHIP 30N RANGE 13W N.M.P.M.

5a. Indicate Type of Lease  
State XX Fee ☐

5. State Oil & Gas Lease No.  
E-3555-7

7. Unit Agreement Name

8. Farm or Lease Name  
Seven of Diamonds9. Well No.  
\*210. Field and Pool, or Wildcat  
\*\*Undes. Fruitland12. County  
San Juan15. Elevation (Show whether DF, RT, GR, etc.)  
5925' GLCheck Appropriate Box To Indicate Nature of Notice, Report or Other Data  
SUBSEQUENT REPORT OF:ALTERING CASING  
PLUG AND ABANDONMENT

PERFORM REMEDIAL WORK ☐

TEMPORARILY ABANDON ☐

PULL OR ALTER CASING ☐

PLUG AND ABANDON ☐

CHANGE PLANS ☒

REMEDIAL WORK ☐

COMMENCE DRILLING OPNS. ☐

CASING TEST AND CEMENT JOBS ☐

OTHER ☐

16. OTHER

17. Describe Proposed or Completed Operations (Clearly state all pertinent details, and give pertinent dates, including estimated date of starting any work) SEE RULE 1103.

\*\*This well has been drilled to a total depth of 2100' to the Pictured Cliffs Formation; PBD is 2060'. We plan to perforate and test only the Fruitland Formation, 1720-1738'.

\*Therefore, we plan to change the number of this well from #1J to #2.  
A C-102, plat, for the Fruitland Formation is enclosed.

Note: Notified Charles Gholson of this change in plans 12-16-83.

**RECEIVED**  
DEC 19 1983  
OIL CON. DIV.  
DIST. 3

18. I hereby certify that the information above is true and complete to the best of my knowledge and belief.

SIGNED Jim L. Jacobs  
Original Signed by CHARLES GHOLSON

TITLE Geologist  
DEPUTY OIL & GAS INSPECTOR, DIST. #3

DATE 12-16DATE DEC 19

APPROVED BY \_\_\_\_\_  
CONDITIONS OF APPROVAL, IF ANY:

All distances must be from the outer boundaries of the Section.

Operator <b>DUGAN PRODUCTION CORP.</b>		Lease <b>Seven of Diamonds</b>		Well No. <b>2</b>
Unit Letter <b>I</b>	Section <b>2</b>	Township <b>30 North</b>	Range <b>13 West</b>	County <b>San Juan</b>
Actual Footage Location of Well: <b>1850</b> feet from the <b>South</b> line and <b>790</b> feet from the <b>East</b> line				
Ground Level Elev. <b>5925</b>	Producing Formation <b>Fruitland</b>	Pool <b>Undesignated Fruitland</b>		Dedicated Acreage: <b>160</b> Acres

1. Outline the acreage dedicated to the subject well by colored pencil or hatchure marks on the plat below.
2. If more than one lease is dedicated to the well, outline each and identify the ownership thereof (both as to working interest and royalty).
3. If more than one lease of different ownership is dedicated to the well, have the interests of all owners been consolidated by communitization, unitization, force-pooling, etc?

☒ Yes ☐ No If answer is "yes," type of consolidation Communitization

If answer is "no," list the owners and tract descriptions which have actually been consolidated. (Use reverse side of this form if necessary.)

No allowable will be assigned to the well until all interests have been consolidated (by communitization, unitization, forced-pooling, or otherwise) or until a non-standard unit, eliminating such interests, has been approved by the Division.

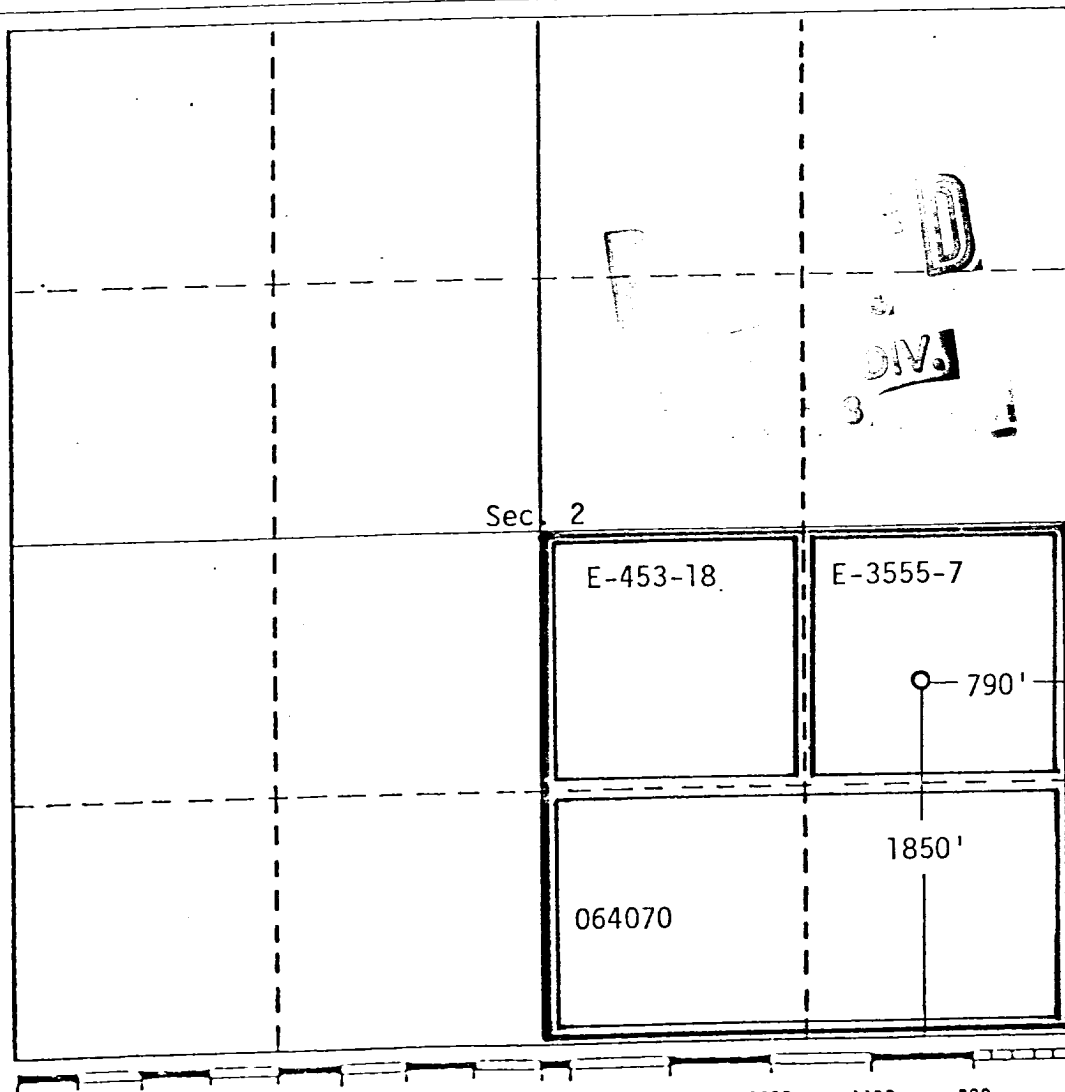

CERTIFICATION

I hereby certify that the information contained herein is true and complete to the best of my knowledge and belief.

Name Jim L. Jacobs  
Position Geologist  
Company Dugan Production Corp.  
Date 12-16-83

I hereby certify that the well location shown on this plat was plotted from field notes of actual surveys made by me or under my supervision, and that the same is true and correct to the best of my knowledge and belief.

Date Surveyed 1-12-83  
Registered Professional Engineer and/or Land Surveyor

*Thomas A. Dugan*  
Certificate No. 2373  
Thomas A. Dugan, PE/LS