

District I  
P.O. Box 1980, Hobbes, NM

District II  
P.O. Drawer DD, Artes, NM 88211

District III  
1000 Rio Brazos Rd, Aztec, NM 87410

State of New Mexico  
Energy, Minerals and Natural Resources Department

OIL CONSERVATION DIVISION  
P.O. Box 2688  
Santa Fe, New Mexico 87504-2088

OIL CON. DIV.  
DIST. 3

12/10/94 OK  
SEP - 04

SUBMIT 1 COPY TO  
APPROPRIATE  
DISTRICT OFFICE  
AND 1 COPY TO  
SANTA FE OFFICE  
(Revised 3/9/94)

**PIT REMEDIATION AND CLOSURE REPORT**

Operator: <u>AMOCO PRODUCTION COMPANY</u>		Telephone: <u>(505) 326-9216</u>	
Address: <u>200 AMOCO COURT, FARMINGTON, NM 87401</u>			
Facility Or: <u>John SHUMACHER #1E</u>			
Well Name			
Location: Unit or Qtr/Qtr Sec <u>NE/NW</u> <u>C</u> Sec <u>8</u> T <u>30</u> R <u>12</u> County <u>SAN JUAN</u>			
Pit Type: Separator _____ Dehydrator _____ Other <u>BLOW DOWN</u>			
Land Type: BLM <u>XX</u> State _____ Fee _____ Other _____			
Pit Location: Pit dimensions: Length <u>37</u> width <u>32</u> depth <u>8</u> (Attach diagram)			
Reference: wellhead <u>XX</u> Other _____			
Footage from reference: <u>136'</u>			
Direction from reference: <u>42</u> Degrees <u>NORTH</u> East North _____ of _____ West South _____			
Depth To Ground Water: (Vertical Distance from contaminants to seasonal high water elevation of ground water)			
Less than 50 feet		(20 points)	
50 feet to 99 feet		(10 points)	
Greater than 100 feet		(0 points)	<u>0</u>
Wellhead Protection Area: (less than 200 feet from a private domestic water source, or, less than 1000 feet from all other water sources)			
Yes		(20 points)	
No		(0 points)	<u>0</u>
Distance To Surface Water: (Horizontal distance to perennial lakes, ponds, rivers, streams, creeks, irrigation canals and ditches)			
Less than 200 feet		(20 points)	
200 feet to 1000 feet		(10 points)	
Greater than 1000 feet		(0 points)	<u>0</u>
RANKING SCORE (TOTAL POINTS):			<u>0</u>

Date Remediation Started: 05/06/94 Date Completed: 05/06/94  
Remediation Method: Excavation XX Approx. cubic yards 350

Landfarmed \_\_\_\_\_ Insitu Bioremediation \_\_\_\_\_

Other \_\_\_\_\_  
\_\_\_\_\_

Remediation Location: Onsite XX Offsite \_\_\_\_\_  
(ie. landfarmed onsite,  
name and location of  
offsite facility)

General Description of Remediation Action: \_\_\_\_\_

CONTAMINATED SIOL WAS REMEDIATED BY DILUTION AND AERATION. COMPETENT SANDSTONE  
ENCOUNTERED @ 5' w/ DRILL RIG (11/20/97).

Ground Water Encountered: No X Yes \_\_\_\_\_ Depth \_\_\_\_\_

Final Pit:

Closure Sampling:  
(if multiple samples,  
attach sample results  
and diagram of sample  
locations and depths)

Sample location See Attached

Sample depth \_\_\_\_\_

Sample date 05/06/94 Sample time 03:00:00

Sample Results

Benzene (ppm) \_\_\_\_\_

Total BTEX (ppm) \_\_\_\_\_

Field headspace (ppm) <100 @ 5' 11/20/97 RV

TPH 1,860 @ 4'

Ground Water Sample: Yes \_\_\_\_\_ No XX (If yes, attach sample results)

I HEREBY CERTIFY THAT INFORMATION ABOVE IS TRUE AND COMPLETE  
TO THE BEST OF MY KNOWLEDGE AND BELIEF

DATE 07/07/94 5/25/98 RV

SIGNATURE

B. Shaw

PRINTED NAME BUDDY SHAW EH&S  
AND TITLE

# PIT LOCATION DIAGRAM

Operator: AMOCO PRODUCTION CO.

Telephone: (505) 326-9219

Address: 200 AMOCO COURT, FARMINGTON, NM 87401

Facility Or: SCHUMACHER 1E

Well Name

Location: Unit or Qtr/Qtr Sec \_\_\_\_\_ Sec \_\_\_\_\_ T \_\_\_\_\_ R \_\_\_\_\_ County \_\_\_\_\_

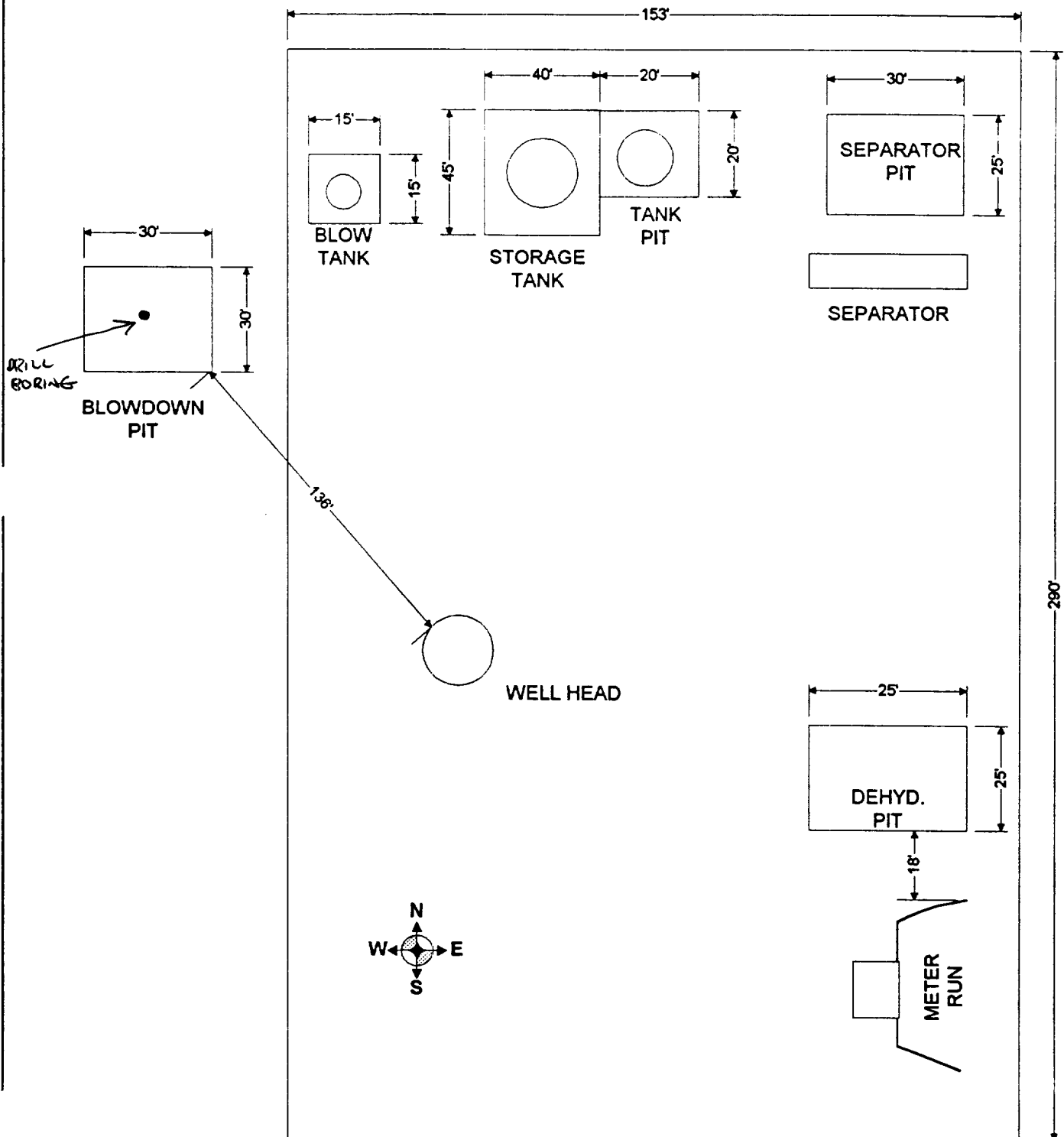

# FINAL PIT CLOSURE SAMPLING REPORT

Operator: AMOCO PRODUCTION COMPANY Telephone: (505) 326-9216

Address: 200 AMOCO COURT, FARMINGTON, NM 87401

Facility Or: SHUMACHER #1E

Well Name

Location: Unit or Qtr/Qtr Sec NE/NW Sec 8 T 30 R 12 County SAN JUAN

Depth	TPH
Surface	2360 ppm
2 ft.	1870 ppm
4 ft.	1860 ppm
6 ft.	1340 ppm
8 ft.	378 ppm
10 ft.	ppm
12 ft.	ppm
14 ft.	ppm
16 ft.	ppm
18 ft.	ppm
20 ft.	ppm
0 ft.	ppm
ft.	ppm
ft.	ppm

**SIDE VIEW**

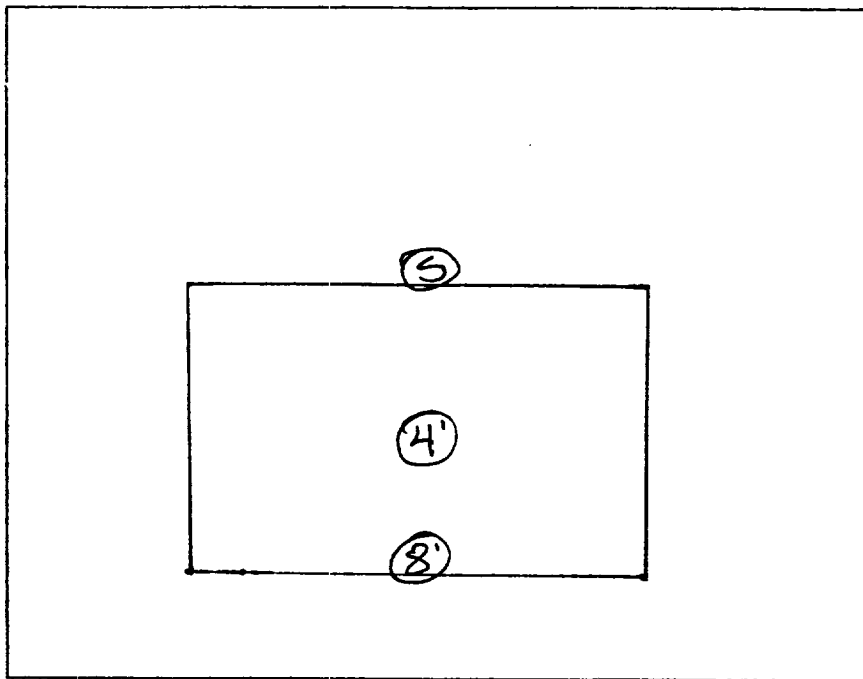

**TOP VIEW**

North Side	112 ppm
East Side	73 ppm
South Side	29 ppm
West Side	89 ppm

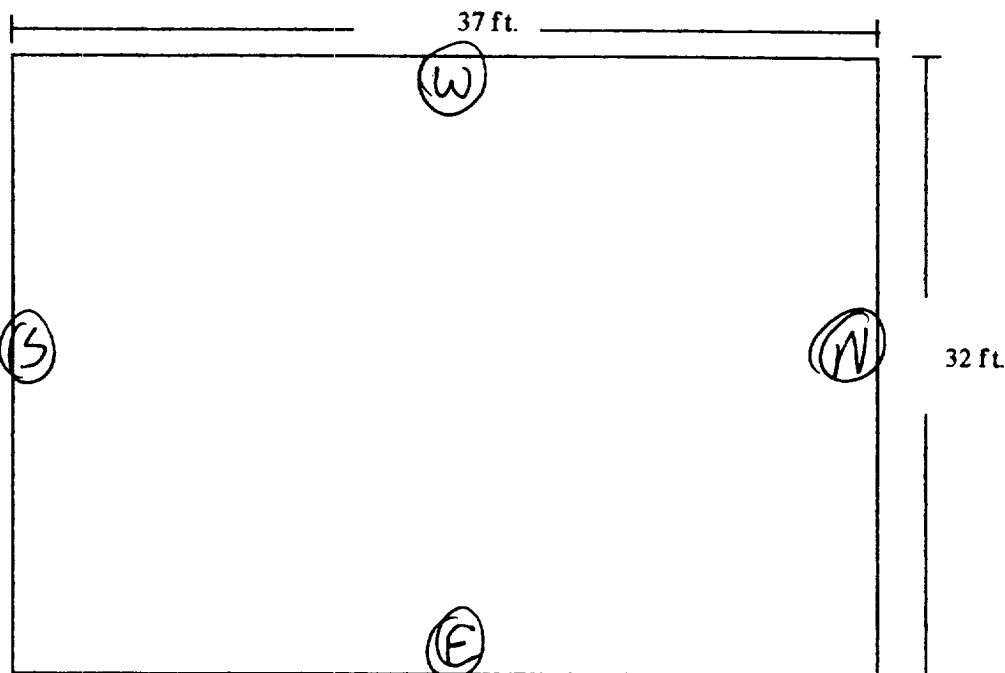

CLIENT: <u>AMOCO</u>	<b>BLAGG ENGINEERING, INC.</b> P.O. BOX 87, BLOOMFIELD, NM 87413 (505) 632-1199	LOCATION NO: <u>WEE</u> C.O.C. NO: <u>5567</u>
----------------------	---	---

## FIELD REPORT: LANDFARM/COMPOST PILE CLOSURE VERIFICATION

LOCATION: NAME: <u>SCHUMACHER, JOHN</u> WELL #: <u>AE</u> PITS: <u>BLW</u> QUAD/UNIT: <u>C</u> SEC: <u>8</u> TWP: <u>30N</u> RNG: <u>12W</u> PM: <u>NM</u> CNTY: <u>ST</u> ST: <u>NM</u> DTP/FOOTAGE: <u>NE/4 NW/4</u> CONTRACTOR: <u>WHOLE EARTH</u>	DATE STARTED: <u>11/20/97</u> DATE FINISHED: _____ ENVIRONMENTAL SPECIALIST: <u>NV/JCB</u>
---	--

### SOIL REMEDIATION:

REMEDIATION SYSTEM: DILUTION & AERATION      APPROX. CUBIC YARDAGE: 350  
 LAND USE: RANGE      LIFT DEPTH (ft): NA

### FIELD NOTES & REMARKS:

DEPTH TO GROUNDWATER: >100'    NEAREST WATER SOURCE: >1000'    NEAREST SURFACE WATER: >1000'

NMOCID RANKING SCORE: 0    NMOCID TPH CLOSURE STD: 5000 PPM

BORING CONDUCTED @ PIT CENTER ACCORDING TO PIT CLOSURE REPORT, ENCOUNTERED COMPETENT SANDSTONE @ 5' BELOW GRADE, SOIL CONSIST OF DK. YELL. BROWN SAND w/ NO DISCOLORATION OR HC ODOR, UNABLE TO OBTAIN SUFFICIENT AMOUNT OF SOIL @ BORING TOTAL DEPTH FOR OVM SAMPLE COLLECTED 4 SAMPLE PTS. USING HAND AUGER, 5 PT. COMPOSITE COLLECTED FOR LAB ANALYSIS OF SUPPOSEDLY DILUTED & AERATED SOIL PLACED BACK INTO EXCAVATED AREA.

### FIELD 418.1 CALCULATIONS

SAMP. TIME	SAMPLE I.D.	LAB No:	WEIGHT (g)	mL. FREON	DILUTION	READING	CALC. ppm

### SKETCH/SAMPLE LOCATIONS

SEE SITE MAP

### OVM RESULTS

### LAB SAMPLES

SAMPLE ID	FIELD HEADSPACE PID (ppm)	SAMPLE ID	ANALYSIS	TIME	RESULTS
DA-1	0.0	DA-1	TPH (8015)	1335	ND

### SCALE

0                      1 FT

TRAVEL NOTES:    CALLOUT: NA    ONSITE: 11/20/97

# ENVIROTECH LABS

PRACTICAL SOLUTIONS FOR A BETTER TOMORROW

## EPA METHOD 8015 Modified Nonhalogenated Volatile Organics Total Petroleum Hydrocarbons

Client:	Blagg / AMOCO	Project #:	04034-10
Sample ID:	DA - 1	Date Reported:	11-25-97
Laboratory Number:	C542	Date Sampled:	11-20-97
Chain of Custody No:	5567	Date Received:	11-21-97
Sample Matrix:	Soil	Date Extracted:	11-21-97
Preservative:	Cool	Date Analyzed:	11-24-97
Condition:	Cool and Intact	Analysis Requested:	8015 TPH

Parameter	Concentration (mg/Kg)	Det. Limit (mg/Kg)
Gasoline Range (C5 - C10)	ND	0.2
Diesel Range (C10 - C28)	ND	0.1
Total Petroleum Hydrocarbons	ND	0.2

ND - Parameter not detected at the stated detection limit.

References: Method 8015B, Nonhalogenated Volatile Organics, Test Methods for Evaluating Solid Waste, SW-846, USEPA, December 1996.

Comments: Schumacher, John # 1E Blow Pit. 5 Pt. Composite.

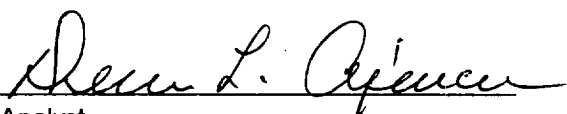
  
Analyst

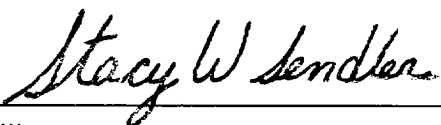
  
Review

District I  
P.O. Box 1980, Hobbes, NM

State of New Mexico  
Energy, Minerals and Natural Resource Department

SUBMIT 1 COPY TO  
APPROPRIATE  
DISTRICT OFFICE  
AND 1 COPY TO  
SANTA FE OFFICE  
(Revised 3/9/94)

District II  
P.O. Drawer DD, Artes, NM 88211

OIL CONSERVATION DIVISION  
P.O. Box 2088  
Santa Fe, New Mexico 87504-2088

District III  
1000 Rio Brazos Rd, Aztec, NM 87410

**PIT REMEDIATION AND CLOSURE REPORT**

Operator: <u>AMOCO PRODUCTION COMPANY</u>		Telephone: <u>(505) 326-9216</u>	
Address: <u>200 AMOCO COURT, FARMINGTON, NM 87401</u>			
Facility Or: <u>Schw SHUMACHER #1E</u>			
Well Name _____			
Location: Unit or Qtr Qtr Sec <u>NE/NW</u> Sec <u>8</u> T <u>30</u> R <u>12</u> County <u>SAN JUAN</u>			
Pit Type: Separator <u>XX</u> Dehydrator _____ Other _____			
Land Type: BLM <u>XX</u> State _____ Fee _____ Other _____			
Pit Location: Pit dimensions: Length <u>30</u> width <u>26</u> depth <u>5</u> (Attach diagram)			
Reference: wellhead <u>XX</u> Other _____			
Footage from reference: <u>132'</u>			
Direction from reference: <u>122</u> Degrees _____ East _____ North _____ of _____ West _____ South <u>EAST</u>			
Depth To Ground Water: (Vertical Distance from contaminants to seasonal high water elevation of ground water)		Less than 50 feet 50 feet to 99 feet Greater than 100 feet	(20 points) (10 points) (0 points) <u>0</u>
Wellhead Protection Area: (less than 200 feet from a private domestic water source, or, less than 1000 feet from all other water sources)		Yes No	(20 points) (0 points) <u>0</u>
Distance To Surface Water: (Horizontal distance to perennial lakes, ponds, rivers, streams, creeks, irrigation canals and ditches)		Less than 200 feet 200 feet to 1000 feet Greater than 1000 feet	(20 points) (10 points) (0 points) <u>0</u>
RANKING SCORE (TOTAL POINTS): <u>0</u>			

Date Remediation Started: 05/06/94 Date Completed: 05/06/94  
Remediation Method: Excavation XX Approx. cubic yards 144

Landfarmed \_\_\_\_\_ Insitu Bioremediation \_\_\_\_\_

Other \_\_\_\_\_  
\_\_\_\_\_

Remediation Location: Onsite XX Offsite \_\_\_\_\_  
(ie. landfarmed onsite,  
name and location of  
offsite facility) \_\_\_\_\_

General Description of Remediation Action: \_\_\_\_\_

CONTAMINATED SIOL WAS REMEDIATED BY DILUTION AND AERATION. COMPETENT SANDSTONE  
ENCOUNTERED @ 3' w/ DRILL RIG (11/20/97).

Ground Water Encountered: No X Yes \_\_\_\_\_ Depth \_\_\_\_\_

Final Pit:  
Closure Sampling:  
(if multiple samples,  
attach sample results  
and diagram of sample  
locations and depths)

Sample location See Attached

Sample depth \_\_\_\_\_

Sample date 05/06/94 Sample time 12:00:00

Sample Results

Benzene (ppm) \_\_\_\_\_

Total BTEX (ppm) \_\_\_\_\_

Field headspace (ppm) < 100 @ 3' 11/20/97 915

TPH 1580 @ 2'

Ground Water Sample: Yes \_\_\_\_\_ No XX (If yes, attach sample results)

I HEREBY CERTIFY THAT INFORMATION ABOVE IS TRUE AND COMPLETE  
TO THE BEST OF MY KNOWLEDGE AND BELIEF

DATE 07/07/94 5/25/98 915

SIGNATURE

Buddy Shaw

PRINTED NAME BUDDY SHAW EH&S  
AND TITLE



# FINAL PIT CLOSURE SAMPLING REPORT

Operator: AMOCO PRODUCTION COMPANY

Telephone: (505) 326-9216

Address: 200 AMOCO COURT, FARMINGTON, NM 87401

Facility Or: SHUMACHER #1E

Well Name

Location: Unit or Qtr/Qtr Sec NE/NW Sec 8 T 30 R 12 County SAN JUAN

## Depth

## TPH

Surface	2870 ppm
2 ft.	1580 ppm
4 ft.	ppm
6 ft.	ppm
8 ft.	ppm
10 ft.	ppm
12 ft.	ppm
14 ft.	ppm
16 ft.	ppm
18 ft.	ppm
20 ft.	ppm
5' ft.	328 ppm
ft.	ppm
ft.	ppm

## SIDE VIEW

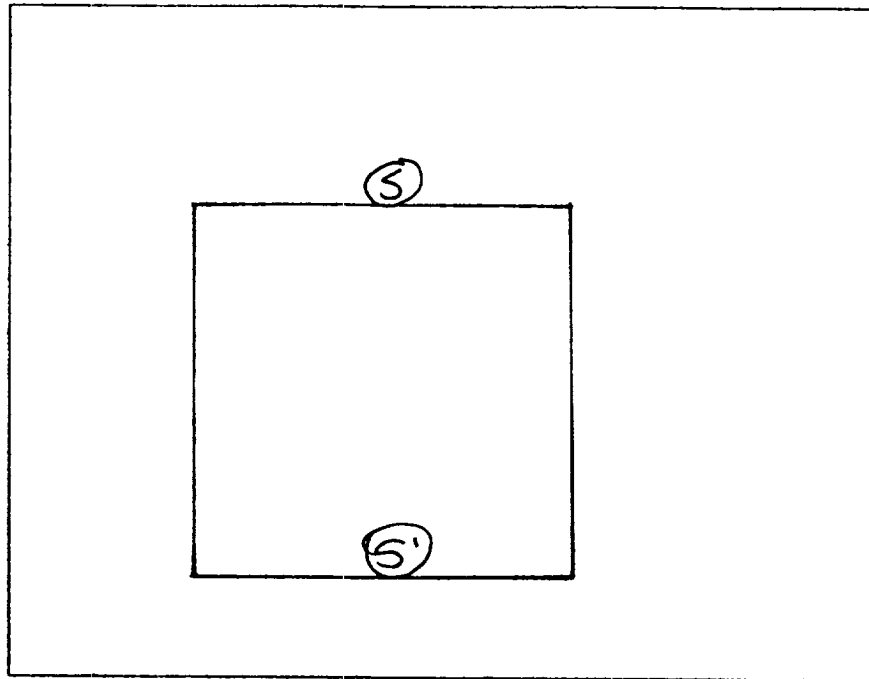

## TOP VIEW

North Side	39 ppm
East Side	546 ppm
South Side	179 ppm
West Side	48 ppm

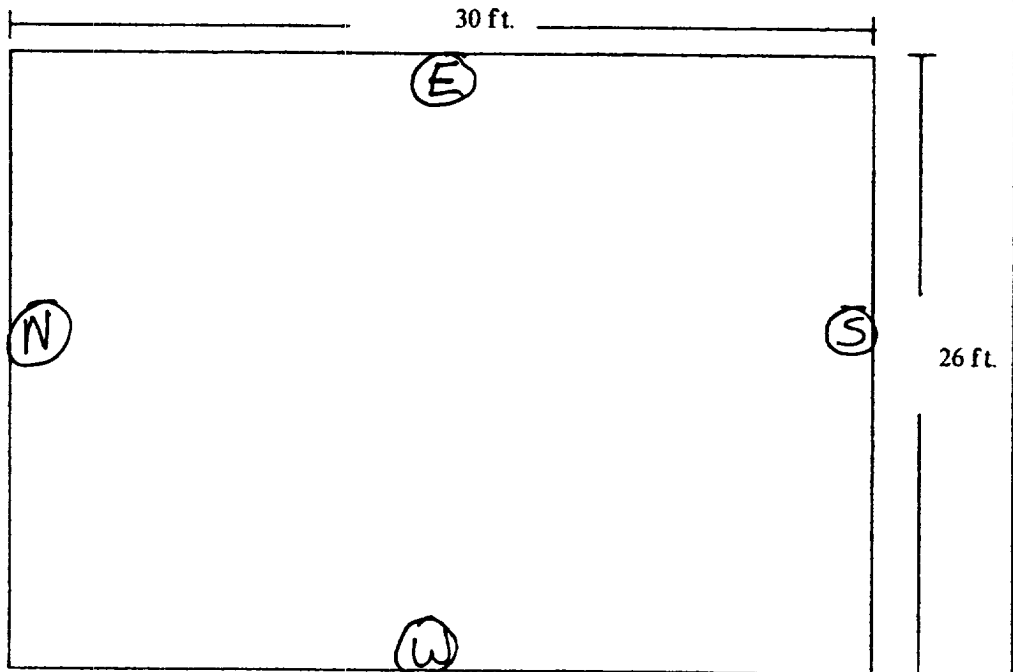

CLIENT: <u>AMOCO</u>	BLAGG ENGINEERING, INC. P.O. BOX 87, BLOOMFIELD, NM 87413 (505) 632-1199	LOCATION NO: <u>WEE</u> C.O.C. NO: <u>5567</u>
----------------------	--	---

## FIELD REPORT: LANDFARM/COMPOST PILE CLOSURE VERIFICATION

LOCATION: NAME: <u>SCHUMACHER, JOHN</u> WELL #: <u>1E</u> PITS: <u>SEP</u> QUAD/UNIT: <u>C</u> SEC: <u>8</u> TWP: <u>30N</u> RNG: <u>12W</u> PM: <u>NM</u> CNTY: <u>ST</u> ST: <u>NM</u> DIR/FOOTAGE: <u>NE/4</u> <u>NW/4</u> CONTRACTOR: <u>WHOLE EARTH</u>	DATE STARTED: <u>11/20/97</u> DATE FINISHED: _____ ENVIRONMENTAL SPECIALIST: <u>W/JCB</u>
--	---

### SOIL REMEDIATION:

REMEDIATION SYSTEM: DILUTED + AERATION      APPROX. CUBIC YARDAGE: 144  
 LAND USE: RANGE      LIFT DEPTH (ft): NA

### FIELD NOTES & REMARKS:

DEPTH TO GROUNDWATER: >100'    NEAREST WATER SOURCE: >1000'    NEAREST SURFACE WATER: >1000'

NMOCD BANKING SCORE: 0    NMOCD TPH CLOSURE STD: 5000 PPM

BORING CONDUCTED @ PIT CENTER ACCORDING TO PIT CLOSURE REPORT, ENCOUNTERED COMPETENT SANDSTONE @ 3' BELOW GRADE. SOIL CONSIST OF OR. YELL. BROWN SAND W/ NO DISCOLORATION OR HC ODOR OBSERVED. W/IN BORING OR @ ANY OF THE 4 HAND AUGER SAMPLE PTS. (1' DEPTH BELOW GRADE), COLLECTED 5 PT. COMPOSITE FOR LAB ANALYSIS OF SUPPOSEDLY DILUTED & AERATED. SOIL PLACED BACK INTO EXCAVATED AREA.

### FIELD 418.1 CALCULATIONS

SAMP. TIME	SAMPLE I.D.	LAB No:	WEIGHT (g)	mL. FREON	DILUTION	READING	CALC. ppm

### SKETCH/SAMPLE LOCATIONS

SEE SITE MAP

### OVM RESULTS

### LAB SAMPLES

SAMPLE ID	FIELD HEADSPACE PID (ppm)	SAMPLE ID	ANALYSIS	TIME	RESULTS
DA-1	0.0	DA-1	TPH (8015)	1320	0.7

### SCALE



0 FT

TRAVEL NOTES:    CALLOUT: NA    ONSITE: 11/20/97

# ENVIROTECH LABS

PRACTICAL SOLUTIONS FOR A BETTER TOMORROW

## EPA METHOD 8015 Modified Nonhalogenated Volatile Organics Total Petroleum Hydrocarbons

Client:	Blagg / AMOCO	Project #:	04034-10
Sample ID:	DA - 1	Date Reported:	11-25-97
Laboratory Number:	C541	Date Sampled:	11-20-97
Chain of Custody No:	5567	Date Received:	11-21-97
Sample Matrix:	Soil	Date Extracted:	11-21-97
Preservative:	Cool	Date Analyzed:	11-24-97
Condition:	Cool and Intact	Analysis Requested:	8015 TPH

Parameter	Concentration (mg/Kg)	Det. Limit (mg/Kg)
Gasoline Range (C5 - C10)	ND	0.2
Diesel Range (C10 - C28)	0.7	0.1
Total Petroleum Hydrocarbons	0.7	0.2

ND - Parameter not detected at the stated detection limit.

References: Method 8015B, Nonhalogenated Volatile Organics, Test Methods for Evaluating Solid Waste, SW-846, USEPA, December 1996.

Comments: Schumacher, John # 1E Separator Pit. 5 Pt. Composite.

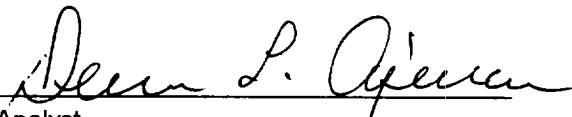
  
Analyst

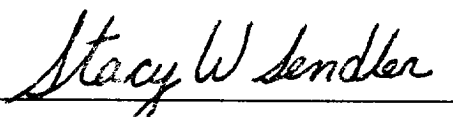
  
Review



## CHAIN OF CUSTODY RECORD

Client/Project Name			Project Location			ANALYSIS/PARAMETERS									
BAGS / ANECO			SCHUMACHER JOHN #1E												
Sampler: (Signature) <i>Michael W. J.</i>			Chain of Custody Tape No. 04034-10			No. of Containers		Remarks							
Sample No./ Identification	Sample Date	Sample Time	Lab Number	Sample Matrix											
DA-1	11/20/97	1320	CS41	SOIL	1	✓								SEPARATOR PIT	
DA-1	11/20/97	1335	CS42	SOIL	1	✓								Bowl PIT	
														BOTH SAMPLES	
														FRESH - COOL	
														4 ARE 5 PT.	
														COMPOSITES	
Relinquished by: (Signature) <i>Michael W. J.</i>			Date	Time	Receiver by: (Signature) <i>Robert K. Cipriano</i>										
Relinquished by: (Signature)					Received by: (Signature)										
Relinquished by: (Signature)					Received by: (Signature)										
Relinquished by: (Signature)					Received by: (Signature)										
Ref COCs 5564-5574			<b>ENVIROTECH INC.</b> 5796 U.S. Highway 64-3014 Farmington, New Mexico 87401 (505) 632-0615												