

UNITED STATES  
DEPARTMENT OF THE INTERIOR  
GEOLOGICAL SURVEYRECEIVED  
SUBMIT IN TRIPLICATE  
(Other instructions on  
reverse side)Form approved.  
Budget Bureau No. 42-R1425.

NOV 30 1983

30-045-25850

## APPLICATION FOR PERMIT TO DRILL, DEEPEN, OR PLUG BACK

## 1a. TYPE OF WORK

DRILL ☒DEEPEN ☐PLUG BACK ☐

## b. TYPE OF WELL

OIL  
WELL ☒GAS  
WELL ☒

OTHER

SINGLE  
ZONE ☐MULTIPLE  
ZONE ☒

## 2. NAME OF OPERATOR

Union Texas Petroleum Corporation

## 3. ADDRESS OF OPERATOR

P.O. Box 1290, Farmington, New Mexico 87401

## 4. LOCATION OF WELL (Report location clearly and in accordance with any State requirements.)

At surface 801' FSL; 948' FEL

At proposed prod. zone Same as above

BUREAU OF LAND MANAGEMENT  
FARMINGTON RESOURCE AREA

## 14. DISTANCE IN MILES AND DIRECTION FROM NEAREST TOWN OR POST OFFICE\*

6 miles north of Farmington, New Mexico

15. DISTANCE FROM PROPOSED\* 948'  
LOCATION TO NEAREST  
PROPERTY OR LEASE LINE, FT.  
(Also to nearest drlg. unit line, if any) 801'16. NO. OF ACRES IN LEASE  
2081.2018. DISTANCE FROM PROPOSED LOCATION\*  
TO NEAREST WELL, DRILLING, COMPLETED,  
OR APPLIED FOR, ON THIS LEASE, FT. 2176'19. PROPOSED DEPTH  
6420'17. NO. OF ACRES ASSIGNED  
TO THIS WELL  
Gallup: 40.00/ Dakota 320.0020. ROTARY OR CABLE TOOLS  
Rotary21. ELEVATIONS (Show whether OF, AT, or GR) AUTHORIZED ARE  
5591' GR SUBJECT TO COMPLIANCE WITH ATTACHED22. APPROX. DATE WORK WILL START\*  
December 12, 1983

## 23. "GENERAL REQUIREMENTS" PROPOSED CASING AND CEMENTING PROGRAM

This section is subject  
appeal pursuant to 30 CFR 290.

SIZE OF HOLE	SIZE OF CASING	WEIGHT PER FOOT	SETTING DEPTH	QUANTITY OF CEMENT
13-3/4"	10-3/4"	40.50# K-55	300'	200 cu.ft. (circulated)
9-7/8"	7"	23.0 # K-55	6420'	1808 cu.ft. (circulated)

We desire to drill surface hole to  $\pm 300'$  using natural mud as the circulating medium. Run 9-5/8" casing to TD and cement w/C1 B cement. W.O.C. Test casing to 800 PSIG for 10 minutes. Drill to 6420' using a starch base permaloid, non-dispersed mud as the circulating medium. Log the well. Run 7" casing to TD with DV tools at approximately 2075' and at 4700'. Cement in 3 stages as follows: 500 cu.ft. of 50-50 POZ mix with 2% gel and 10# salt/sack; 2nd stage 385 cu.ft. of 65/35/6 followed by approx. 175 cu.ft. of C1 B cement w/2% CaCl<sub>2</sub>; 3rd stage approx. 630 cu.ft. of 65/35/12 followed by approx. 118 cu.ft. of C1 B cement. W.O.C. Drill out DV tools. Pressure test the casing to 1500 PSIG for 15 minutes. Perf & frac the Dakota zone. Set a bridgeplug above the Dakota zone. Perf and frac the Gallup zone. Clean the Gallup up. Remove the bridgeplug. Clean the Dakota zone up. Run new 2-3/8", 4.7#, J-55, EUE tubing with a production packer to be set above the Dakota zone. Run a second string of 2-3/8", 4.7#, J-55, EUE tubing to be landed in the Gallup zone. Run rods and pump in the Gallup tubing. Set pumping unit, separator and tanks. Test the well. Connect to a gathering system. The gas from this well has previously been dedicated to a transporter.

NOTE: Actual cement volumes to be calculated from Caliper Log.

IN ABOVE SPACE DESCRIBE PROPOSED PROGRAM: If proposal is to deepen or plug back, give data on present productive zone and proposed new productive zone. If proposal is to drill or deepen directionally, give pertinent data on subsurface locations and measured and true vertical depths. Give blowout preventer program, if any.

24.

SIGNED

Rudy D. Mottlo

TITLE Area Operations Manager

(This space for Federal or State office use)

PERMIT NO.

APPROVAL DATE

APPROVED BY

CONDITIONS OF APPROVAL, IF ANY:

TITLE

NMOCC

APPROVED  
AS AMENDED

NOV 29 1983

FARMINGTON RESOURCE AREA

All distances must be from the outer boundaries of the Section.

Operator <b>UNION TEXAS PETROLEUM CORPORATION</b>			Lease <b>MCCORD</b>		Well No. <b>6E</b>
Unit Letter <b>P</b>	Section <b>9</b>	Township <b>30 NORTH</b>	Range <b>13 WEST</b>	County <b>SAN JUAN</b>	
Actual Footage Location of Well: <b>801</b> feet from the <b>SOUTH</b> line and <b>948</b> feet from the <b>EAST</b> line					
Ground Level Elev. <b>5591</b>	Producing Formation <b>Gallup-Dakota</b>	Pool <b>Undesignated Basin</b>		Bearing: <b>S 40.00° E</b> Distance: <b>320.00</b> feet	

1. Outline the acreage dedicated to the subject well by colored pencil or hatchure marks on the plat below.
2. If more than one lease is dedicated to the well, outline each and identify the ownership thereof (both as to working interest and royalty).
3. If more than one lease of different ownership is dedicated to the well, have the interests of all owners been consolidated by communitization, unitization, force-pooling, etc?

☐ Yes ☐ No If answer is "yes," type of consolidation \_\_\_\_\_

If answer is "no," list the owners and tract descriptions which have actually been consolidated. (Use reverse side of this form if necessary.) \_\_\_\_\_

No allowable will be assigned to the well until all interests have been consolidated (by communitization, unitization, forced-pooling, or otherwise) or until a non-standard unit, eliminating such interests, has been approved by the Division.

**RECEIVED**

NOV 30 1983

OIL CON. DIV.  
DIST. 3

**RECEIVED**

NOV 14 1983

BUREAU OF LAND MANAGEMENT  
FARMINGTON RESOURCE AREA

**CERTIFICATION**

I hereby certify that the information contained herein is true and complete to the best of my knowledge and belief.

*Rudy D. Motto*

Name

Rudy D. Motto

Position

Area Operations Manager

Company

Union Texas Petroleum

Date

November 11, 1983

I hereby certify that the well location shown on this plat was plotted from field notes of a survey made by me or under my supervision, and that the same is true and correct to the best of my knowledge and belief.

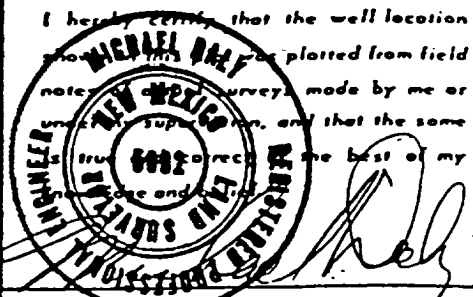

Date Surveyed

October 18, 1983

Registered Professional Engineer  
and/or Land Surveyor

Michael Daly

Certificate No.

5002

948  
801'

