

UNITED STATES
DEPARTMENT OF THE INTERIOR
GEOLOGICAL SURVEY

APPLICATION FOR PERMIT TO DRILL, DEEPEN, OR PLUG BACK

1a. TYPE OF WORK

DRILL ☒DEEPEN ☐PLUG BACK ☐

b. TYPE OF WELL

OIL
WELL ☒GAS
WELL ☒

OTHER

SINGLE
ZONE ☐MULTIPLE
ZONE ☒

2. NAME OF OPERATOR

LOBO PRODUCTION

3. ADDRESS OF OPERATOR

P.O. Box 2364, Farmington, New Mexico 87499

4. LOCATION OF WELL (Report location clearly and in accordance with any State requirements*)

At surface

990 FNL and 940 FWL

At proposed prod. zone

same

14. DISTANCE IN MILES AND DIRECTION FROM NEAREST TOWN OR POST OFFICE

3.5 miles North of Kirtland, New Mex. Post Office

15. DISTANCE FROM PROPOSED*

LOCATION TO NEAREST
PROPERTY OR LEASE LINE, FT.
(Also to nearest drlg. unit line, if any)

940 ft.

16. NO. OF ACRES IN LEASE

960

18. DISTANCE FROM PROPOSED LOCATION*

TO NEAREST WELL, DRILLING, COMPLETED,
OR APPLIED FOR, ON THIS LEASE, FT.

1/2 mile

19. PROPOSED DEPTH

5800'

17. NO. OF ACRES ASSIGNED
TO THIS WELL

320 Dakota, 40 Gallup

20. ROTARY OR CABLE TOOLS

Rotary

21. ELEVATIONS (Show whether DE, RT, OR etc.)

DRILLING OPERATIONS AUTHORIZED ARE
SUBJECT TO COMPLIANCE WITH ATTACHED

5344' Gr

23. "GENERAL REQUIREMENTS" PROPOSED CASING AND CEMENTING PROGRAM

22. APPROX. DATE WORK WILL START*

March 15, 1984

This action is subject to administrative
appeal pursuant to 30 CFR 290.

SIZE OF HOLE	SIZE OF CASING	WEIGHT PER FOOT	SETTING DEPTH	QUANTITY OF CEMENT
12 1/4	8 5/8	K55- 24#	200'	175 sks
7 7/8	5 1/2	J55- 17#	5800'	900 sks

Will drill 12 1/4" hole to 200 ft. and set 200 ft. of 8 5/8" K55-24# used casing with 175 sks cement. Will drill 7 7/8" hole to 5800' and run open hole logs. If appears productive, will run 5800' of 5 1/2", 17# new casing and bring cement up across Fruitland formation. Will perforate and stimulate as required.

FORMATION

ESTIMATED TOPS

CONTENT

Fruitland	210'	Water and Gas
Picture Cliff	725'	Water and Gas
Cliff House	1719'	Water
Point Look Out	3210'	Water
Mancos	3514'	Shale
Gallup	4505'	Oil and Gas
Greenhorn	5284'	Gas
Graneros-Dakota	5400'	Gas

IN ABOVE SPACE DESCRIBE PROPOSED PROGRAM: If proposal is to deepen or plug back, give data on present productive zone and proposed new productive zone. If proposal is to drill or deepen directionally, give pertinent data on subsurface locations and measured and true vertical depths. Give blowout preventer program, if any.

24.

SIGNED

TITLE

Operator

DATE

1-18-84

(This space for Federal or State office use)

PERMIT NO.

APPROVAL DATE

APPROVED BY

TITLE

CONDITIONS OF APPROVAL, IF ANY:

RECEIVED

JAN 30 1984

OIL CON. DIV.

NMOCC

APPROVED

AS AMENDED

DATE

JAN 27 1984

AREA MANAGER
FARMINGTON RESOURCE AREA

All distances must be from the outer boundaries of the Section

Operator LOBO PRODUCTION			Lease MESA TWIN MOUNDS			Well No. # 1		
Well Letter D	Section 31	Township 30 NORTH	Range 14 WEST	County SAN JUAN				
Well Postage Location of Well: 990 feet from the NORTH line and 940 feet from the WEST line								
Land Level Elev. 5344	Producing Formation Basin Dakota		Pool Basin Dakota			Dedicated Acreage: 320 Acres		

1. Outline the acreage dedicated to the subject well by colored pencil or hachure marks on the plat below.
2. If more than one lease is dedicated to the well, outline each and identify the ownership thereof (both as to working interest and royalty).
3. If more than one lease of different ownership is dedicated to the well, have the interests of all owners been consolidated by communitization, unitization, force-pooling, etc?

☐ Yes ☐ No If answer is "yes," type of consolidation _____

If answer is "no," list the owners and tract descriptions which have actually been consolidated. (Use reverse side of this form if necessary.) _____

No allowable will be assigned to the well until all interests have been consolidated (by communitization, unitization, forced-pooling, or otherwise) or until a non-standard unit, eliminating such interests, has been approved by the Division

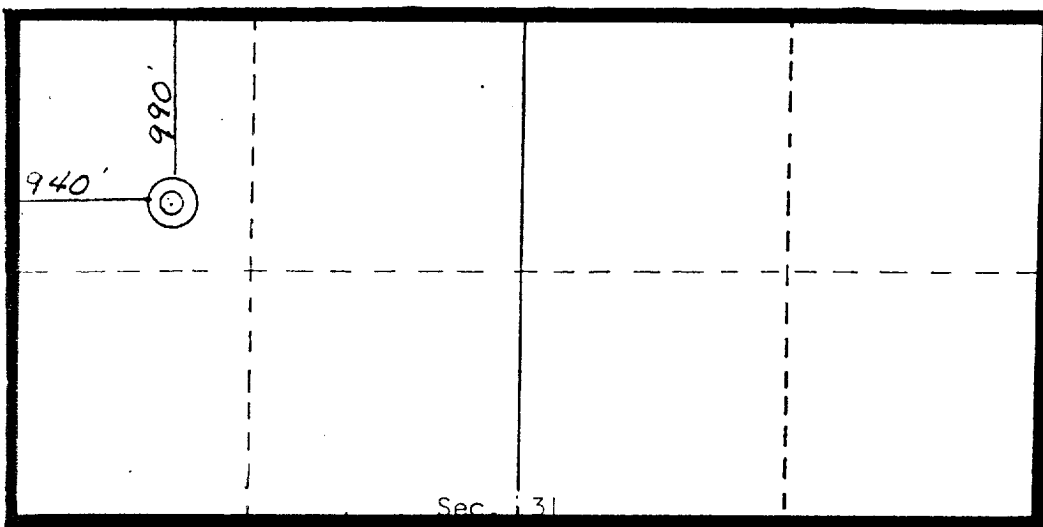

CERTIFICATION

I hereby certify that the information contained herein is true and complete to the best of my knowledge and belief.

R.E. Lauritsen

Name

R.E. LAURITSEN

Position

Operator (Partner)

Company

LOBO PRODUCTION

Date

1-17084

I hereby certify that the well location shown on this plat was plotted from field notes of actual surveys made by me or under my supervision, and that the same is true and correct to the best of my knowledge and belief.

26 September, 1983

Date Surveyed

Charles C. Stocking

Registered Professional Engineer and/or Land Surveyor

Cur. C. Stocking

Certificate No.

5980

RECEIVED
JAN 30 1984
OIL CON. DIV.
DIST. 3

RECEIVED
JAN 30 1984
BUREAU OF LAND MANAGEMENT
SANTA FE, NEW MEXICO

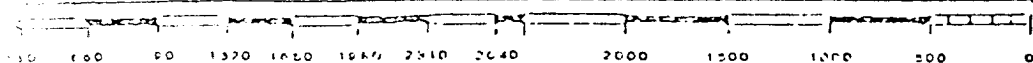

All distances must be from the outer boundaries of the Section

Operator LOBO PRODUCTION			Lease MESA TWIN MOUNDS			Well No. # 1		
Tr. Letter 9	Section 31	Township 30 NORTH	Range 14 WEST	County SAN JUAN				
Well Footage Location of Well: 990 feet from the NORTH line and 940 feet from the WEST line								
Ground Level Elev. 5344		Producing Formation Gallup		Pool Wildcat		Dedicated Acreage: 40 Acres		

1. Outline the acreage dedicated to the subject well by colored pencil or hatchure marks on the plat below.
2. If more than one lease is dedicated to the well, outline each and identify the ownership thereof (both as to working interest and royalty).
3. If more than one lease of different ownership is dedicated to the well, have the interests of all owners been consolidated by communitization, unitization, force-pooling, etc?

☐ Yes ☐ No If answer is "yes," type of consolidation _____

If answer is "no," list the owners and tract descriptions which have actually been consolidated. (Use reverse side of this form if necessary.) _____

No allowable will be assigned to the well until all interests have been consolidated (by communitization, unitization, forced-pooling, or otherwise) or until a non-standard unit, eliminating such interests, has been approved by the Division

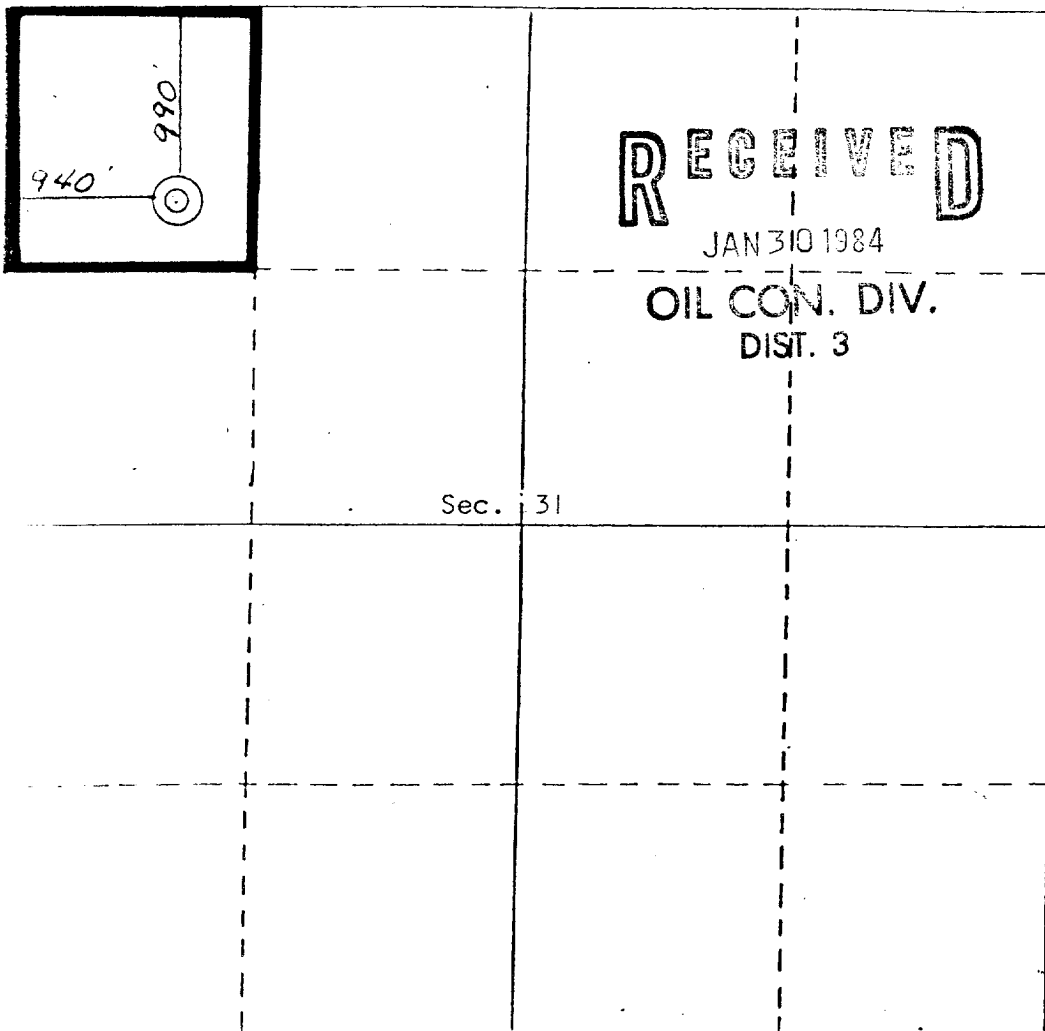

CERTIFICATION

I hereby certify that the information contained herein is true and complete to the best of my knowledge and belief.

R.E. Lauritzen
Name

R.E. Lauritzen
Position

Operator (Partner)

Company
LOBO PRODUCTION

Date
1-17-84

I hereby certify that the well location shown on this plat was plotted from field notes of actual surveys made by me or under my supervision, and that the same is true and correct to the best of my knowledge and belief.

26 September, 1983

Curtis C. Stocking
Date Surveyed
Registered Professional Engineer
and/or Land Surveyor

Curtis C. Stocking

Certificate No.
5980

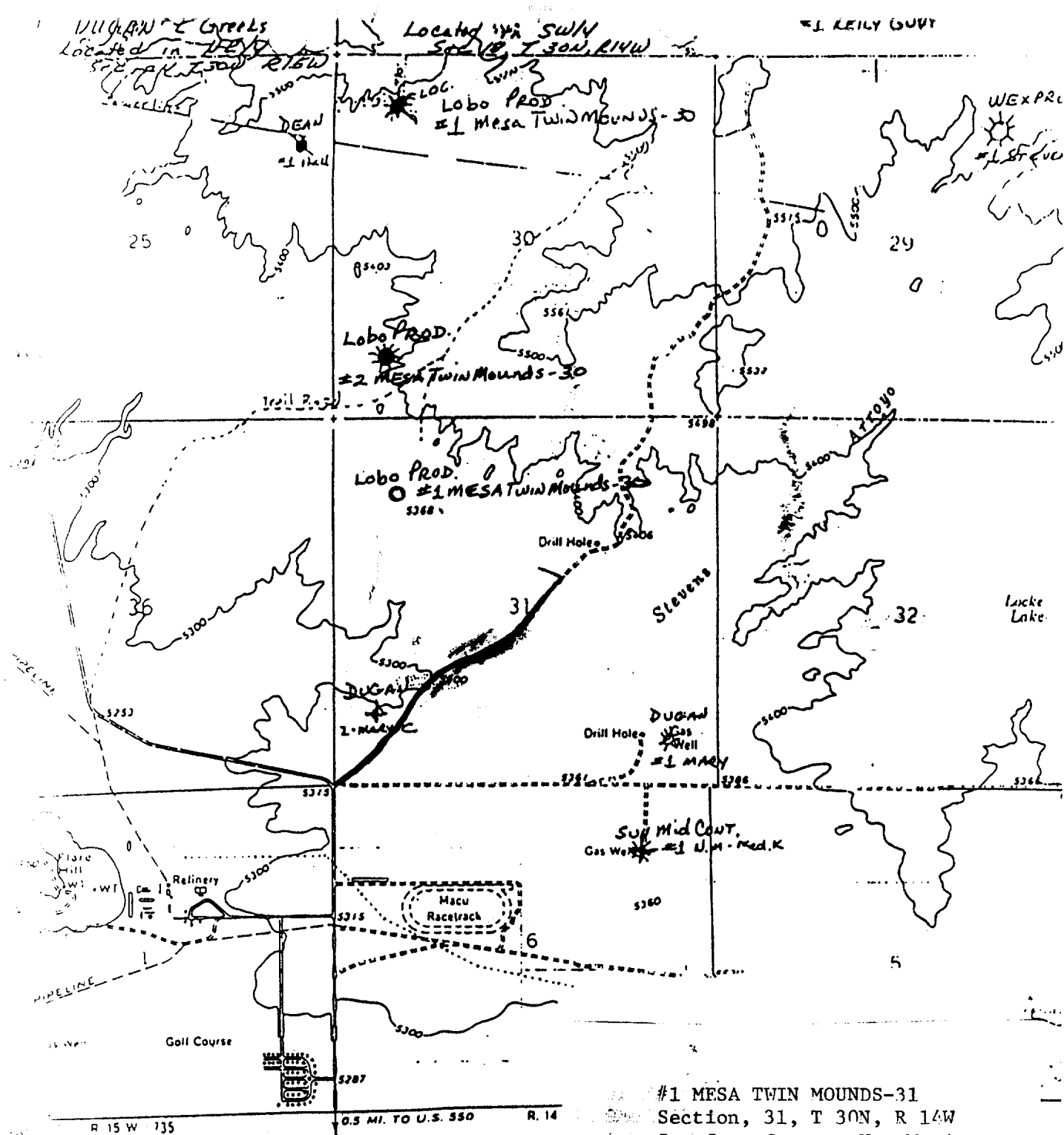

Map # 2
Existing Wells

Map # 2
Existing Wells

Map # 2
Existing Wells

Map # 2
Existing Wells

Map # 2
Existing Wells

Map # 2
Existing Wells