

All distances must be from the outer boundaries of the Section.

Operator <b>CONSOLIDATED OIL &amp; GAS, INC</b>			Lease <b>ROURKE</b>	Well No. <b>1-E</b>
Unit Letter <b>D</b>	Section <b>4</b>	Township <b>30 NORTH</b>	Range <b>13 WEST</b>	County <b>SAN JUAN</b>
Actual Footage Location of Well: <b>1000</b> feet from the <b>NORTH</b> line and <b>1000</b> feet from the <b>WEST</b> line				
Ground Level Elev. <b>5551</b>	Producing Formation <b>Gallup</b>	Pool <b>Flora Vista Gallup</b>	Dedicated Acreage: <b>160-30 160</b> Acres	

1. Outline the acreage dedicated to the subject well by colored-pencil or hatchure marks on the plat below.
2. If more than one lease is dedicated to the well, outline each and identify the ownership thereof (both as to working interest and royalty).
3. If more than one lease of different ownership is dedicated to the well, have the interests of all owners been consolidated by communitization, unitization, force-pooling, etc?

Yes  No If answer is "yes," type of consolidation \_\_\_\_\_

If answer is "no," list the owners and tract descriptions which have actually been consolidated. (Use reverse side of this form if necessary.) \_\_\_\_\_

No allowable will be assigned to the well until all interests have been consolidated (by communitization, unitization, forced-pooling, or otherwise) or until a non-standard unit, eliminating such interests, has been approved by the Division.

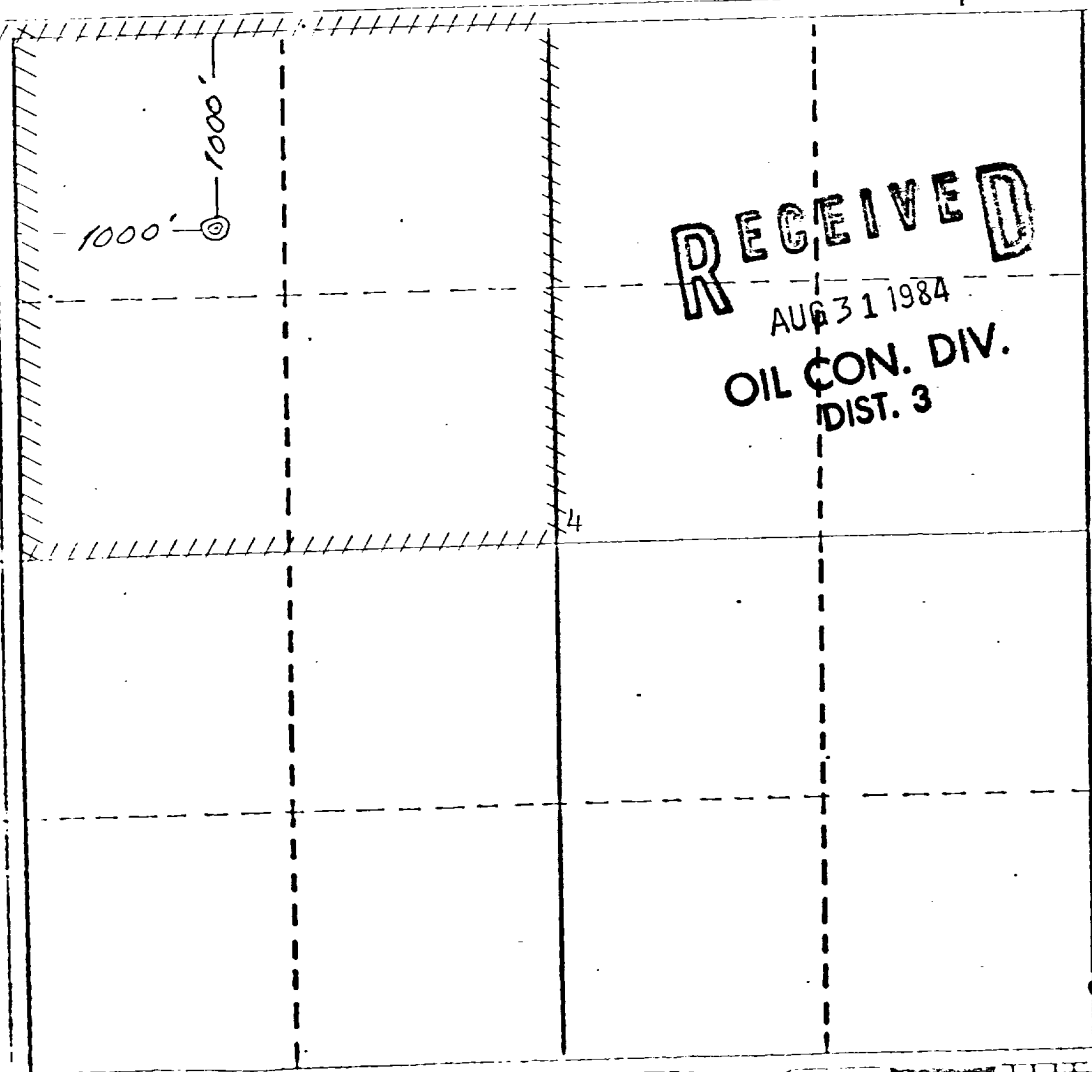

CERTIFICATION

I hereby certify that the information contained herein is true and complete to the best of my knowledge and belief.

*B. Rex*  
Name  
B. Rex  
Position  
Prod. & Drlg. Technician  
Company  
Consolidated Oil & Gas, Inc.  
Date  
5-1-84

I hereby certify that the information shown on this plat was plotted from field notes of a survey made by me or under my supervision and that the same is true to the best of my knowledge and belief.

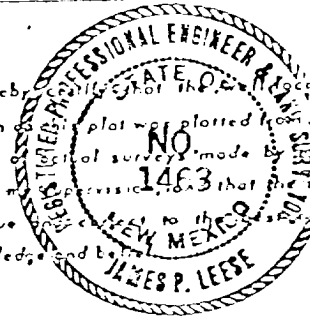

Date Surveyed  
February 28, 1980  
Registered Professional Engineer  
and/or Land Surveyor  
*James P. Leese*  
James P. Leese  
Certificate No.  
1463