

30-045 26224

Form C-101
Revised 1-1-65

NEW MEXICO OIL CONSERVATION COMMISSION

NO. OF COPIES RECEIVED	
DISTRIBUTION	
SANTA FE	
FILE	
U.S.G.S.	
LAND OFFICE	
OPERATOR	

5A. Indicate Type of Lease	
STATE <input type="checkbox"/>	FEE <input checked="" type="checkbox"/>
5. State Oil & Gas Lease No.	

APPLICATION FOR PERMIT TO DRILL, DEEPEN, OR PLUG BACK

1a. Type of Work		7. Unit Agreement Name	
b. Type of Well OIL WELL <input type="checkbox"/> GAS WELL <input checked="" type="checkbox"/> OTHER <input type="checkbox"/> DRILL <input checked="" type="checkbox"/> DEEPEN <input type="checkbox"/> PLUG BACK <input type="checkbox"/> SINGLE ZONE <input checked="" type="checkbox"/> MULTIPLE ZONE <input type="checkbox"/>		8. Farm or Lease Name Montgomery	
2. Name of Operator El Paso Natural Gas Company		9. Well No. 2	
3. Address of Operator PO Box 4289, Farmington, NM 87499		10. Field and Pool, or Wildcat Basin Dakota	
4. Location of Well UNIT LETTER A LOCATED 800 FEET FROM THE North LINE AND 1100 FEET FROM THE East LINE OF SEC. 17 TWP. 30N RGE. 11W NMPM		12. County San Juan	
19. Proposed Depth 6627'		19A. Formation Dakota	20. Rotary or C.T. Rotary
21. Elevations (Show whether DF, RT, etc.) 5586' GL	21A. Kind & Status Plug. Bond Statewide	21B. Drilling Contractor	22. Approx. Date Work will start

PROPOSED CASING AND CEMENT PROGRAM

SIZE OF HOLE	SIZE OF CASING	WEIGHT PER FOOT	SETTING DEPTH	SACKS OF CEMENT	EST. TOP
12 1/4"	9 5/8"	32.3#	300'	160 (188 cf)	surface
8 3/4"	7"	23.0#	3700'	740 (1111 cf)	surface
6 1/4"	4 1/2"	10.5#	3550-6627'	290 (536 cf)	3550'

Selectively perforate and sandwater fracture the Dakota formation.

A 3000 psi WP and 6000 psi test double gate preventer equipped with blind and pipe rams will be used for blow out prevention on this well.

This gas is dedicated.

The N/2 of Section 17 is dedicated to this well.

RECEIVED
FEB 14 1985
OIL CON. DIV.
DIST. 3

APPROVAL EXT. 8-14-85
UNLESS DRILLING COMMENCED.
SPUD NOTICE MUST BE SUBMITTED
WITHIN 10 DAYS.

IN ABOVE SPACE DESCRIBE PROPOSED PROGRAM: IF PROPOSAL IS TO DEEPEN OR PLUG BACK GIVE DATA ON PRESENT PRODUCTIVE ZONE AND PROPOSED NEW PRODUCTIVE ZONE. GIVE BLOWOUT PREVENTER PROGRAM, IF ANY.

I hereby certify that the information above is true and complete to the best of my knowledge and belief.

Signed Peggy Doak Title Drilling Clerk Date February 12, 1985

(This space for State Use)

APPROVED BY Frank J. Chay TITLE SUPERVISOR DISTRICT # 3 DATE FEB 14 1985

CONDITIONS OF APPROVAL, IF ANY:

NEW MEXICO OIL CONSERVATION COMMISSION
WELL LOCATION AND ACREAGE DEDICATION PLAT

Form C-102
Supersedes C-123
Effective 1-1-65

All distances must be from the outer boundaries of the Section.

Operator EL PASO NATURAL GAS COMPANY		Lease MONTGOMERY		(FEE)	Well No. 2
Unit Letter A	Section 17	Township 30-N	Range 11-W	County SAN JUAN	
Actual Footage Location of Well: 800 feet from the NORTH line and 1100 feet from the EAST line					
Ground Level Elev. 5586	Producing Formation DAKOTA		Pool BASIN	Dedicated Acreage: 320.00 Acres	

1. Outline the acreage dedicated to the subject well by colored pencil or hachure marks on the plat below.
2. If more than one lease is dedicated to the well, outline each and identify the ownership thereof (both as to working interest and royalty).
3. If more than one lease of different ownership is dedicated to the well, have the interests of all owners been consolidated by communitization, unitization, force-pooling, etc?

☐ Yes ☐ No If answer is "yes," type of consolidation _____

If answer is "no," list the owners and tract descriptions which have actually been consolidated. (Use reverse side of this form if necessary.) _____

No allowable will be assigned to the well until all interests have been consolidated (by communitization, unitization, forced-pooling, or otherwise) or until a non-standard unit, eliminating such interests, has been approved by the Commission.

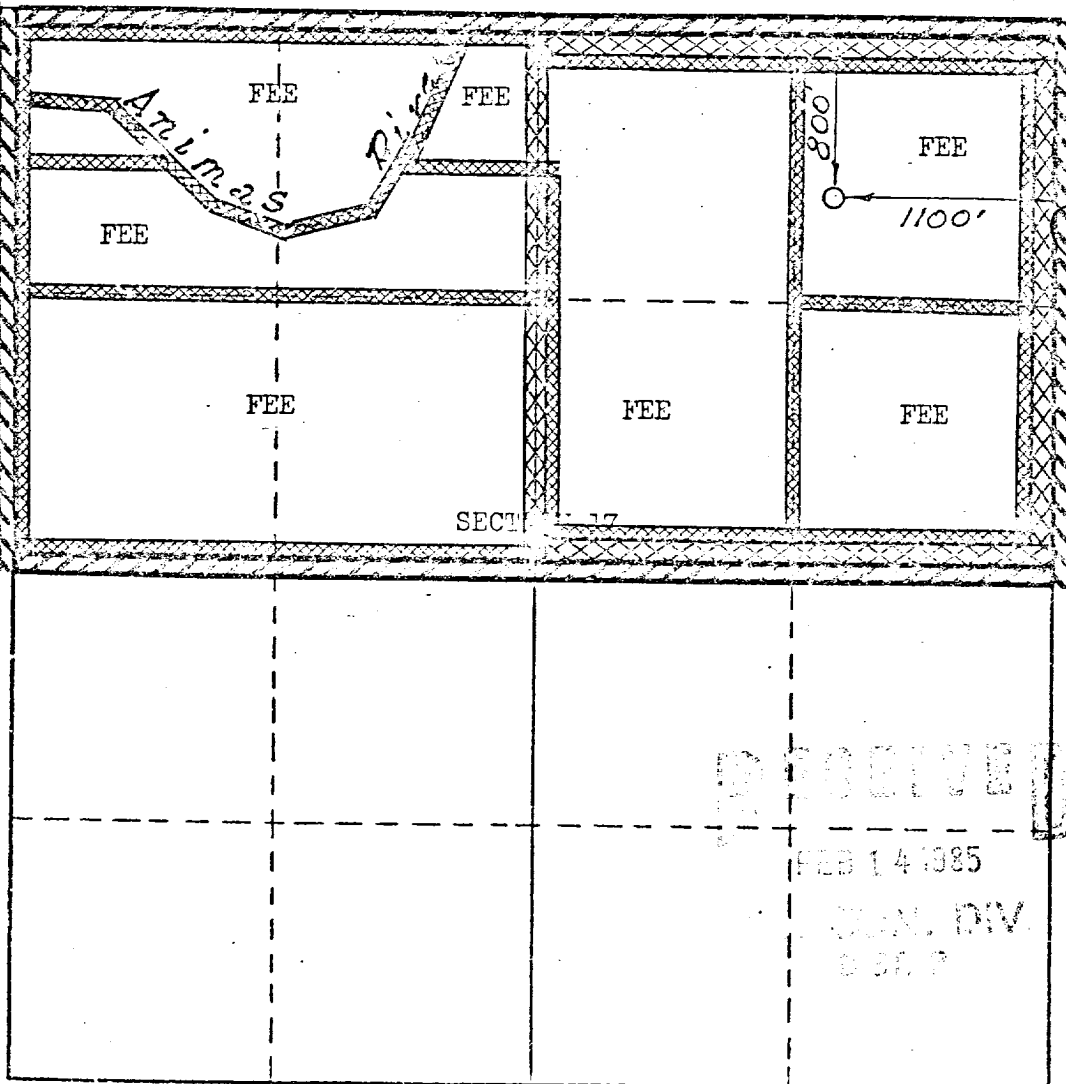

CERTIFICATION

I hereby certify that the information contained herein is true and complete to the best of my knowledge and belief.

Peggy Doal
Name
Drilling Clerk
Position
El Paso Natural Gas Co
Company
February 14, 1985
Date

I hereby certify that the well location shown on this plat was plotted from field notes of actual surveys made by me or under my supervision, and that the same is true and correct to the best of my knowledge and belief.

David Wilson
Date Surveyed
AUGUST 22, 1978
Registered Professional Engineer
and/or Land Surveyor
Certificate No. 1760

RECEIVED

FEB 14 1985

GEN. DIV.
D. B. P.

