

UNITED STATES  
DEPARTMENT OF THE INTERIOR  
GEOLOGICAL SURVEY

APPLICATION FOR PERMIT TO DRILL, DEEPEN, OR PLUG BACK

1a. TYPE OF WORK

DRILL ☒

DEEPEN ☐

PLUG BACK ☐

b. TYPE OF WELL

OIL  
WELL ☐

GAS  
WELL ☒

OTHER

SINGLE  
ZONE ☒

MULTIPLE  
ZONE ☐

2. NAME OF OPERATOR

Union Texas Petroleum Corporation

3. ADDRESS OF OPERATOR

P.O. Box 1290, Farmington, NM 87499

4. LOCATION OF WELL (Report location clearly and in accordance with any State requirements.)

At surface

1093' FSL; 1748' FEL

At proposed prod. zone Same as above

BUREAU OF LAND MANAGEMENT

14. DISTANCE IN MILES AND DIRECTION FROM NEAREST TOWN OR POST OFFICE\*

1/2 Mile North of Farmington, New Mexico

15. DISTANCE FROM PROPOSED\*

LOCATION TO NEAREST  
PROPERTY OR LEASE LINE, FT.  
(Also to nearest drig. unit line, if any)

1093'

892'

18. DISTANCE FROM PROPOSED LOCATION\*  
TO NEAREST WELL, DRILLING, COMPLETED,  
OR APPLIED FOR, ON THIS LEASE, FT.

2592'

16. NO. OF ACRES IN LEASE

2440.0

19. PROPOSED DEPTH

6230'

17. NO. OF ACRES ASSIGNED  
TO THIS WELL

S/2 320.00

20. ROTARY OR CABLE TOOLS

Rotary

21. ELEVATIONS (Show whether DF, RT, GR, etc.)

5477 GR (ungraded)

DRILLING OPERATIONS AUTHORIZED ARE

SUBJECT TO COMPLIANCE WITH ATTACHED

"GENERAL REQUIREMENTS" CEMENTING PROGRAM

22. APPROX. DATE WORK WILL START\*

March 30, 1985

23.

This action is subject to administrative  
appeal pursuant to 30 CFR 290.

SIZE OF HOLE	SIZE OF CASING	WEIGHT PER FOOT	SETTING DEPTH	QUANTITY OF CEMENT
12-1/4"	New 8-5/8" K55	24.0#	(±) 200'	165cu.ft. CL "B" 2% CaCl <sub>2</sub> circ.
7-7/8"	New 4-1/2" K55	10.5#	(±) 6230'	2 stage circulated (see below)

We desire to drill this well to the above described program. After cementing surface pipe and waiting on cement, pressure test the surface pipe then drill to T.D. using mud as the circulating medium. After logging run 4-1/2" casing to T.D. with a D.V. tool at approx. 1700 feet. Cement the first stage with 1235 cu.ft., 50-50 Poz with 2% gel, 0.6% FLA, 9800# of salt and 245# of flocele to circulate to the D.V. tool. Cement the second stage with 244 cu.ft. of 65-35 Poz with 12% gel, 1470# of flocele to circulate to the D.V. tool. Cement 2nd stage with 244 cu.ft. of 65-35 Poz with 12% gel, 1470# of gilsonite and 30# of flocele tailed in with 118 cu.ft. of CL "B" with 2% CaCl<sub>2</sub> and 25# of flocele to circulate to the surface, wait on cement, then drill out the D.V. tool and pressure test the casing. Perforate and fracture the Dakota zone. Clean the well up and run 2-3/8", J55 tubing to the Dakota zone and nipple down the well head. Test the well and connect to a gathering system.

IN ABOVE SPACE DESCRIBE PROPOSED PROGRAM: If proposal is to deepen or plug back, give data on present productive zone and proposed new productive zone. If proposal is to drill or deepen directionally, give pertinent data on subsurface locations and measured and true vertical depths. Give blowout preventer program, if any.

24.

SIGNED

RUDY D. MOLLO

TITLE Area Operations Manager

(This space for Federal or State office use)

PERMIT NO.

APPROVED BY

CONDITIONS OF APPROVAL, IF ANY:

RECEIVED

MAR 22 1985

OIL CON. DIV.  
DIST. 3

APPROVED, 1985

AS AMENDED

MAR 20 1985

DATE  
AREA MANAGER  
FARMINGTON RESOURCE AREA

All distances must be from the outer boundaries of the Section.

Operator UNION TEXAS PETROLEUM CORPORATION			Lease MCCORD		Well No. 12-E
Unit Letter 0	Section 33	Township 30 NORTH	Range 13 WEST	County SAN JUAN	
Actual Footage Location of Well: 1093 feet from the SOUTH line and 1748 feet from the EAST line					
Ground Level Elev. 5477	Producing Formation DAKOTA		Pool BASIN		Dedicated Acreage: S/2 320.00 Acres

1. Outline the acreage dedicated to the subject well by colored pencil or hachure marks on the plat below.
2. If more than one lease is dedicated to the well, outline each and identify the ownership thereof (both as to working interest and royalty).
3. If more than one lease of different ownership is dedicated to the well, have the interests of all owners been consolidated by communitization, unitization, force-pooling, etc?

☒ Yes ☐ No If answer is "yes," type of consolidation Communitized SW 143

If answer is "no," list the owners and tract descriptions which have actually been consolidated. (Use reverse side of this form if necessary.)

No allowable will be assigned to the well until all interests have been consolidated (by communitization, unitization, forced-pooling, or otherwise) or until a non-standard unit, eliminating such interests, has been approved by the Division

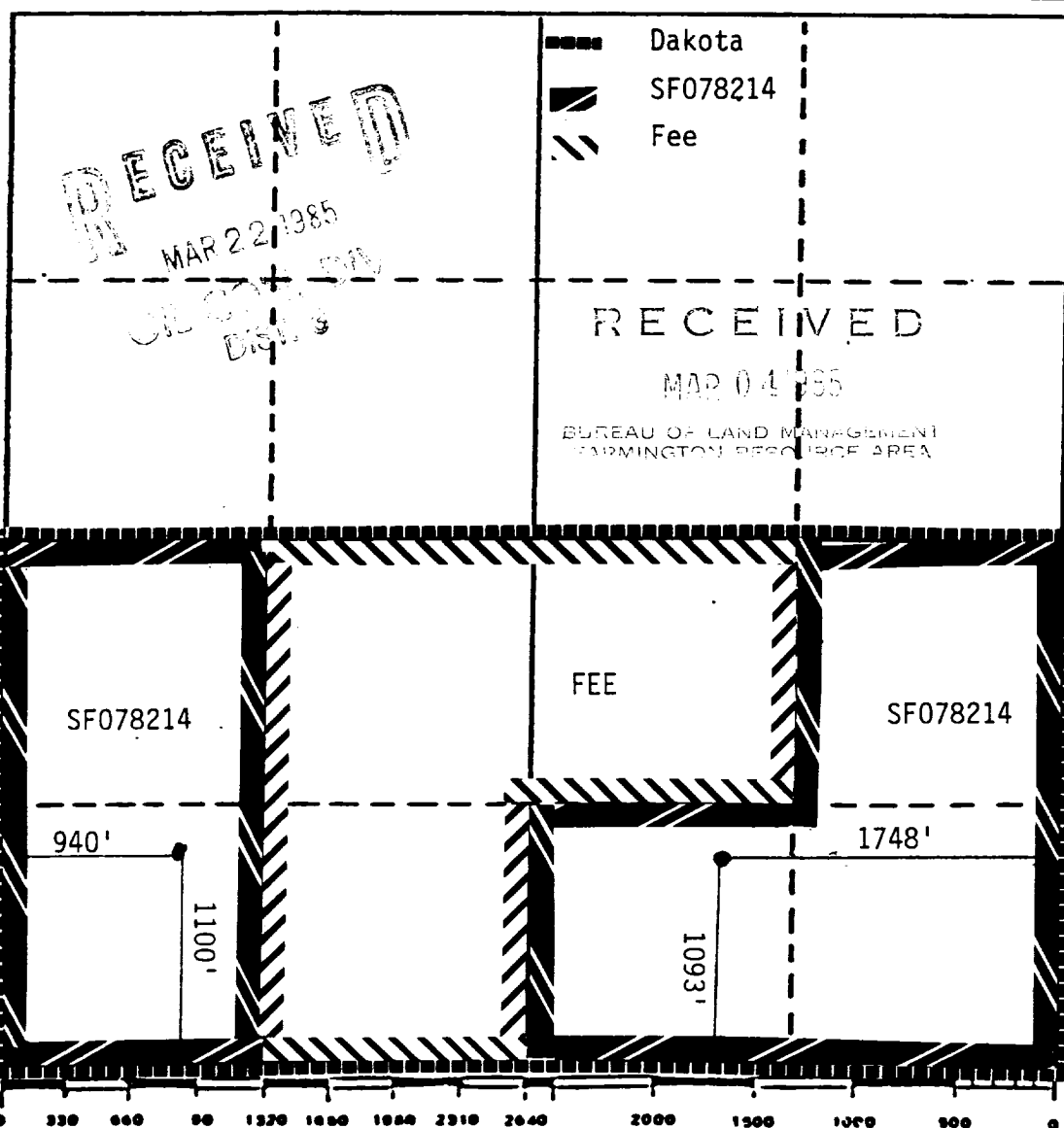

## CERTIFICATION

I hereby certify that the information contained herein is true and complete to the best of my knowledge and belief.

*Rudy D. Motto*

Name

Rudy D. Motto

Position

Area Operations Manager

Company

Union Texas Petroleum Corp

Date

February 28, 1985

I hereby certify that the well location shown on this map was plotted from field notes of Michael Daly made by me or under my supervision, and that the same is true and correct to the best of my knowledge and belief.

Date Surveyed

March 27, 1984

Registered Professional Engineer  
and/or Land Surveyor

Michael Daly

Certificate No.  
5992

LEASE: 01-07-22-1  
USGS TOPO MAP

MC CORD # 12E

1093' FSK & 1748' FEL

SEC. 33, T30N, R13W

SAN JUAN COUNTY, N.M.

