

NO. OF COPIES RECEIVED	
DISTRIBUTION	
SANTA FE	/
FILE	/
U.S.G.S. <i>Perm</i>	/
LAND OFFICE	/
OPERATOR	/

NEW MEXICO OIL CONSERVATION COMMISSION

Form C-101
Revised 1-1-65

5A. Indicate Type of Lease	
STATE <input checked="" type="checkbox"/>	FEE <input type="checkbox"/>
5. State Oil & Gas Lease No. E-1641-3	

API 30-045-21978

APPLICATION FOR PERMIT TO DRILL, DEEPEN, OR PLUG BACK

1a. Type of Work		7. Unit Agreement Name	
b. Type of Well OIL WELL <input type="checkbox"/> GAS WELL <input checked="" type="checkbox"/> OTHER <input type="checkbox"/>		8. Farm or Lease Name EPNG Com	
2. Name of Operator El Paso Natural Gas Company		9. Well No. 1A	
3. Address of Operator PO Box 990, Farmington, NM 87401		10. Field and Pool, or Wildcat Blanco Mesa Verde <input checked="" type="checkbox"/>	
4. Location of Well UNIT LETTER J LOCATED 1650 FEET FROM THE South LINE AND 500 FEET FROM THE East LINE OF SEC. 32 TWP. 30N RGE. 8W NMPM		12. County San Juan	
19. Proposed Depth 5445'		19A. Formation Mesa Verde	
20. Rotary or C.T. Rotary		21. Elevations (Show whether DF, RT, etc.) 6205' GR	
21A. Kind & Status Plug. Bond statewide		22. Approx. Date Work will start	

PROPOSED CASING AND CEMENT PROGRAM

SIZE OF HOLE	SIZE OF CASING	WEIGHT PER FOOT	SETTING DEPTH	SACKS OF CEMENT	EST. TOP
13 3/8"	9 5/8"	32.3#	200'	224 cu.ft.	surface
8 3/4"	7"	20.0#	3190'	313 cu.ft.	cover Ojo Alamo
6 1/4"	4 1/2"	10.5#	3040-5445'	420 cu.ft.	to fill to 3040'

Selectively perforate and sandwater fracture the Mesa Verde formation.

A 3000 psi WP and 6000 psi test double gate preventer equipped with blind and pipe rams will be used for blow out prevention on this well.

The E/2 of Section 32 is dedicated to this well.

APPROVED FOR
FOR 10
DILL

EXPIRES *April 25*



IN ABOVE SPACE DESCRIBE PROPOSED PROGRAM: IF PROPOSAL IS TO DEEPEN OR PLUG BACK, GIVE DATA ON PRESENT PRODUCTIVE ZONE AND PROPOSED NEW PRODUCTIVE ZONE. GIVE BLOWOUT PREVENTER PROGRAM, IF ANY.

I hereby certify that the information above is true and complete to the best of my knowledge and belief.

Signed *N. G. Buices* Title *Drilling Clerk* Date *January 21, 1976*

(This space for State Use)

APPROVED BY *AK Kendrick* TITLE *SUPERVISOR DIST. #3* DATE *JAN 26 1976*

CONDITIONS OF APPROVAL, IF ANY:

**NEW MEXICO OIL CONSERVATION COMMISSION
WELL LOCATION AND ACREAGE DEDICATION PLAT**

Form C-102
Supersedes C-128
Effective 1-1-65

All distances must be from the outer boundaries of the Section.

Operator EL PASO NATURAL GAS COMPANY			Lease EPNG COM. (E-1641-3)		Well No. 1A
Unit Letter J	Section 32	Township 30-N	Range 8-W	County SAN JUAN	
Actual Footage Location of Well: <div style="display: flex; justify-content: space-between;"> 1650 feet from the SOUTH line and 1500 feet from the EAST line </div>					
Ground Level Elev. 6205	Producing Formation MESA VERDE		Pool BLANCO MESA VERDE	Dedicated Acreage: 4 320.00 Acres	

1. Outline the acreage dedicated to the subject well by colored pencil or hachure marks on the plat below.
2. If more than one lease is dedicated to the well, outline each and identify the ownership thereof (both as to working interest and royalty).
3. If more than one lease of different ownership is dedicated to the well, have the interests of all owners been consolidated by communitization, unitization, force-pooling, etc?

☒ Yes ☐ No If answer is "yes," type of consolidation Communitization

If answer is "no," list the owners and tract descriptions which have actually been consolidated. (Use reverse side of this form if necessary.) _____

No allowable will be assigned to the well until all interests have been consolidated (by communitization, unitization, forced-pooling, or otherwise) or until a non-standard unit, eliminating such interests, has been approved by the Commission.

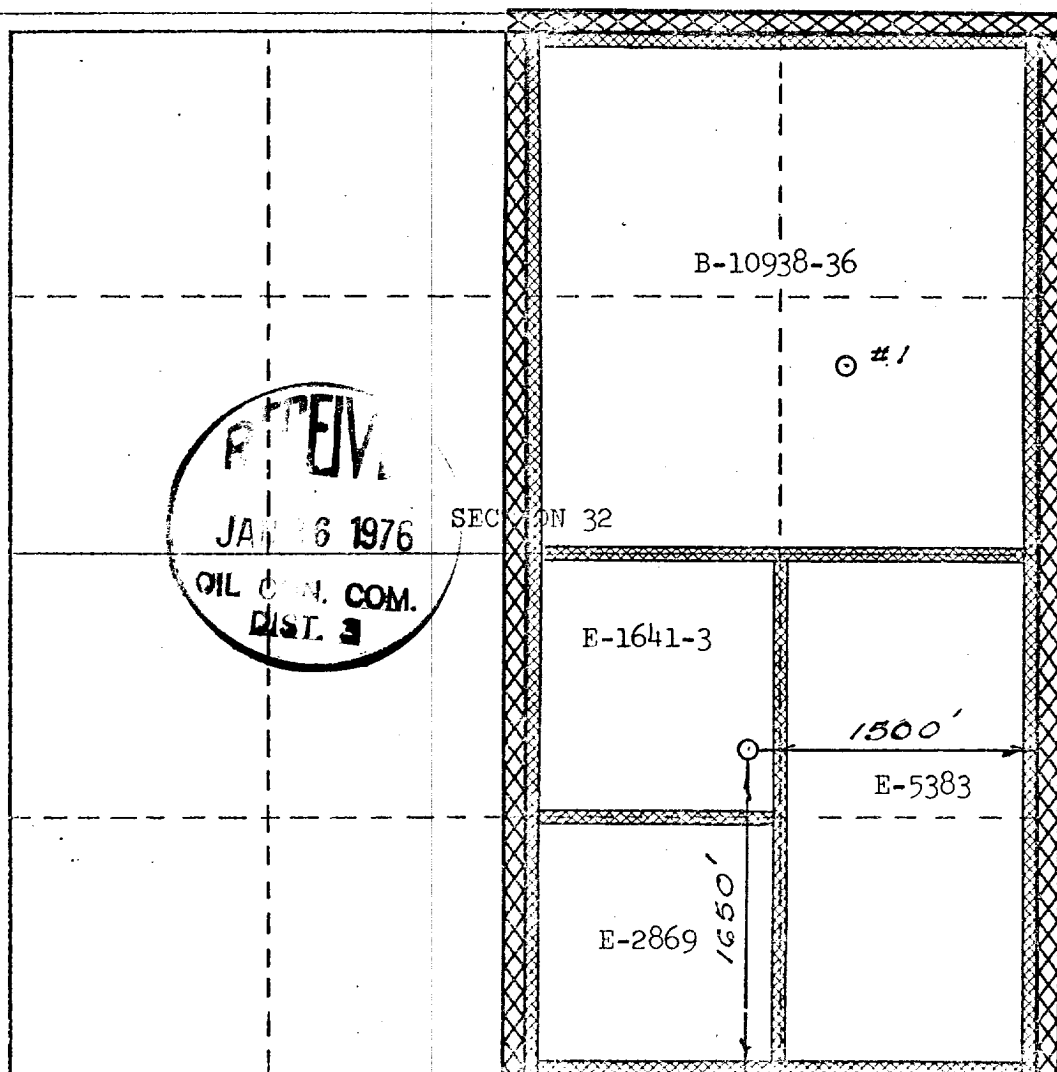

CERTIFICATION

I hereby certify that the information contained herein is true and complete to the best of my knowledge and belief.

N. Y. Guice
Name

Drilling Clerk
Position

El Paso Natural Gas Co.
Company

January 23, 1976
Date

I hereby certify that the well location shown on this plat was plotted from field notes of actual surveys made by me or under my supervision, and that the same is true and correct to the best of my knowledge and belief.

Date Surveyed
DECEMBER 1, 1975

Registered Professional Engineer
and/or Land Surveyor

David C. Kuen
Certificate No. **1760**

0 330 660 990 1320 1650 1980 2310 2640 2970 3300 3630 3960 4290 4620 4950 5280 5610 5940 6270 6600

NO. OF COPIES RECEIVED	5
DISTRIBUTION	
SANTA FE	1
FILE	1 ✓
U.S.G.S.	
LAND OFFICE	
OPERATOR	3

NEW MEXICO OIL CONSERVATION COMMISSION

Form C-103
Supersedes Old
C-102 and C-103
Effective 1-1-65

5a. Indicate Type of Lease	
State <input checked="" type="checkbox"/>	Fee <input type="checkbox"/>
5. State Oil & Gas Lease No.	
E-1641-3	

SUNDRY NOTICES AND REPORTS ON WELLS

(DO NOT USE THIS FORM FOR PROPOSALS TO DRILL OR TO DEEPEN OR PLUG BACK TO A DIFFERENT RESERVOIR. USE "APPLICATION FOR PERMIT -" (FORM C-101) FOR SUCH PROPOSALS.)

1. OIL WELL <input type="checkbox"/> GAS WELL <input checked="" type="checkbox"/> OTHER <input type="checkbox"/>		7. Unit Agreement Name
2. Name of Operator El Paso Natural Gas Company		8. Farm or Lease Name EPNG Com
3. Address of Operator PO Box 990, Farmington, NM 87401		9. Well No. 1A
4. Location of Well UNIT LETTER J, 1650 FEET FROM THE South LINE AND 1500 FEET FROM THE East LINE, SECTION 32 TOWNSHIP 30N RANGE 8W NMPM.		10. Field and Pool, or Wildcat Blanco Mesa Verde
15. Elevation (Show whether DF, RT, GR, etc.) 6205' ASL		12. County San Juan

Check Appropriate Box To Indicate Nature of Notice, Report or Other Data

NOTICE OF INTENTION TO:

PERFORM REMEDIAL WORK ☐
TEMPORARILY ABANDON ☐
PULL OR ALTER CASING ☐

PLUG AND ABANDON ☐
CHANGE PLANS ☐

OTHER Permit to Drill Extension ☒

SUBSEQUENT REPORT OF:

REMEDIAL WORK ☐
COMMENCE DRILLING OPNS. ☐
CASING TEST AND CEMENT JOBS ☐

ALTERING CASING ☐
PLUG AND ABANDONMENT ☐

OTHER ☐

17. Describe Proposed or Completed Operations (Clearly state all pertinent details, and give pertinent dates, including estimated date of starting any proposed work) SEE RULE 1703.

It is anticipated that the "Permit to Drill" will expire before this well can be spudded. Therefore, an extension is requested.

APPROVAL
FOR 90 DAYS UNLESS
DRILLING COMMENCES

EXPIRES July 26, 1976



18. I hereby certify that the information above is true and complete to the best of my knowledge and belief.

SIGNED A. G. Lewis TITLE Drilling Clerk DATE April 26, 1976

APPROVED BY _____ TITLE _____ DATE _____

CONDITIONS OF APPROVAL, IF ANY:

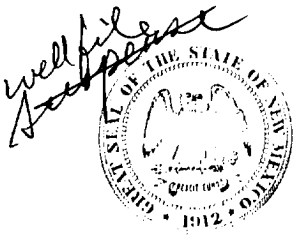

DIRECTOR
JOE D. RAMEY

OIL CONSERVATION COMMISSION

STATE OF NEW MEXICO
1000 RIO BRAZOS RD. - AZTEC

87410
LAND COMMISSIONER
PHIL R. LUCERO



STATE GEOLOGIST
EMERY C. ARNOLD

July 28, 1976

El Paso Natural Gas Co.

P. O. Box 990

Farmington, New Mexico

Re: El Paso Natural Gas Co.

EPNG Com #1 A

J-32-30N-8W

Gentlemen:

of extension

Ninety days have elapsed since approval of Commission Form C-101, Notice of Intention to Drill, for the subject well and to date no progress reports, Forms C-103, have been received. Therefore, Commission approval of Form C-101 has now expired and no drilling operations are to be initiated or continued without further notice to and approval by the Commission. Pending such approval this will be considered an abandoned location.

Yours very truly,

A. R. Kendrick
Supervisor, District 3

xc: OCC, Santa Fe



DIRECTOR
JOE D. RAMEY

OIL CONSERVATION COMMISSION

STATE OF NEW MEXICO
1000 RIO BRAZOS RD. - AZTEC

87410
LAND COMMISSIONER
PHIL R. LUCERO



STATE GEOLOGIST
EMERY C. ARNOLD

July 28, 1976

El Paso Natural Gas Co.

P. O. Box 990

Farmington, New Mexico

Aband. Loc.

Re: El Paso Natural Gas Co.

EPNG Com #1 A

J-32-30N-8W

Gentlemen:

of extension

Ninety days have elapsed since approval of Commission Form C-101, Notice of Intention to Drill, for the subject well and to date no progress reports, Forms C-103, have been received. Therefore, Commission approval of Form C-101 has now expired and no drilling operations are to be initiated or continued without further notice to and approval by the Commission. Pending such approval this will be considered an abandoned location.

Yours very truly,

A. R. Kendrick
Supervisor, District 3

xc: OCC, Santa Fe

NO. OF COPIES RECEIVED	6
DISTRIBUTION	
SANTA FE	1
FILE	1
U.S.G.S.	2
LAND OFFICE	1
OPERATOR	1

NEW MEXICO OIL CONSERVATION COMMISSION

30-045-22441
Form C-101
Revised 1-1-65

5A. Indicate Type of Lease	
STATE <input checked="" type="checkbox"/>	FEE <input type="checkbox"/>
5. State Oil & Gas Lease No. E-1641-3	

APPLICATION FOR PERMIT TO DRILL, DEEPEN, OR PLUG BACK

1a. Type of Work		7. Unit Agreement Name	
b. Type of Well DRILL <input checked="" type="checkbox"/> DEEPEN <input type="checkbox"/> PLUG BACK <input type="checkbox"/>		8. Farm or Lease Name EPNG Com	
2. Name of Operator El Paso Natural Gas Company		9. Well No. 1A	
3. Address of Operator PO Box 990, Farmington, NM 87401		10. Field and Pool, or Wildcat Blanco Mesa Verde	
4. Location of Well UNIT LETTER _____ LOCATED 1650 FEET FROM THE South LINE AND 1500 FEET FROM THE East LINE OF SEC. 32 TWP. 30N RGE. 8W NMPM		12. County San Juan	
19. Proposed Depth 5445'		19A. Formation Mesa Verde	
20. Rotary or C.T. Rotary		21. Elevations (Show whether DF, RT, etc.) 6205' GR	
21A. Kind & Status Plug. Bond statewide		21B. Drilling Contractor	
22. Approx. Date Work will start			

23.

PROPOSED CASING AND CEMENT PROGRAM

SIZE OF HOLE	SIZE OF CASING	WEIGHT PER FOOT	SETTING DEPTH	SACKS OF CEMENT	EST. TOP
13 3/4"	9 5/8"	32.3#	200'	224 cu.ft.	surface
8 3/4"	7"	20.0#	190'	313 cu.ft.	Ojo Alamo
6 1/4"	4 1/2"	10.5#	3040-5445'	420 cu.ft.	3040'

Selectively perforate and sandwater fracture the Mesa Verde formation.

A 3000 psi WP and 600 psi test double gate preventer equipped with blind and pipe rams will be used for blow out prevention on this well.

APPROVAL VALID
FOR 90 DAYS UNLESS
DRILLING COMMENCED.

This gas is dedicated.

EXPIRES 5-29-78

The E/2 of Section 32 is dedicated to this well.



IN ABOVE SPACE DESCRIBE PROPOSED PROGRAM: IF PROPOSAL IS TO DEEPEN OR PLUG BACK, GIVE DATA ON PRESENT PRODUCTIVE ZONE AND PROPOSED NEW PRODUCTIVE ZONE. GIVE BLOWOUT PREVENTER PROGRAM, IF ANY.

I hereby certify that the information above is true and complete to the best of my knowledge and belief.

Signed N. G. Busco Title Drilling Clerk Date February 27, 1978

(This space for State Use)

APPROVED BY [Signature] TITLE SUPERVISOR DIST. 33 DATE FEB 28 1978
CONDITIONS OF APPROVAL, IF ANY:

NEW MEXICO OIL CONSERVATION COMMISSION
WELL LOCATION AND ACREAGE DEDICATION PLAT

Form C-152
Supersedes C-123
Effective 1-1-65

All distances must be from the outer boundaries of the Section.

Operator EL PASO NATURAL GAS COMPANY		Lease EPNG COM. (E-1641-3)		Well No. 1A
Unit Letter J	Section 32	Township 30-N	Range 8-W	County SAN JUAN
Actual Footage Location of Well: 1650 feet from the SOUTH line and 1500 feet from the EAST line				
Ground Level Elev. 6205	Producing Formation MESA VERDE	Pool BLANCO MESA VERDE ✓	Dedicated Acreage: 320.00 ✓ Acres	

1. Outline the acreage dedicated to the subject well by colored pencil or hatchure marks on the plat below.
2. If more than one lease is dedicated to the well, outline each and identify the ownership thereof (both as to working interest and royalty).
3. If more than one lease of different ownership is dedicated to the well, have the interests of all owners been consolidated by communitization, unitization, force-pooling, etc?

☒ Yes ☐ No If answer is "yes," type of consolidation Communitization

If answer is "no," list the owners and tract descriptions which have actually been consolidated. (Use reverse side of this form if necessary.)

No allowable will be assigned to the well until all interests have been consolidated (by communitization, unitization, forced-pooling, or otherwise) or until a non-standard unit, eliminating such interests, has been approved by the Commission.

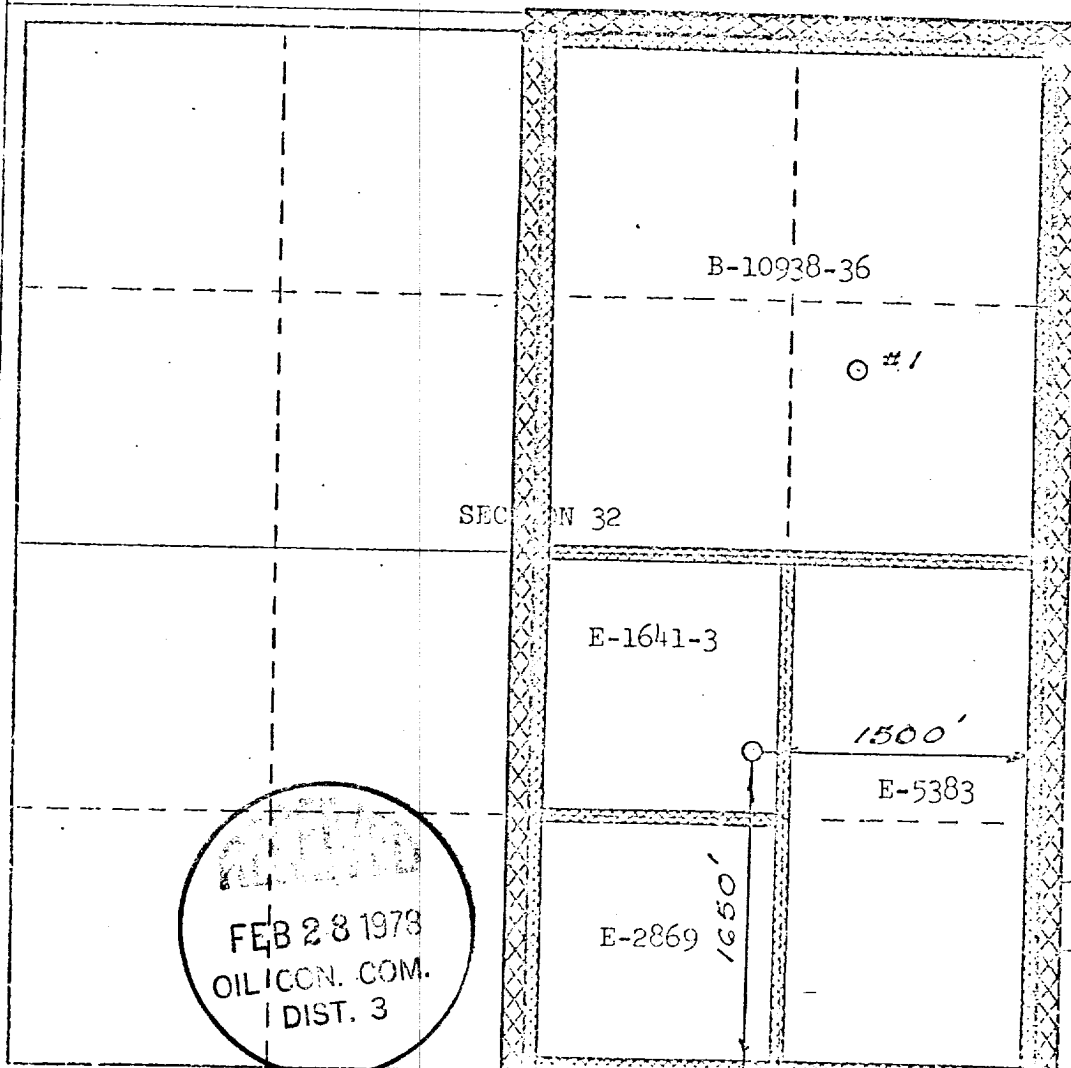

CERTIFICATION

I hereby certify that the information contained herein is true and complete to the best of my knowledge and belief.

H. G. Guiso

Drilling Clerk

El Paso Natural Gas Co.

Company

February 27, 1978

Date

I hereby certify that the well location shown on this plat was plotted from field notes of actual surveys made by me or under my supervision, and that the same is true and correct to the best of my knowledge and belief.

Date Surveyed

DECEMBER 1, 1975

Registered Professional Engineer and/or Land Surveyor

[Signature]

Certificate No. 1760

0 330 660 990 1320 1650 1980 2310 2640 2970 3300 3630 3960 4290 4620 4950 5280 5610 5940 6270 6600

NO. OF COPIES RECEIVED	3
DISTRIBUTION	
SANTA FE	1
FILE	1
U.S.G.S.	
LAND OFFICE	
OPERATOR	1

NEW MEXICO OIL CONSERVATION COMMISSION

Form C-103
Supersedes Old
C-102 and C-103
Effective 1-1-65

5a. Indicate Type of Lease	
State <input checked="" type="checkbox"/>	Fee <input type="checkbox"/>
5. State Oil & Gas Lease No. E-1641-3	

SUNDRY NOTICES AND REPORTS ON WELLS (DO NOT USE THIS FORM FOR PROPOSALS TO DRILL OR TO DEEPEN OR PLUG BACK TO A DIFFERENT RESERVOIR. USE "APPLICATION FOR PERMIT -" (FORM C-101) FOR SUCH PROPOSALS.)

1. <input type="checkbox"/> OIL WELL <input checked="" type="checkbox"/> GAS WELL <input type="checkbox"/> OTHER		7. Unit Agreement Name
2. Name of Operator El Paso Natural Gas Company		8. Farm or Lease Name EPNG Com
3. Address of Operator PO Box 990, Farmington, NM 87401		9. Well No. 1A
4. Location of Well UNIT LETTER J, 1650 FEET FROM THE South LINE AND 1500 FEET FROM East 32. 30N 8W THE LINE, SECTION TOWNSHIP RANGE NMPM.		10. Field and Pool, or Wildcat Blanco Mesa Verde
15. Elevation (Show whether DF, RT, GR, etc.) 6205' GL		12. County San Juan

16. Check Appropriate Box To Indicate Nature of Notice, Report or Other Data NOTICE OF INTENTION TO: SUBSEQUENT REPORT OF:

PERFORM REMEDIAL WORK <input type="checkbox"/>	PLUG AND ABANDON <input type="checkbox"/>	REMEDIAL WORK <input type="checkbox"/>	ALTERING CASING <input type="checkbox"/>
TEMPORARILY ABANDON <input type="checkbox"/>	CHANGE PLANS <input type="checkbox"/>	COMMENCE DRILLING CPNS. <input type="checkbox"/>	PLUG AND ABANDONMENT <input type="checkbox"/>
PULL OR ALTER CASING <input type="checkbox"/>	OTHER <input checked="" type="checkbox"/> Permit to Drill Extension	CASING TEST AND CEMENT JOBS <input type="checkbox"/>	

17. Describe Proposed or Completed Operations (Clearly state all pertinent details, and give pertinent dates, including estimated date of starting any proposed work) SEE RULE 1103.

It is anticipated that the "Permit to Drill" will expire before this well can be spudded; therefore, an extension is requested.

APPROVAL VALID
FOR 90 DAYS UNLESS
DRILLING COMMENCED,

EXPIRES 8-27-78



18. I hereby certify that the information above is true and complete to the best of my knowledge and belief.

SIGNED A. R. Kendrick TITLE Drilling Clerk DATE May 30, 1978

APPROVED BY Original Signed by A. R. Kendrick TITLE SUPERVISOR DIST. 3 DATE MAY 31 1978

CONDITIONS OF APPROVAL, IF ANY:

NO. OF COPIES RECEIVED	3
DISTRIBUTION	
SANTA FE	1
FILE	1
U.S.G.S.	
LAND OFFICE	
OPERATOR	1

NEW MEXICO OIL CONSERVATION COMMISSION

Form C-103
Supersedes Old
C-102 and C-103
Effective 1-1-65

5a. Indicate Type of Lease	
State <input checked="" type="checkbox"/>	Fee <input type="checkbox"/>
5. State Oil & Gas Lease No.	
E-1641-3	

SUNDRY NOTICES AND REPORTS ON WELLS

DO NOT USE THIS FORM FOR PROPOSALS TO DRILL OR TO DEEPEN OR PLUG BACK TO A DIFFERENT RESERVOIR.
(SEE APPLICATION FOR PERMIT LAW (FORM C-101) FOR SUCH PROPOSALS.)

1. OIL WELL <input type="checkbox"/> GAS WELL <input checked="" type="checkbox"/> OTHER <input type="checkbox"/>		7. Unit Agreement Name
2. Name of Operator		8. Farm or Lease Name
El Paso Natural Gas Company		EPNG Com
3. Address of Operator		9. Well No.
Box 990, Farmington, New Mexico 87401		1A
4. Location of Well		10. Field and Pool, or Wildcat
UNIT LETTER J, 1650 FEET FROM THE South LINE AND 1500 FEET FROM THE East LINE, SECTION 32 TOWNSHIP 30N RANGE 8W NMPM.		Blanco Mesa Verde
15. Elevation (Show whether DF, RT, GR, etc.)		12. County
6205' GL		San Juan

16. Check Appropriate Box To Indicate Nature of Notice, Report or Other Data
NOTICE OF INTENTION TO: SUBSEQUENT REPORT OF:

PERFORM REMEDIAL WORK <input type="checkbox"/>	PLUG AND ABANDON <input type="checkbox"/>	REMEDIAL WORK <input type="checkbox"/>	ALTERING CASING <input type="checkbox"/>
TEMPORARILY ABANDON <input type="checkbox"/>	CHANGE PLANS <input type="checkbox"/>	COMMENCE DRILLING OPNS. <input type="checkbox"/>	PLUG AND ABANDONMENT <input type="checkbox"/>
PULL OR ALTER CASING <input type="checkbox"/>	OTHER PERMIT TO DRILL EXTENSION <input checked="" type="checkbox"/>	CASING TEST AND CEMENT JOB <input type="checkbox"/>	OTHER <input type="checkbox"/>

17. Describe Proposed or Completed Operations (Clearly state all pertinent details, and give pertinent dates, including estimated date of starting any proposed work) SEE RULE 1133.

IT IS ANTICIPATED THAT THE "PERMIT TO DRILL" WILL EXPIRE BEFORE THIS WELL CAN BE SPUDDED; THEREFORE, AN EXTENSION IS REQUESTED.

EXPIRES 11-25-78



18. I hereby certify that the information above is true and complete to the best of my knowledge and belief.

SIGNED <u>A. G. Davis</u>	TITLE <u>Drilling Clerk</u>	DATE <u>8-18-78</u>
Original Signed by <u>A. R. Kendrick</u>	TITLE <u>SUPERVISOR</u>	DATE <u>8-18-78</u>
APPROVED BY	TITLE	DATE
CONDITIONS OF APPROVAL, IF ANY:		

NO. OF COPIES RECEIVED	3
DISTRIBUTION	
SANTA FE	
FILE	1
U.S.G.S.	
LAND OFFICE	
OPERATOR	1

NEW MEXICO OIL CONSERVATION COMMISSION

Form C-103
Supersedes Old
C-102 and C-103
Effective 1-1-65

5a. Indicate Type of Lease	
State <input checked="" type="checkbox"/>	Fee <input type="checkbox"/>
5. State Oil & Gas Lease No.	

SUNDRY NOTICES AND REPORTS ON WELLS

DO NOT USE THIS FORM FOR PROPOSALS TO DRILL OR TO DEEPEN OR PLUG BACK TO A DIFFERENT RESERVOIR.
SEE APPLICATION FOR PERMIT TO DRILL (FORM C-101) FOR SUCH PROPOSALS.

1. OIL WELL <input type="checkbox"/> GAS WELL <input checked="" type="checkbox"/> OTHER <input type="checkbox"/>		7. Unit Agreement Name
2. Name of Operator El Paso Natural Gas Company		8. Farm or Lease Name EPNG Com
3. Address of Operator Box 289, Farmington, New Mexico 87401		9. Well No. 1A
4. Location of Well UNIT LETTER J 1650 FEET FROM THE South LINE AND 1500 FEET FROM THE East LINE, SECTION 32 TOWNSHIP 30N RANGE 8W NMPM.		10. Field and Pool, or Wildcat Blanco Mesa Verde
11. Elevation (Show whether DF, RT, GR, etc.) 6205' GL		12. County San Juan

16. Check Appropriate Box To Indicate Nature of Notice, Report or Other Data
NOTICE OF INTENTION TO: SUBSEQUENT REPORT OF:

PERFORM REMEDIAL WORK <input type="checkbox"/>	PLUG AND ABANDON <input type="checkbox"/>	REMEDIAL WORK <input type="checkbox"/>	ALTERING CASING <input type="checkbox"/>
TEMPORARILY ABANDON <input type="checkbox"/>	CHANGE PLANS <input type="checkbox"/>	COMMENCE DRILLING OPNS. <input type="checkbox"/>	PLUG AND ABANDONMENT <input type="checkbox"/>
PULL OR ALTER CASING <input type="checkbox"/>	OTHER <input checked="" type="checkbox"/> PERMIT TO DRILL EXTENSION	CASING TEST AND CEMENT JOBS <input type="checkbox"/>	

17. Describe Proposed or Completed Operations (Clearly state all pertinent details, and give pertinent dates, including estimated date of starting any proposed work) SEE RULE 1103.

IT IS ANTICIPATED THAT THE "PERMIT TO DRILL" WILL EXPIRE BEFORE THIS WELL CAN
BE SPUDDED; THEREFORE, AN EXTENSION IS REQUESTED.

18. I hereby certify that the information above is true and complete to the best of my knowledge and belief.

SIGNED *A. G. Buices* TITLE Drilling Clerk DATE 11-16-78

Original Signed by A. R. Kendrick TITLE SUPERVISOR DIST. 53 DATE NOV 16 1978
APPROVED BY _____
CONDITIONS OF APPROVAL, IF ANY:

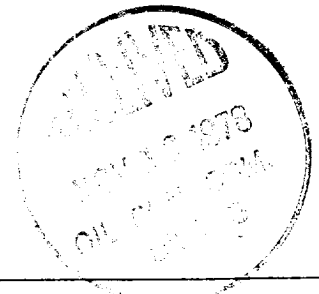

2-23-78

S

API 30-045-21978

1-26-76

F. Loc. 1650/S;1500/E

Elev. 6205 GR

Spd.

Comp.

TD

PB

Casing S. @ W Sx.
Csg.Perf.Int. @ W Sx. Pr. @ W Sx. T. @
Prod. Stim.T
R
A
N
S

I.P. BO/D MCF/D After Hrs. SICP PSI After Days GOR Grav. 1st Del. s

TOPS		NITD	Well Log	TEST DATA						
Kirtland		C-103	Plat	Schd.	PC	Q	PW	PD	D	Ref.No.
Fruitland		C-104	Electric Log							
Pictured Cliffs			C-122							
Cliff House		Ditr	Dfa							
Menefee		Datr	Dac							
Point Lookout										
Mancos										
Gallup										
Sanostee										
Greenhorn										
Dakota										
Morrison										
Entrada										

E/320

P
o
o
l

Blanco MV Co. SJ S 32

T 30N

R 8W

U J

Oper.

El Paso Natural Gas Co.

Lse.

EPNG Com

1A

EPNG Com #1A

J-32-30N-8W

El Paso Natural Gas Company



ENERGY AND MINERALS DEPARTMENT

OIL CONSERVATION DIVISION
AZTEC DISTRICT OFFICE

JERRY APODACA
GOVERNOR

NICK FRANKLIN
SECRETARY

1000 RIO BRAZOS ROAD
AZTEC, NEW MEXICO 87410
(505) 334-6178

March 6, 1979

El Paso Natural Gas Company

P. O. Box 990

Farmington, New Mexico 87401

Re: El Paso Natural Gas Company

EPNG Com #1A

J-32-30N-8W

Gentlemen:

Ninety days have elapsed since approval of Division Form C-101, Notice of Intention to Drill, for the subject well and to date no progress reports, Forms C-103, have been received. Therefore, Division approval of Form C-101 has now expired and no drilling operations are to be initiated or continued without further notice to and approval by the Division. Pending such approval this will be considered an abandoned location.

Yours very truly,

A. R. Kendrick
Supervisor, District #3

xc: OCD, Santa Fe