

UNITED STATES  
DEPARTMENT OF THE INTERIOR  
GEOLOGICAL SURVEY

SUBMIT IN TRIPLICATE\*  
(Other instructions on  
reverse side)

Form approved.  
Budget Bureau No. 42-R1425.

30-045-26794

APPLICATION FOR PERMIT TO DRILL, DEEPEN, OR PLUG BACK

1a. TYPE OF WORK DRILL ☒ DEEPEN ☐ PLUG BACK ☐

b. TYPE OF WELL OIL WELL ☐ GAS WELL ☒ OTHER ☐ SINGLE ZONE ☒ MULTIPLE ZONE ☐

2. NAME OF OPERATOR  
Ladd Petroleum Corporation

3. ADDRESS OF OPERATOR  
370 17th St. Suite 1700, Denver, Colo. 80202

4. LOCATION OF WELL (Report location clearly and in accordance with any State requirements.)  
At surface 1790' FNL & 970' FWL (SE NW)

At proposed prod. zone  
Same

14. DISTANCE IN MILES AND DIRECTION FROM NEAREST TOWN OR POST OFFICE\*  
Location is 8.8 miles Northwest of Farmington, New Mexico

15. DISTANCE FROM PROPOSED\*  
LOCATION TO NEAREST  
PROPERTY OR LEASE LINE, FT.  
(Also to nearest drig. unit line, if any) 970'

16. NO. OF ACRES IN LEASE  
180 2563.94

17. NO. OF ACRES ASSIGNED  
TO THIS WELL  
316.83

18. DISTANCE FROM PROPOSED LOCATION\*  
TO NEAREST WELL, DRILLING, COMPLETED,  
OR APPLIED FOR, ON THIS LEASE, FT. ---

19. PROPOSED DEPTH  
6362

20. ROTARY OR CABLE TOOLS  
Rotary

21. ELEVATIONS (Show whether DF, RT, GR, etc.)  
5725' GR

DRILLING OPERATIONS AUTHORIZED ARE  
SUBJECT TO COMPLIANCE WITH ATTACHED  
"GENERAL REQUIREMENTS".

22. APPROX. DATE WORK WILL START\*  
May 15, 1987

23. PROPOSED CASING AND CEMENTING PROGRAM This action is subject to technical and  
procedural review pursuant to 43 CFR 3165.3  
and appeal pursuant to 43 CFR 3165.4.

SIZE OF HOLE	SIZE OF CASING	WEIGHT PER FOOT	SETTING DEPTH	
13 3/4"	8 5/8" new	24#, K-55 STC	270'	Cement to surface
7 7/8"	4 1/2" new	10.5# K-55 STC	6362'	See attached On Shore Order # 1

Operator proposes to test the Dakota formation (6107') for hydrocarbons. If  
successful production casing will be set and a completion attempted. If unsuccessful  
well will be plugged and abandoned in accordance with Federal and State regulations.

See On Shore Order No 1 for details.

RECEIVED  
MAY 29 1987  
OIL CON. DIV  
DIST. 3

IN ABOVE SPACE DESCRIBE PROPOSED PROGRAM: If proposal is to deepen or plug back, give data on present productive zone and proposed new productive  
zone. If proposal is to drill or deepen directionally, give pertinent data on subsurface locations and measured and true vertical depths. Give blowout  
preventer program, if any.

24. SIGNED [Signature] Operations Support Coordinator DATE May 1, 1987

(This space for Federal or State office use)

PERMIT NO. \_\_\_\_\_ APPROVAL DATE \_\_\_\_\_

APPROVED BY \_\_\_\_\_ TITLE \_\_\_\_\_

CONDITIONS OF APPROVAL, IF ANY:

APPROVED  
AS AMENDED

MAY 26 1987

FOR /s/ J. Stan McKee  
AREA MANAGER

NSP R-2046

NMOCC

\*See Instructions On Reverse Side

**NEW MEXICO OIL CONSERVATION COMMISSION  
WELL LOCATION AND ACREAGE DEDICATION PLAT**

Form C-102  
Supersedes C-128  
Effective 1-1-65

All distances must be from the outer boundaries of the Section.

Operator <b>Ladd Petroleum Corporation</b>			Lease <b>Butte</b>		Well No. <b>1R</b>
Unit Letter <b>F</b>	Section <b>19</b>	Township <b>30 North</b>	Range <b>13 West</b>	County <b>San Juan</b>	
Actual Footage Location of Well: <b>1790</b> feet from the <b>North</b> line and <b>970</b> feet from the <b>West</b> line					
Ground Level Elev. <b>5725</b>	Producing Formation <b>Dakota</b>	Pool <b>BASIN</b>		Dedicated Acreage: <b>316.83</b> Acres	

1. Outline the acreage dedicated to the subject well by colored pencil or hachure marks on the plat below.  
See Exhibit A attached
2. If more than one lease is dedicated to the well, outline each and identify the ownership thereof (both as to working interest and royalty). See Exhibit A, Exhibit B, and Exhibit C attached
3. If more than one lease of different ownership is dedicated to the well, have the interests of all owners been consolidated by communitization, unitization, force-pooling, etc? Communitized

☒ Yes ☐ No If answer is "yes," type of consolidation Communitized

If answer is "no," list the owners and tract descriptions which have actually been consolidated. (Use reverse side of this form if necessary.)

No allowable will be assigned to the well until all interests have been consolidated (by communitization, unitization, forced-pooling, or otherwise) or until a non-standard unit, eliminating such interests, has been approved by the Commission.

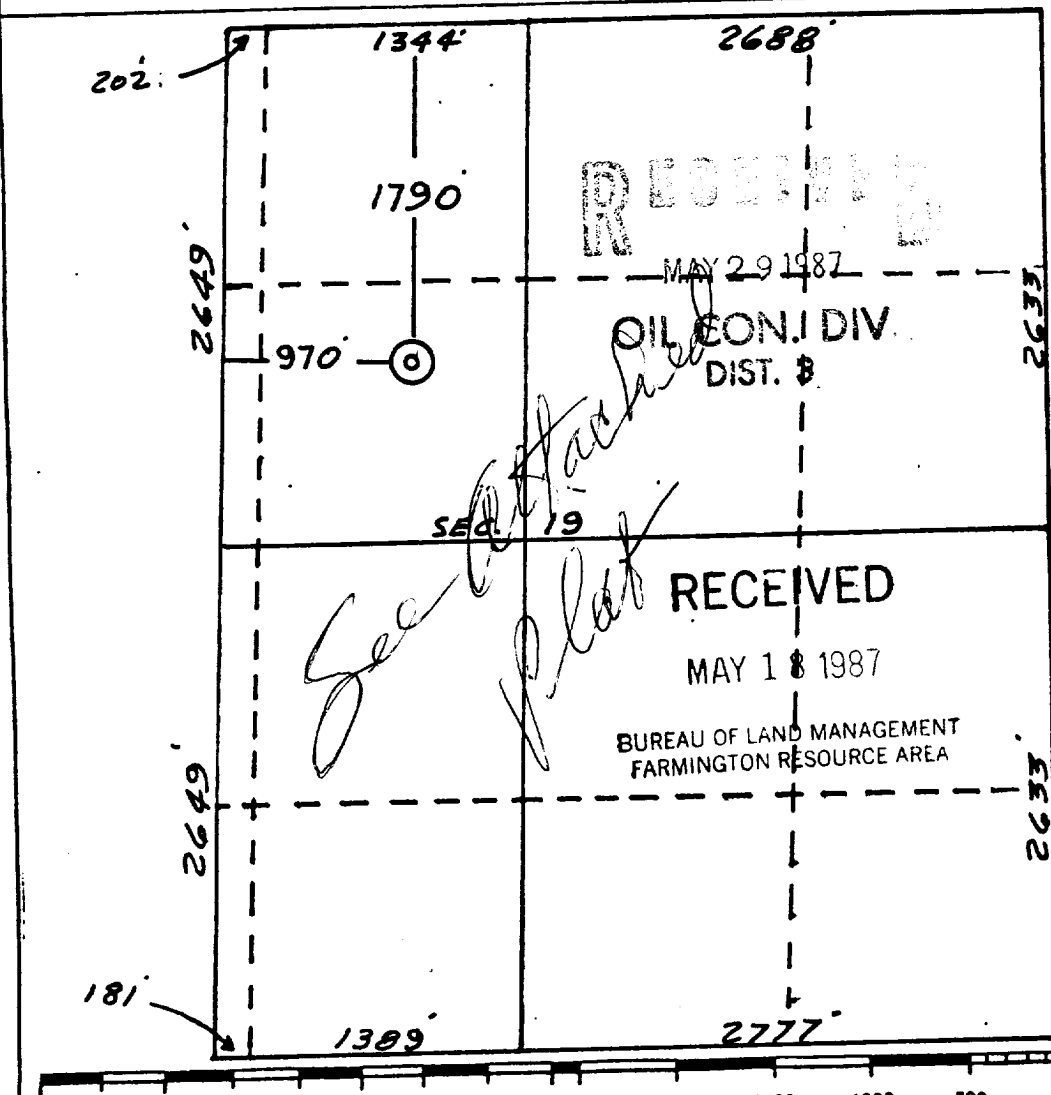

<b>CERTIFICATION</b>	
I hereby certify that the information contained herein is true and complete to the best of my knowledge and belief.	
Name	<b>Joe Adamski</b>
Position	<b>Operations Support Coordinator</b>
Company	<b>Ladd Petroleum Corp.</b>
	<b>370 17th, #1700</b>
	<b>Denver, CO. 80202</b>
Date	<b>May 14, 1987</b>
Date Surveyed	<b>April 1, 1987</b>
Registered Professional Engineer and/or Land Surveyor	
<b>Edgar L. Risenhoover</b>	
Certificate No.	<b>5979</b>
<b>Edgar L. Risenhoover, L.S.</b>	

EXHIBIT A  
BUTTE UNIT

SEC. 18

SEC. 18

40 ac.  
Butte NE

40 ac

4/6 ac

46 cc

40 gms

40  
-1-19  
Shut-in

~~42.23 ac~~

Plot 6  
42.22 ac.

Lot 5  
42.10 as.

Lot 10  
42.75 ac.

Lot 11  
42.63 ac

$$\frac{42.5}{100}$$

Lot 13  
41.88 ac

40 am

40 ac

Lot 16  
40.58cc

40 a

404

Proposed  
Butte #1-R

San Juan County, New Mexico  
Township 30 North, Range 13 West  
316.83 acres

Lease: U.S. SF-078977  
Sec. 19: Lots 1, 2, 3, 4,  
E/2 W/2

**Sec. 30: Lot 7**

Lease: NM-0986-A (Federal)  
Sec. 18: Lots 3,4, E/2 SW/4

SEC. 19

SEC. 30

30

