

UNITED STATES
DEPARTMENT OF THE INTERIOR
BUREAU OF LAND MANAGEMENT

30-045-26720

APPLICATION FOR PERMIT TO DRILL, DEEPEN, OR PLUG BACK

1a. TYPE OF WORK
 DRILL DEEPEN PLUG BACK
 b. TYPE OF WELL
 OIL WELL GAS WELL OTHER
 SINGLE ZONE MULTIPLE ZONE

2. NAME OF OPERATOR
 El Paso Natural Gas Company

3. ADDRESS OF OPERATOR
 PO Box 4289, Farmington, NM 87499

4. LOCATION OF WELL (Report location clearly and in accordance with any State requirements.)
 At surface: 1700'S, 1055'E
 At proposed prod. zone

RECEIVED
MAR 24 1986

14. DISTANCE IN MILES AND DIRECTION FROM NEAREST TOWN OR POST OFFICE
 2 miles SE of Aztec, NM

15. DISTANCE FROM PROPOSED* LOCATION TO NEAREST PROPERTY OR LEASE LINE, FT. (Also to nearest drlg. unit line, if any)
 1055'

16. NO. OF ACRES IN LEASE
 317.76

17. NO. OF ACRES ASSIGNED TO THIS WELL
 5 317.76

18. DISTANCE FROM PROPOSED LOCATION* TO NEAREST WELL, DRILLING, COMPLETED OR APPLIED FOR, ON THIS LEASE, FT.
 300'

19. PROPOSED DEPTH
 5105'

20. ROTARY OR CABLE TOOLS
 Rotary

21. ELEVATIONS (Show whether DF, RT, GR, etc.)
 5976' GL

22. APPROX. DATE WORK WILL START*

DRILLING OPERATIONS AUTHORIZED ARE SUBJECT TO COMPLIANCE WITH ATTACHED "GENERAL REQUIREMENTS" PROPOSED CASING AND CEMENTING PROGRAM

This action is subject to technical and procedural review pursuant to 43 CFR 3165.3 and appeal pursuant to 43 CFR 3165.4.

SIZE OF HOLE	SIZE OF CASING	WEIGHT PER FOOT	SETTING DEPTH	QUANTITY OF CEMENT
12 1/4"	9 5/8"	36.0#	200'	138 cu.ft. circulated
8 3/4"	7"	20.0#	2725'	535 cu.ft. cover Ojo Alamo
6 1/4"	4 1/2"	10.5#	2575-5105'	445 cu.ft. circ. liner

Selectively perforate and sand water fracture the Mesa Verde formation.
 A 3000 psi WP and 6000 psi test double gate preventer equipped with blind and pipe rams will be used for blow out prevention on this well.
 This gas is dedicated.
 The S/2 of Section 27 is dedicated to this well.

RECEIVED
APR 07 1986
OIL CON. DIV.
DIST. 3

IN ABOVE SPACE DESCRIBE PROPOSED PROGRAM: If proposal is to deepen or plug back, give data on present productive zone and proposed new productive zone. If proposal is to drill or deepen directionally, give pertinent data on subsurface locations and measured and true vertical depths. Give blowout preventer program, if any.

24. SIGNED [Signature] TITLE Drilling Clerk DATE 3-21-86

PERMIT NO. _____ APPROVAL DATE _____
 APPROVED BY _____ TITLE _____
 CONDITIONS OF APPROVAL, IF ANY: _____

APPROVED
AS AMENDED
APR 07 1986
[Signature]
AREA MANAGER

ok
5/6

NMOCC

*See Instructions On Reverse Side

OIL CONSERVATION DIVISION

STATE OF NEW MEXICO
ENERGY AND MINERALS DEPARTMENT

P. O. BOX 2088
SANTA FE, NEW MEXICO 87501

Form C-102
Revised 10-1-78

All distances must be from the outer boundaries of the Section.

Operator El Paso Natural Gas Company			Lease Murphy D (NM 02758)			Well No. 4		
Unit Letter I	Section 27	Township 30N	Range 11 W	County San Juan				
Actual Footage Location of Well: 1700 feet from the South line and 1055 feet from the East line								
Ground Level Elev. 5976	Producing Formation Mesaverde		Pool Blanco			Dedicated Acreage: 317.76 Acres		

1. Outline the acreage dedicated to the subject well by colored pencil or hachure marks on the plat below.
2. If more than one lease is dedicated to the well, outline each and identify the ownership thereof (both as to working interest and royalty).
3. If more than one lease of different ownership is dedicated to the well, have the interests of all owners been consolidated by communitization, unitization, force-pooling, etc?

Yes No If answer is "yes," type of consolidation _____

If answer is "no," list the owners and tract descriptions which have actually been consolidated. (Use reverse side of this form if necessary.) _____

No allowable will be assigned to the well until all interests have been consolidated (by communitization, unitization, forced-pooling, or otherwise) or until a non-standard unit, eliminating such interests, has been approved by the Division.

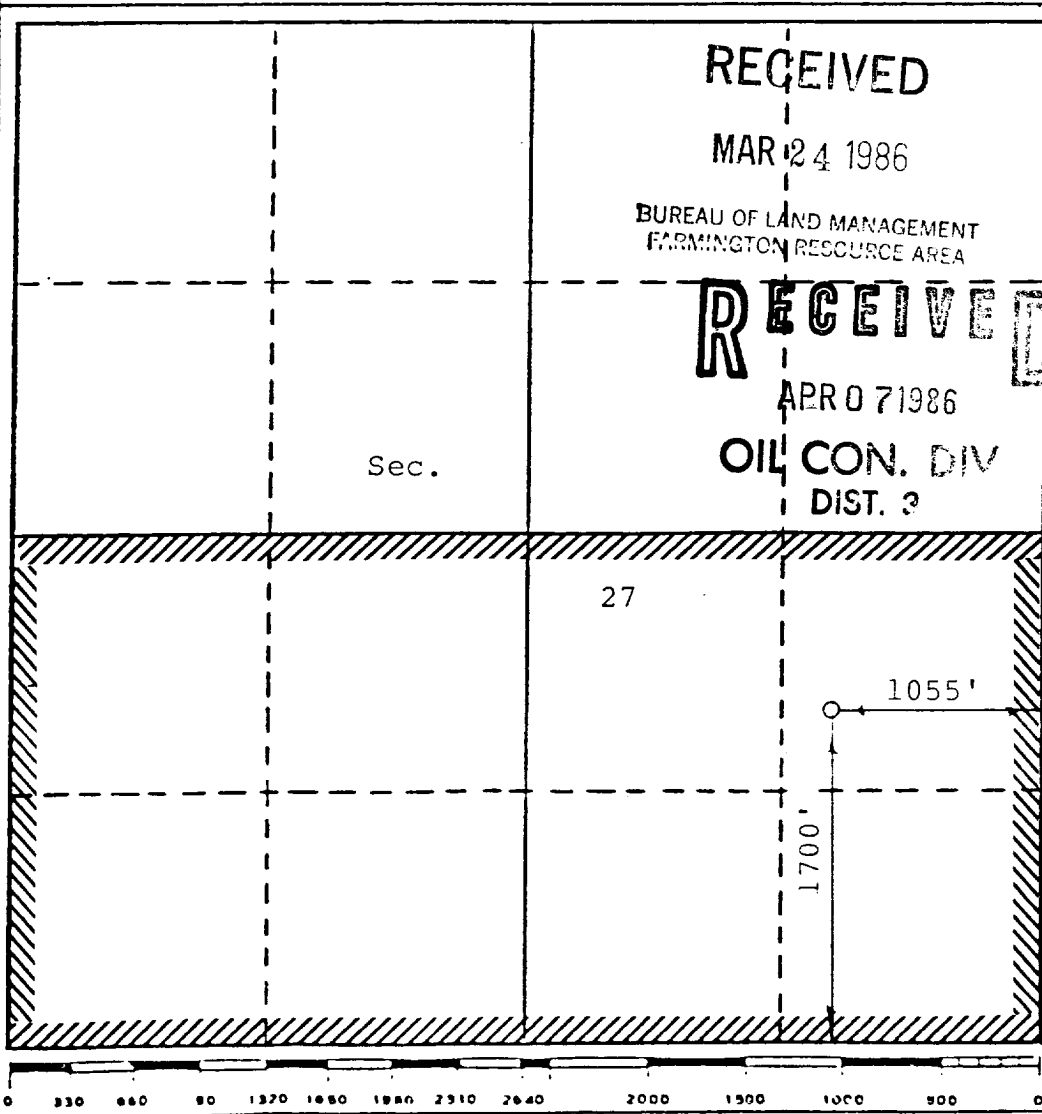

CERTIFICATION	
I hereby certify that the information contained herein is true and complete to the best of my knowledge and belief.	
<i>Peggy Cook</i>	
Name	Drilling Clerk
Position	El Paso Natural Gas
Company	3-21-86
Date	
I hereby certify that the well location shown on this plat was plotted from field notes of actual surveys made by me or under my supervision, and that the same is true and correct to the best of my knowledge and belief.	
March 10, 1986	
Date Surveyed	David M. Kelsey
Registered Professional Engineer and/or Land Surveyor	
<i>David M. Kelsey</i>	
Certificate No.	5855

MURPHY D #4

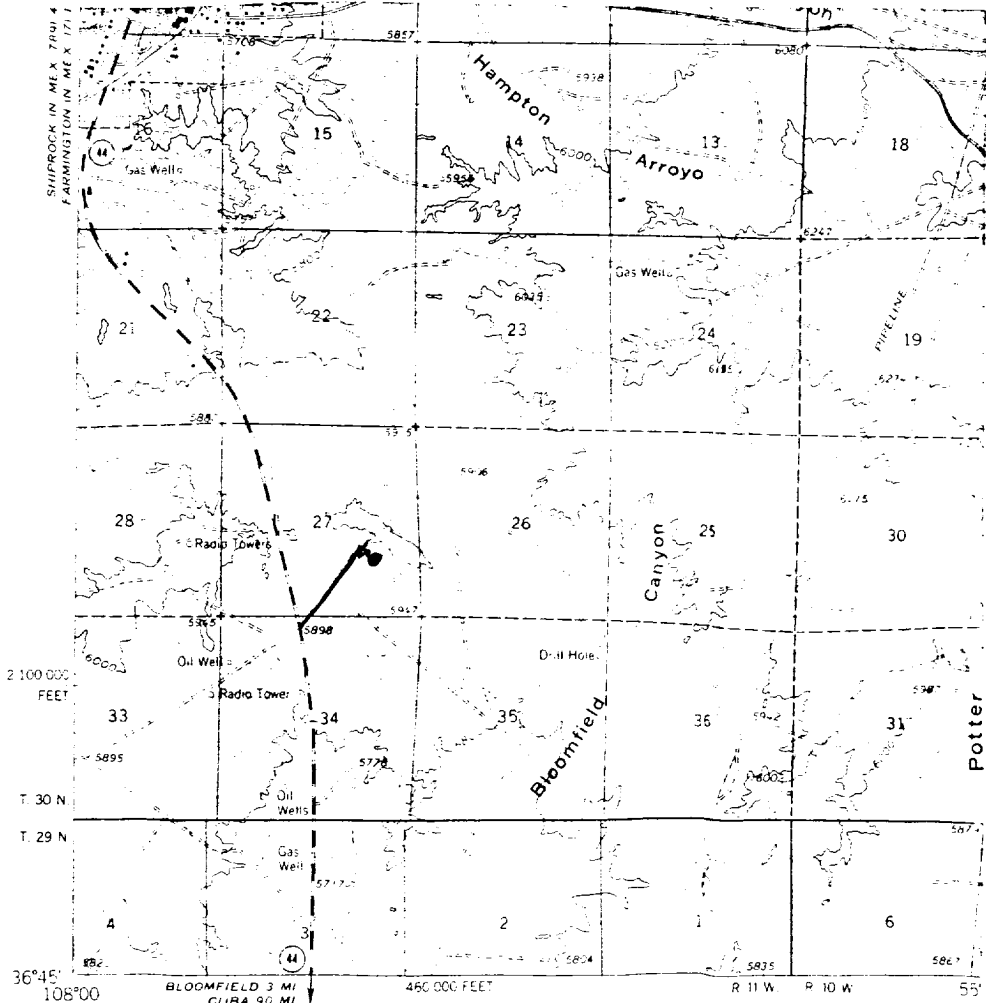

Mapped, edited, and published by the Geological Survey

Control by USGS and USC&GS

Topography by photogrammetric method; from aerial photographs taken 1955. Field checked 1959.

Polyconic projection; 1927 North American datum; 10,000-foot grid based on New Mexico coordinate system; west zone.

1:000-meter Universal Transverse Mercator grid ticks; zone 12; north-south blue.

Red tint indicate area in which original mark buildings are shown.

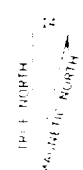



Map #2

LEGEND OF RIGHT-OF-WAYS

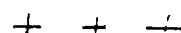
EXISTING ROADS 

EXISTING PIPELINES 

EXISTING ROAD & PIPELINE 

PROPOSED ROADS 

PROPOSED PIPELINES 

PROPOSED ROAD & PIPELINE 