

UNITED STATES  
DEPARTMENT OF THE INTERIOR  
BUREAU OF LAND MANAGEMENT

APPLICATION FOR PERMIT TO DRILL, DEEPEN, OR PLUG BACK

1a. TYPE OF WORK DRILL <input checked="" type="checkbox"/> DEEPEN <input type="checkbox"/> PLUG BACK <input type="checkbox"/>				5. LEASE DESIGNATION AND SERIAL NO. SF 078174A	
b. TYPE OF WELL OIL WELL <input type="checkbox"/> GAS WELL <input checked="" type="checkbox"/> OTHER <input type="checkbox"/>				6. IF INDIAN, ALLOTTEE OR TRIBE NAME	
2. NAME OF OPERATOR Meridian Oil Inc.				7. UNIT AGREEMENT NAME	
3. ADDRESS OF OPERATOR PO Box 4289, Farmington, NM 87499				8. FARM OR LEASE NAME Kessler Com	
4. LOCATION OF WELL (Report location clearly and in accordance with any State requirements.) At surface 790'S, 1850'E At proposed prod. zone 1815'E				9. WELL NO. 3	
14. DISTANCE IN MILES AND DIRECTION FROM NEAREST TOWN OR POST OFFICE* 3 miles SW of Aztec, NM				10. FIELD AND POOL, OR WILDCAT Blanco Mesa Verde	
15. DISTANCE FROM PROPOSED* LOCATION TO NEAREST PROPERTY OR LEASE LINE, FT. (Also to nearest drlg. unit line, if any)		16. NO. OF ACRES IN LEASE 320.00		17. NO. OF ACRES ASSIGNED TO THIS WELL E 320.00 313.36	
18. DISTANCE FROM PROPOSED LOCATION* TO NEAREST WELL, DRILLING, COMPLETED, OR APPLIED FOR, ON THIS LEASE, FT. 790'		19. PROPOSED DEPTH 5140'		20. ROTARY OR CABLE TOOLS Rotary	
21. ELEVATIONS (Show whether DF, RT, GR, etc.) 5971' GL DRILLING OPERATIONS AUTHORIZED ARE SUBJECT TO COMPLIANCE WITH ATTACHED PROPOSED CASING AND CEMENTING PROGRAM GENERAL REQUIREMENTS				22. APPROX. DATE WORK WILL START* This action is subject to technical and operational review pursuant to 43 CFR 3165.3 and 43 CFR 3185.4.	
SIZE OF HOLE	SIZE OF CASING	WEIGHT PER FOOT	SETTING DEPTH	QUANTITY OF CEMENT	
12 1/4"	9 5/8"	32.3#	200'	125 cu.ft. circulated	
8 3/4"	7"	20&23#	2720'	496 cu.ft. cover Ojo Alamo	
6 1/4"	4 1/2"	10.5#	2570-5140'	448 cu.ft. circ. liner	

Selectively perforate and sand water fracture the Mesa Verde formation.

A 3000 psi WP and 6000 psi test double gate preventer equipped with blind and pipe rams will be used for blow out prevention on this well.

This gas is dedicated.

The E/2 of Section 25 is dedicated to this well.

IN ABOVE SPACE DESCRIBE PROPOSED PROGRAM: If proposal is to deepen or plug back, give data on present productive zone and proposed new productive zone. If proposal is to drill or deepen directionally, give pertinent data on subsurface locations and measured and true vertical depths. Give blowout preventer program, if any.

24. SIGNED Deany Doak TITLE Drilling Clerk DATE 10-05-87

(This space for Federal or State office use)

PERMIT NO. \_\_\_\_\_ APPROVAL DATE \_\_\_\_\_

APPROVED BY \_\_\_\_\_ TITLE \_\_\_\_\_ DATE \_\_\_\_\_  
CONDITIONS OF APPROVAL, IF ANY:

NMCCC

\*See Instructions On Reverse Side

## OIL CONSERVATION DIVISION

STATE OF NEW MEXICO  
ENERGY AND MINERALS DEPARTMENTP. O. BOX 2088  
SANTA FE, NEW MEXICO 87501Form C-102  
Revised 10-1-78

All distances must be from the outer boundaries of the Section.

Operator MERIDIAN OIL INC.			Lessee KESSLER COM (SF-078174A)		Well No. 3
Unit Letter O	Section 25	Township 30-N	Range 11-W	County SAN JUAN	
Actual Footage Location of Well: 790 feet from the SOUTH line and 1815 feet from the EAST line					
Ground Level Elev. 5968	Producing Formation Mesa Verde		Pool Blanco	Dedicated Acreage: 320 3/8 Acres	

1. Outline the acreage dedicated to the subject well by colored pencil or hatchure marks on the plat below.
2. If more than one lease is dedicated to the well, outline each and identify the ownership thereof (both as to working interest and royalty).
3. If more than one lease of different ownership is dedicated to the well, have the interests of all owners been consolidated by communitization, unitization, force-pooling, etc?

☒ Yes ☐ No If answer is "yes," type of consolidation communitization

If answer is "no," list the owners and tract descriptions which have actually been consolidated. (Use reverse side of this form if necessary.)

No allowable will be assigned to the well until all interests have been consolidated (by communitization, unitization, forced-pooling, or otherwise) or until a non-standard unit, eliminating such interests, has been approved by the Division.

REISSUED TO SHOW MOVED LOCATION 10/22/1987

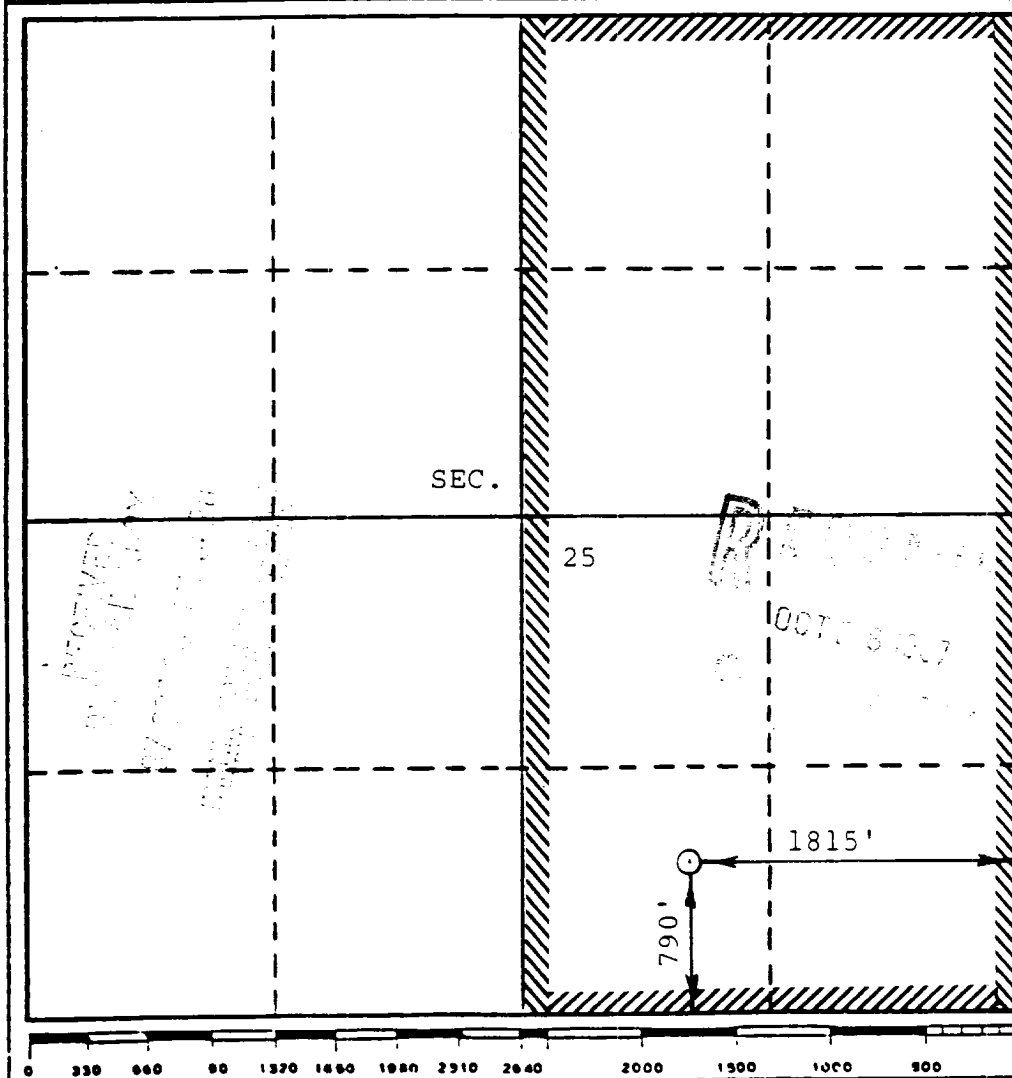

## CERTIFICATION

I hereby certify that the information contained herein is true and complete to the best of my knowledge and belief.

Name  
Drilling Clerk  
Meridian Oil Inc.  
Company

Date

I hereby certify that the well location shown on this plat was plotted from field notes of actual surveys made by me or under my supervision, and that the same is true and correct to the best of my knowledge and belief.

SEPTEMBER 26, 1987

Date Surveyed

DAVID M. KELSEY

Registered Professional Engineer  
and/or Land Surveyor

Certificate No.

5855

# Kessler Com #3

## SE 25-30-11

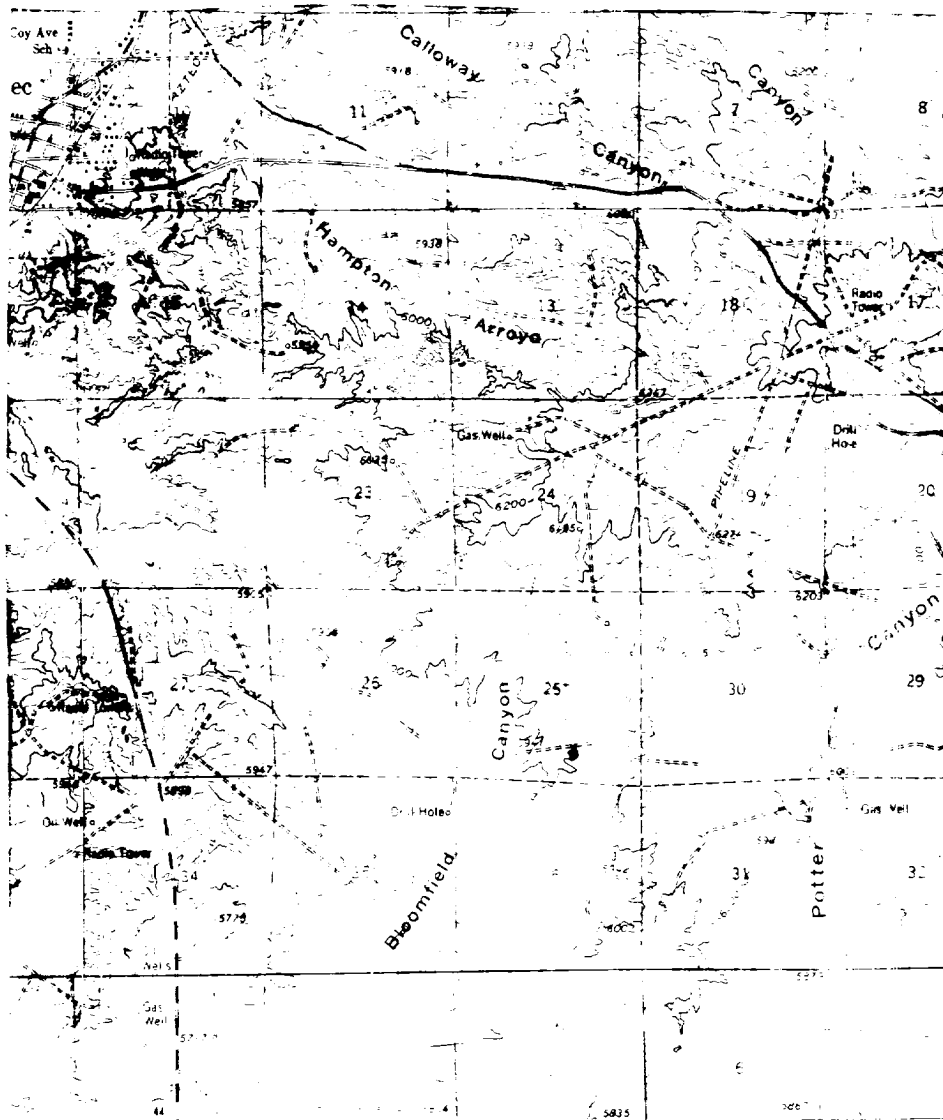

Edited and published by the Geological Survey  
 U.S.S. and U.S.C. & S.  
 and other appropriate methods from 1911

Map #2

### LEGEND OF RIGHT-OF-WAYS

- EXISTING ROADS
- EXISTING PIPELINES
- EXISTING ROAD & PIPELINE
- PROPOSED ROADS
- PROPOSED PIPELINES
- PROPOSED ROAD & PIPELINE