

UNITED STATES
DEPARTMENT OF THE INTERIOR
BUREAU OF LAND MANAGEMENT

APPLICATION FOR PERMIT TO DRILL, DEEPEN, OR PLUG BACK

1a. TYPE OF WORK DRILL <input checked="" type="checkbox"/> DEEPEN <input type="checkbox"/> PLUG BACK <input type="checkbox"/>			5. LEASE DESIGNATION AND SERIAL NO. SF 080113		
b. TYPE OF WELL OIL WELL <input type="checkbox"/> GAS WELL <input checked="" type="checkbox"/> OTHER <input type="checkbox"/>			6. IF INDIAN, ALLOTTEE OR TRIBE NAME		
2. NAME OF OPERATOR Meridian Oil Inc.			7. UNIT AGREEMENT NAME		
3. ADDRESS OF OPERATOR P.O. Box 4289, Farmington, NM 87499			8. FARM OR LEASE NAME Hartman Com		
4. LOCATION OF WELL (Report location clearly and in accordance with any State requirements.) At surface 1450' FNL, 790' FEL At proposed prod. zone			9. WELL NO. 4		
14. DISTANCE IN MILES AND DIRECTION FROM NEAREST TOWN OR POST OFFICE* 5 miles SW of Aztec, NM			10. FIELD AND POOL, OR WILDCAT Blanco Mesa Verde		
15. DISTANCE FROM PROPOSED* LOCATION TO NEAREST PROPERTY OR LEASE LINE, FT. (Also to nearest drlg. unit line, if any) 790'			11. SEC., T., R., E., M., OR BLE. AND SURVEY OR AREA H Sec. 26, T-30-N, R-11-W NM PM		
16. NO. OF ACRES IN LEASE 320			12. COUNTY OR PARISH San Juan		
17. NO. OF ACRES ASSIGNED TO THIS WELL 319.53			13. STATE NM		
18. DISTANCE FROM PROPOSED* LOCATION TO NEAREST WELL, DRILLING, COMPLETED, OR APPLIED FOR, ON THIS LEASE, FT. 300'			19. PROPOSED DEPTH 5210		
20. ROTARY OR CABLE TOOLS Rotary			21. APPROX. DATE WORK WILL START* as soon as possible		
22. ELEVATIONS (Show whether DF, RT, GR, etc.) -5962' GL 6036					

PROPOSED CASING AND CEMENTING PROGRAM

SIZE OF HOLE	SIZE OF CASING	WEIGHT PER FOOT	SETTING DEPTH	QUANTITY OF CEMENT
12 1/4"	9 5/8"	32.3#	200'	125 cu. ft. circulated
8 3/4"	7"	20.0#	2820'	520 cu. ft. cover Ojo Alamo
6 1/4"	4 1/2"	10.5#	2670' - 5210'	443 cu. ft. circulate liner

Selectively perforate and sand water fracture the Mesa Verde formation.

A 3000 psi WP and 6000 psi test double gate preventer equipped with blind and pipe rams will be used for blow out prevention on this well.

This gas is dedicated.

The N/2 of Section 26 is dedicated to this well.

NOV 30 1987
OIL CON. DIV.
DIST. 3

IN ABOVE SPACE DESCRIBE PROPOSED PROGRAM: If proposal is to deepen or plug back, give data on present productive zone and proposed new productive zone. If proposal is to drill or deepen directionally, give pertinent data on subsurface locations and measured and true vertical depths. Give blowout preventer program, if any.

24. SIGNED [Signature] TITLE Registered Petroleum Engineer DATE _____

(This space for Federal or State office use)

PERMIT NO. _____ APPROVAL DATE _____

APPROVED BY _____ TITLE _____ DATE _____

CONDITIONS OF APPROVAL, IF ANY:

NOV 06 1987

OIL CON. DIV.

DIST. 3

See Instructions On Reverse Side

All distances must be from the outer boundaries of the Section.

Operator MERIDIAN OIL INC.			Lease HARTMAN COM (SF 080113)		Well No. 4
Unit Letter H	Section 26	Township 30N	Range 11W	County SAN JUAN	

Actual Footage Location of Well:

1450 feet from the NORTH line and 790 feet from the EAST line

Ground Level Elev. 6036	Producing Formation Mesa Verde	Pool Blanco	Dedicated Acreage: 320.1219.53 acres
----------------------------	-----------------------------------	----------------	---

1. Outline the acreage dedicated to the subject well by colored pencil or hachure marks on the plat below.
2. If more than one lease is dedicated to the well, outline each and identify the ownership thereof (both as to working interest and royalty).
3. If more than one lease of different ownership is dedicated to the well, have the interests of all owners been consolidated by communitization, unitization, force-pooling, etc?

☒ Yes ☐ No If answer is "yes," type of consolidation communitization

If answer is "no," list the owners and tract descriptions which have actually been consolidated. (Use reverse side of this form if necessary.)

No allowable will be assigned to the well until all interests have been consolidated (by communitization, unitization, forced-pooling, or otherwise) or until a non-standard unit, eliminating such interests, has been approved by the Division.

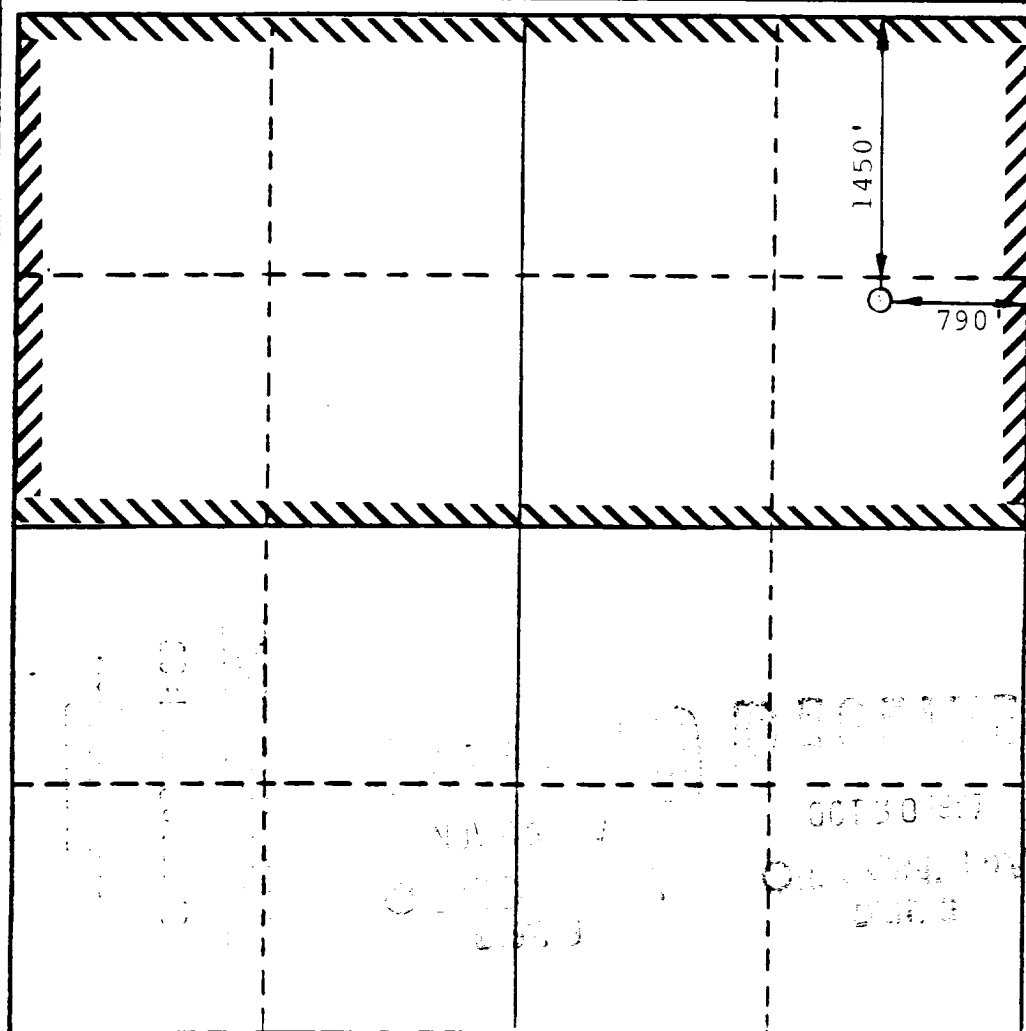

CERTIFICATION

I hereby certify that the information contained herein is true and complete to the best of my knowledge and belief.

Name
Drilling Clerk
Meridian Oil Inc.
Company

Date

I hereby certify that the well location shown on this plat was plotted from field notes of actual surveys made by me or under my supervision, and that the same is true and correct to the best of my knowledge and belief.

OCTOBER 9, 1987

Date Surveyed
DAVID M. KELSEY

Registered Professional Engineer
and/or Land Surveyor

David M. Kelsey
Certificate No.

5855

EL PASO NATURAL GAS COMPANY

Hartman #4

NE 26-30-11

1450 N 790 E

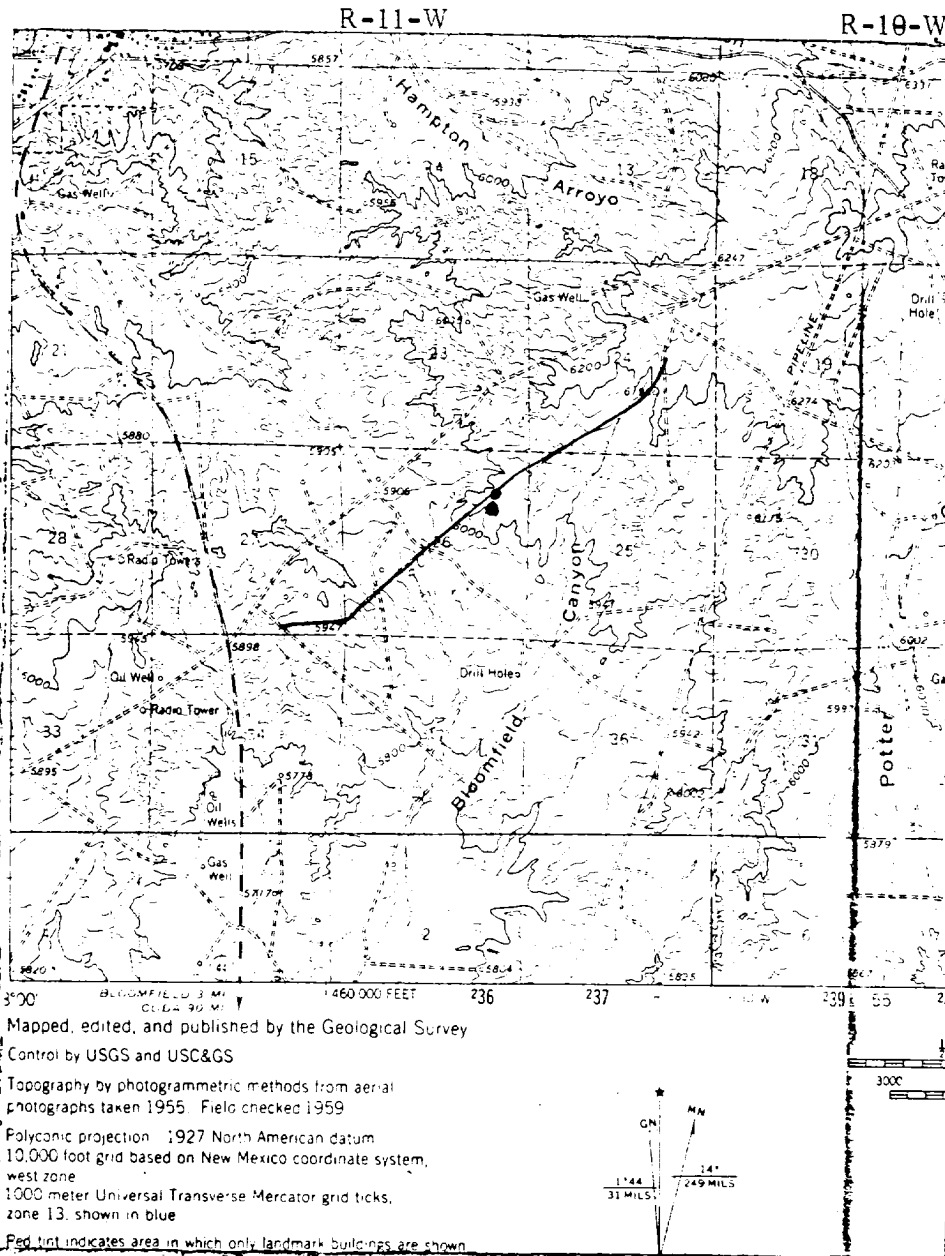

Mapped, edited, and published by the Geological Survey

Control by USGS and USC&GS

Topography by photogrammetric methods from aerial photographs taken 1955. Field checked 1959

Polyconic projection 1927 North American datum
10,000 foot grid based on New Mexico coordinate system,
west zone
1000 meter Universal Transverse Mercator grid ticks,
zone 13, shown in blue

Ped tint indicates area in which only landmark buildings are shown

MAP #1

LEGEND OF RIGHT-OF-WAYS

- EXISTING ROADS —————
- EXISTING PIPELINES — + + + —
- EXISTING ROAD & PIPELINE — + + + —
- PROPOSED ROADS —————
- PROPOSED PIPELINES — + + + —
- PROPOSED ROAD & PIPELINE — + + + —