

UNITED STATES  
DEPARTMENT OF THE INTERIOR  
BUREAU OF LAND MANAGEMENT

SUBMIT IN TRIPLICATE\*  
(Other instructions on re-  
verse side)

Budget Bureau No. 1004-0135  
Expires August 31, 1985

5. LEASE DESIGNATION AND SERIAL NO.

SF-078385A

6. IF INDIAN, ALLOTTEE OR TRIBE NAME

7. UNIT AGREEMENT NAME

8. FARM OR LEASE NAME

Howell L

9. WELL NO.

302

10. FIELD AND POOL, OR WILDCAT

Basin Fruitland Coal

11. SEC., T., R., NE, OR SW, AND  
SURVEY OR AREA

Sec. 34, T30N, R8W

NMPM

12. COUNTY OR PARISH 13. STATE

San Juan NM

1. OIL WELL ☐ GAS WELL ☒ OTHER

2. NAME OF OPERATOR

Meridian Oil Inc.

3. ADDRESS OF OPERATOR

P.O. Box 4289, Farmington, NM 87499

4. LOCATION OF WELL (Report location clearly and in accordance with any State requirements.\*  
See also space 17 below.) 1580'S, 1760'E  
At surface

14. PERMIT NO.

15. ELEVATIONS (Show whether OF, BT, OR, etc.)

6300' GL

16.

Check Appropriate Box To Indicate Nature of Notice, Report, or Other Data

NOTICE OF INTENTION TO:

TEST WATER SHUT-OFF

FRACTURE TREAT

SHOOT OR ACIDIZE

REPAIR WELL

(Other) Revision

POLE OR ALTER CASING

MULTIPLE COMPLETE

ABANDON\*

CHANGE PLANS

X

SUBSEQUENT REPORT OF:

WATER SHUT-OFF

FRACTURE TREATMENT

SHOOTING OR ACIDIZING

(Other)

REPAIRING WELL

ALTERING CASING

ABANDONMENT\*

(Note: Report results of multiple completion on Well  
Completion or Recompletion Report and Log form.)

17. DRAINAGE PROPOSED OR COMPLETED OPERATIONS (Clearly state all pertinent details, and give pertinent dates, including estimated date of starting any proposed work. If well is directionally drilled, give subsurface locations and measured and true vertical depths for all markers and zones pertinent to this work.)

Attached is a copy of the C102 showing the revised pool & dedication.

RECEIVED  
FARMINGTON RESOURCE AREA  
FARMINGTON, NEW MEXICO  
88 DEC 28 PM 2:19

DEC 28 1988  
OIL & GAS DIV.  
DIST. 3

18. I hereby certify that the foregoing is true and correct

SIGNED

TITLE Regulatory Affairs

DATE

12-22-88

(This space for Federal or State office use)

APPROVED BY

TITLE

DATE

CONDITIONS OF APPROVAL, IF ANY:

\*See Instructions on Reverse Side

All distances must be from the outer boundaries of the Section.

|  |                                       |                                |                                 |                    |
|--|---------------------------------------|--------------------------------|---------------------------------|--------------------|
| Operator<br>MERIDIAN OIL, INC.   |                                       | Lease<br>HOWELL L (SF-078385A) |                                 | Well No.<br>302    |
| Unit Letter<br>J   | Section<br>34                         | Township<br>30-N               | Range<br>8-W                    | County<br>SAN JUAN |
| Actual Footage Location of Well:<br>1580 feet from the SOUTH line and 1760 feet from the EAST line |                                       |                                |                                 |                    |
| Ground Level Elev.<br>6300   | Producing Formation<br>Fruitland Coal | Pool<br>Basin                  | Dedicated Acreage:<br>320 Acres |                    |

1. Outline the acreage dedicated to the subject well by colored pencil or hachure marks on the plat below.
2. If more than one lease is dedicated to the well, outline each and identify the ownership thereof (both as to working interest and royalty).
3. If more than one lease of different ownership is dedicated to the well, have the interests of all owners been consolidated by communitization, unitization, force-pooling, etc?

☐ Yes ☐ No If answer is "yes;" type of consolidation \_\_\_\_\_

If answer is "no;" list the owners and tract descriptions which have actually been consolidated. (Use reverse side of this form if necessary.) \_\_\_\_\_

No allowable will be assigned to the well until all interests have been consolidated (by communitization, unitization, forced-pooling, or otherwise) or until a non-standard unit, eliminating such interests, has been approved by the Division.

Reissued to show moved footage 3-15-88

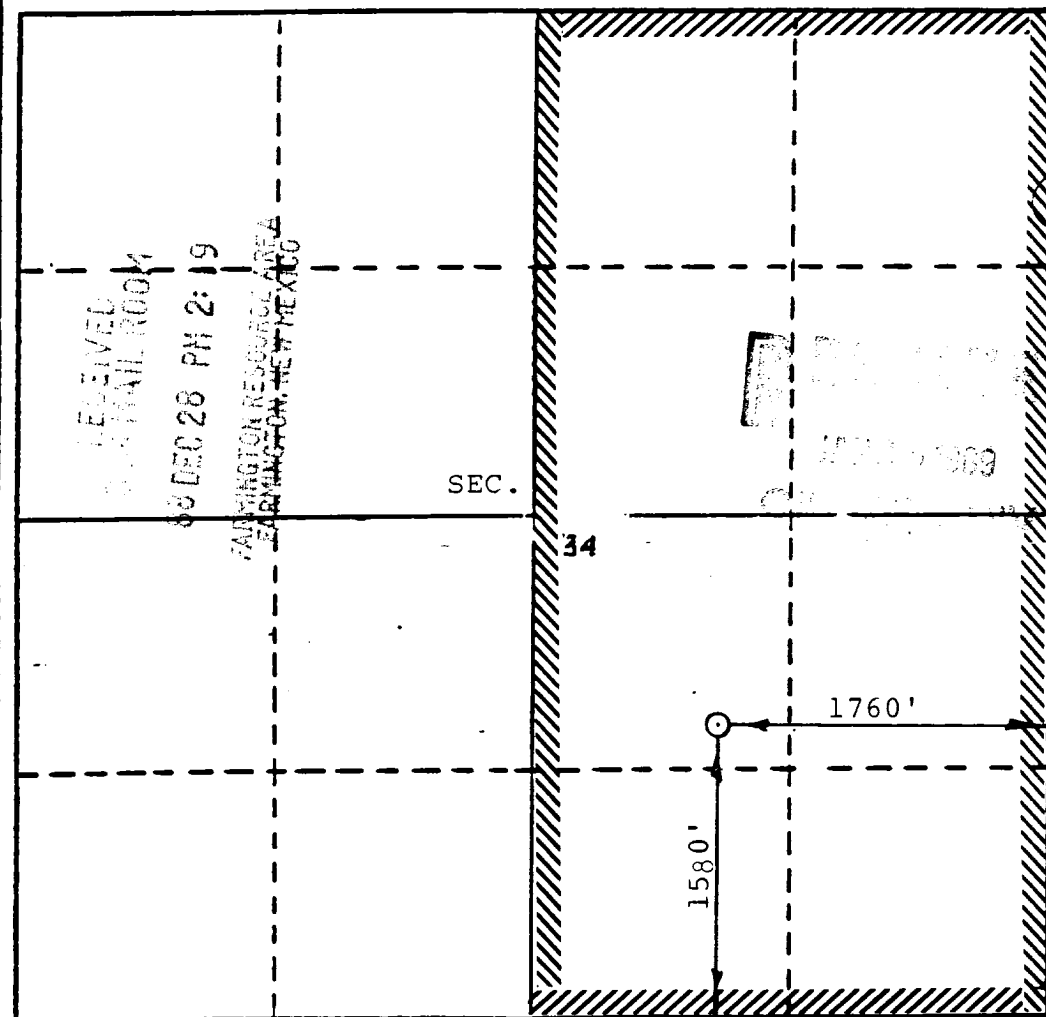

CERTIFICATION

I hereby certify that the information contained herein is true and complete to the best of my knowledge and belief.

*D. Bradford*

Name  
Drilling Clerk  
Meridian Oil Inc.

Company  
12-22-88

Date

I hereby certify that the well location shown on this plat was plotted from field notes of actual surveys made by me or under my supervision, and that the same is true and correct to the best of my knowledge and belief.

FEBRUARY 4, 1988

Date Surveyed  
ISAAC L. WEAVER  
Registered Professional Engineer  
and/or Land Surveyor

Certificate No. 8966