

UNITED STATES  
DEPARTMENT OF THE INTERIOR  
GEOLOGICAL SURVEY

## APPLICATION FOR PERMIT TO DRILL, DEEPEN, OR PLUG BACK

1a. TYPE OF WORK DRILL <input checked="" type="checkbox"/> DEEPEN <input type="checkbox"/> PLUG BACK <input type="checkbox"/>				5. LEASE DESIGNATION AND SERIAL NO. SF 078988	
b. TYPE OF WELL OIL WELL <input type="checkbox"/> GAS WELL <input checked="" type="checkbox"/> OTHER <input type="checkbox"/> SINGLE ZONE <input checked="" type="checkbox"/> MULTIPLE ZONE <input type="checkbox"/>				6. IF INDIAN, ALLOTTEE OR TRIBE NAME	
2. NAME OF OPERATOR Blackwood & Nichols Co., Ltd.				7. UNIT AGREEMENT NAME NEBU No 1, Sec 929	
3. ADDRESS OF OPERATOR P.O. Box 1237 Durango, CO 81302-1237				8. FARM OR LEASE NAME Northeast Blanco Unit	
4. LOCATION OF WELL (Report location clearly and in accordance with any State requirements.)* At surface 990' FSL, 990' FWL At proposed prod. zone				9. WELL NO. 400	
14. DISTANCE IN MILES AND DIRECTION FROM NEAREST TOWN OR POST OFFICE* 14 Miles				10. FIELD AND POOL, OR WILDCAT Fruitland Coal	
15. DISTANCE FROM PROPOSED* LOCATION TO NEAREST PROPERTY OR LEASE LINE, FT. (Also to nearest drlg. unit line, if any)		16. NO. OF ACRES IN LEASE 2560		17. NO. OF ACRES ASSIGNED TO THIS WELL 160	
18. DISTANCE FROM PROPOSED LOCATION* TO NEAREST WELL, DRILLING, COMPLETED, OR APPLIED FOR, ON THIS LEASE, FT.		19. PROPOSED DEPTH 3680'		20. ROTARY OR CABLE TOOLS Rotary	
21. ELEVATIONS (Show whether DF, RT, GR, etc.) 6530' U.G. This action is subject to technical and procedural review pursuant to 43 CFR 3165.2 and appeal pursuant to 43 CFR 3165.4.				22. APPROX. DATE WORK WILL START* April 21, 1988	
23. PROPOSED DRILLING AND CEMENTING PROGRAM					
SIZE OF HOLE	SIZE OF CASING	WEIGHT PER FOOT	SETTING DEPTH	DRILLING OPERATIONS AUTHORIZED ARE SUBJECT TO COMPLIANCE WITH ATTACHED "GENERAL REG. (256M-88)".	
12 1/4"	9 5/8"	36.0#	200'	Circulate (236 cf)	
8 3/4"	7"	23.0#	3680'	Circulate or Cover OjoAlamo (800 cf)	

Blackwood & Nichols Co., Ltd. proposes to drill this Fruitland Coal well to further develop the Northeast Blanco Unit. This APD requests right of way for the pipeline. A Notice of Staking for this well was submitted on March 22, 1988.

Attached: Onshore Drilling Program and Surface Use Program

RECEIVED  
OIL CON. DIV.  
DIST. 3  
APR 27 1988

RECEIVED  
OIL CON. DIV.  
DIST. 3  
APR 27 1988

IN ABOVE SPACE DESCRIBE PROPOSED PROGRAM: If proposal is to deepen or plug back, give data on present productive zone and proposed new productive zone. If proposal is to drill or deepen directionally, give pertinent data on subsurface locations and measured and true vertical depths. Give blowout preventer program, if any.

24. SIGNED William F. Elard TITLE Operations Manager DATE March 28, 1988

(This space for Federal or State office use)

PERMIT NO. \_\_\_\_\_ APPROVAL DATE \_\_\_\_\_

APPROVED BY \_\_\_\_\_ TITLE \_\_\_\_\_ DATE \_\_\_\_\_  
CONDITIONS OF APPROVAL, IF ANY:

ds  
EB

\*See Instructions On Reverse Side

APPROVED  
AS AMENDED  
APR 25 1988  
AREA MANAGER

NEW MEXICO OIL CONSERVATION COMMISSION  
WELL LOCATION AND ACREAGE DEDICATION PLAT

Form C-102  
Supersedes C-128  
Effective 1-1-65

All distances must be from the outer boundaries of the Section.

Operator <b>BLACKWOOD &amp; NICHOLS CO., LTD.</b>			Lease <b>NORTHEAST BLANCO UNIT</b>		Well No. <b>400</b>
Unit Letter <b>M</b>	Section <b>7</b>	Township <b>31 North</b>	Range <b>6 W., N.M.P.M.</b>	County <b>San Juan</b>	
Actual Footage Location of Well: <b>990 feet from the south line and 990 feet from the west line</b>					
Ground Level Elev: <b>6530 (U.G.)</b>	Producing Formation <b>Fruitland Coal</b>		Pool <b>Undeg. Fruitland</b>	Dedicated Acreage: <b>160 Acres</b>	

1. Outline the acreage dedicated to the subject well by colored pencil or hachure marks on the plat below.
2. If more than one lease is dedicated to the well, outline each and identify the ownership thereof (both as to working interest and royalty).
3. If more than one lease of different ownership is dedicated to the well, have the interests of all owners been consolidated by communitization, unitization, force-pooling, etc?

☒ Yes ☐ No If answer is "yes," type of consolidation Unitization

If answer is "no," list the owners and tract descriptions which have actually been consolidated. (Use reverse side of this form if necessary.)

No allowable will be assigned to the well until all interests have been consolidated (by communitization, unitization, forced-pooling, or otherwise) or until a non-standard unit, eliminating such interests, has been approved by the Commission.

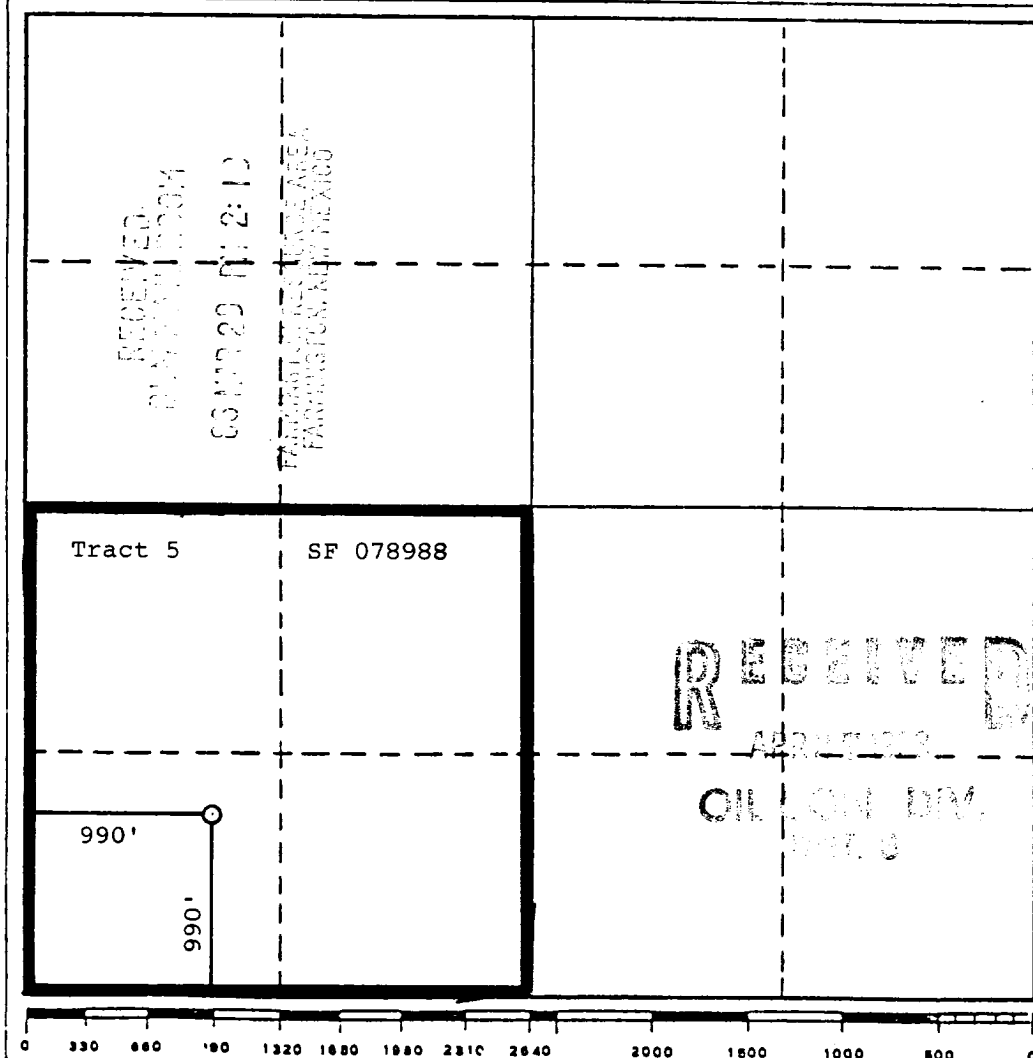

CERTIFICATION	
I hereby certify that the information contained herein is true and complete to the best of my knowledge and belief.	
<i>William F. Clark</i> William F. Clark	
Name	Operations Manager
Position	Blackwood & Nichols Co., Ltd.
Company	March 23, 1988
Date	
I hereby certify that the well location shown on this plat was plotted from field notes of actual surveys made by me or under my supervision, and that the same is true and correct to the best of my knowledge and belief.	
Date Surveyed	March 17, 1988
Registered Professional Engineer and/or Land Surveyor	<i>Allison L. Kroeger</i> Allison L. Kroeger, PLS
Certificate No.	7922

FIGURE III Access Road and Pipeline Detail

Northeast Blanco Unit Well Number 400

