

UNITED STATES  
DEPARTMENT OF THE INTERIOR  
BUREAU OF LAND MANAGEMENT

SUBMIT IN TRIPLICATE\*  
(Other instructions on  
reverse side)

Form approved.  
Budget Bureau No. 1004-0136  
Expires August 31, 1985

5. LEASE DESIGNATION AND SERIAL NO.

BF-078201A

IF INDIAN, ALLOTTEE OR TRIBE NAME

UNIT AGREEMENT NAME

9. FARM OR LEASE NAME

Riddle Com

9. WELL NO.

200

10. FIELD AND POOL, OR WILDCAT

Undes. Fruitland CCA

11. SEC., T., R., M., OR BLK.

Sec. 10, T-30-N, R- 9-W  
NMPM

12. COUNTY OR PARISH

San Juan

13. STATE

NM

1a. TYPE OF WORK

DRILL ☒

DEEPEN ☐

b. TYPE OF WELL

OIL  
WELL ☐

GAS  
WELL ☒

OTHER

SINGLE  
ZONE ☒

MULTIPLE  
ZONE ☐

2. NAME OF OPERATOR

Meridian Oil Inc.

3. ADDRESS OF OPERATOR

PO Box 4289, Farmington, NM 87499

4. LOCATION OF WELL (Report location clearly and in accordance with any State requirements.)

At surface  
835'S, 1180'E

At proposed prod. zone

14. DISTANCE IN MILES AND DIRECTION FROM NEAREST TOWN OR POST OFFICE\*

10 miles from Navajo Dam

16. DISTANCE FROM PROPOSED\*

LOCATION TO NEAREST  
PROPERTY OR LEASE LINE, FT.  
(Also to nearest drig. unit line, if any)

835'

17. NO. OF ACRES IN LEASE

160 922.05

17. NO. OF ACRES ASSIGNED

TO THIS WELL 160.00

18. DISTANCE FROM PROPOSED LOCATION\*

TO NEAREST WELL, DRILLING, COMPLETED,  
OR APPLIC. FOR, ON THIS LEASE, FT.

300'

19. PROPOSED DEPTH

2882'

20. ROTARY OR CABLE TOOLS

Rotary

21. ELEVATIONS (Show whether DF, RT, GR, etc.)

6111' GL DRILLING OPERATIONS AUTHORIZED ARE

22. APPROX. DATE WORK WILL START\*

23. SUBJECT TO COMPLIANCE WITH ATTACHED  
"GENERAL REQUIREMENTS" PROPOSED CASING AND CEMENTING PROGRAM

This action is subject to technical and  
procedural review pursuant to 43 CFR 3105.0,  
and appeal to the BLM.

SIZE OF HOLE	SIZE OF CASING	WEIGHT PER FOOT	SETTING DEPTH	
12 1/4"	9 5/8"	32.3#	200'	125 cf. circulated
8 3/4"	7"	20.0#	2685'	326 cf to cover Ojo Alamo
6 1/4"	5 1/2" liner	23.0#	2882'	do not cement

The Fruitland formation will be completed.

A 3000 psi WP and 6000 psi test double gate preventer equipped with  
blind and pipe rams will be used for blow out prevention on this well.

This gas is dedicated.

The SE/4 of Section 10 is dedicated to this well.

RECEIVED  
MAY 19 1988  
OIL CON. DIV.  
DIST. 3

IN ABOVE SPACE DESCRIBE PROPOSED PROGRAM: If proposal is to deepen or plug back, give data on present productive zone and proposed new productive zone. If proposal is to drill or deepen directionally, give pertinent data on subsurface locations and measured and true vertical depths. Give blowout preventer program, if any.

24.

SIGNED

*[Signature]*

TITLE

Drilling Clerk

DATE

04-14-88

(This space for Federal or State office use)

PERMIT NO.

APPROVAL DATE

APPROVED BY

TITLE

DATE

CONDITIONS OF APPROVAL, IF ANY:

Holder of this permit shall  
or title to this land.

\*See Instructions On Reverse Side

## OIL CONSERVATION DIVISION

STATE OF NEW MEXICO  
ENERGY AND MINERALS DEPARTMENTP. O. BOX 2088  
SANTA FE, NEW MEXICO 87501Form C-102  
Revised 10-1-78

All distances must be from the outer boundaries of the Section.

Operator <b>MERIDIAN OIL INC</b>			Lease <b>RIDDIE COM (SF-078201A)</b>		Well No. <b>200</b>
Unit Letter <b>P</b>	Section <b>10</b>	Township <b>30-N</b>	Range <b>9-W</b>	County <b>SAN JUAN</b>	
Actual Postage Location of Wells <b>835</b> feet from the <b>SOUTH</b> line and <b>1180</b> feet from the <b>EAST</b> line					
Ground Level Elev. <b>6111</b>	Producing Formation <b>Fruitland COAL</b>		Pool <b>Undesignated</b>		Dedicated Acreage <b>160</b> Acres

1. Outline the acreage dedicated to the subject well by colored pencil or hatchure marks on the plat below.
2. If more than one lease is dedicated to the well, outline each and identify the ownership thereof (both as to working interest and royalty).
3. If more than one lease of different ownership is dedicated to the well, have the interests of all owners been consolidated by communitization, unitization, force-pooling, etc?

☒ Yes ☐ No If answer is "yes," type of consolidation communitization

If answer is "no," list the owners and tract descriptions which have actually been consolidated. (Use reverse side of this form if necessary.) \_\_\_\_\_

No allowable will be assigned to the well until all interests have been consolidated (by communitization, unitization, forced-pooling, or otherwise) or until a non-standard unit, eliminating such interests, has been approved by the Division.

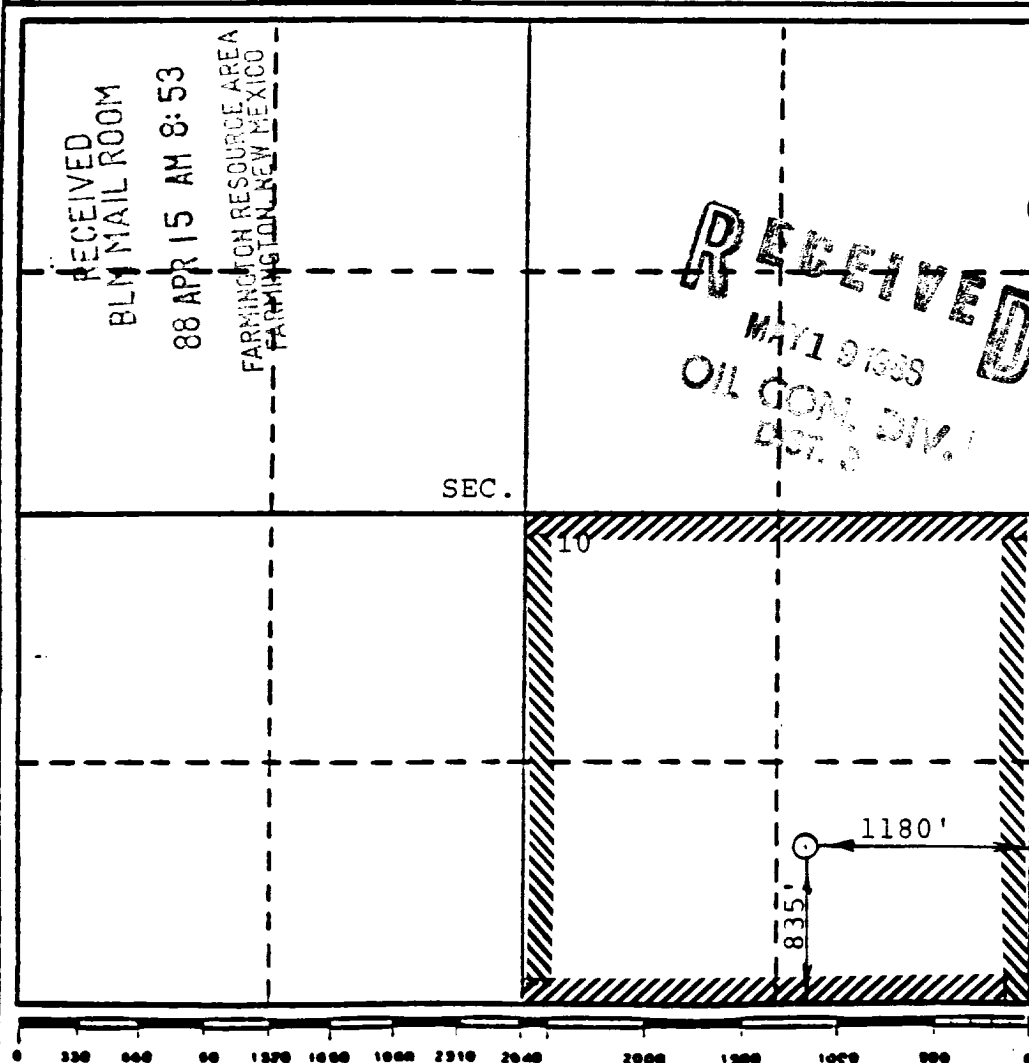

## CERTIFICATION

I hereby certify that the information contained herein is true and complete to the best of my knowledge and belief.

Name  
**Drilling Clerk**  
Position  
**Meridian Oil Inc.**

Company  
**4-14-88**

Date

ISAAC L. WEAVER  
NEW MEXICO  
REGISTERED PROFESSIONAL ENGINEER  
I hereby certify that the well location shown on this plat was plotted from field notes of actual survey made by me or under my supervision, and that the same is true and correct to the best of my knowledge and belief.

MARCH 21, 1988

Date Surveyed  
**ISAAC L. WEAVER**  
Registered Professional Engineer  
and/or Land Surveyor

Certificate No.  
**8966**

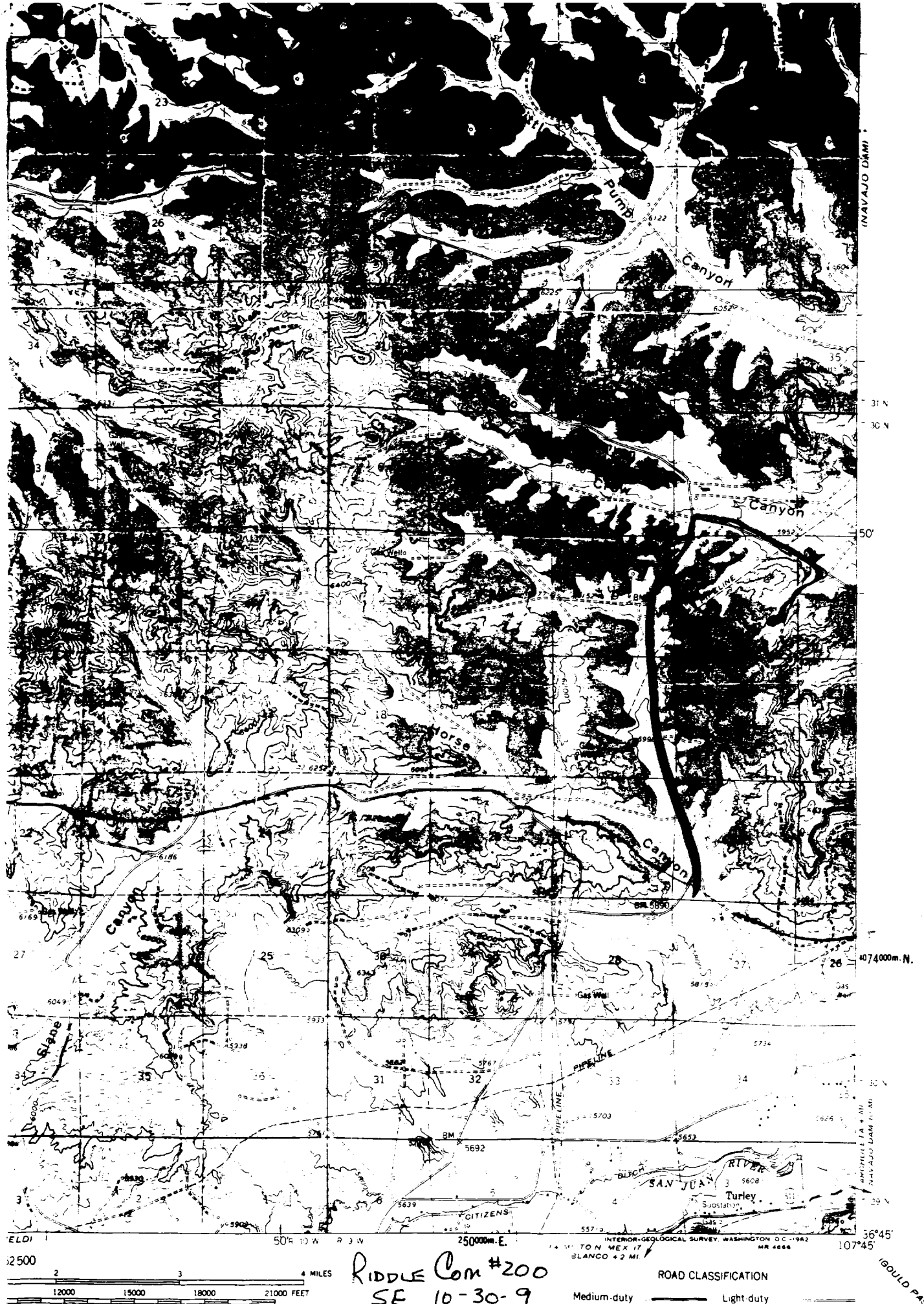

2500  
12000 15000 18000 21000 FEET  
4 MILES

RIDDLE Com #200  
SE 10-30-9

107°45' 107°55' W  
36°45' 36°55' N  
INTERIOR-GEOLOGICAL SURVEY WASHINGTON D.C. 1962  
MR 4000

ROAD CLASSIFICATION  
Medium-duty Light-duty

GOULD PAS