

30-045-26935

NO. OF COPIES RECEIVED	
DISTRIBUTION	
SANTA FE	
FILE	
U.S.G.S.	
LAND OFFICE	
OPERATOR	

NEW MEXICO OIL CONSERVATION COMMISSION

Form C-101  
Revised 1-1-65

5A. Indicate Type of Lease
STATE <input checked="" type="checkbox"/> FEE <input type="checkbox"/>
5. State Oil & Gas Lease No.
E-1641

APPLICATION FOR PERMIT TO DRILL, DEEPEN, OR PLUG BACK

1a. Type of Work			7. Unit Agreement Name		
b. Type of Well OIL WELL <input type="checkbox"/> GAS WELL <input checked="" type="checkbox"/> OTHER <input type="checkbox"/>			8. Farm or Lease Name Turner B Com A		
2. Name of Operator Meridian Oil Inc.			9. Well No. 200		
3. Address of Operator PO Box 4289, Farmington, NM 87499			10. Field and Pool, or Wildcat Undes. Fruitland Coal		
4. Location of Well UNIT LETTER 0 LOCATED 1000 FEET FROM THE South LINE AND 1545 FEET FROM THE East LINE OF SEC. 2 TWP. 30N RGE. 9W NMPM			12. County San Juan		
19. Proposed Depth 2735			19A. Formation Fruitland		20. Rotary or C.T. Rotary
21. Elevations (Show whether DF, RT, etc.) 5942' GL		21A. Kind & Status Plug. Bond statewide		22. Approx. Date Work will start	

PROPOSED CASING AND CEMENT PROGRAM

SIZE OF HOLE	SIZE OF CASING	WEIGHT PER FOOT	SETTING DEPTH	SACKS OF CEMENT	EST. TOP
12 1/4"	9 5/8"	36.0#	200'	130 cu.ft.	circ. surface
8 3/4"	7"	20.0#	2535'	800 cu.ft.	circ. surface
6 1/4"	5 1/2"	23.0#	2735'	do not cement	

The Fruitland Coal formation will be completed.

A 3000 psi WP and 6000 psi test double gate preventer equipped with blind and pipe rams will be used for blow out prevention on this well.

This gas is dedicated.

The SE/4 of Section 2 is dedicated to this well.

APPROVAL BY 12-1-88  
UNLESS OTHERWISE INDICATED  
SPUD DATE IS DEEMED  
WITHIN 10 DAYS.

RECEIVED  
MAY 2 8 1988  
OIL CON. DIV.  
DIST. 3

IN ABOVE SPACE DESCRIBE PROPOSED PROGRAM: IF PROPOSAL IS TO DEEPEN OR PLUG BACK, GIVE DATA ON PRESENT PRODUCTION ZONE AND PROPOSED NEW PRODUCTION ZONE. GIVE BLOWOUT PREVENTER PROGRAM, IF ANY.

I hereby certify that the information above is true and complete to the best of my knowledge and belief.

Signed [Signature] Title Drilling Clerk Date 05-25-88

(This space for State Use)

APPROVED BY [Signature] TITLE DEPUTY OIL & GAS INSPECTOR, DIST. #3 DATE JUN 01 1988

CONDITIONS OF APPROVAL, IF ANY:

## OIL CONSERVATION DIVISION

P. O. BOX 2088

STATE OF NEW MEXICO  
ENERGY AND MINERALS DEPARTMENT

SANTA FE, NEW MEXICO 37501

Form C-102  
Revised 10-1-78

All distances must be from the outer boundaries of the Section.

Operator <b>Meridian Oil Co.</b>			Lease <b>Turner B Com (E-1641)</b>		Well No. <b>A 200</b>
Unit Letter <b>O</b>	Section <b>2</b>	Township <b>T30N</b>	Range <b>R9W</b>	County <b>San Juan</b>	
Actual Footage Location of Well: <b>1000</b> feet from the <b>South</b> line and <b>1545</b> feet from the <b>East</b> line					
Ground Level Elev. <b>5942</b>	Producing Formation <b>Fruitland Coal</b>		Pool <b>Undesignated</b>		Dedicated Acreage: <b>160</b> Acres

1. Outline the acreage dedicated to the subject well by colored pencil or hatchure marks on the plat below.
2. If more than one lease is dedicated to the well, outline each and identify the ownership thereof (both as to working interest and royalty).
3. If more than one lease of different ownership is dedicated to the well, have the interests of all owners been consolidated by communitization, unitization, force-pooling, etc?

☒ Yes ☐ No If answer is "yes," type of consolidation communitization

If answer is "no," list the owners and tract descriptions which have actually been consolidated. (Use reverse side of this form if necessary.) \_\_\_\_\_

No allowable will be assigned to the well until all interests have been consolidated (by communitization, unitization, forced-pooling, or otherwise) or until a non-standard unit, eliminating such interests, has been approved by the Division.

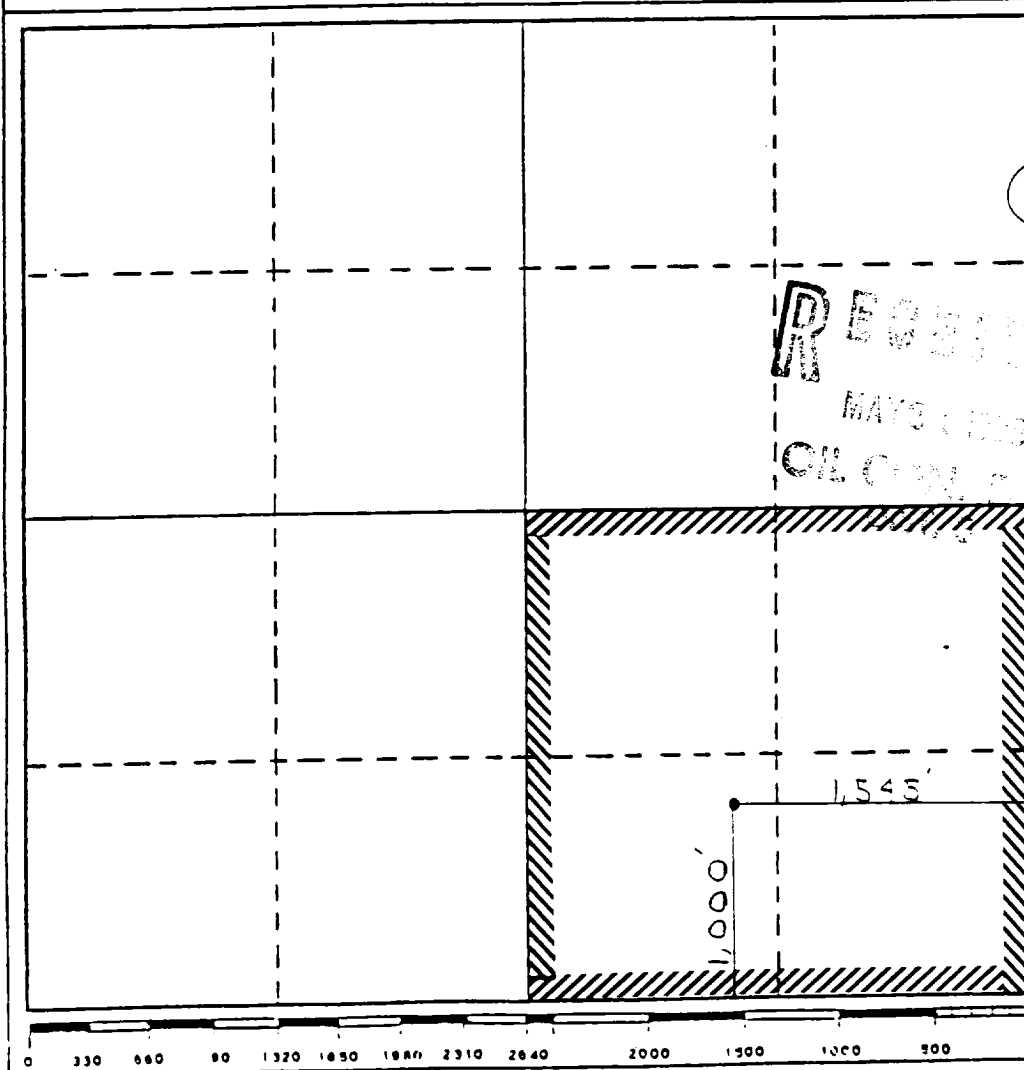

## CERTIFICATION

I hereby certify that the information contained herein is true and complete to the best of my knowledge and belief.

Name

Drilling Clerk

Position

Meridian Oil Inc.

Company

5-25-88

Date

I hereby certify that the well location shown on this plat was plotted from field notes of actual surveys made by me or under my supervision, and that the same is true and correct to the best of my knowledge and belief.

Registered Professional  
Land Surveyor

Date Surveyed

April 9, 1988

Registered Land Surveyor

R. Howard Daggett

*R. Howard Daggett*  
Certificate No.

9679