

UNITED STATES
DEPARTMENT OF THE INTERIOR
BUREAU OF LAND MANAGEMENT

30-045-27006

RECEIVED
ROOM

APPLICATION FOR PERMIT TO DRILL, DEEPEN, OR PLUG BACK

1a. TYPE OF WORK
 DRILL DEEPEN PLUG BACK
 b. TYPE OF WELL
 OIL WELL GAS WELL OTHER
 SINGLE ZONE MULTIPLE ZONE

5. LEASE DESIGNATION AND SERIAL NO.
SF-078128
 6. IF INDIAN, ALLOTTEE OR TRIBE NAME
 7. UNIT AGREEMENT NAME
 8. FARM OR LEASE NAME
Turner Federal
 9. WELL NO.
210
 10. FIELD AND POOL, OR WILDCAT
Undes. Fruitland Coal
 11. SEC., T., R., M., OR BLK. AND SURVEY OR AREA
Sec. 13, T-30-N, R-10-W
NMPM
 12. COUNTY OR PARISH 13. STATE
San Juan NM

2. NAME OF OPERATOR
Meridian Oil Inc.

3. ADDRESS OF OPERATOR
PO Box 4289, Farmington, NM 87499

4. LOCATION OF WELL (Report location clearly and in accordance with any State requirements.)
 At ^{face} 950' N, 790' E
 At proposed prod. zone

14. DISTANCE IN MILES AND DIRECTION FROM NEAREST TOWN OR POST OFFICE*
8 miles from Aztec, NM

13. DISTANCE FROM PROPOSED* LOCATION TO NEAREST PROPERTY OR LEASE LINE, FT. (Also to nearest drlg. unit line, if any)	790'	16. NO. OF ACRES IN LEASE	17. NO. OF ACRES ASSIGNED TO THIS WELL
18. DISTANCE FROM PROPOSED LOCATION* TO NEAREST WELL, DRILLING, COMPLETED, OR APPLIED FOR, ON THIS LEASE, FT.	1450'	19. PROPOSED DEPTH	20. ROTARY OR CABLE TOOLS
		3042'	Rotary

21. ELEVATIONS (Show whether DP, RT, GR, etc.)
6366' GL
 22. APPROX. DATE WORK WILL START*

23. This action is subject to technical and procedural review pursuant to 43 CFR 3165.4 and appeal pursuant to 43 CFR 3165.4
 PROPOSED CASING AND CEMENTING PROGRAM

SIZE OF HOLE	SIZE OF CASING	WEIGHT PER FOOT	SETTING DEPTH	QUANTITY OF CEMENT
12 1/4"	9 5/8"	32.3#	200'	130 cf. circulated
8 3/4"	7"	20.0#	2880'	910 cf circ. surface
6 1/4"	5 1/2" liner	23.0#	3042'	do not cement

The Fruitland coal formation will be completed.
 A 3000 psi WP and 6000 psi test double gate preventer equipped with blind and pipe rams will be used for blow out prevention on this well.
 This gas is dedicated.
 The NE/4 of Section 13 is dedicated to this well.

RECEIVED
AUG 11 1988
OIL CON. DIV.
DIST. 3

IN ABOVE SPACE DESCRIBE PROPOSED PROGRAM: If proposal is to deepen or plug back, give data on present productive zone and proposed new productive zone. If proposal is to drill or deepen directionally, give pertinent data on subsurface locations and measured and true vertical depths. Give blowout preventer program, if any.

24. SIGNED [Signature] TITLE Regulatory Affairs DATE 08-05-88

(This space for Federal or State office use)

PERMIT NO. _____ APPROVAL DATE _____

APPROVED BY [Signature] TITLE _____ DATE AUG 9 1988
 CONDITIONS OF APPROVAL, IF ANY: _____
 AREA MANAGER

*See Instructions On Reverse Side

All distances must be from the outer boundaries of the Section.

Operator Meridian Oil Inc.		Lease Turner Federal (SF-078128)		Well No. 210
Unit Letter A	Section 13	Township 30 North	Range 10 West	County San Juan
Actual Footage Location of Wells: 950 feet from the North line and 790 feet from the East line				
Ground Level Elev. 6366	Producing Formation Fruitland Coal	Pool Undesignated	Dedicated Acreage: 158.50 Acres	

- Outline the acreage dedicated to the subject well by colored pencil or hachure marks on the plat below.
- If more than one lease is dedicated to the well, outline each and identify the ownership thereof (both as to working interest and royalty).
- If more than one lease of different ownership is dedicated to the well, have the interests of all owners been consolidated by communitization, unitization, force-pooling, etc?

Yes No If answer is "yes," type of consolidation _____

If answer is "no," list the owners and tract descriptions which have actually been consolidated. (Use reverse side of this form if necessary.) _____

No allowable will be assigned to the well until all interests have been consolidated (by communitization, unitization, forced-pooling, or otherwise) or until a non-standard unit, eliminating such interests, has been approved by the Division

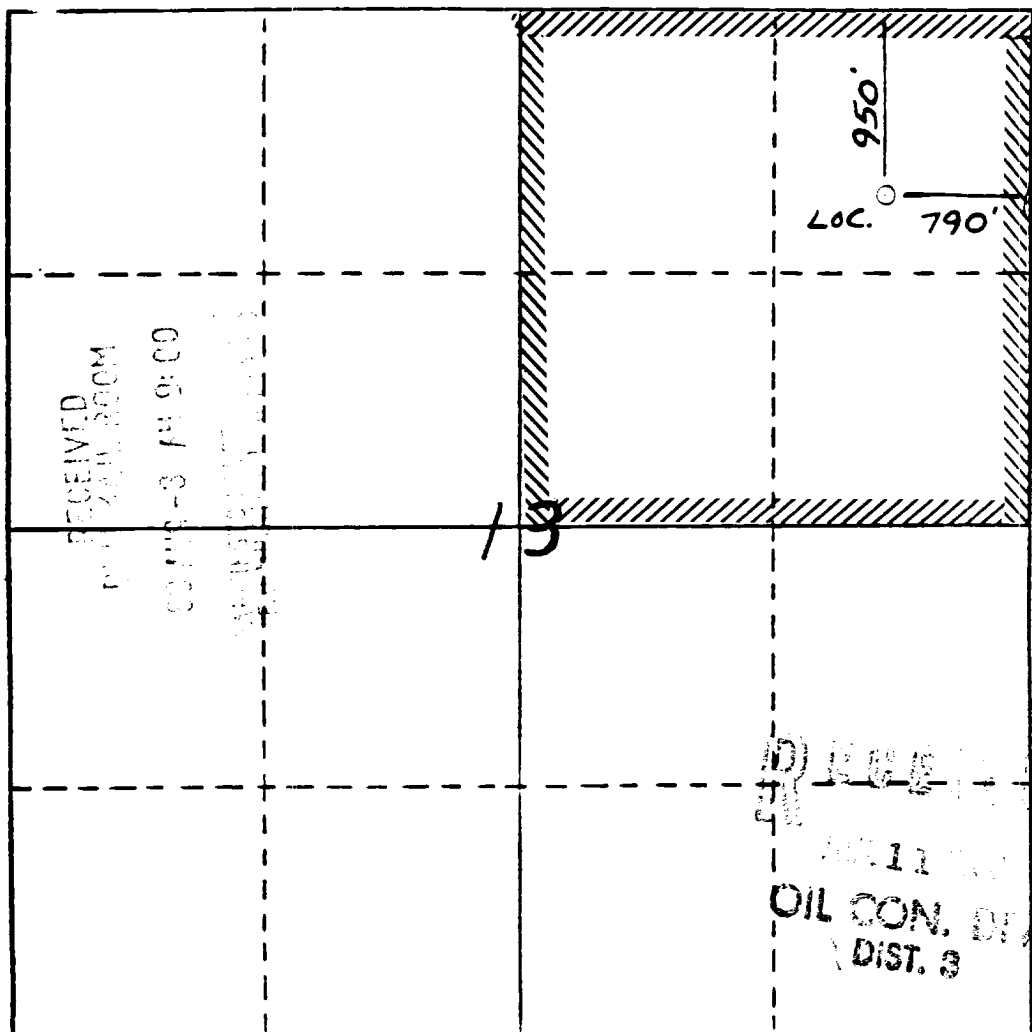

CERTIFICATION

I hereby certify that the information contained herein is true and complete to the best of my knowledge and belief.

John H. ...

Name

Drilling Clerk

Position

Meridian Oil Inc.

Company

Date

6-13-88

I hereby certify that the well location shown on this plat is plotted from field notes of actual surveys made by me or under my supervision, and that the same is true and correct to the best of my knowledge and belief.

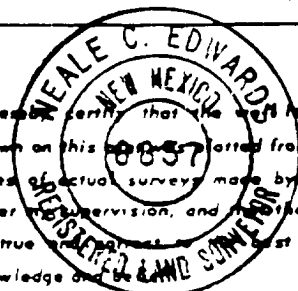

Neale C. Edwards

Date Surveyed

6-13-88

Registered Professional Engineer and/or Land Surveyor

Neale C. Edwards

Certificate No.

6357

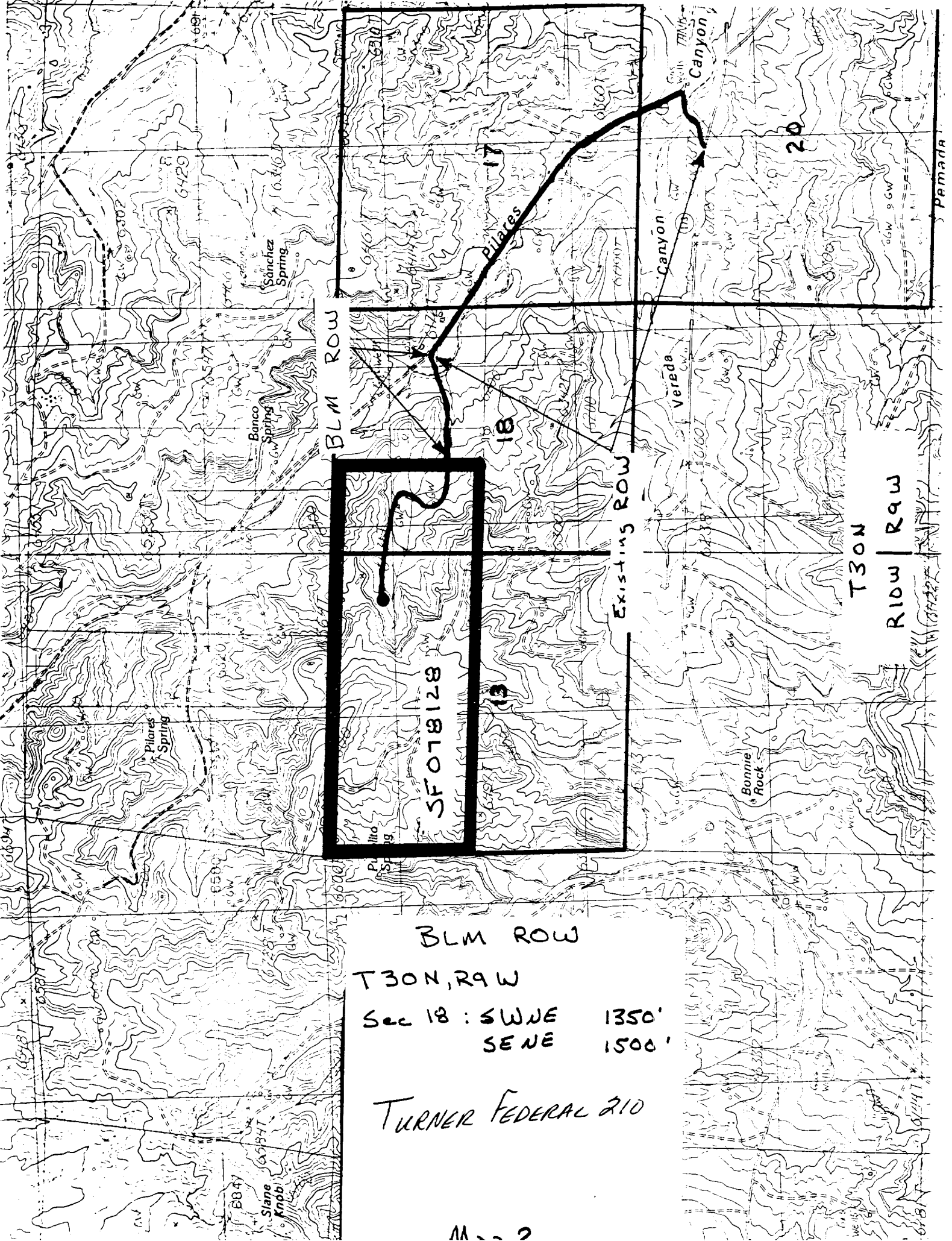

BLM ROW

Existing ROW

SF078128

BLM ROW

T30N, R9W

Sec 18 : SWNE 1350'
SENE 1500'

TURNER FEDERAL 210

T30N

R10W R9W

PAMADA