

STATE OF NEW MEXICO  
ENERGY AND MINERALS DEPARTMENT

OIL CONSERVATION DIVISION  
P. O. BOX 2088  
SANTA FE, NEW MEXICO 87501

30-045-27007

Form C-101  
Revised 10-1-78

NO. OF COPIES RECEIVED	
DISTRIBUTION	
SANTA FE	
FILE	
U.S.G.S.	
LAND OFFICE	
OPERATOR	

5A. Indicate Type of Lease  
STATE ☐ FEE ☒

5. State Oil & Gas Lease No.

APPLICATION FOR PERMIT TO DRILL, DEEPEN, OR PLUG BACK

1a. Type of Work b. Type of Well OIL WELL <input checked="" type="checkbox"/> GAS WELL <input type="checkbox"/> OTHER <input type="checkbox"/> DEEPEN <input type="checkbox"/> PLUG BACK <input type="checkbox"/>		7. Unit Agreement Name
2. Name of Operator Manzano Oil Corporation		8. Farm or Lease Name Wild Swede
3. Address of Operator P.O. Box 2107, Roswell N.M. 88202-2107 623-1996		9. Well No. #1
4. Location of Well UNIT LETTER H LOCATED 1780' FEET FROM THE North LINE AND 600 FEET FROM THE East LINE OF SEC. 6 TWP. 30N REC. 15W		10. Field and Pool, or Wildcat Verde Gallup
11. Elevations (Show whether DT, RT, etc.) 5339 GL		12. County San Juan
21A. Kind & Status Plug. Bond State Wide	19. Proposed Depth 2000'	19A. Formation Gallup
21B. Drilling Contractor Unknown	20. Rotary or C.T. Rotary	
22. Approx. Date Work will start August 20, 1988		

PROPOSED CASING AND CEMENT PROGRAM

SIZE OF HOLE	SIZE OF CASING	WEIGHT PER FOOT	SETTING DEPTH	SACKS OF CEMENT	EST. TOP
11"	8-5/8"	24 lbs.	100'	100 sx (circ)	surface
7-7/8"	5-1/2"	14 lbs.	2000'	100 sx Class C	1100'

BOP Program: A 3000# 10 inch 900 Series Double with blanks and 3-1/2 inch with blank rims.

Casing Program: Plan to rig up and spud approximately August 20, 1988. Drill to 100' and run 8-5/8 inch casing. Drill to approximately 2000' and if well is commercial we will run 5-1/2 inch casing and put on production.

APPROVAL EXPIRES 2-17-89  
UNLESS DRILLING IS COMMENCED.  
SPUD NOTICE MUST BE SUBMITTED  
WITHIN 10 DAYS.

RECEIVED  
AUG 5 1988  
OIL CON. DIV.  
DIST. 3

IN ABOVE SPACE DESCRIBE PROPOSED PROGRAM: IF PROPOSAL IS TO DEEPEN OR PLUG BACK, GIVE DATA ON PRESENT PRODUCTIVE ZONE AND PROPOSED NEW PRODUCTIVE ZONE. GIVE BLOWOUT PREVENTER PROGRAM, IF ANY.

I hereby certify that the information above is true and complete to the best of my knowledge and belief.

Signed [Signature] Title Landman Date August 12, 1988

(This space for State Use)

APPROVED BY [Signature] TITLE DEPUTY OIL & GAS INSPECTOR, DIST. #3 DATE 8-17-88

CONDITIONS OF APPROVAL, IF ANY:

Circulate 5 1/2 to surface

**NEW MEXICO OIL CONSERVATION COMMISSION  
WELL LOCATION AND ACREAGE DEDICATION PLAT**

Form C-102  
Supersedes C-128  
Effective 1-1-65

All distances must be from the outer boundaries of the Section.

Operator <b>MANZANO OIL CORP.</b>			Lease <b>WILD SWENE</b>		Well No. <b>1</b>
Unit Letter <b>H</b>	Section <b>6</b>	Township <b>30 N</b>	Range <b>15 W</b>	County <b>SAN JUAN</b>	
Actual Footage Location of Well: <b>1780</b> feet from the <b>North</b> line and <b>600</b> feet from the <b>East</b> line					
Ground Level Elev: <b>5339</b>	Producing Formation <b>Gallup</b>	Pool <b>Verde Gallup</b>	Dedicated Acreage: <b>40</b> Acres		

1. Outline the acreage dedicated to the subject well by colored pencil or hatchure marks on the plat below.
2. If more than one lease is dedicated to the well, outline each and identify the ownership thereof (both as to working interest and royalty).
3. If more than one lease of different ownership is dedicated to the well, have the interests of all owners been consolidated by communitization, unitization, force-pooling, etc?

☐ Yes ☐ No If answer is "yes," type of consolidation \_\_\_\_\_

If answer is "no," list the owners and tract descriptions which have actually been consolidated. (Use reverse side of this form if necessary.) \_\_\_\_\_

No allowable will be assigned to the well until all interests have been consolidated (by communitization, unitization, forced-pooling, or otherwise) or until a non-standard unit, eliminating such interests, has been approved by the Commission.

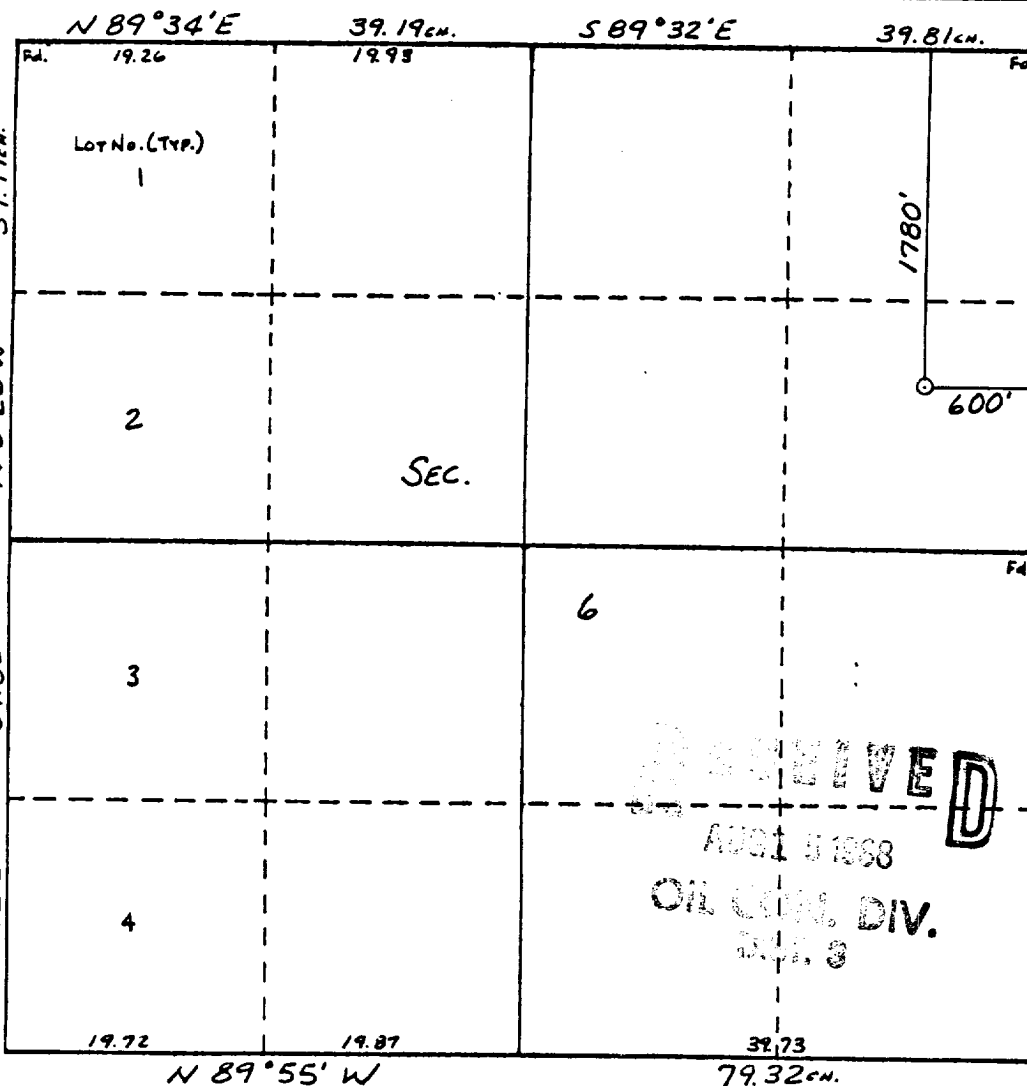

**CERTIFICATION**

I hereby certify that the information contained herein is true and complete to the best of my knowledge and belief.

Name **Jim Ball**  
Position **Landman**  
Company **Manzano Oil Corporation**  
Date **August 12, 1988**

I hereby certify that the well location shown on this plat was plotted from field notes of actual surveys made by me or under my supervision, and that the same is true and correct to the best of my knowledge and belief.

Date Surveyed **Aug 12, 1988**  
Witnessed by **P. Mahanne**  
Registered Professional Engineer and/or Land Surveyor  
Certificate No. **8466**

UTE MOUNTAIN INDIAN RESERVATION

MANZANO OIL CORP.  
WILD SWEDEN #1  
1780'FNL & 600'FEL  
Sec.6, T30N, R15W  
San Juan Co., N.M.

