

OIL CONSERVATION DIVISION

STATE OF NEW MEXICO
ENERGY AND MINERALS DEPARTMENTP. O. BOX 2088
SANTA FE, NEW MEXICO 875Form C-102
Revised 10-1-

All distances must be from the outer boundaries of the Section.

Operator Meridian Oil Inc.		Lease Florance B Com (SF-078116A)		Well No. 250
Unit Letter C	Section 20	Township 30 North	Range 9 West	County San Juan
Actual Footage Location of Well: 790 feet from the North line and 1530 feet from the West line				
Ground Level Elev. 6068'	Producing Formation Fruitland Coal		Pool Basin	Dedicated Acreage: 320 Acre

1. Outline the acreage dedicated to the subject well by colored pencil or hachure marks on the plat below.
2. If more than one lease is dedicated to the well, outline each and identify the ownership thereof (both as to working interest and royalty).
3. If more than one lease of different ownership is dedicated to the well, have the interests of all owners been consolidated by communitization, unitization, force-pooling, etc?

☒ Yes ☐ No If answer is "yes," type of consolidation Communitization agreement NM-8013

If answer is "no," list the owners and tract descriptions which have actually been consolidated. (Use reverse side of this form if necessary.)

No allowable will be assigned to the well until all interests have been consolidated (by communitization, unitization, forced-pooling, or otherwise) or until a non-standard unit, eliminating such interests, has been approved by the Division.

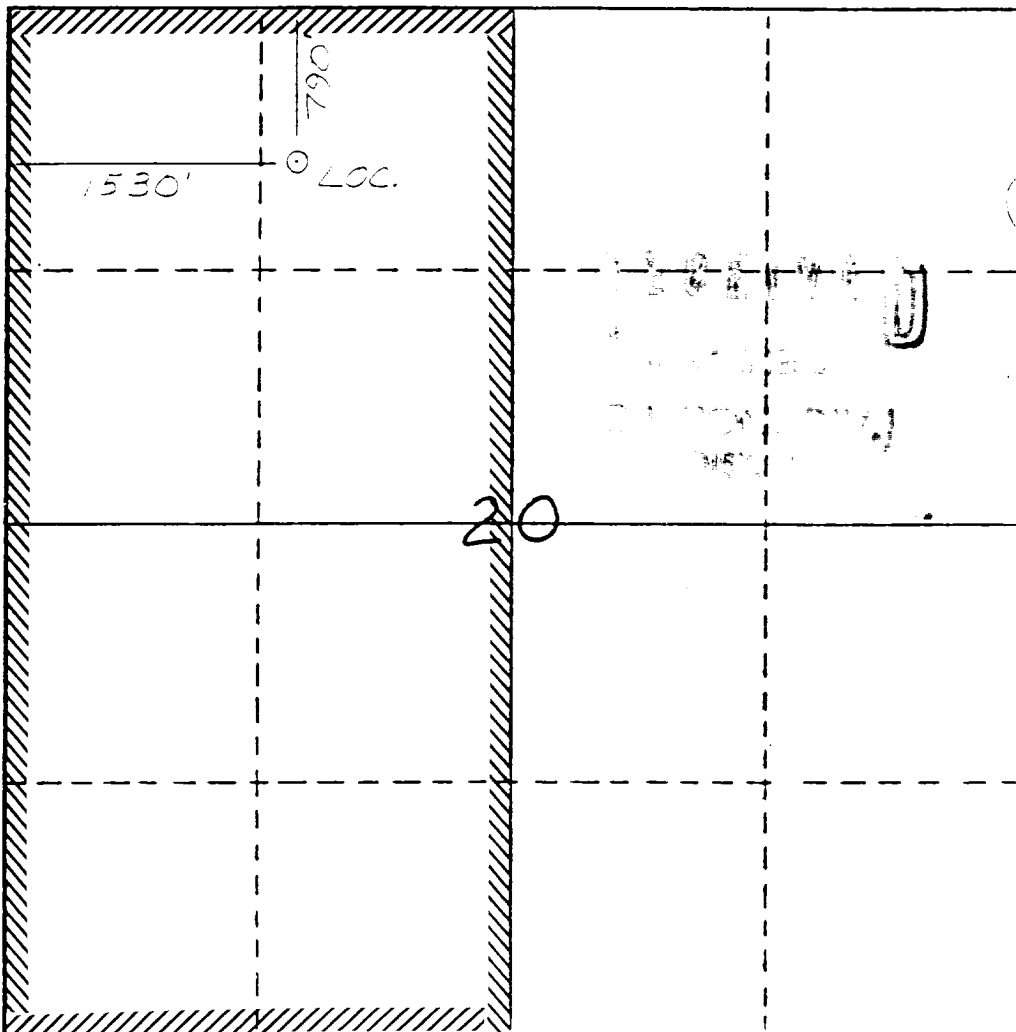

CERTIFICATION

I hereby certify that the information contained herein is true and complete to the best of my knowledge and belief.

Name

Regulatory Affairs

Position

Meridian Oil Inc.

Company

Date

4-18-96

I hereby certify that the well location shown on this plat was plotted from field notes of actual surveys made by me or under my supervision, and that the same is true and correct to the best of my knowledge and belief.

Date Surveyed

6-12-88

Registered Professional Engineer
and/or Land Surveyor

Neale C. Edwards

Certificate No.