

UNITED STATES
DEPARTMENT OF THE INTERIOR
GEOLOGICAL SURVEY

APPLICATION FOR PERMIT TO DRILL, DEEPEN, OR PLUG BACK

1a. TYPE OF WORK
DRILL ☒ DEEPEN ☐ PLUG BACK ☐

b. TYPE OF WELL
OIL WELL ☐ GAS WELL ☒ OTHER ☐ SINGLE ZONE ☒ MULTIPLE ZONE ☐

2. NAME OF OPERATOR
Tenneco Oil Company

3. ADDRESS OF OPERATOR
P.O. Box 3249, Englewood, CO 80155

4. LOCATION OF WELL (Report location clearly and in accordance with any State requirements.)
At surface
1175' FNL, 990' FWL
At proposed prod. zone
Same

14. DISTANCE IN MILES AND DIRECTION FROM NEAREST TOWN OR POST OFFICE*
1 mile North of Aztec, NM

15. DISTANCE FROM PROPOSED* LOCATION TO NEAREST PROPERTY OR LEASE LINE, FT.
(Also to nearest drig. unit line, if any)
330'

16. NO. OF ACRES IN LEASE
470.58

17. NO. OF ACRES ASSIGNED TO THIS WELL
200 3/8.39

18. DISTANCE FROM PROPOSED LOCATION* TO NEAREST WELL, DRILLING, COMPLETED, OR APPLIED FOR, ON THIS LEASE, FT.
1056'

19. PROPOSED DEPTH
5000'

20. ROTARY OR CABLE TOOLS
Rotary

21. ELEVATIONS (Show whether BE SET OR AUTHORIZED ARE
5794' GR SUBJECT TO COMPLIANCE WITH ATTACHED

22. APPROX. DATE WORK WILL START*
ASAP

23. "GENERAL REQUIREMENTS" PROPOSED CASING AND CEMENTING PROGRAM

5. LEASE DESIGNATION AND SERIAL NO.
SF-078731

6. IF INDIAN, ALLOTTEE OR TRIBE NAME

7. UNIT AGREEMENT NAME

8. FARM OR LEASE NAME
Storey B LS

9. WELL NO.
3A

10. FIELD AND POOL, OR WILDCAT
Blanco Mesaverde

11. SEC., T., R., M., OR BLK. AND SURVEY OR AREA
D
Sec. 5, T30N, R11W

12. COUNTY OR PARISH
San Juan

13. STATE
NM

SIZE OF HOLE	SIZE OF CASING	WEIGHT PER FOOT	SETTING DEPTH	QUANTITY OF CEMENT
12 1/4"	9 5/8"	36#	± 250'	206 cu.ft. - Circ. to Surface
8 3/4"	7"	23#	± 2650'	637 cu.ft. - Circ. to Surface
6 1/4"	4 1/2"	10.5#	± 5000'	544 cu.ft. - Circ. to Liner Top

See Attached Drilling Procedure.

See Item 1.B. in Surface use Plan & Map 2 for BLM Right-of-Way Application.

RECEIVED
AUG 15 1988
OIL CON. DIV.
DIST. 3

IN ABOVE SPACE DESCRIBE PROPOSED PROGRAM: If proposal is to deepen or plug back, give data on present productive zone and proposed new productive zone. If proposal is to drill or deepen directionally, give pertinent data on subsurface locations and measured and true vertical depths. Give blowout preventer program, if any.

24. SIGNED Larry Bell TITLE Admin. Supervisor DATE 6/21/88
(This space for Federal or State office use)

PERMIT NO. _____ APPROVAL DATE _____
APPROVED BY _____ TITLE _____
CONDITIONS OF APPROVAL, IF ANY:

OK
5/8

NMOCC

**NEW MEXICO OIL CONSERVATION COMMISSION
WELL LOCATION AND ACREAGE DEDICATION PLAT**

Form C-102
Supersedes C-128
Effective 1-4-85

All distances must be from the outer boundaries of the Section.

Operator TENNOCO OIL COMPANY			Lease STOREY B LS		Well No. 3A
Unit Letter D	Section 5	Township 30 N	Range 11 W	County SAN JUAN	
Actual Footage Location of Well: 1175 feet from the North line and 990 feet from the West line					
Ground Level Elev. 5794	Producing Formation Mesaverde		Pool Blanco Mesaverde		Dedicated Acreage 320.33 318.39 Acres

1. Outline the acreage dedicated to the subject well by colored pencil or hachure marks on the plat below.
2. If more than one lease is dedicated to the well, outline each and identify the ownership thereof (both as to working interest and royalty).
3. If more than one lease of different ownership is dedicated to the well, have the interests of all owners been consolidated by communitization, unitization, force-pooling, etc?

☒ Yes ☐ No If answer is "yes," type of consolidation Communitization

If answer is "no," list the owners and tract descriptions which have actually been consolidated. (Use reverse side of this form if necessary.) _____

No allowable will be assigned to the well until all interests have been consolidated (by communitization, unitization, forced-pooling, or otherwise) or until a non-standard unit, eliminating such interests, has been approved by the Commission.

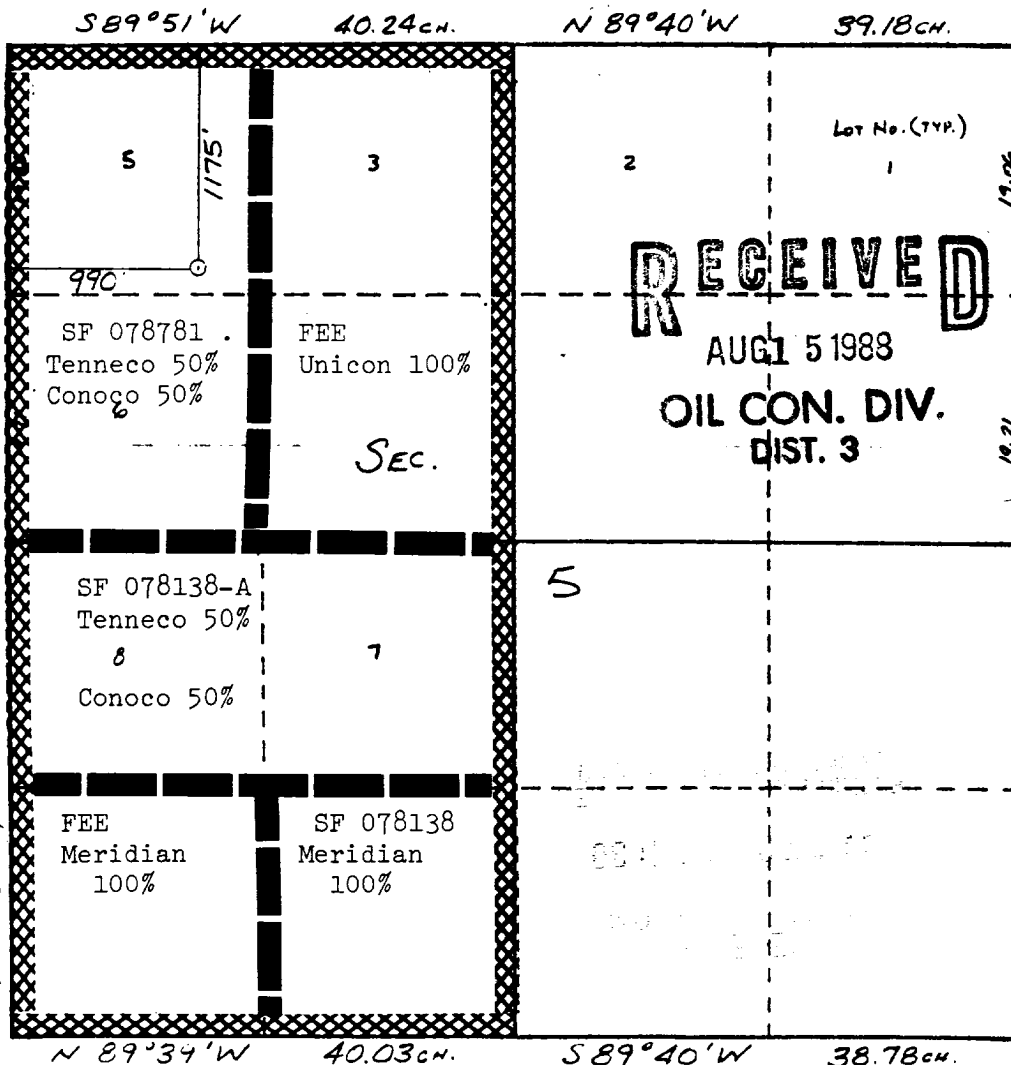

CERTIFICATION	
I hereby certify that the information contained herein is true and complete to the best of my knowledge and belief.	
Name	<u>Ken Russell</u>
Position	<u>Admin Analyst</u>
Company	<u>Tenneco Oil Co</u>
Date	<u>6/15/88</u>
I hereby certify that the well location shown on this plat was plotted from field notes of actual surveys made by me or under my supervision, and that the same is true and correct to the best of my knowledge and belief.	
Date Surveyed	<u>6-15-88</u>
Witness	<u>WILLIAM J. HANKE II</u>
Registered Professional Engineer and Land Surveyor	<u>8466</u>
Certificate No.	<u>8466</u>

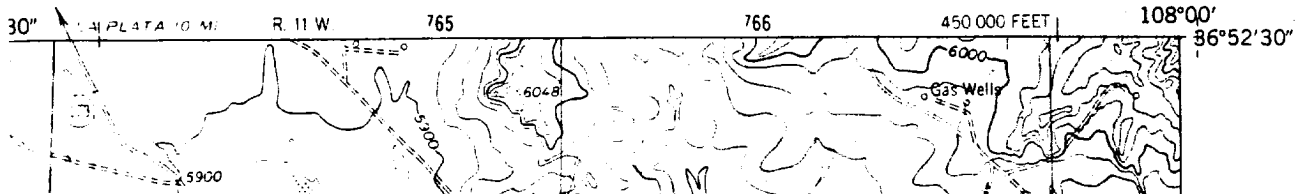
**MAP 1****STOREY B LS 3A**

1175' FNL, 990' FWL
 Sec. 5, T30N, R11W
 San Juan, NM

Access Roads

± 700' New Construction

