

UNITED STATES
DEPARTMENT OF THE INTERIOR
BUREAU OF LAND MANAGEMENT

APPLICATION FOR PERMIT TO DRILL, DEEPEN, OR PLUG BACK

1A. TYPE OF WORK

DRILL ☒

DEEPEN ☐

PLUG BACK ☐

5. LEASE DESIGNATION AND SERIAL NO.

SE-078200A

6. IF INDIAN, ALLOTTEE OR TRIBE NAME

7. UNIT AGREEMENT NAME

8. FARM OR LEASE NAME

Grambling C

9. WELL NO.

202

10. FIELD AND POOL, OR WILDCAT

Undes. Fruitland Coal

11. SEC., T., R., M., OR BLK.

Sec. 14, T-30-N, R-10-W

NMFM

12. COUNTY OR PARISH 13. STATE

San Juan NM

B. TYPE OF WELL

OIL WELL ☐

GAS WELL ☒

OTHER

SINGLE ZONE ☒

MULTIPLE ZONE ☐

2. NAME OF OPERATOR

Meridian Oil Inc.

3. ADDRESS OF OPERATOR

PO Box 4289, Farmington, NM 87499

4. LOCATION OF WELL (Report location clearly and in accordance with any State requirements.)

At surface 1630'N, 1495'E

At proposed prod. zone

14. DISTANCE IN MILES AND DIRECTION FROM NEAREST TOWN OR POST OFFICE*

9 miles from Aztec, NM

15. DISTANCE FROM PROPOSED*
LOCATION TO NEAREST
PROPERTY OR LEASE LINE, FT.
(Also to nearest drig. unit line, if any)

1495

16. NO. OF ACRES IN LEASE

17. NO. OF ACRES ASSIGNED
TO THIS WELL

160.00 157.68

18. DISTANCE FROM PROPOSED LOCATION*
TO NEAREST WELL, DRILLING, COMPLETED,
OR APPLIED FOR, ON THIS LEASE, FT.

400'

19. PROPOSED DEPTH

3052'

20. ROTARY OR CABLE TOOLS

Rotary

21. ELEVATIONS (Show whether DF, BT, GR, etc.)

6403' GL

This action is subject to technical and
procedural review pursuant to 43 CFR 3100.3

and appeal pursuant to 43 CFR 3100.4, AND CEMENTING PROGRAM

22. APPROX. DATE WORK WILL START*

DRILLING OPERATIONS AUTHORIZED ARE
SUBJECT TO COMPLIANCE WITH ATTACHED

"GENERAL REQUIREMENTS".

SIZE OF HOLE	SIZE OF CASING	WEIGHT PER FOOT	SETTING DEPTH	
12 1/4"	9 5/8"	32.3#	200'	130' cf. circulated
8 3/4"	7"	20.0#	2811'	910' cf. circ. surface
6 1/4"	5 1/2" liner	23.0#	3052'	do not cement

The Fruitland coal formation will be completed.

A 3000 psi WP and 6000 psi test double gate preventer equipped with
blind and pipe rams will be used for blow out prevention on this well.

This gas is dedicated.

The NE/4 of Section 14 is dedicated to this well.

RECEIVED
AUG 16 1988
OIL CON. DIV.
DIST. 2

IN ABOVE SPACE DESCRIBE PROPOSED PROGRAM: If proposal is to deepen or plug back, give data on present productive zone and proposed new productive zone. If proposal is to drill or deepen directionally, give pertinent data on subsurface locations and measured and true vertical depths. Give blowout preventer program, if any.

24. SIGNED [Signature] TITLE Regulatory Affairs DATE 08-16-88

(This space for Federal or State office use)

*A PERMIT NO. APPROVAL DATE

APPROVED BY TITLE DATE

CONDITIONS OF APPROVAL, IF ANY:

NMOC

*See Instructions On Reverse Side

All distances must be from the outer boundaries of the Section.

Operator Meridian Oil Inc.		Lease Grumbling C (SF-078200A)		Well No. 202
Unit Letter G	Section 14	Township 30 North	Range 10 West	County Santa Fe
Actual Footage Location of Wells 1630 feet from the North line and 1495 feet from the East line				
Ground Level Elev. 6403'	Producing Formation Fruitland Coal	Pool Undesignated	Dedicated Acreage: 160/5 '08' Acres	

1. Outline the acreage dedicated to the subject well by colored pencil or hatchure marks on the plat below.
2. If more than one lease is dedicated to the well, outline each and identify the ownership thereof (both as to working interest and royalty).
3. If more than one lease of different ownership is dedicated to the well, have the interests of all owners been consolidated by communitization, unitization, force-pooling, etc?

☐ Yes ☐ No If answer is "yes," type of consolidation _____

If answer is "no," list the owners and tract descriptions which have actually been consolidated. (Use reverse side of this form if necessary.) _____

No allowable will be assigned to the well until all interests have been consolidated (by communitization, unitization, forced-pooling, or otherwise) or until a non-standard unit, eliminating such interests, has been approved by the Division

NOTE: reissued to show moved location

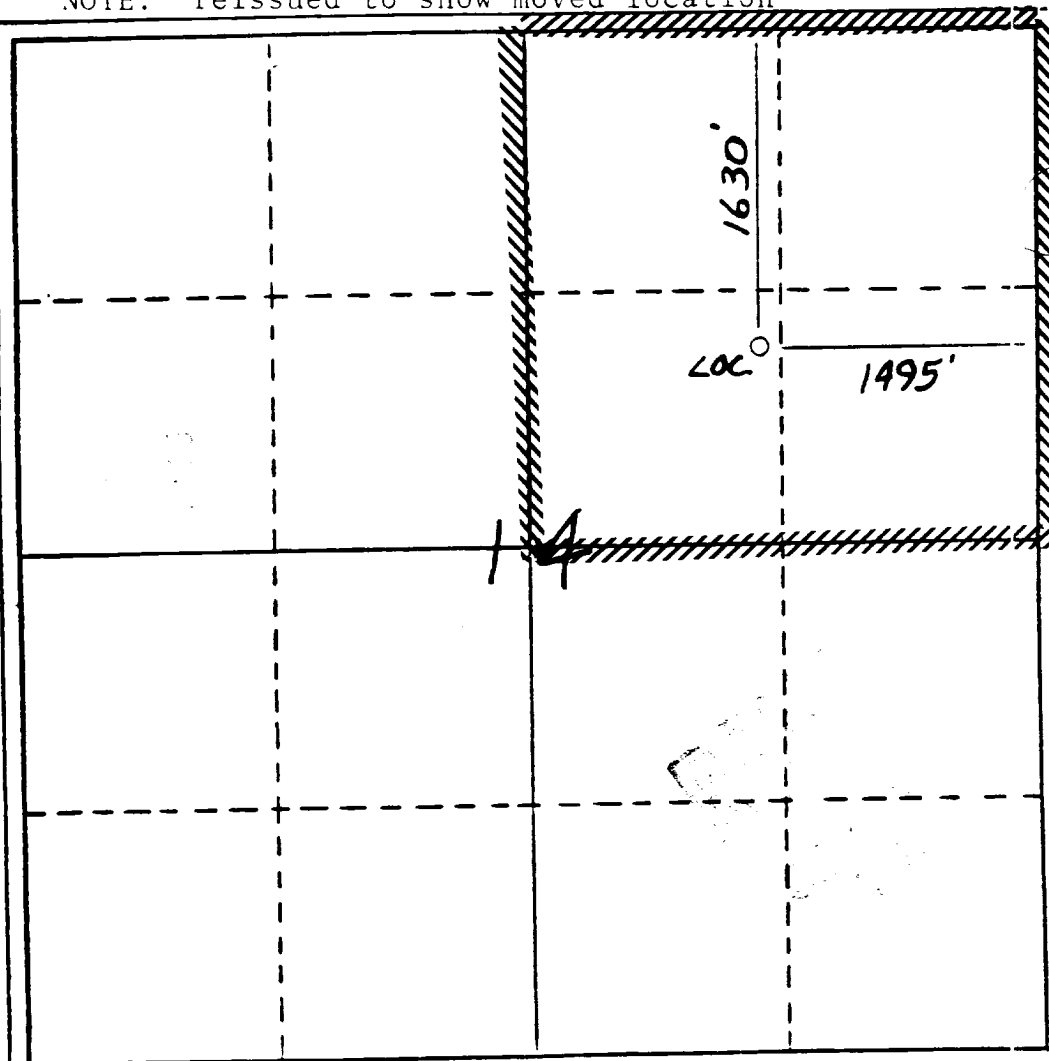

CERTIFICATION

I hereby certify that the information contained herein is true and complete to the best of my knowledge and belief.

[Signature]

Name
Regulatory Affairs

Position
Meridian Oil Inc.

Company
8-15-78

Date

by

I hereby certify that the well location shown on this plat is based on field notes of actual survey made by me or under my supervision, and the same is true and correct to the best of my knowledge and belief.

[Signature]

Date Surveyed

7-22-
Registered Professional Engineer
and/or Land Surveyor

Neale C. Edwards

Certificate No.

6357

GRABBLING 0202

ARJ 1-1-20
No work needed

